

REV.	DATE	DCN #	DRAWING TREE #
v1	11th Nov 2008	E080530-v1	

ETCH OR GRIND REGISTRATION MARKS  
 0.25mm ±0.05mm WIDE x  
 80mm ±3mm LONG MINIMUM LEGIBLE  
 DEPTH LINE ALONG  $\phi$ , CENTERED  
 BETWEEN SURFACES 'S1' AND 'S2', PARALLEL  
 TO THE CYLINDRICAL AXIS  
 (DEFINED BY DATUM FEATURE -A-)  
 WITHIN ±0.1mm AND  
 180° FROM SCRIBE LINE AT LOCATION OF  
 MINIMUM PART THICKNESS.

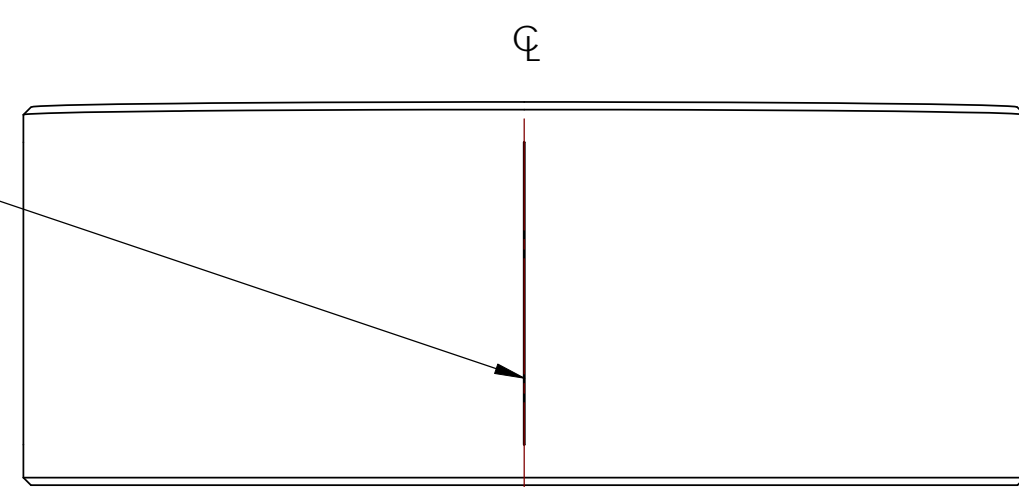

TOP VIEW

ETCH OR GRIND REGISTRATION MARKS  
 0.25mm ±0.05mm WIDE x  
 80mm ±3mm LONG MINIMUM LEGIBLE  
 DEPTH LINE ALONG  $\phi$ , CENTERED  
 BETWEEN SURFACES 'S1' AND 'S2', PARALLEL  
 TO THE CYLINDRICAL AXIS  
 (DEFINED BY DATUM FEATURE -A-)  
 WITHIN ±0.1mm AND  
 90° FROM SCRIBE LINE AT LOCATION OF  
 MINIMUM PART THICKNESS.

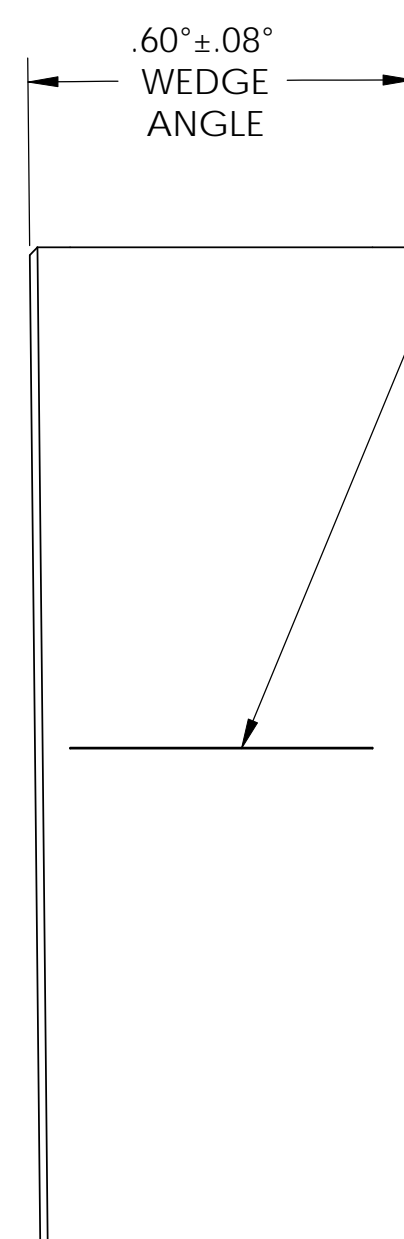

60° ±0.08°  
 WEDGE  
 ANGLE

ETCH OR GRIND REGISTRATION MARKS  
 0.25mm ±0.05mm WIDE x  
 80mm ±3mm LONG MINIMUM LEGIBLE  
 DEPTH LINE ALONG  $\phi$ , CENTERED  
 BETWEEN SURFACES 'S1' AND 'S2' AT  
 LOCATION OF MINIMUM PART THICKNESS  
 WITHIN ±1° CLOCKING ANGLE  
 (WITH RESPECT TO DATUM FEATURE -A-),  
 AND PARALLEL TO THE CYLINDRICAL AXIS  
 (DEFINED BY DATUM FEATURE -A-)  
 WITHIN ±0.1mm, WITH ARROW POINTING  
 TO SURFACE 'S1'.

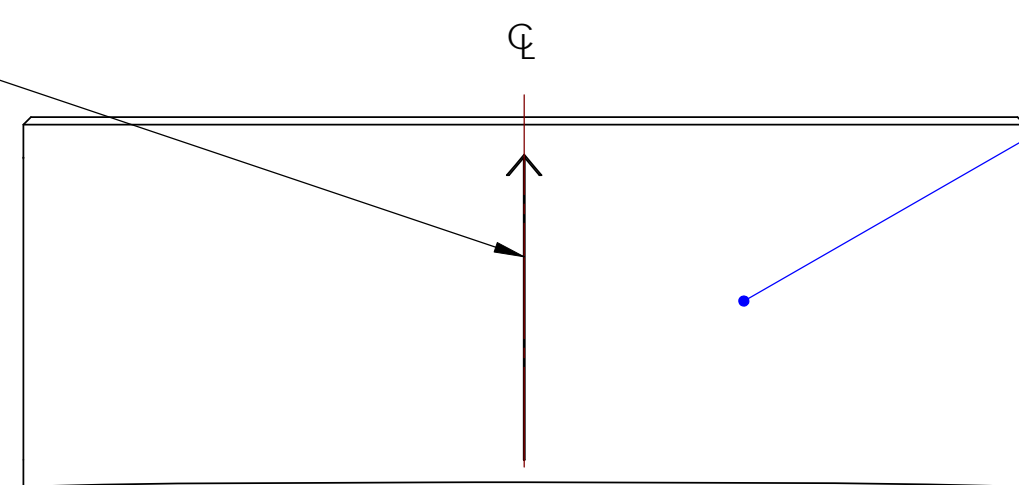

BOTTOM VIEW

POLISH SURFACE 'S1'  
 (SEE NOTE 4)

$\phi$ 265.00 ±0.25
0.1
0.18 B

BARREL SIDE AND BEVEL POLISH  
 (SEE NOTE 3).

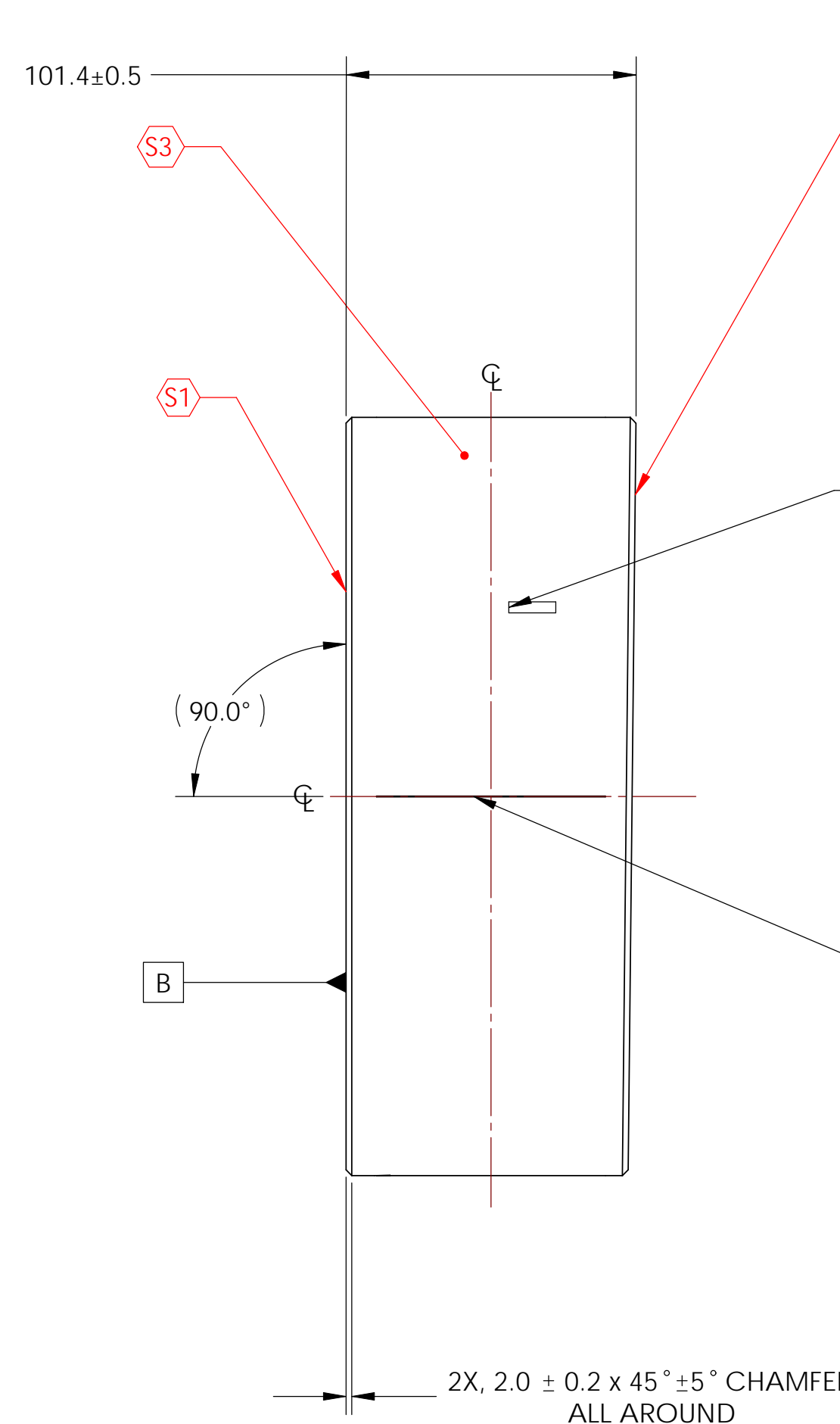

101.4 ±0.5

POLISH SURFACE 'S2'  
 (SEE NOTE 4).

ETCH OR GRIND SERIAL NUMBER, APPROX. WHERE SHOWN,  
 LETTERING APPROX. 4mm HIGH  
 (SEE NOTE 5 FOR FURTHER DETAILS)

(90.0°)

ETCH OR GRIND REGISTRATION MARKS  
 0.25mm ±0.05mm WIDE x  
 80mm ±3mm LONG MINIMUM LEGIBLE  
 DEPTH LINE ALONG  $\phi$ , CENTERED  
 BETWEEN SURFACES 'S1' AND 'S2', PARALLEL  
 TO THE CYLINDRICAL AXIS  
 (DEFINED BY DATUM FEATURE -A-)  
 WITHIN ±0.1mm AND  
 90° FROM SCRIBE LINE AT LOCATION OF  
 MINIMUM PART THICKNESS.

2X, 2.0 ± 0.2 x 45° ±5° CHAMFER,  
 ALL AROUND

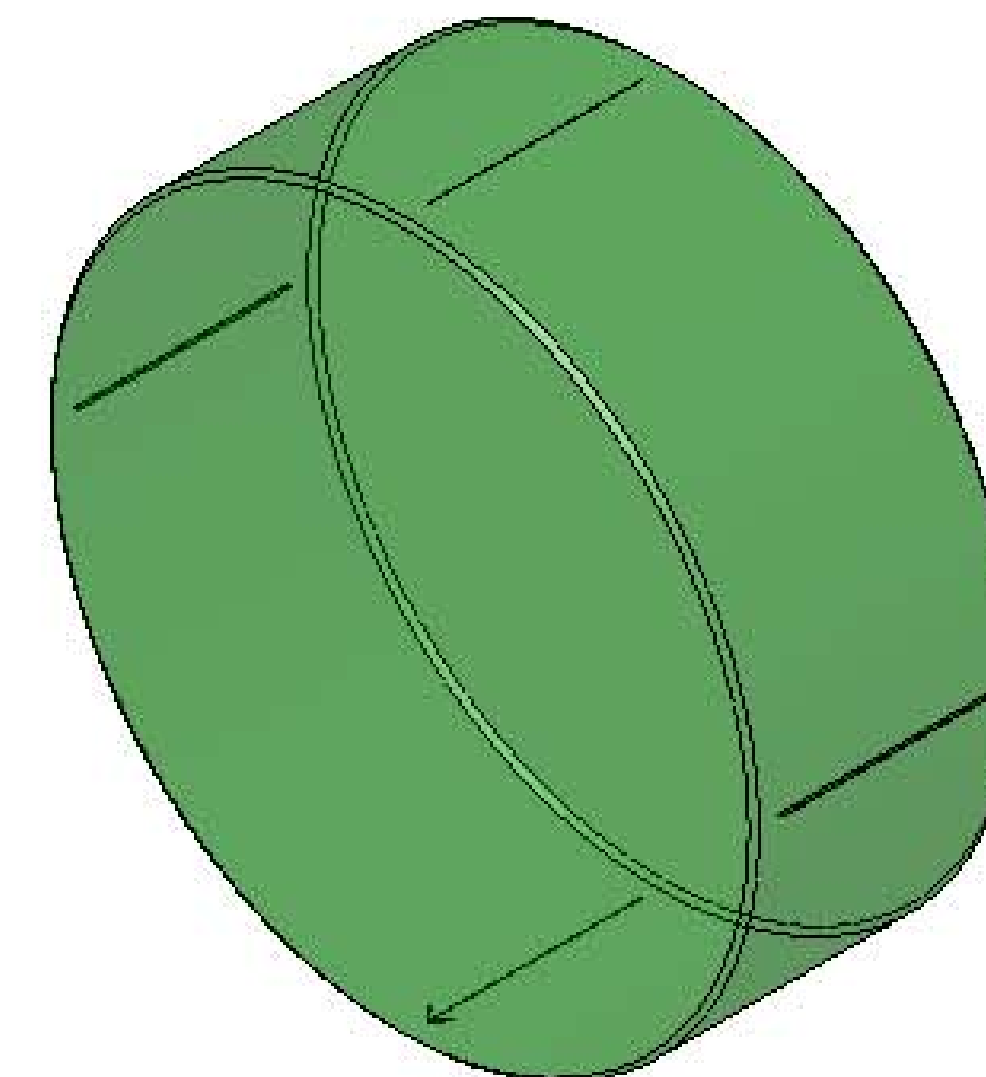

**MANUFACTURING NOTES:**

- DO NOT SCALE FROM DRAWING.
- INTERPRET DRAWING AS PER ANSI Y14.5M 1994.
- BARREL SIDE AND BEVEL POLISH PER E080518-v1.
- FINISH SURFACES 'S1' AND 'S2' AS PER E080518-v1.
- REFER TO E080518-v1 FOR MORE INFORMATION ON SERIAL NUMBER.

**PARTS LIST**

REF	DESCRIPTION	PART NAME
REF E080041-v1		SR3

**FINISH** SEE NOTES **PART NAME** SR3 SUBSTRATE

NAME	DATE	SIZE	DWG. NO.	REV.
DRAWN C. TORRE	11-Nov-08	D	D080664	v1
CHECKED D. COYNE	10-Nov-08			
CHECKED G. GUARACINO	10-Nov-08			
APPROVED D. COYNE	11-Dec-08			

SCALE: 1:2 PROJECTION: SHEET 1 OF 1