

ALTERNATE 1 NOTE:
 AIRLOCK WITH EXTERIOR ROLLUP DOOR AND MAN DOOR, CONCRETE PAD EXTENSIONS ARE TO BE BID AS ALTERNATE 1.
 DELETE STRIP CURTAINS AND SUPPORTS IDENTIFIED AS "ALT 1 DELETE" AS PART OF ALTERNATE 1.

- CONSTRUCTION NOTES:**
- 1 5/8" GWB ON 6" METAL FRAMING SPACED 16" OC. INSULATE WITH 6" FIBERGLASS BATT (R-19). PROVIDE ACCESS COVER FOR EQUIPMENT REQUIRING ACCESS, SUCH AS JUNCTION BOXES.
 - 2 PARTITION WALL BETWEEN AREAS SHALL BE EXTENDED TO THE ROOF AND SEALED TIGHT, INSULATED (R-19) FINISH TAPED, BOTH SIDES, AND PAINTED BOTH SIDES WITH SEMIGLOSS LATEX ENAMEL.
 - 3 PERIMETER WALL SHALL BE EXTENDED TO THE ROOF AND SEALED TIGHT, FINISH TAPED, AND PAINTED WITH SEMIGLOSS LATEX ENAMEL.
 - 4 POSITION NEW WALL AGAINST FLANGE OF SUPPORT COLUMNS AND BEAMS.
 - 5 BUILD INTERIOR WALL OVER FACE OF EXISTING ROLL UP DOOR. ATTACH ADDITIONAL LAYER OF INSULATION ON INSIDE FACE OF DOOR. DEMOLISH EXISTING SUPPORT RAILS FOR THIS DOOR.
 - 6 5/8" GWB ON 6" METAL FRAMING SPACED 16" OC. INSULATE WITH 6" FIBERGLASS BATT (R-19). FINISH TAPE AND PAINT INTERIOR SURFACE WITH SEMIGLOSS LATEX ENAMEL. MATCH EXTERIOR SIDING TO EXISTING.
 - 7 6" CONCRETE SLAB WITH #4 AT 18" OC ON 4" OF 5/8" MINUS CRUSHED GRAVEL ON COMPACTED SUBBASE.
 - 8 PROVIDE 6"Wx4"H CURB/BASE AT AIRLOCK WALLS.
 - 9 INSTALL NEW 3'Wx7'H EXTERIOR METAL DOOR AND FRAME. PAINT WHITE OR AS OTHERWISE DIRECTED BY OWNER. DOOR HARDWARE SHALL BE OF MATCHING STYLE AND QUALITY TO EXISTING.
 - 10 INSTALL NEW 12'Wx10'H ROLL UP DOOR. (CITY GATES R-8.7 INSULATED, WITH CHAIN PULL, PH 1-718-939-9700). DEMO EXISTING RAILS. SEE DET B, DWG 027.
 - 11 COAT FLOOR WITH 2 COATS EPOXY FLOOR COATING. 65% SOLIDS CONTENT OR APPROVED EQUAL.
 - 12 DUCT CHASE TO 12'-6" ABOVE FLOOR. COORDINATE CONSTRUCTION TO ACCOMMODATE 12"x18" DUCT WITHIN CHASE. (TYP OF 4-NOTE ROTATED DUCT ORIENTATION IN 2 CHASES.)
 - 13 PLACE TENSION CABLES IN "X" PATTERN BETWEEN COLUMNS. RELOCATE FROM ADJACENT BAY.
 - 14 BUILD WALL OFFSET TO ACCOMMODATE TENSION CABLES.
 - 15 REPAIR AND RESEAL ALL EXISTING INSULATION BATTS THROUGHOUT BUILDING.
 - 16 RELOCATE TENSION CABLES TO ADJACENT BAY.
 - 17 RESEAL AND PLUG ALL CORRUGATED ROOF END OPENINGS.
 - 18 SEAL CAVITY BETWEEN ASPHALT AND CONCRETE AT BUILDING FOUNDATION.
 - 19 STRIP CURTAIN: SEE DRAWING 026 FOR SUPPORT DETAILS.

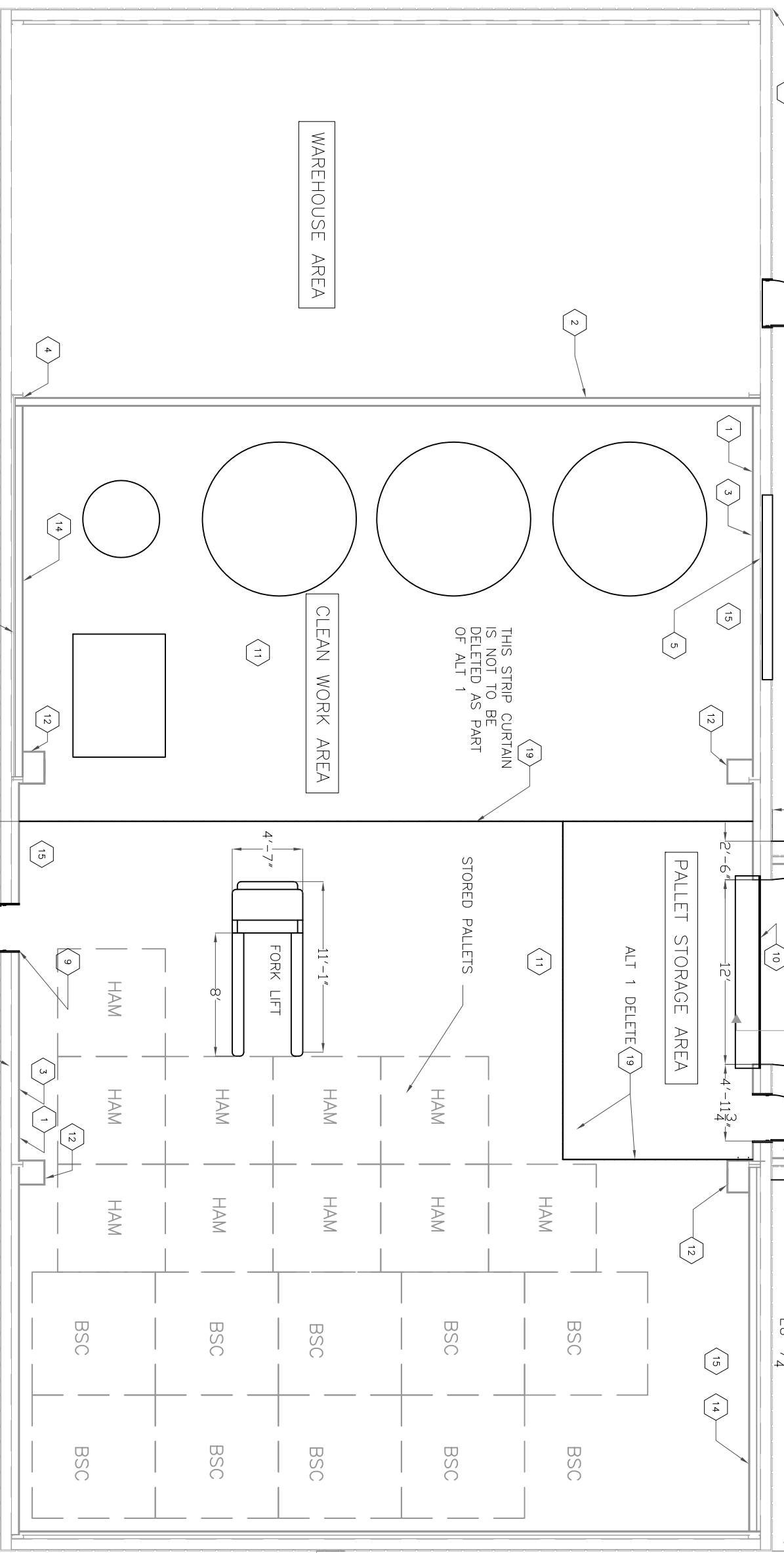

FLOOR PLAN
 SCALE: 1/4" = 1'-0"

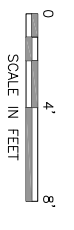

LIGO HANFORD OBSERVATORY
 DRAWING: LIGO-D0810022-V1
HIBBS ENGINEERING, INC.
 KENNEWICK, WASHINGTON

LHO WAREHOUSE
 ARCHITECTURAL PLAN

PROJECT NUMBER: 1023.010
 CAD FILE: 0000A01.DWG

© 2008 Hibbs Engineering, Inc.

DRAWN BY: GLH
 CHECKED BY:
 DESIGN A/E DESIGN GM
 HBI APPROVAL

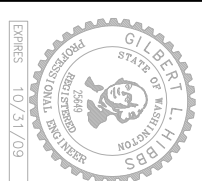

REV	DATE	BY	DESCRIPTION	APPROVED

DRAWING NUMBER
 022
 REV
 V1