

- REFER TO DOCUMENT D1101271 FOR OPTICAL TABLE HOLE TABULATION CONVENTION.
- REFER TO G1000125 FOR ISI NAMING AND ORIENTATION CONVENTION.

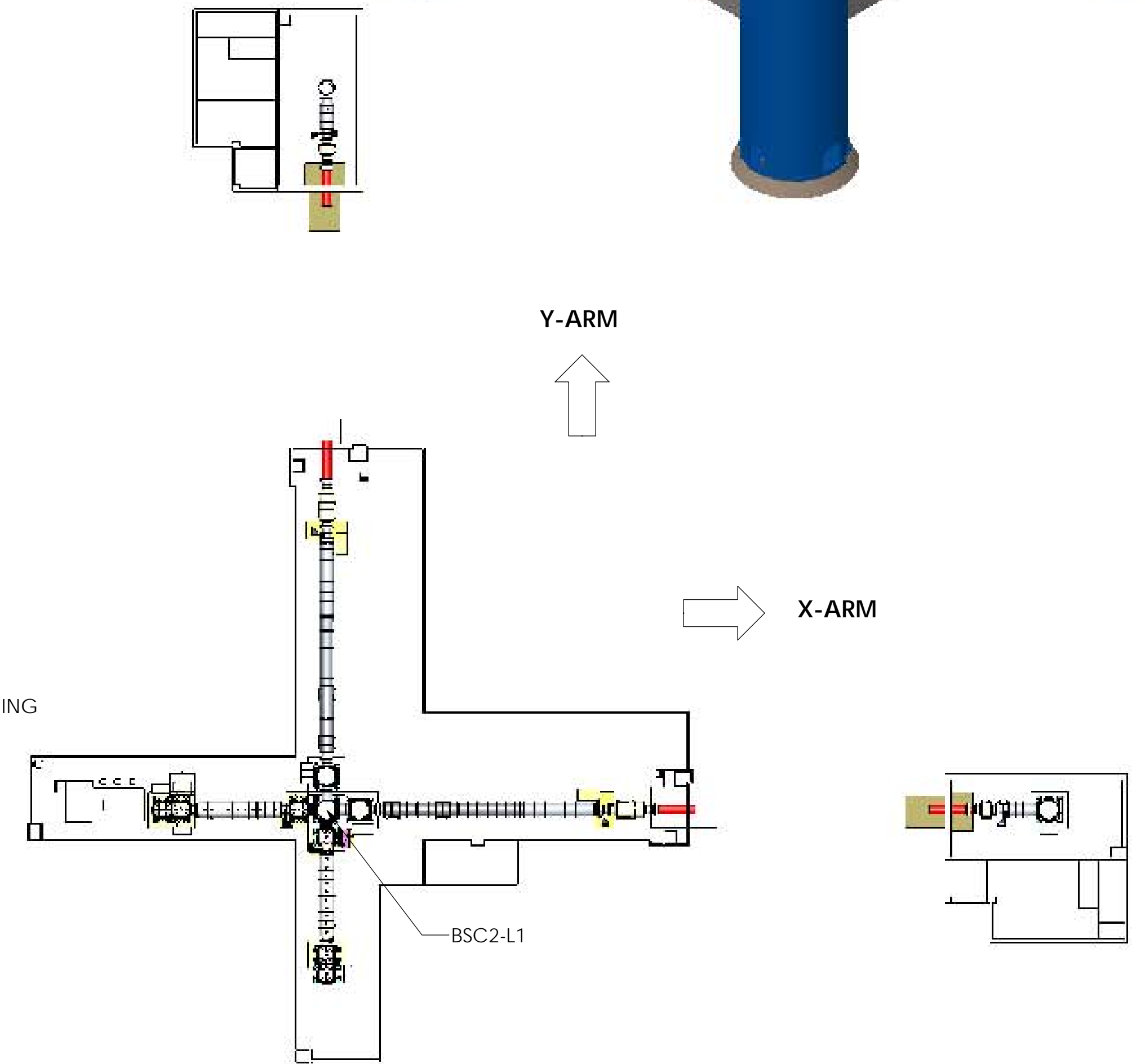
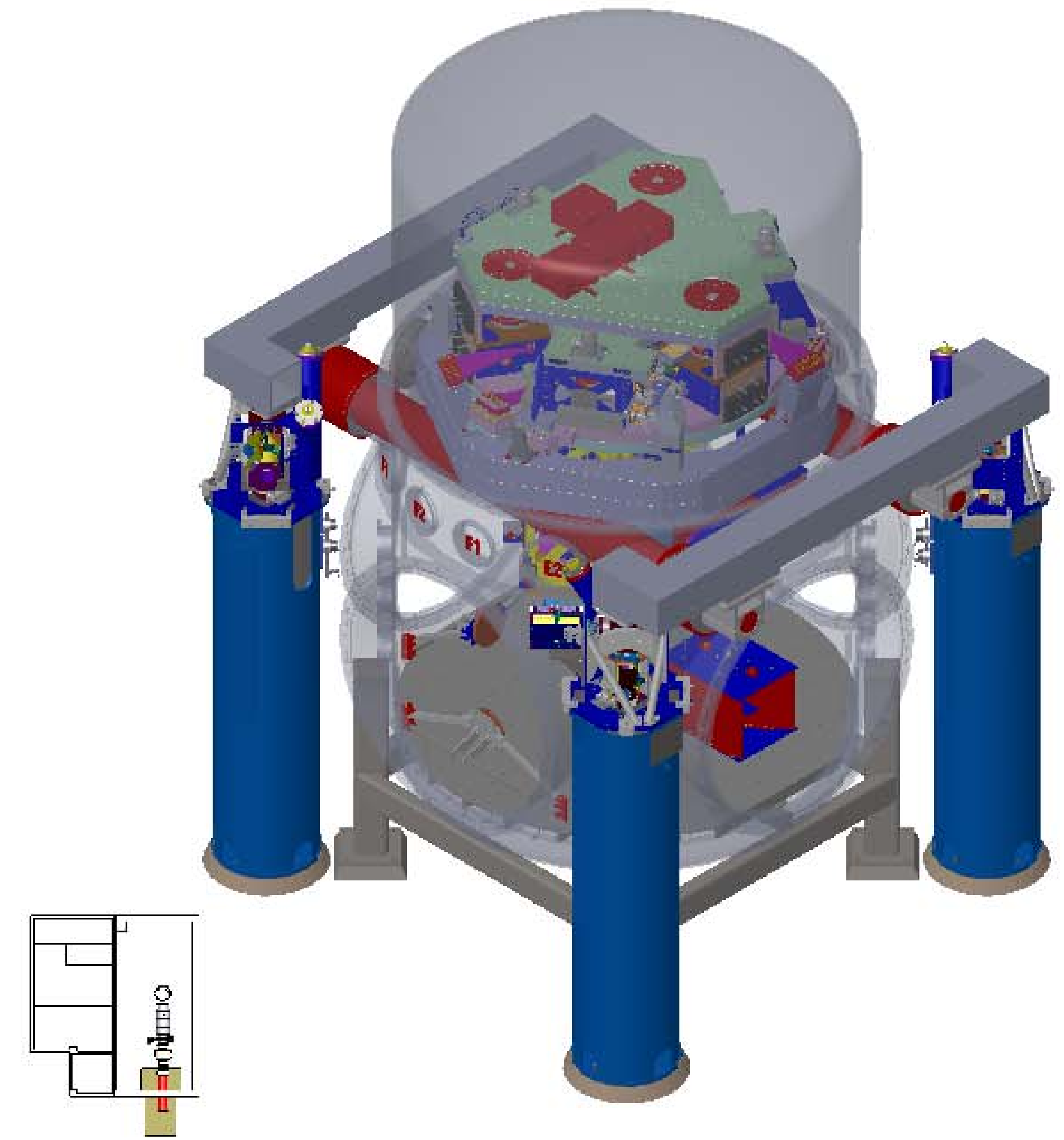
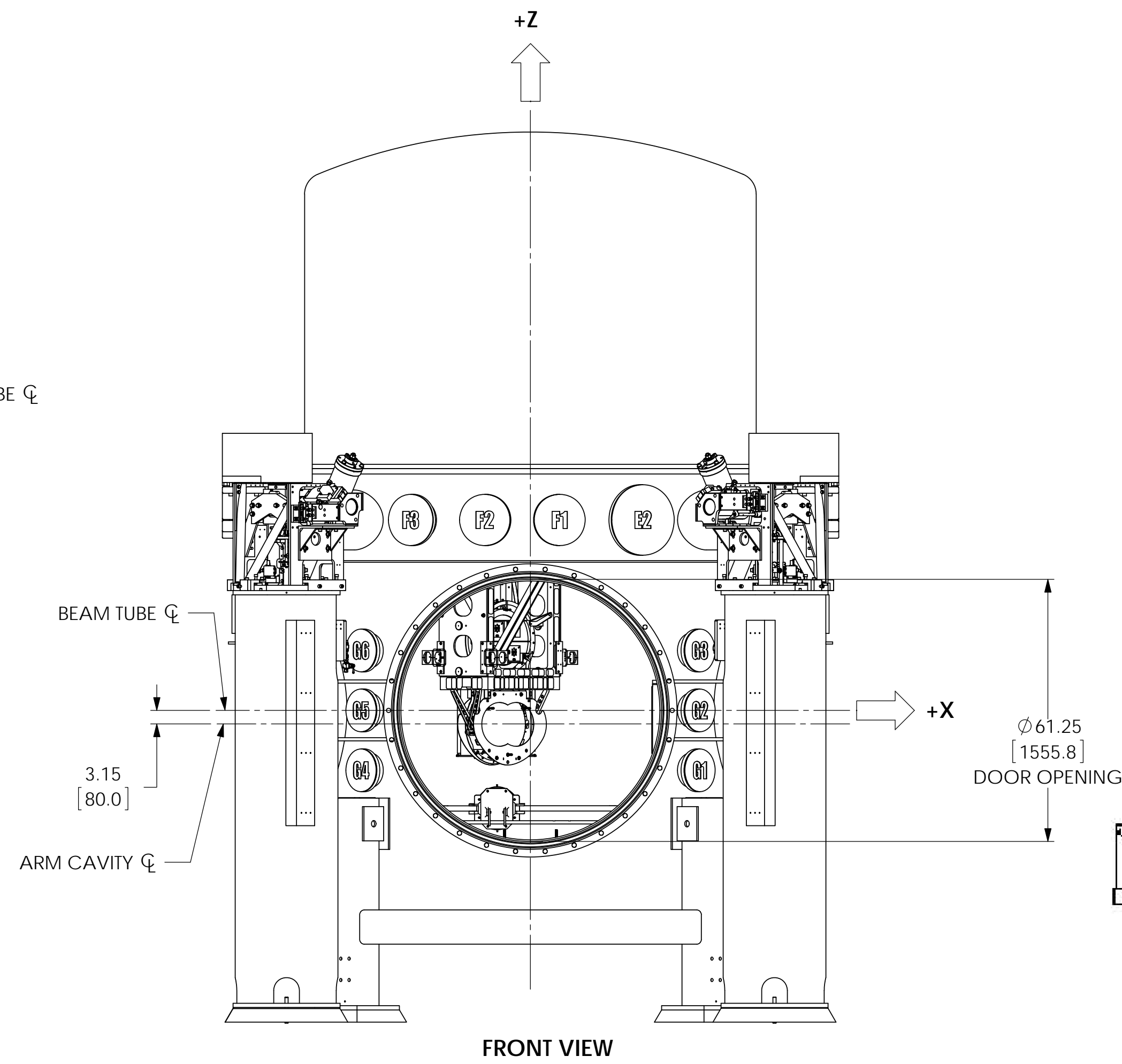
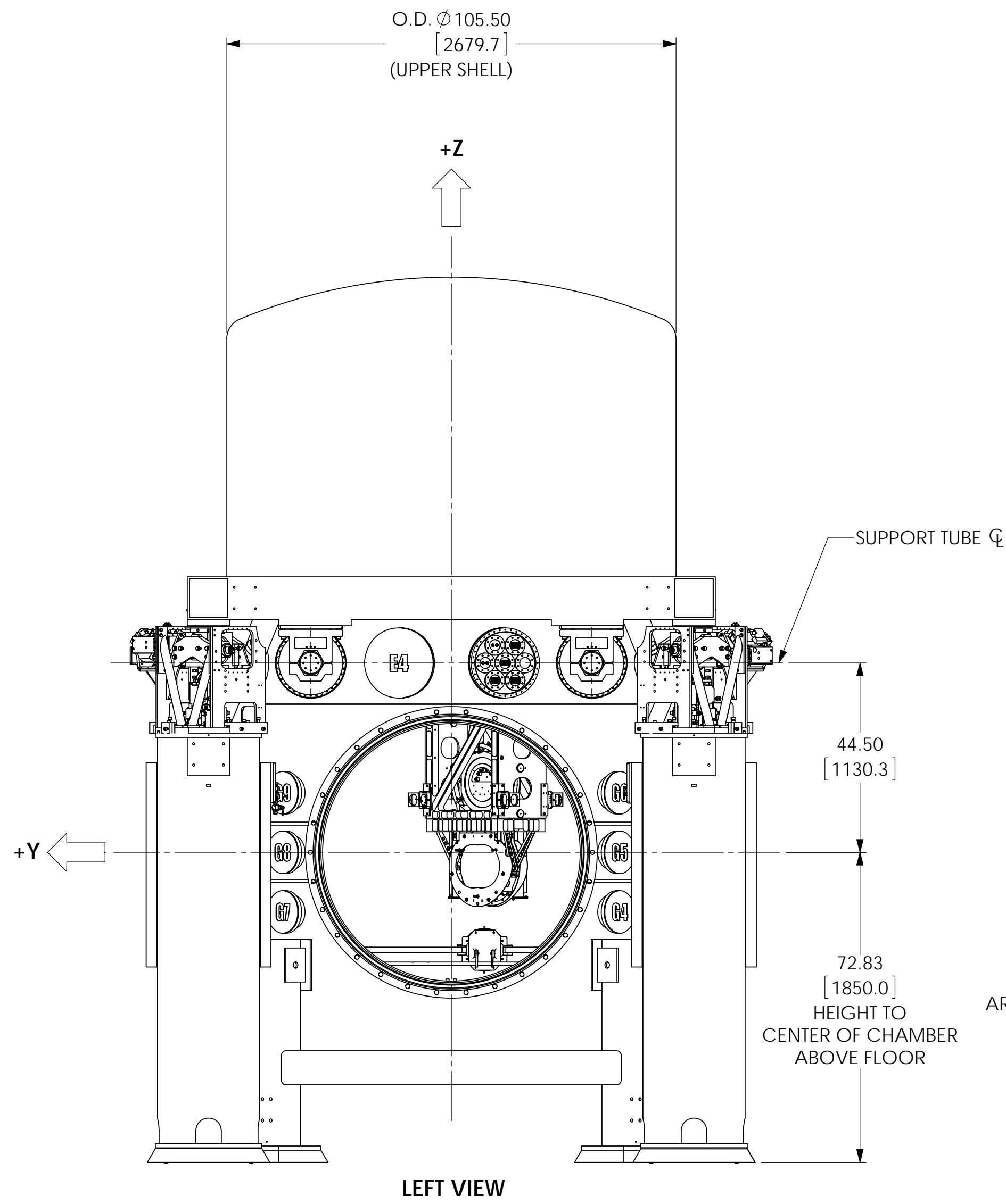
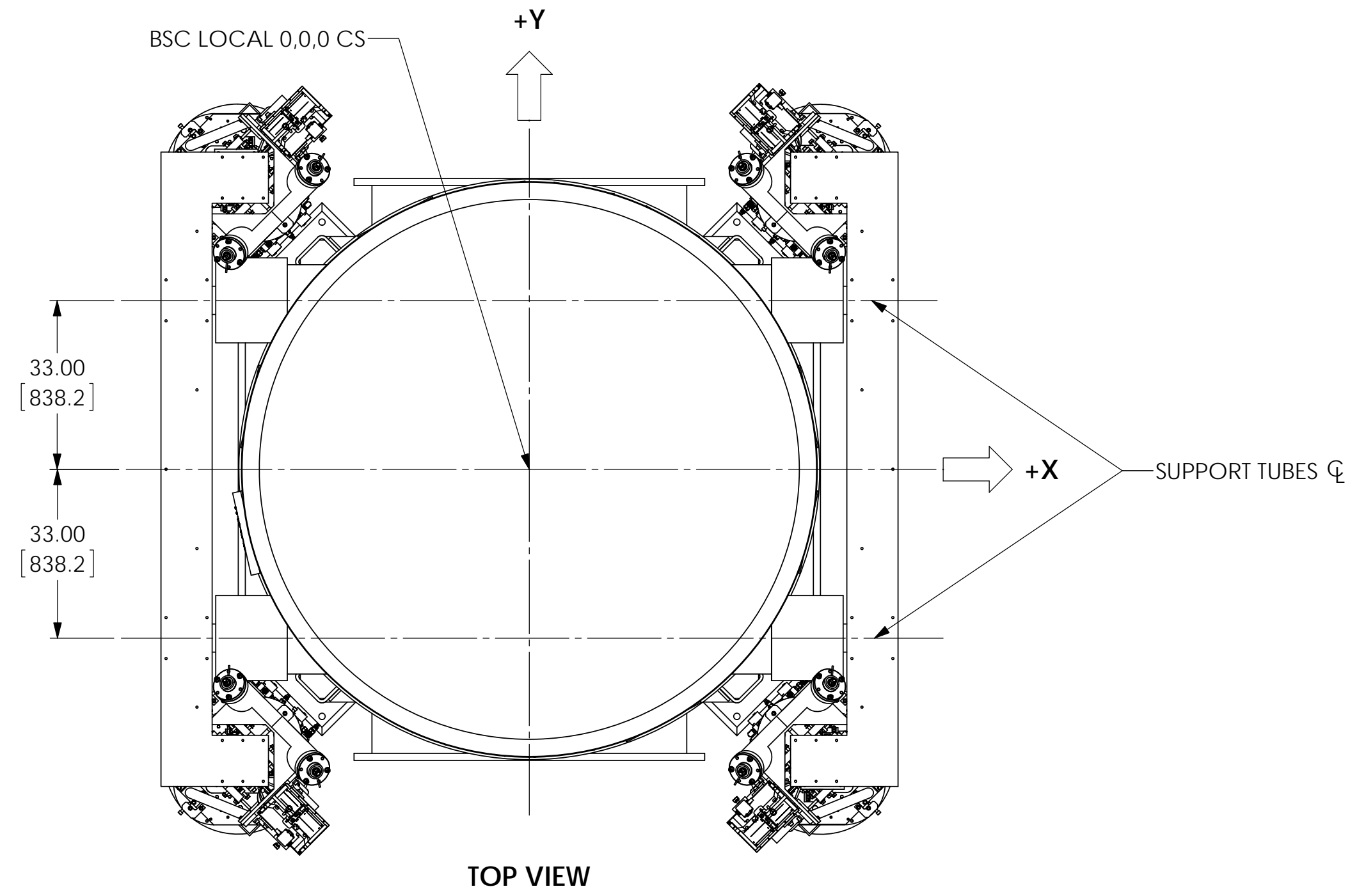

NOTES AND TOLERANCES: (UNLESS OTHERWISE SPECIFIED)	
1. INTERPRET DRAWING PER ASME Y14.5-1994.	
2. REMOVE ALL SHARP EDGES, .005-.015, FOR MACHINED PARTS. ROUND ALL EDGES APPROXIMATELY R.02 FOR SHEET METAL PARTS.	
3. DO NOT SCALE FROM DRAWING.	
4. ALL MACHINING FLUIDS MUST BE FULLY SYNTHETIC, FULLY WATER SOLUBLE AND FREE OF SULFUR, SILICONE, AND CHLORINE.	
DIMENSIONS ARE IN INCHES [MM]	
TOLERANCES:	
.XX ± .01	
.XXX ± .005	
ANGULAR ± 0.5°	
MATERIAL	--
FINISH	-- μ inch

CALIFORNIA INSTITUTE OF TECHNOLOGY MASSACHUSETTS INSTITUTE OF TECHNOLOGY	
SYSTEM	ADVANCED LIGO
SUB-SYSTEM	SUS
NEXT ASSY	

PART NAME		BSC2-L1 TOP LEVEL CHAMBER ASSEMBLY, FULLY DEFINED	
DESIGNER		SIZE	DWG. NO.
DRAFTER	ED CHAVEZ	13 JUN 2012	
CHECKER		D	D0900428
APPROVAL		SCALE: 1:24	PROJECTION:
			SHEET 1 OF 3

A B C D E F G H

H

G

F

E

D

C

B

A

8 7 6 5 4 3 2 1

D0900428 AdvLIGO Systems: BSC2-L1 Top Level Chamber Assembly: PART PDM REV: X-09: DRAWING PDM REV: X-005

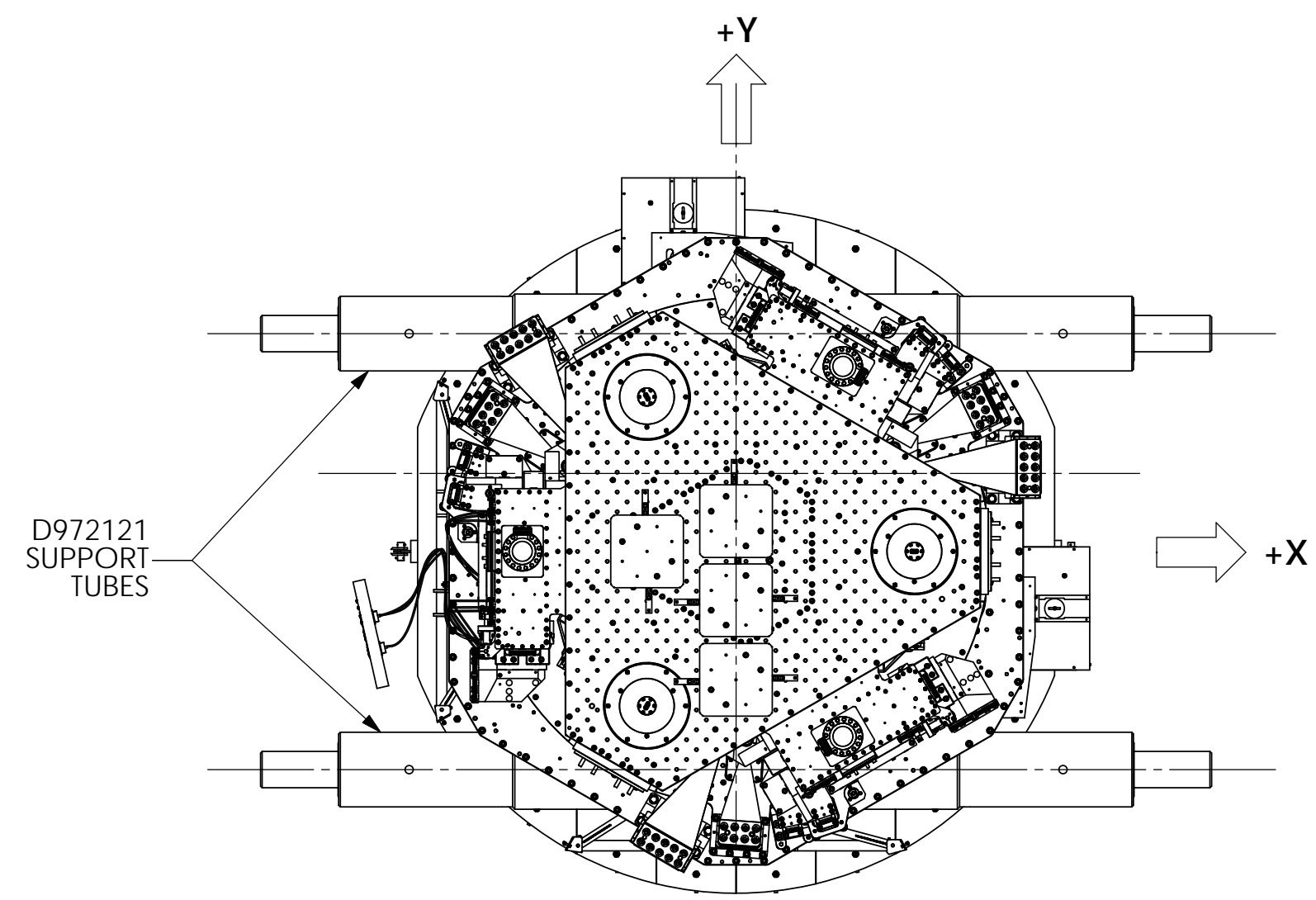

TOP VIEW

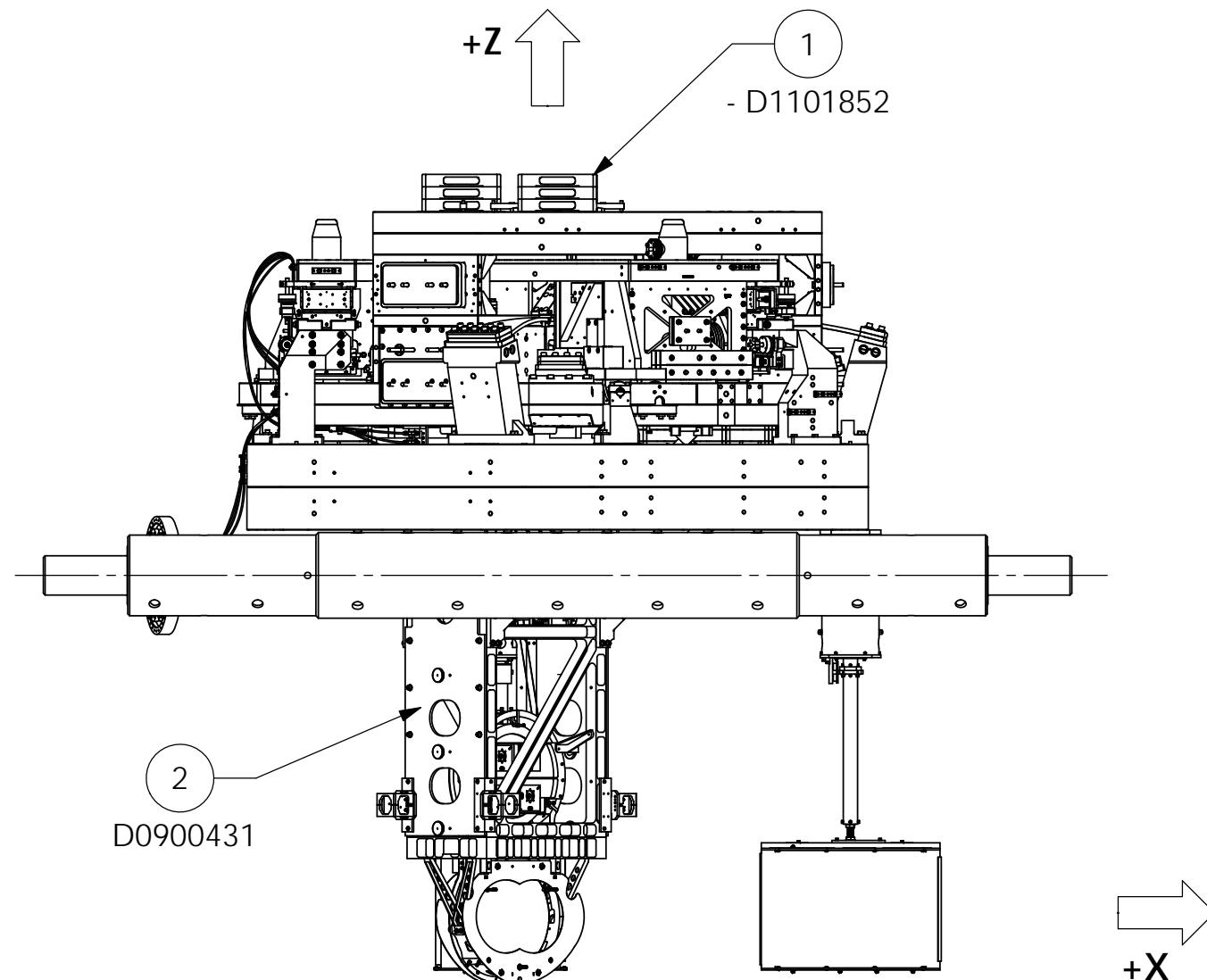

FRONT VIEW

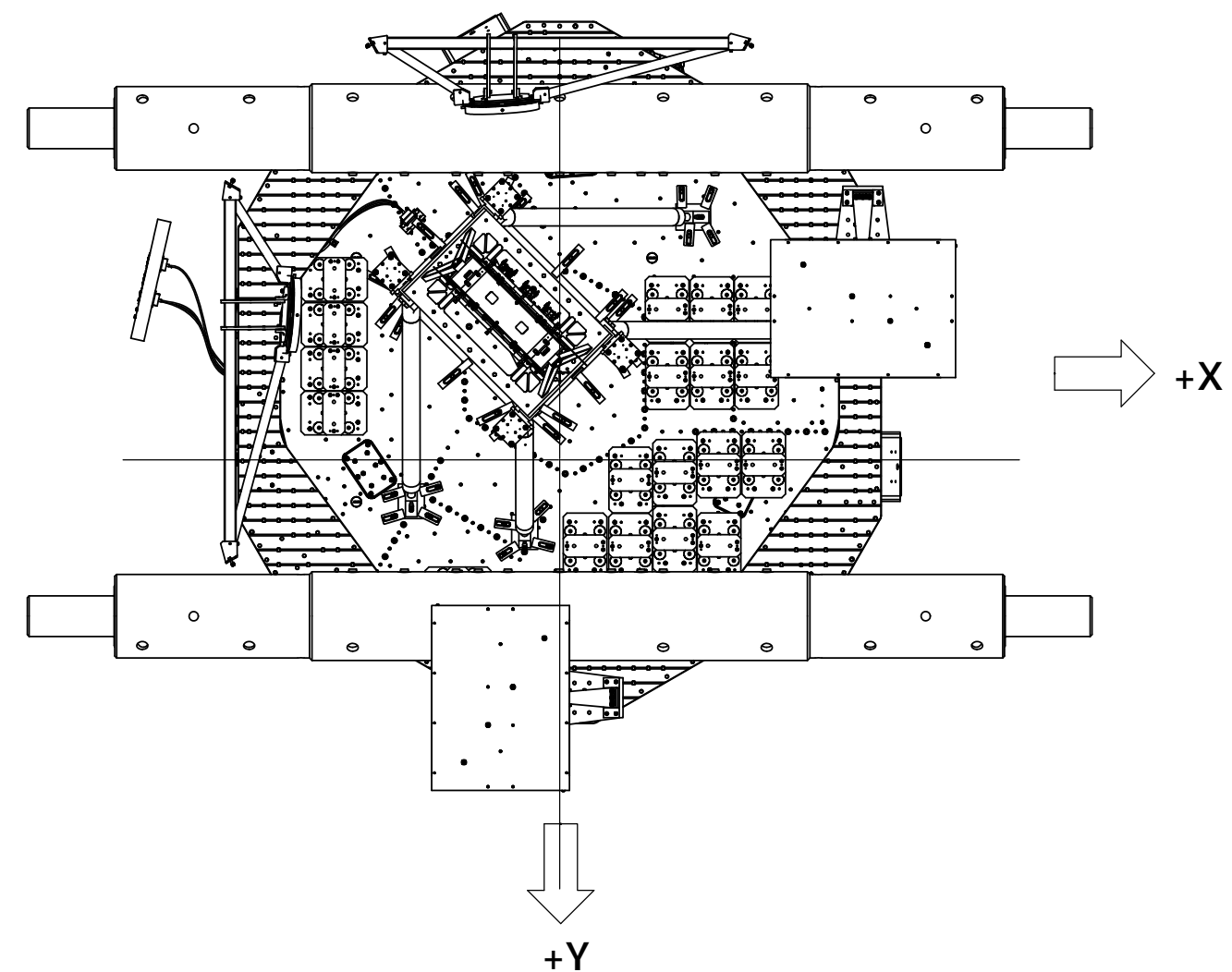

BOTTOM VIEW

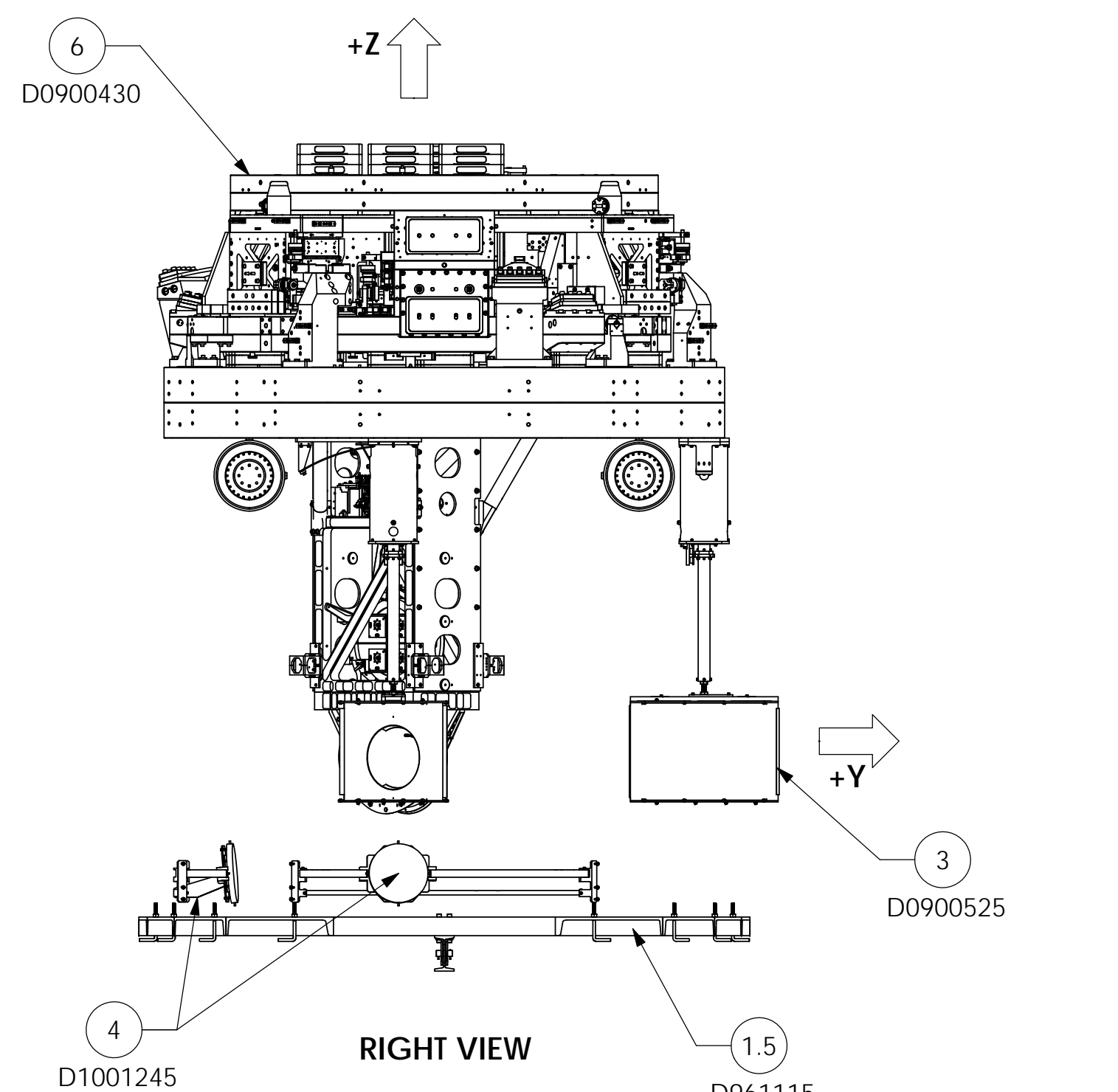

RIGHT VIEW

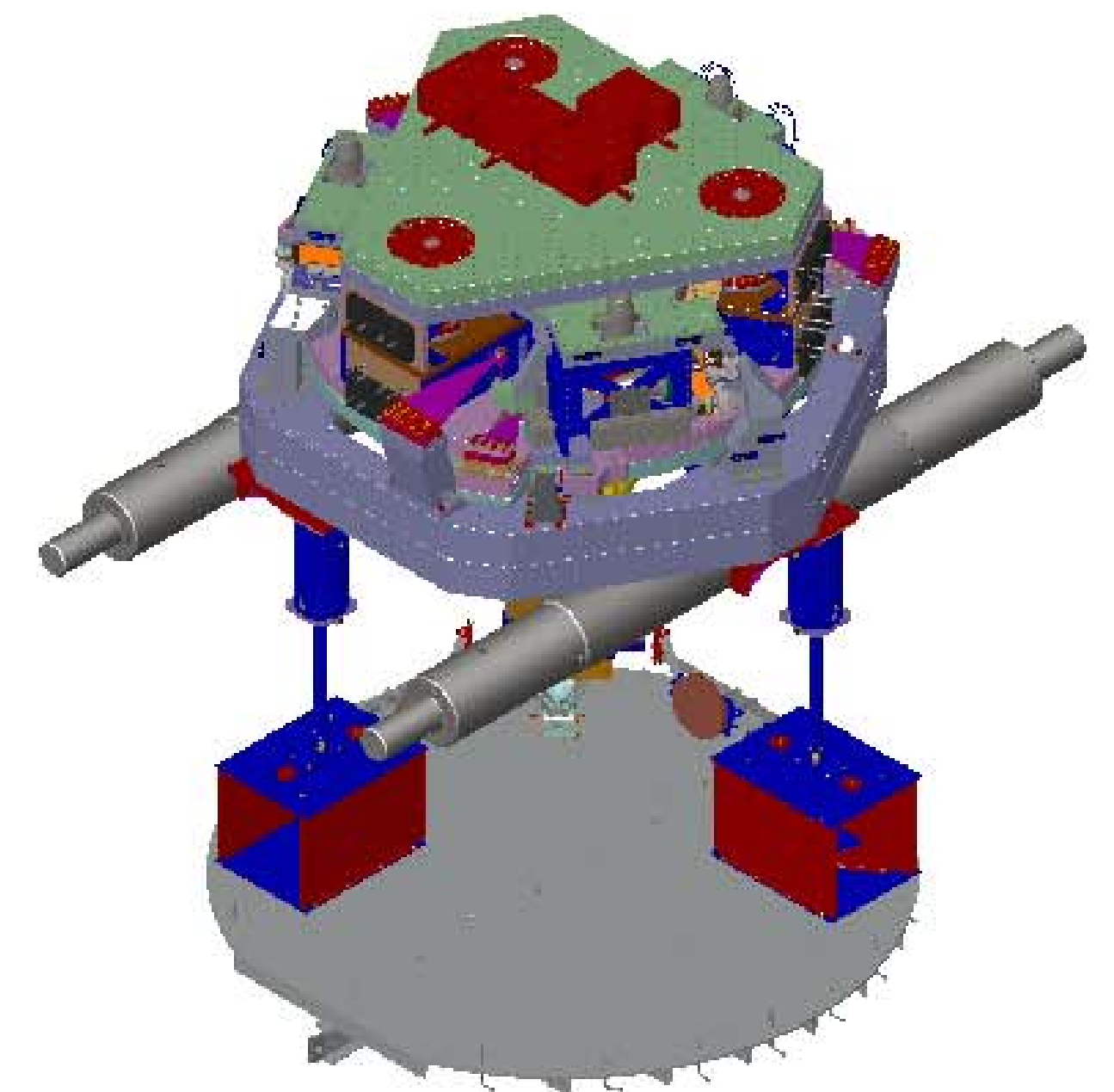

ITEM NO.	PART NUMBER	DESCRIPTION	QTY
8	D1200060	ALIGO, CABLE HARNESS ROUTING, BSC-2	1
7	D1000513	HEPI ASSEMBLY, BSC aLIGO	1
6	D0900430	AdvLIGO SEI BSC2-L1, XYZ Local CS for ISI Table	1
5	D0900429	AdvLIGO VE BSC2-L1, Vacuum Equipment Assembly	1
4	D1001245	AdvLIGO SUS, BSC2-H1 Local CS for CO2 IIM Steering Mirror	1
3	D0900525	AdvLIGO SUS BSC2-L1, XYZ Local CS for Elliptical Baffle (ITMX,ITMY)	1
2	D0900431	AdvLIGO SUS BSC2-L1, XYZ Local CS for BS HR	1
1	D1101852	AdvLIGO BSC2-L1 ISI Table, Payload & Suspended Masses Assy	1

LIGO CALIFORNIA INSTITUTE OF TECHNOLOGY
MASSACHUSETTS INSTITUTE OF TECHNOLOGY

SIZE DWG. NO. REV.
D D0900428 v6

SCALE: 1:24 PROJECTION: SHEET 2 OF 3

D0900428 AdvLIGO Systems, BSC2-L1 Top Level Chamber Assembly, PART PDM REV. X-069, DRAWING PDM REV. X-005

8 7 6 5 4 3 2 1

H G F E D C B A

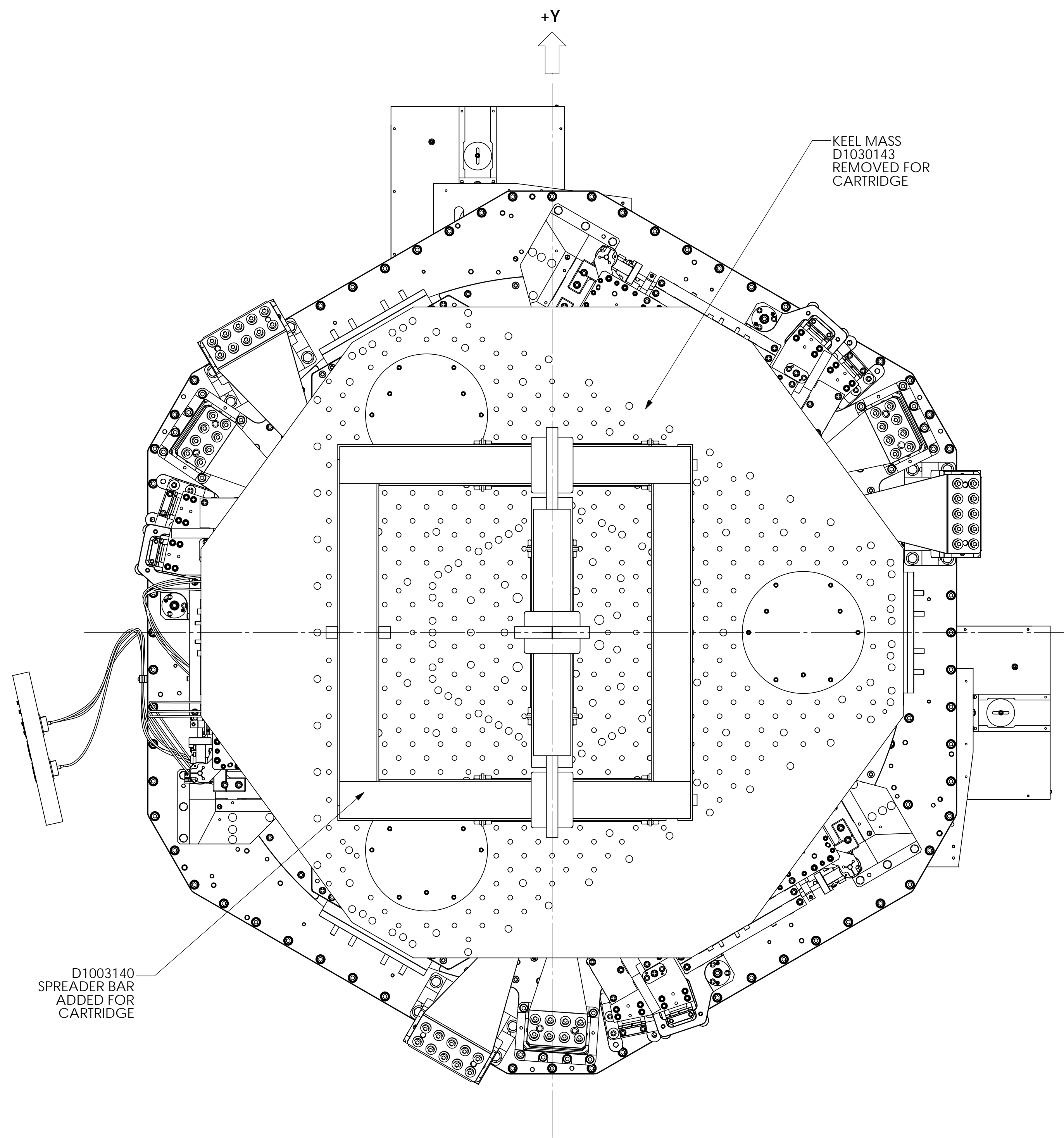

D1003140
SPREADER BAR
ADDED FOR
CARTRIDGE

KEEL MASS
D1030143
REMOVED FOR
CARTRIDGE

TOP VIEW
(LOOKING DOWN)
CARTRIDGE ASSY.
CONFIGURATION
(KEEL MASS REMOVED)

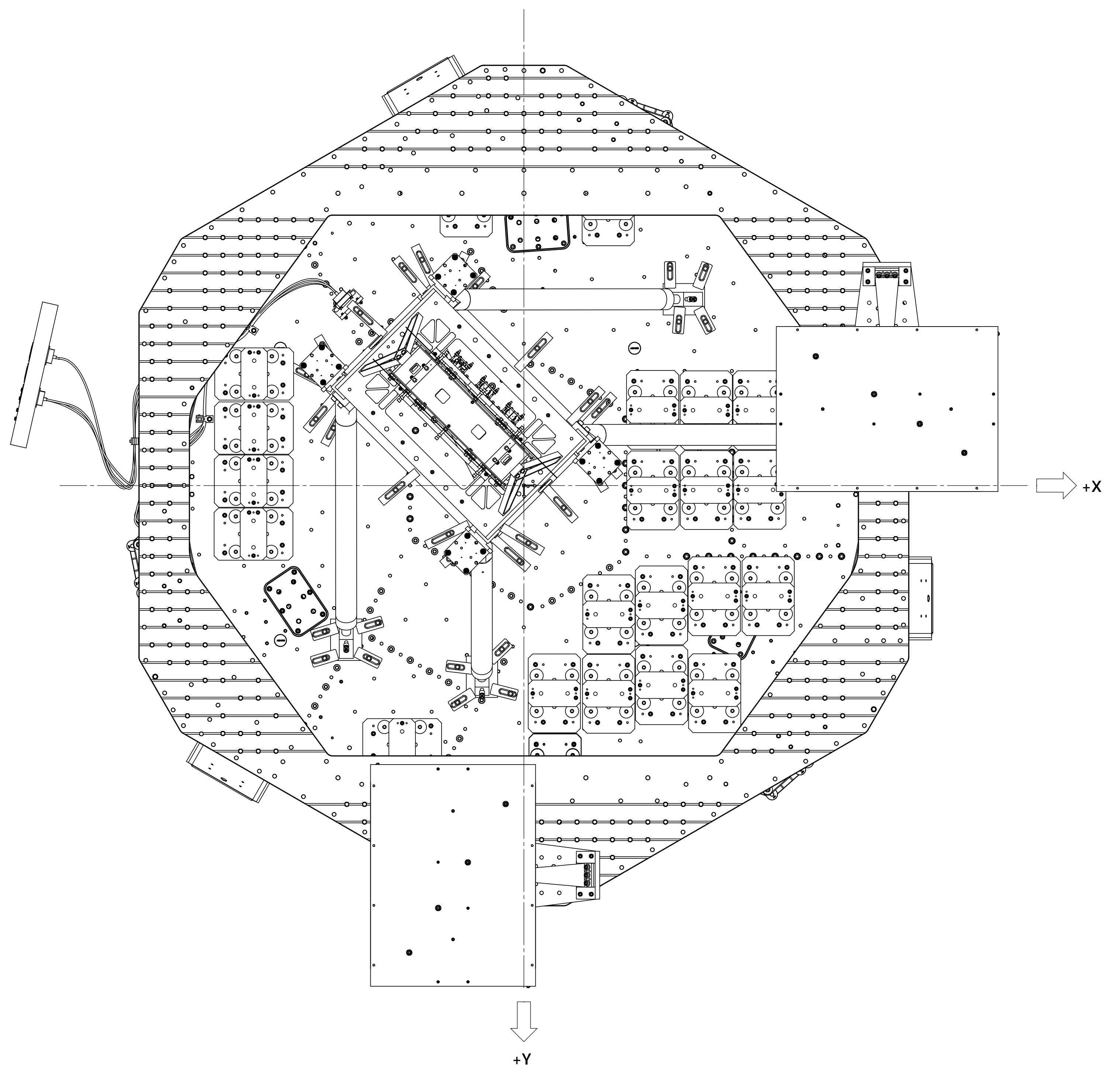

BOTTOM VIEW
(LOOKING UP)

LIGO CALIFORNIA INSTITUTE OF TECHNOLOGY MASSACHUSETTS INSTITUTE OF TECHNOLOGY		
SIZE	DWG. NO.	REV.
D	D0900428	V6
SCALE: 1:8	PROJECTION:	SHEET 3 OF 3

8 7 6 5 4 3 2 1

D0900428 Asm LIGO Systems: BSC2-1.1 Top Level Chamber Assembly: PART PDM REV: X-069: DRAWING PDM REV: X-005