

5. REFER TO DOCUMENT D1101271 FOR OPTICAL TABLE HOLE TABULATION CONVENTION.
6. REFER TO G1000125 FOR ISI NAMING AND ORIENTATION CONVENTION.

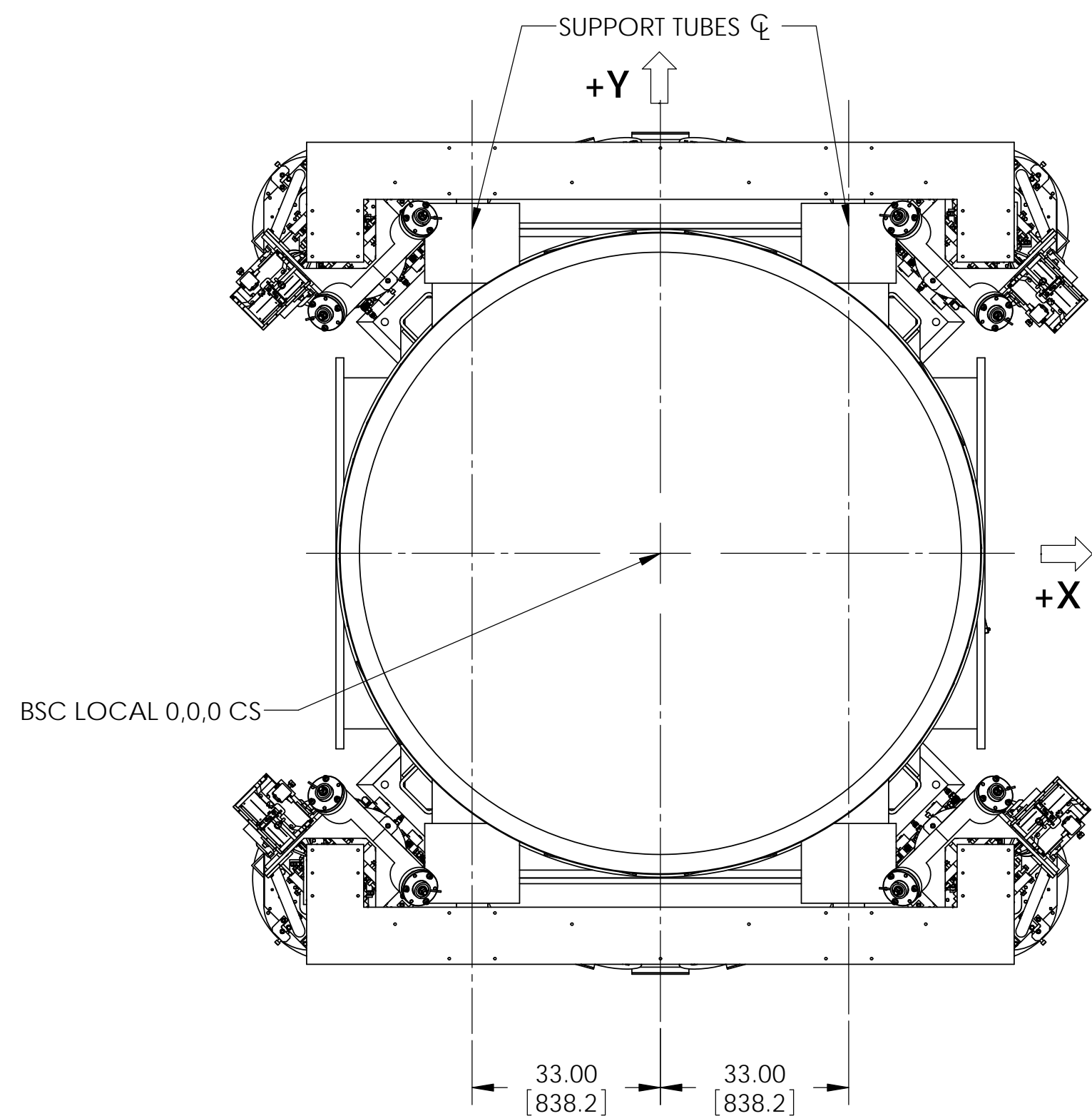

TOP VIEW

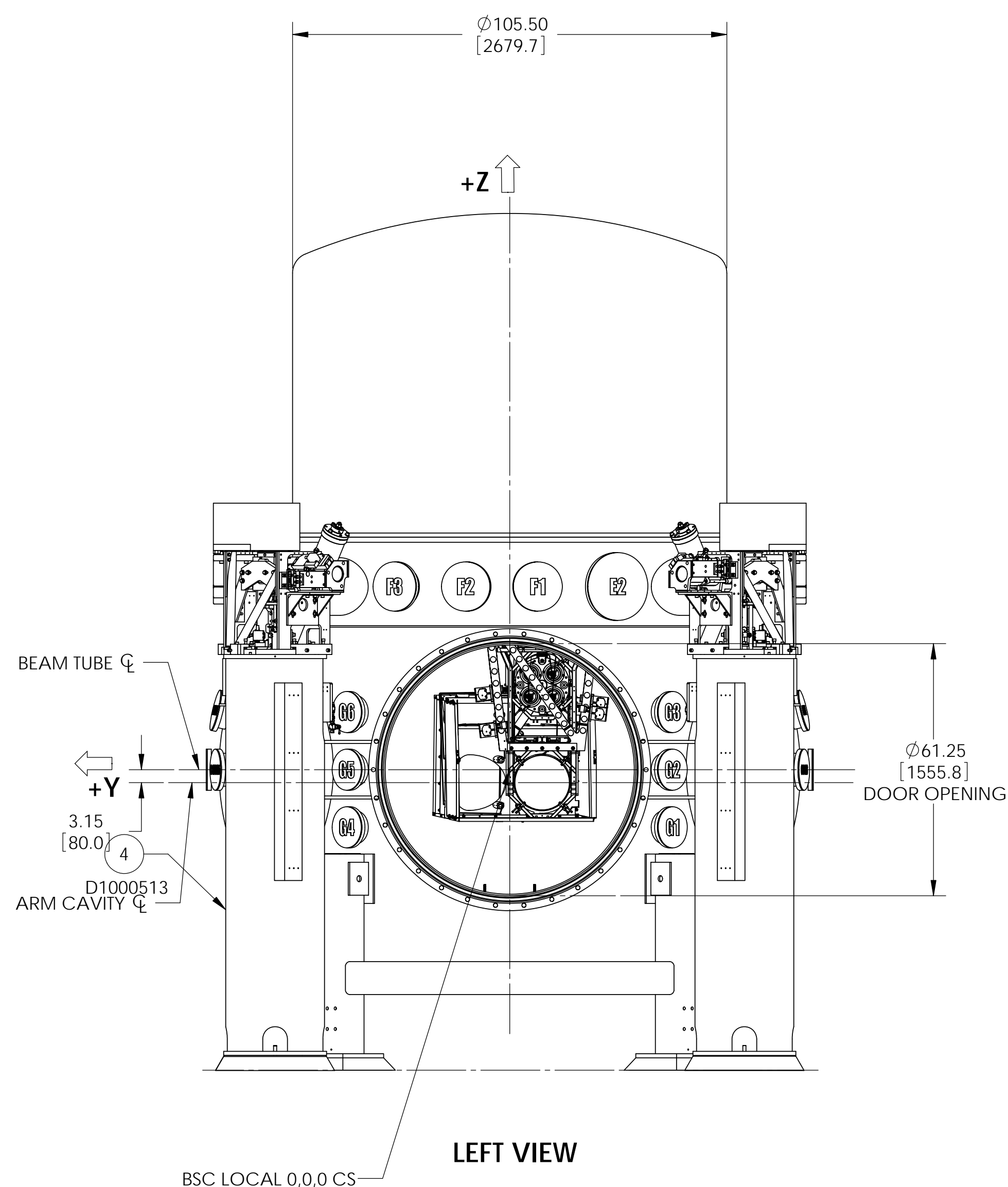
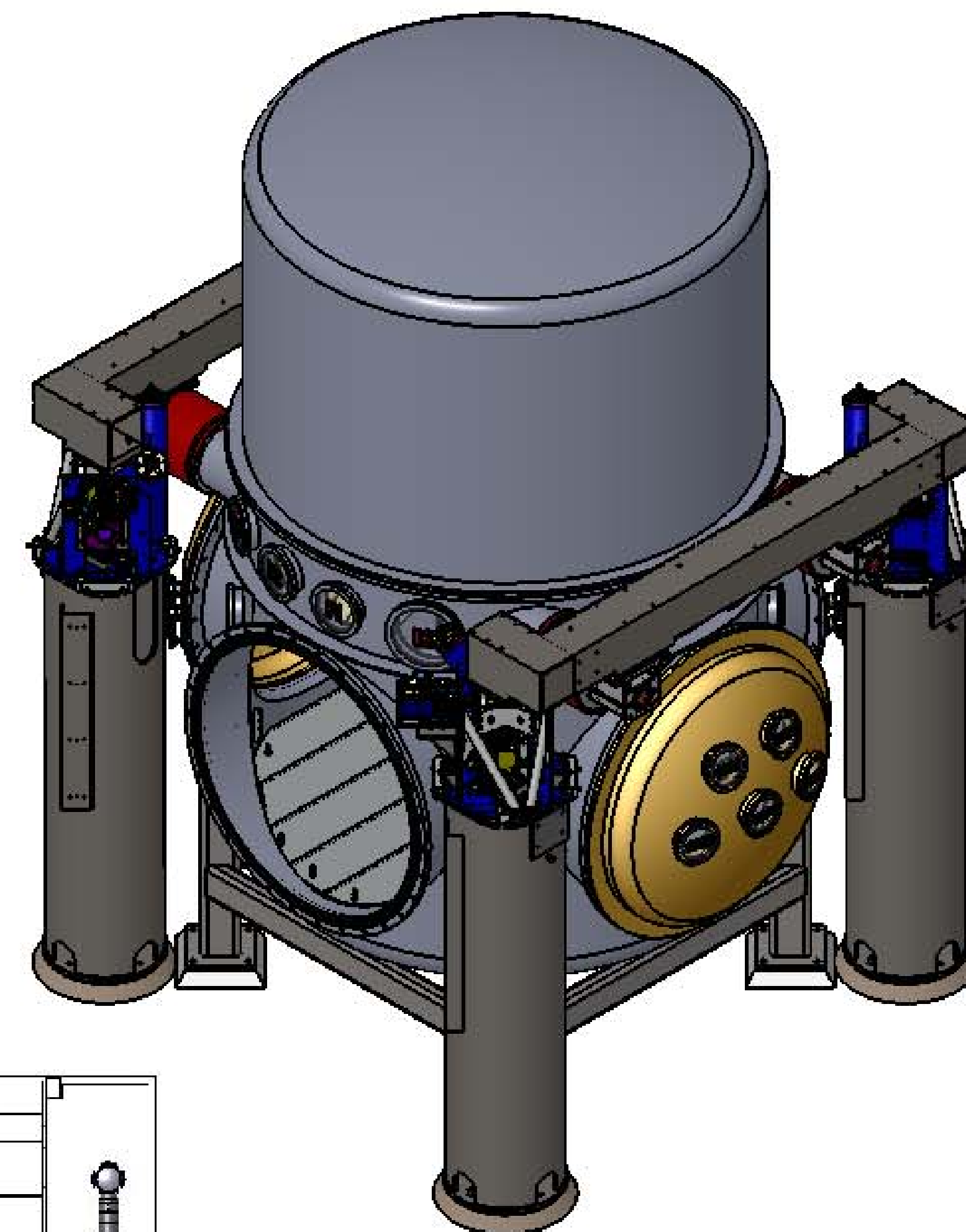

LEFT VIEW

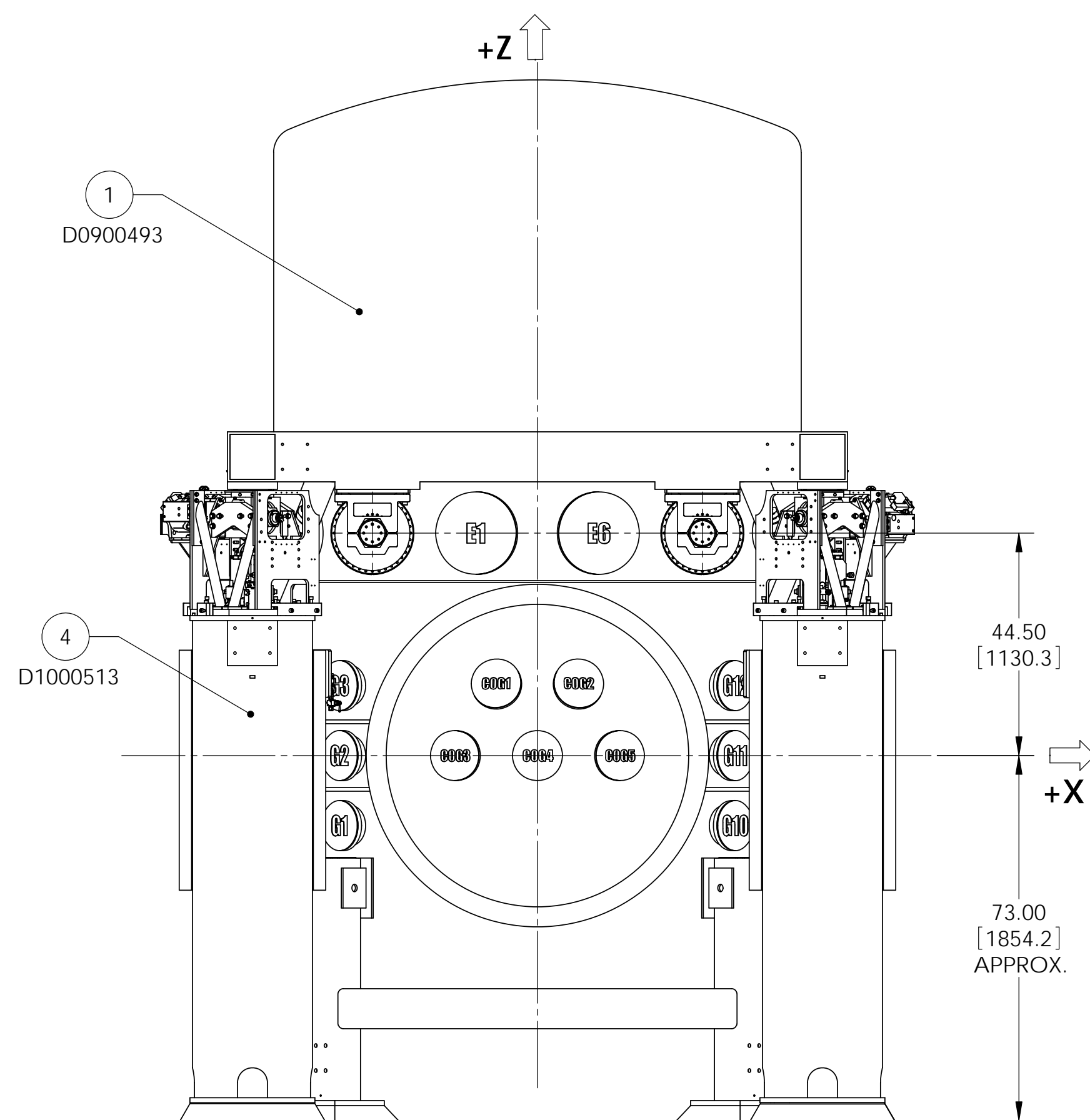

FRONT VIEW

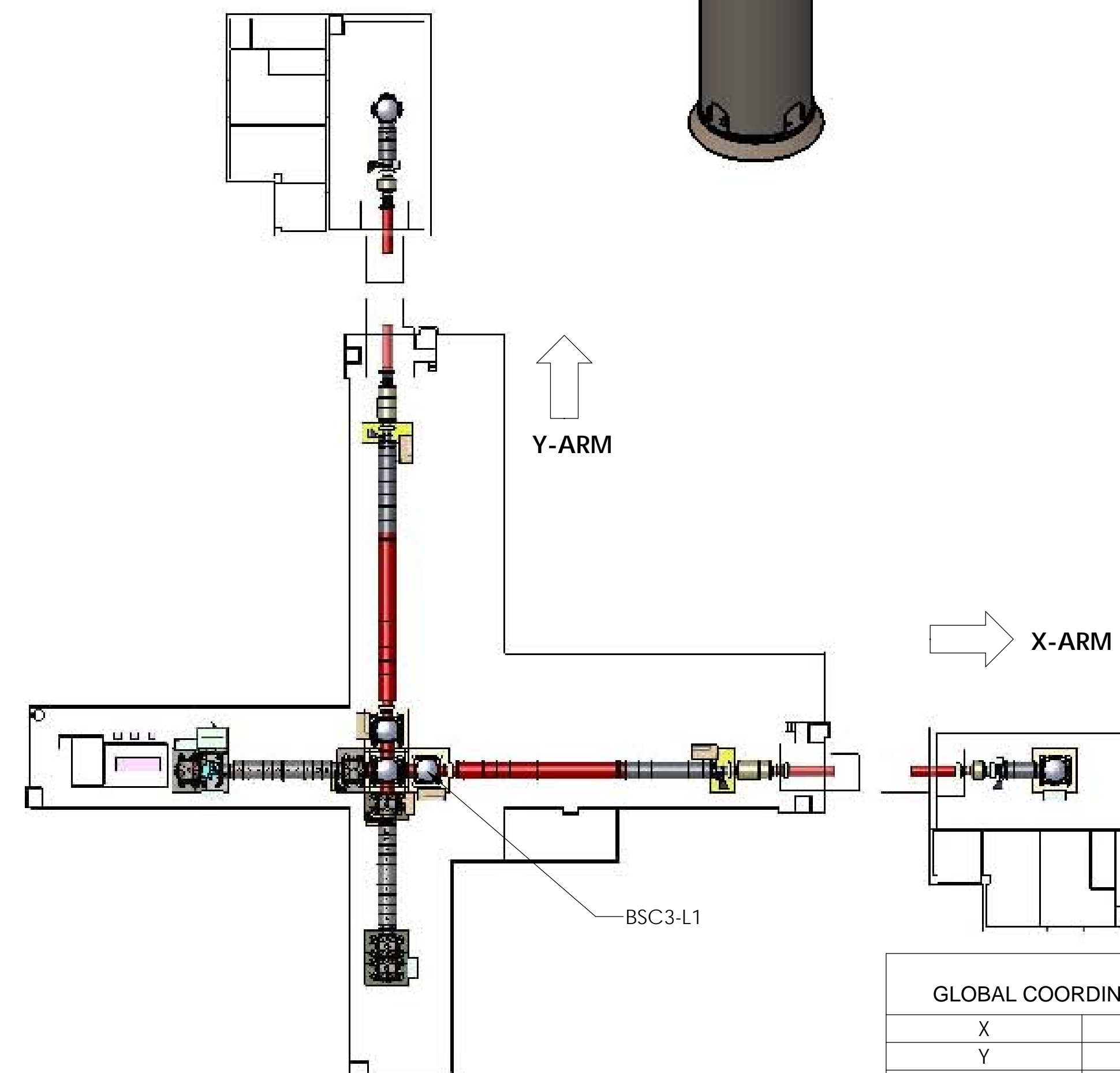

GLOBAL COORDINATES (mm)	
X	4580.0
Y	0.0
Z	0.0

NOTES AND TOLERANCES: (UNLESS OTHERWISE SPECIFIED)	
1. INTERPRET DRAWING PER ASME Y14.5-1994.	
2. REMOVE ALL SHARP EDGES, .005-.015, FOR MACHINED PARTS. ROUND ALL EDGES APPROXIMATELY R.02 FOR SHEET METAL PARTS.	
3. DO NOT SCALE FROM DRAWING.	
4. ALL MACHINING FLUIDS MUST BE FULLY SYNTHETIC, FULLY WATER SOLUBLE AND FREE OF SULFUR, SILICONE, AND CHLORINE.	
MATERIAL	FINISH
--	-- μ inch

LIGO CALIFORNIA INSTITUTE OF TECHNOLOGY MASSACHUSETTS INSTITUTE OF TECHNOLOGY	
SYSTEM	SUB-SYSTEM
ADVANCED LIGO	SUS
NEXT ASSY	

PART NAME		BSC3-L1 Top Level Chamber Assembly, Fully Defined	
DESIGNER	SIZE	DWG. NO.	REV.
DRAFTER	N. CUSTARD	05 OCT 2011	D
CHECKER			D0900492
APPROVAL			v5
SCALE: 1:24		PROJECTION:	SHEET 1 OF 3

D0900492 Asm LIGO Systems: BSC3-L1 Top Level Chamber Assembly, ALL PART FROM REV. X-038, DRAWING FROM REV. X-004

D972121
SUPPORT TUBES

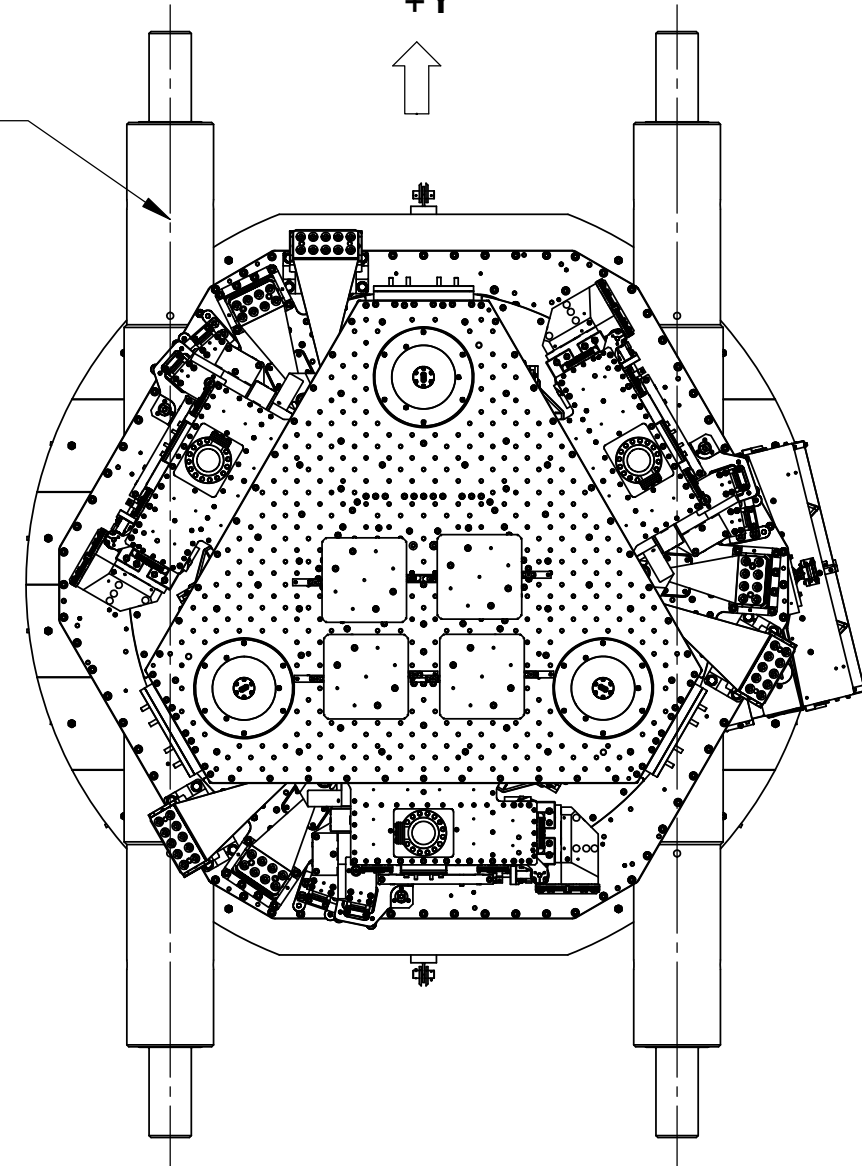

TOP VIEW

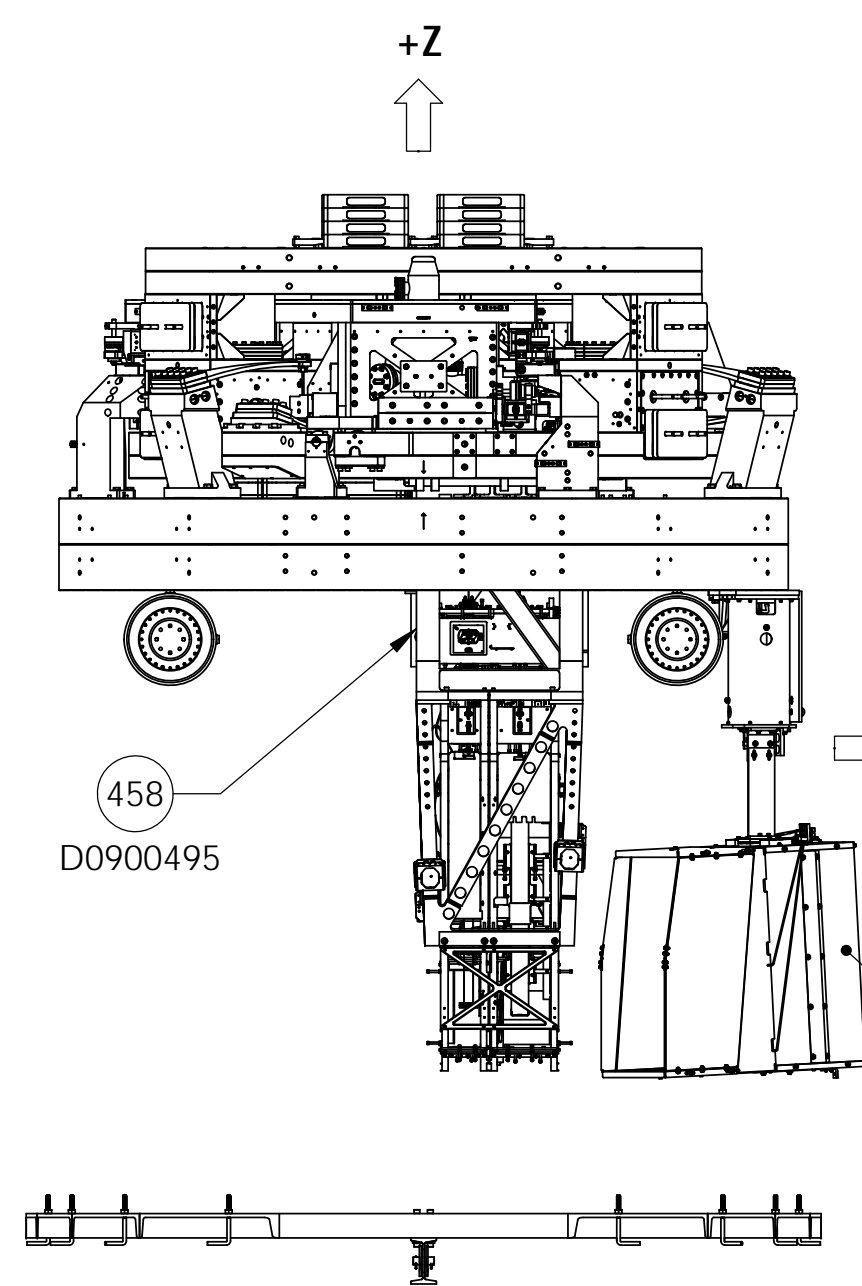

FRONT VIEW

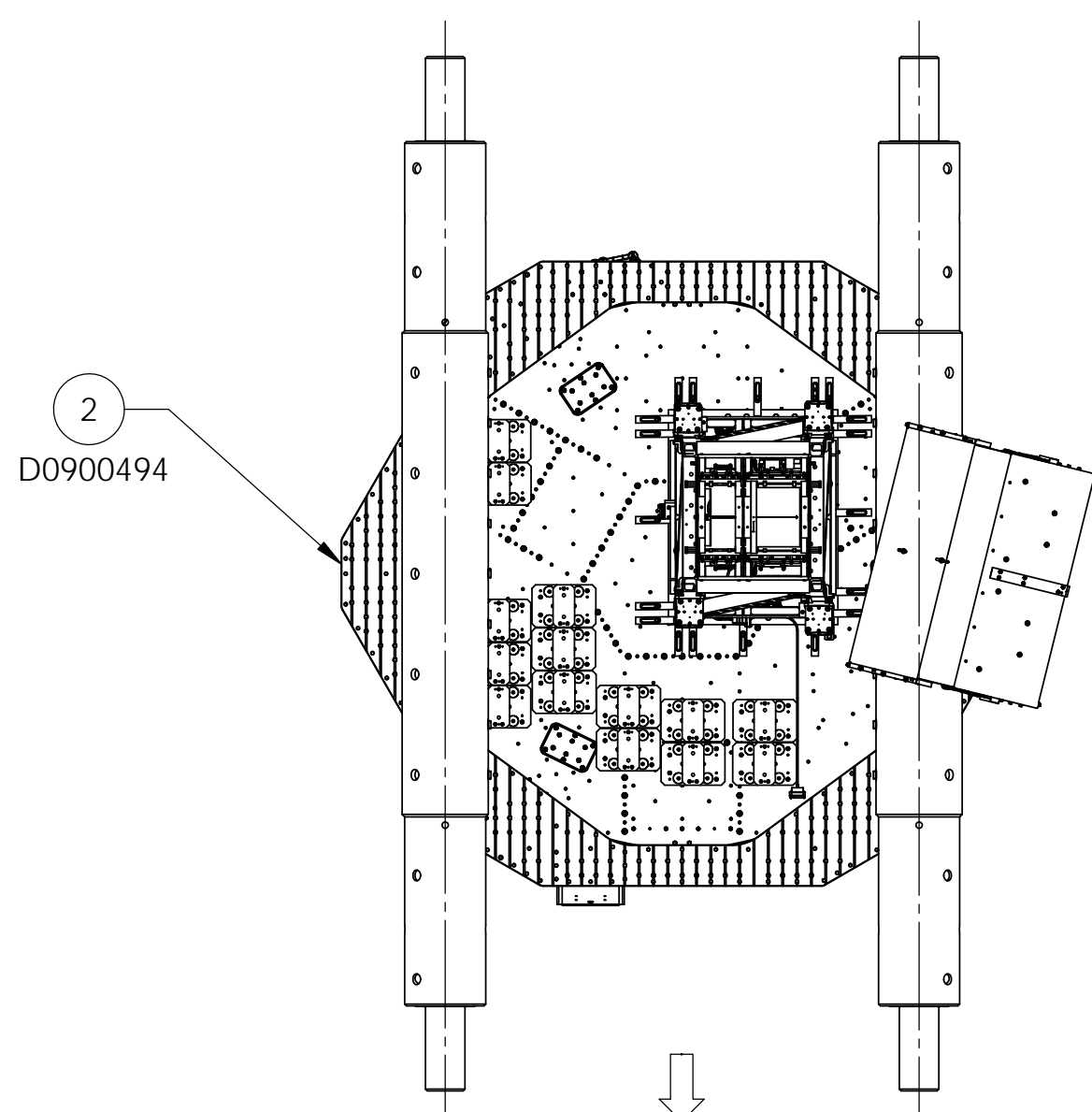

BOTTOM VIEW

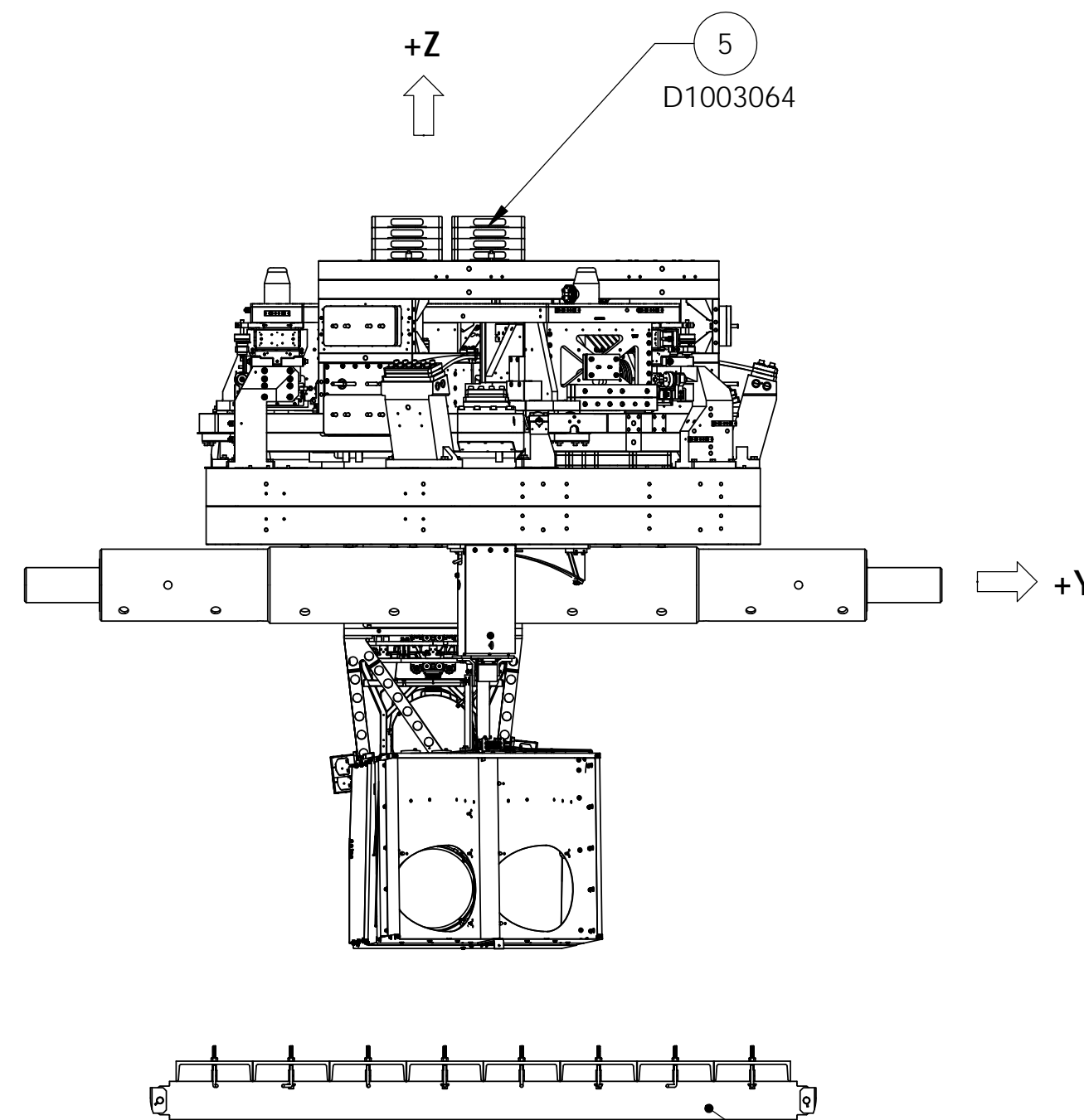

RIGHT VIEW

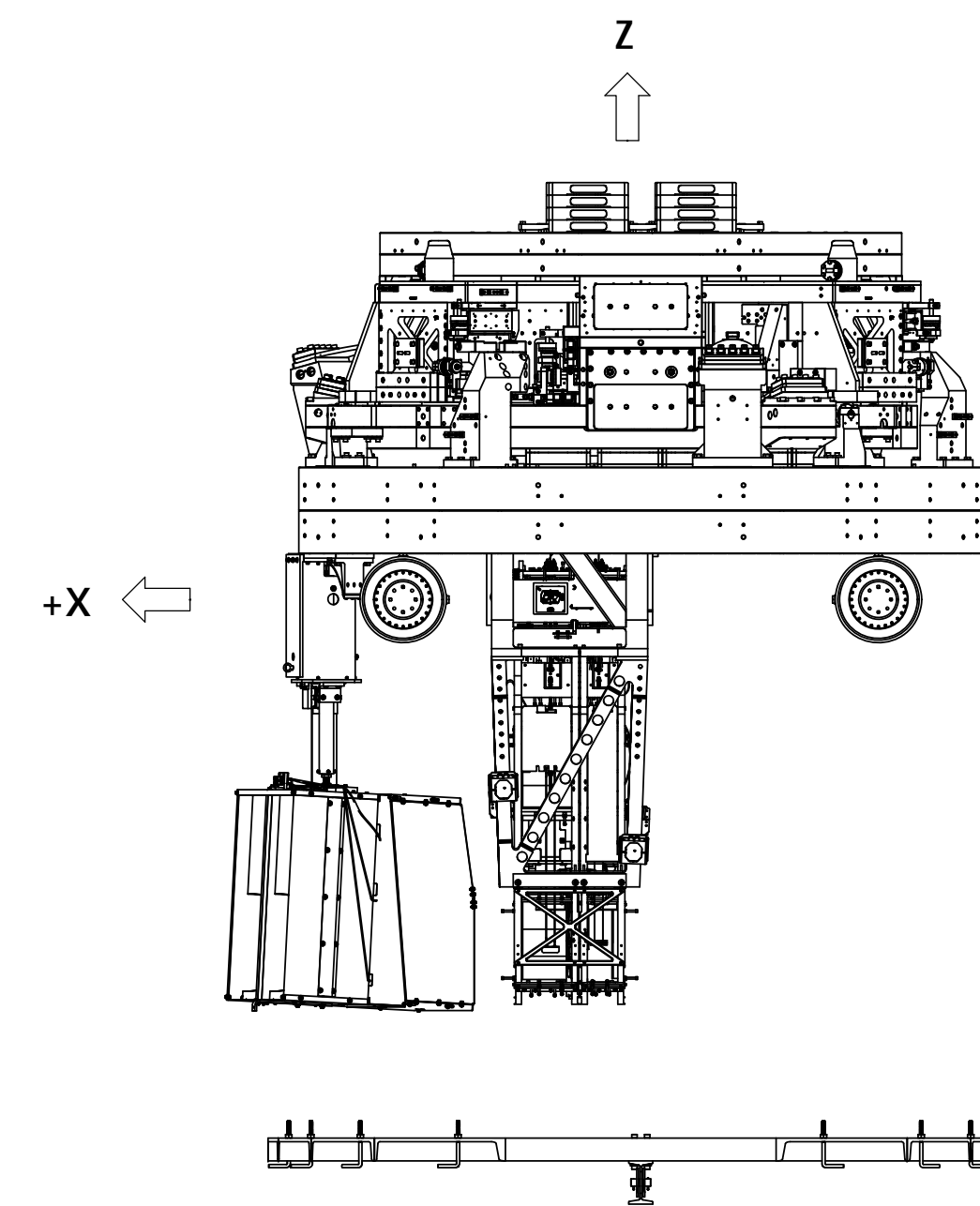

BACK VIEW

4.5
D961115
REFER TO D1100429 FOR
ORIENTATION W/R TO CHAMBER

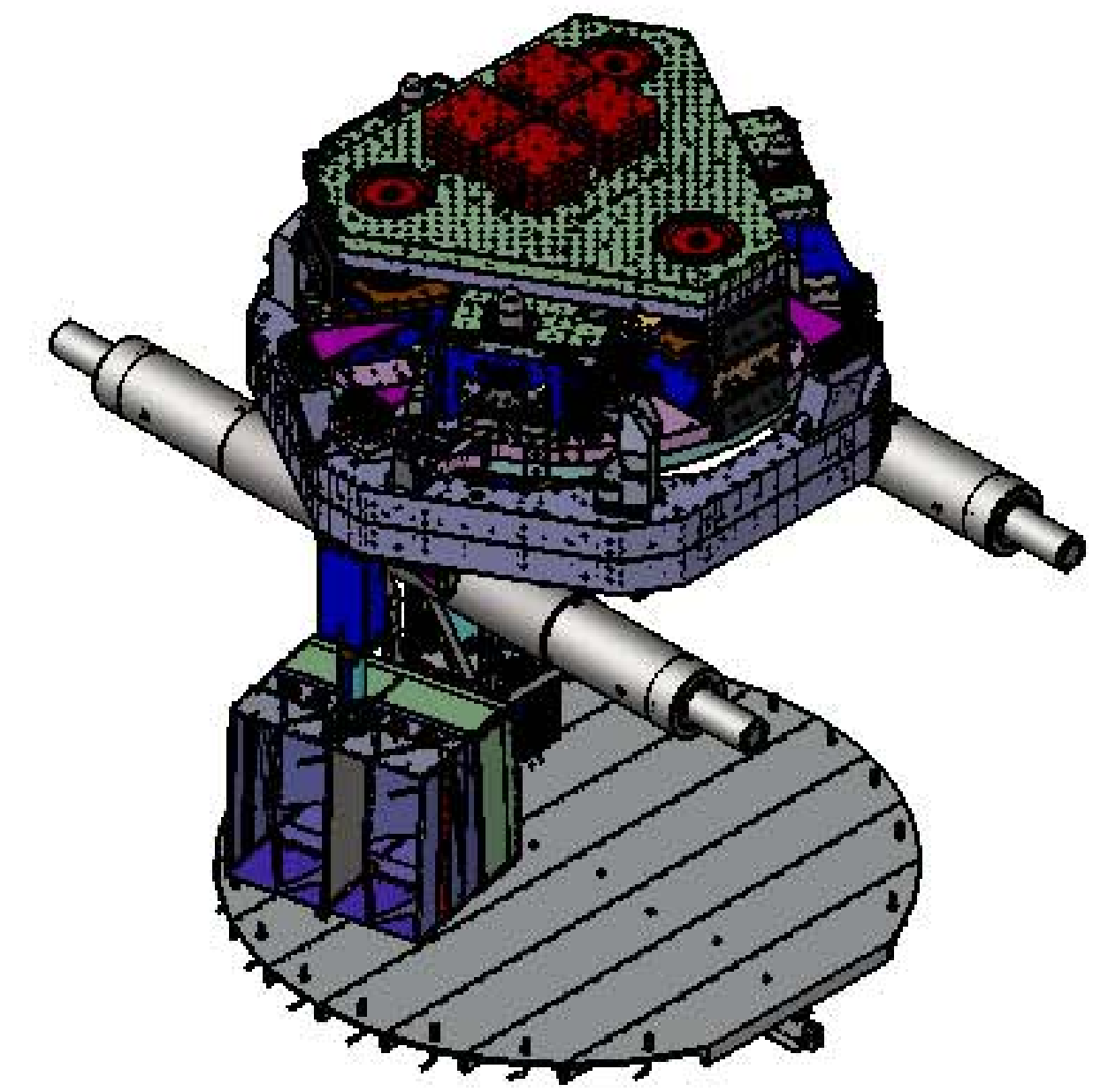

ITEM NO.	PART NUMBER	DESCRIPTION	Full Complete/QTY.
6	D1003371	AdvLIGO SUS BSC3 BSC5-L1, XYZ Local CS for SLC Arm Cavity Baffle	1
5	D1003064	AdvLIGO BSC3-L1 ISI Table, Balance, Ballast & Trim Mass Assy	1
4	D1000513	HEPI ASSEMBLY, BSC aLIGO	1
3	D0900495	AdvLIGO SUS BSC3-L1, XYZ Local CS for ITMX	1
2	D0900494	AdvLIGO SEI BSC3-L1, XYZ Local CS for ISI Table	1
1	D0900493	AdvLIGO VE BSC3-H1, Vacuum Equipment Assembly	1

LIGO CALIFORNIA INSTITUTE OF TECHNOLOGY
MASSACHUSETTS INSTITUTE OF TECHNOLOGY

SIZE DWG. NO. REV.
D D0900492 v5

SCALE: 1:25 PROJECTION: SHEET 2 OF 3

D0900492 AdvLIGO Systems, BSC3-L1 Top Level Chamber Assembly, ALL PART FROM REV. X-038, DRAWING FROM REV. X-004

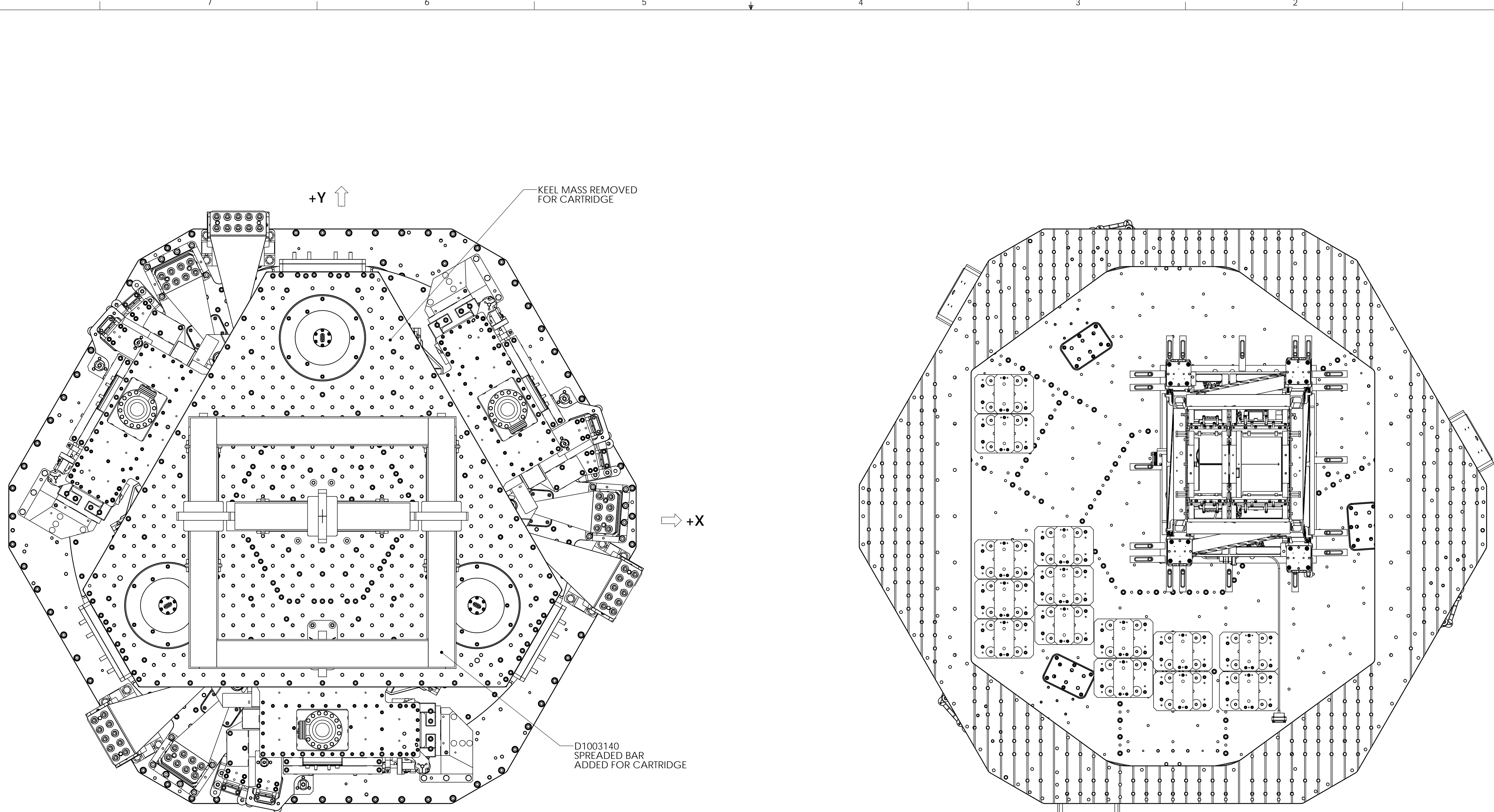

**TOP VIEW
(LOOKING DOWN)
CARTRIDGE ASSEMBLY CONFIGURATION
KEEL MASS REMOVED**

**BOTTOM VIEW
(LOOKING UP)**

KEEL MASS REMOVED
FOR CARTRIDGE

D1003140
SPREADED BAR
ADDED FOR CARTRIDGE

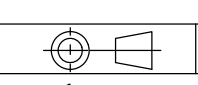
LIGO CALIFORNIA INSTITUTE OF TECHNOLOGY MASSACHUSETTS INSTITUTE OF TECHNOLOGY	
SIZE DWG. NO.	REV.
D D0900492	v5
SCALE: 1:8	PROJECTION:  SHEET 3 OF 3

D0900492 AxM LIGO Systems: BCS-11 Top Level Chamber Assembly: ALL PART FROM REV: X-036L DRAWING FROM REV: X-004