

REV.	DATE	DCH #	DRAWING TREE #
v11	03 AUG, 2015	E1500290-x0	

- NOTES:
- REFER TO DOCUMENT D1101271 FOR OPTICAL TABLE HOLE TABULATION CONVENTION.
 - REFER TO G1000125 FOR ISI NAMING AND ORIENTATION CONVENTION.

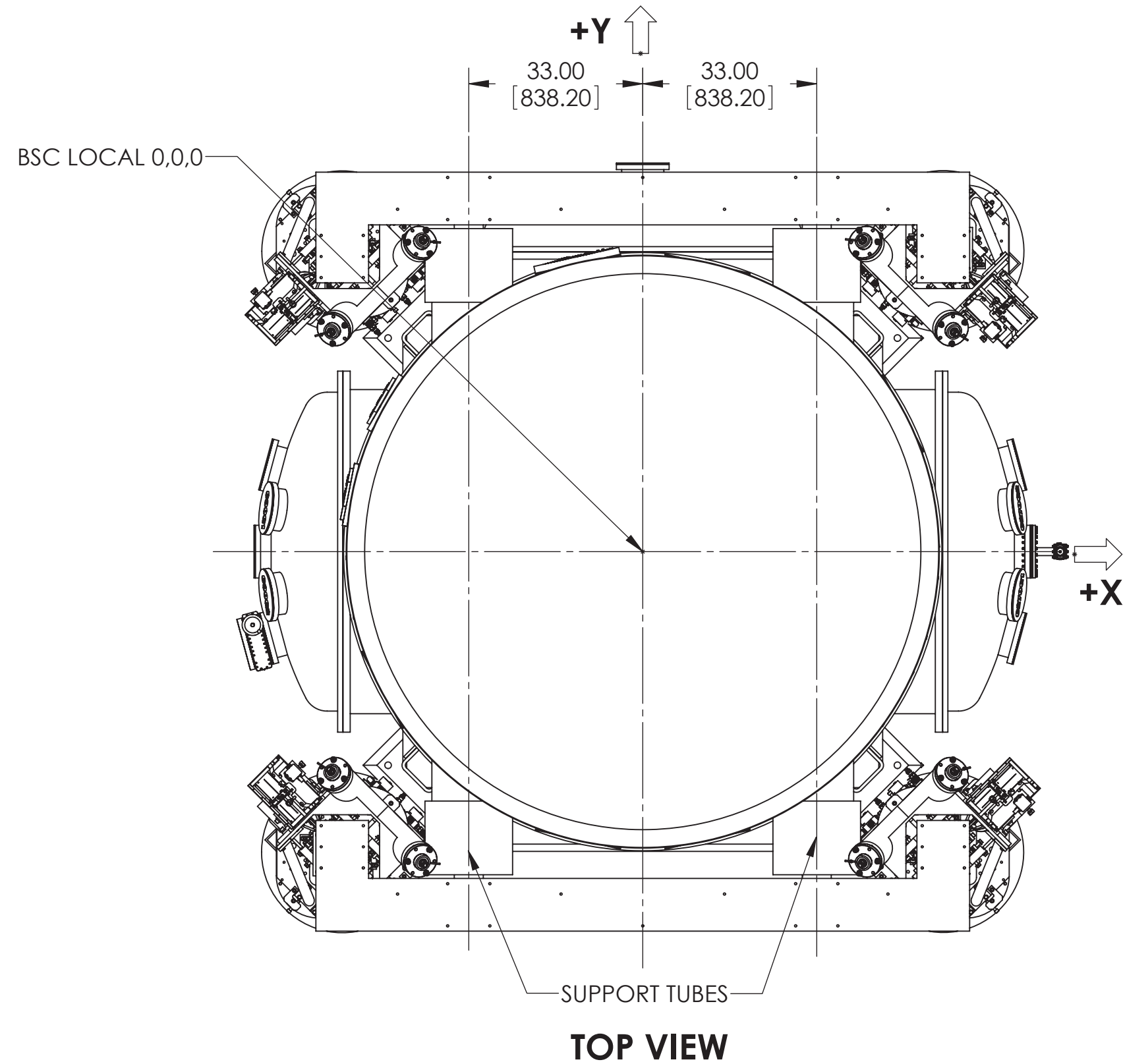

TOP VIEW

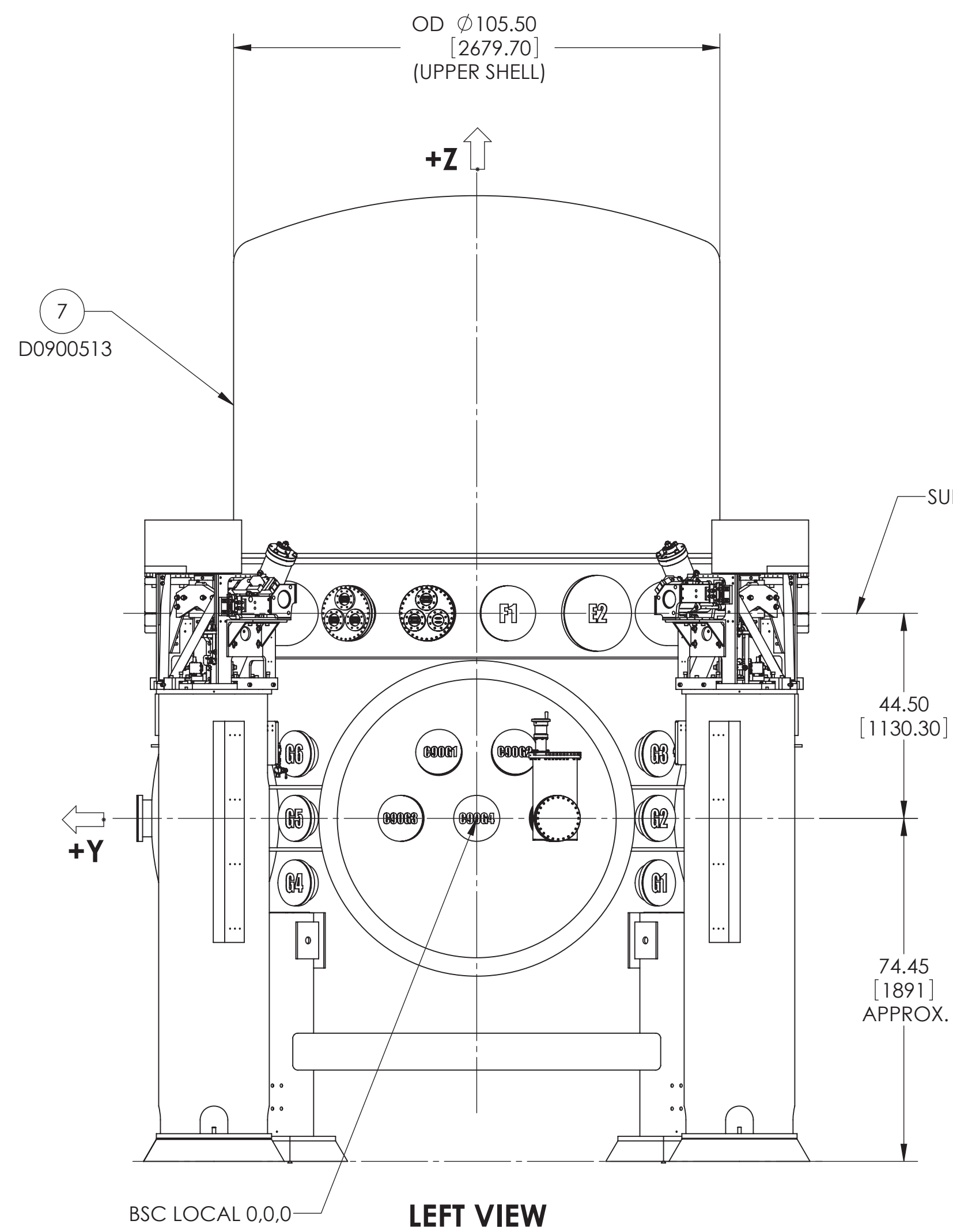
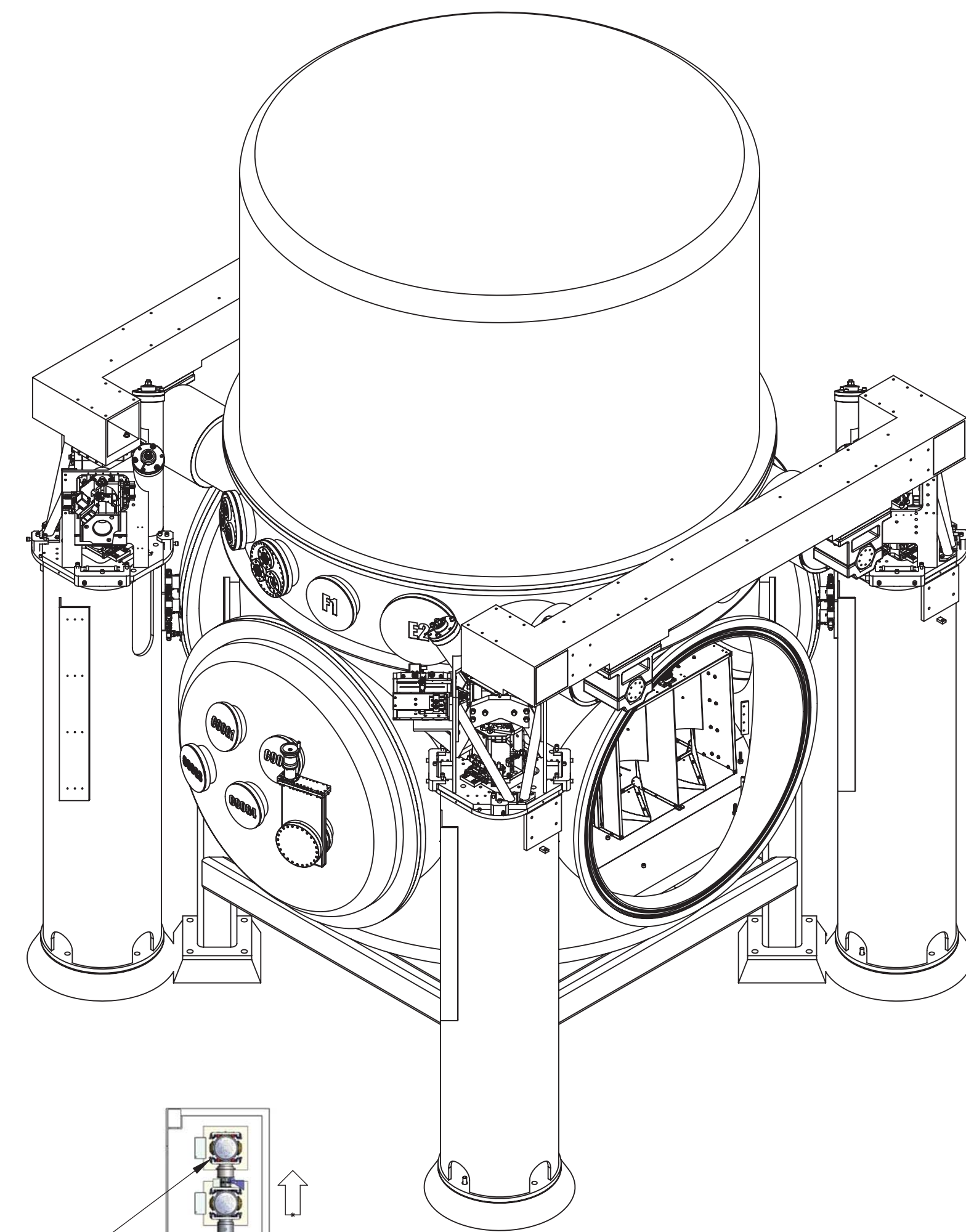

LEFT VIEW

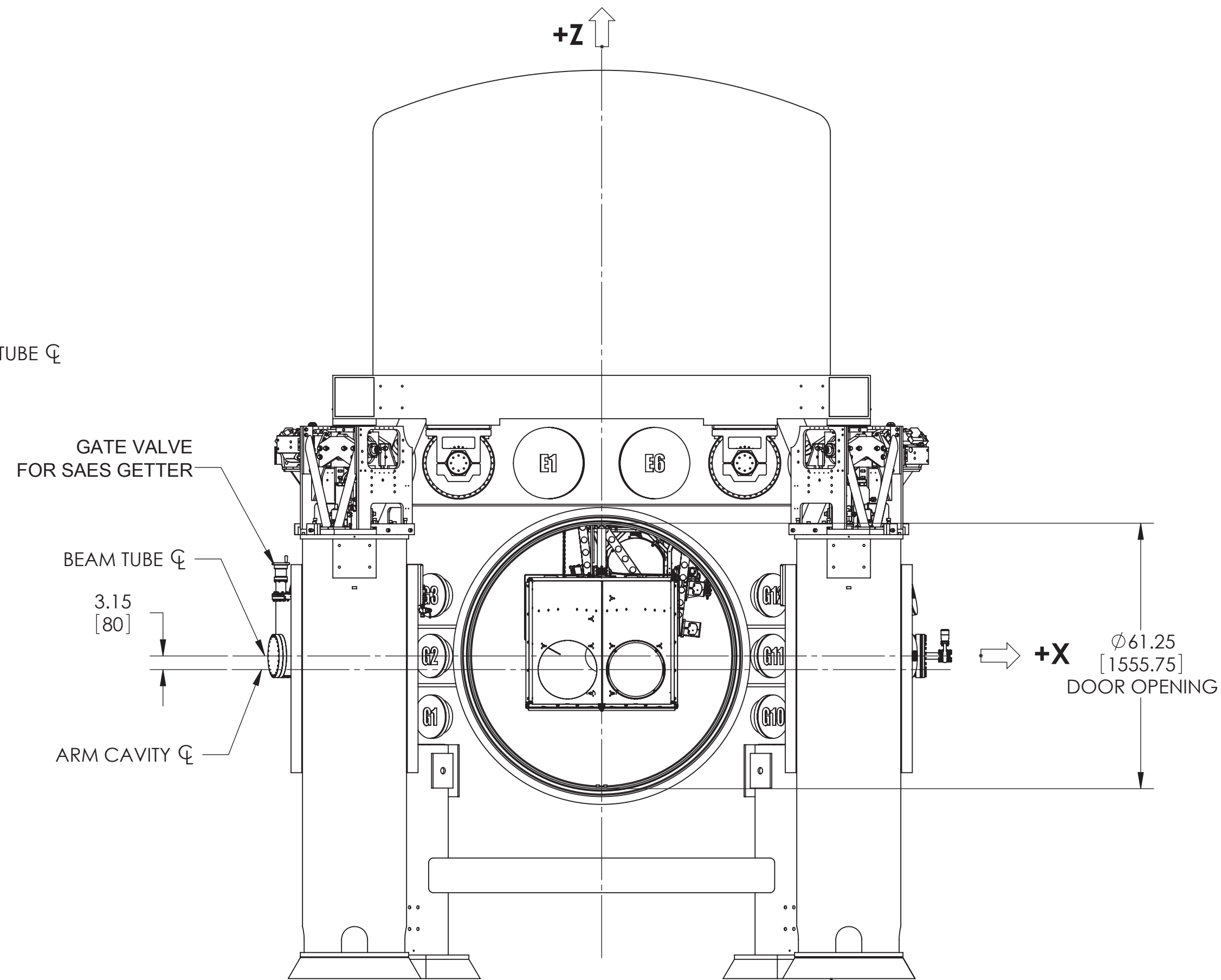

FRONT VIEW

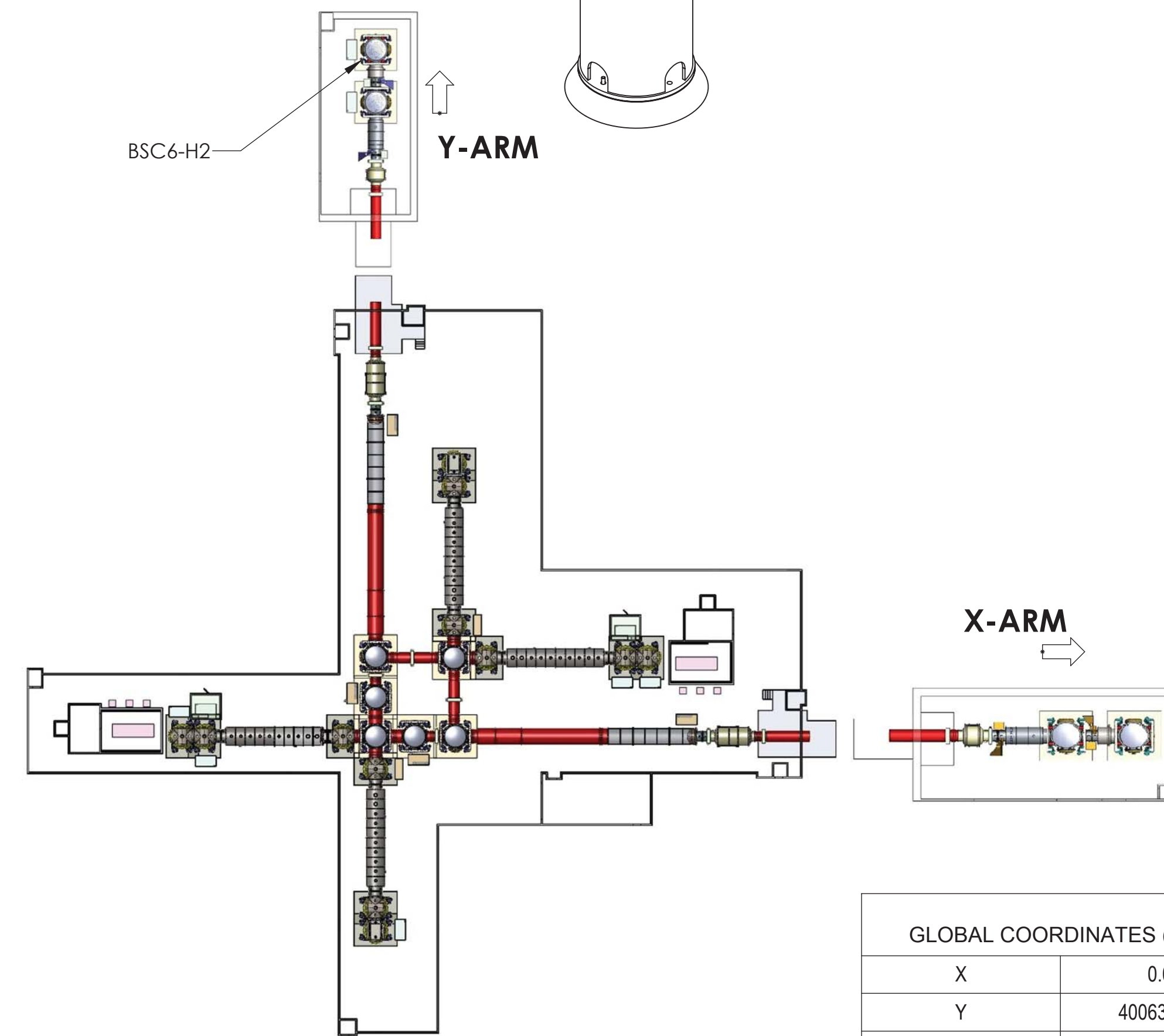

GLOBAL COORDINATES (mm)	
X	0.0
Y	4006370.0
Z	0.0

NOTES AND TOLERANCES: (UNLESS OTHERWISE SPECIFIED)

MATERIAL	--	FINISH	-- μinch
----------	----	--------	----------

CALIFORNIA INSTITUTE OF TECHNOLOGY MASSACHUSETTS INSTITUTE OF TECHNOLOGY		PART NAME BSC6-H2 TOP LEVEL CHAMBER ASSEMBLY, FULLY DEFINED	
SYSTEM	ADVANCED LIGO	SUB-SYSTEM	SUS
DRAFTER	ED CHAVEZ	25 SEP 2011	SIZE DWG. NO.
CHECKER	C.TORRIE	03 OCT 2011	D
APPROVAL	SEE DCC		D0900512

REV.	v11	SHEET 1 OF 3
SCALE:	1:24	PROJECTION:

D0900512_Ask/LIGO Systems: BSC6-H2 Top Level Chamber Assembly, All Part PDM REV-X: 109: DRAWING PDM REV: X:011

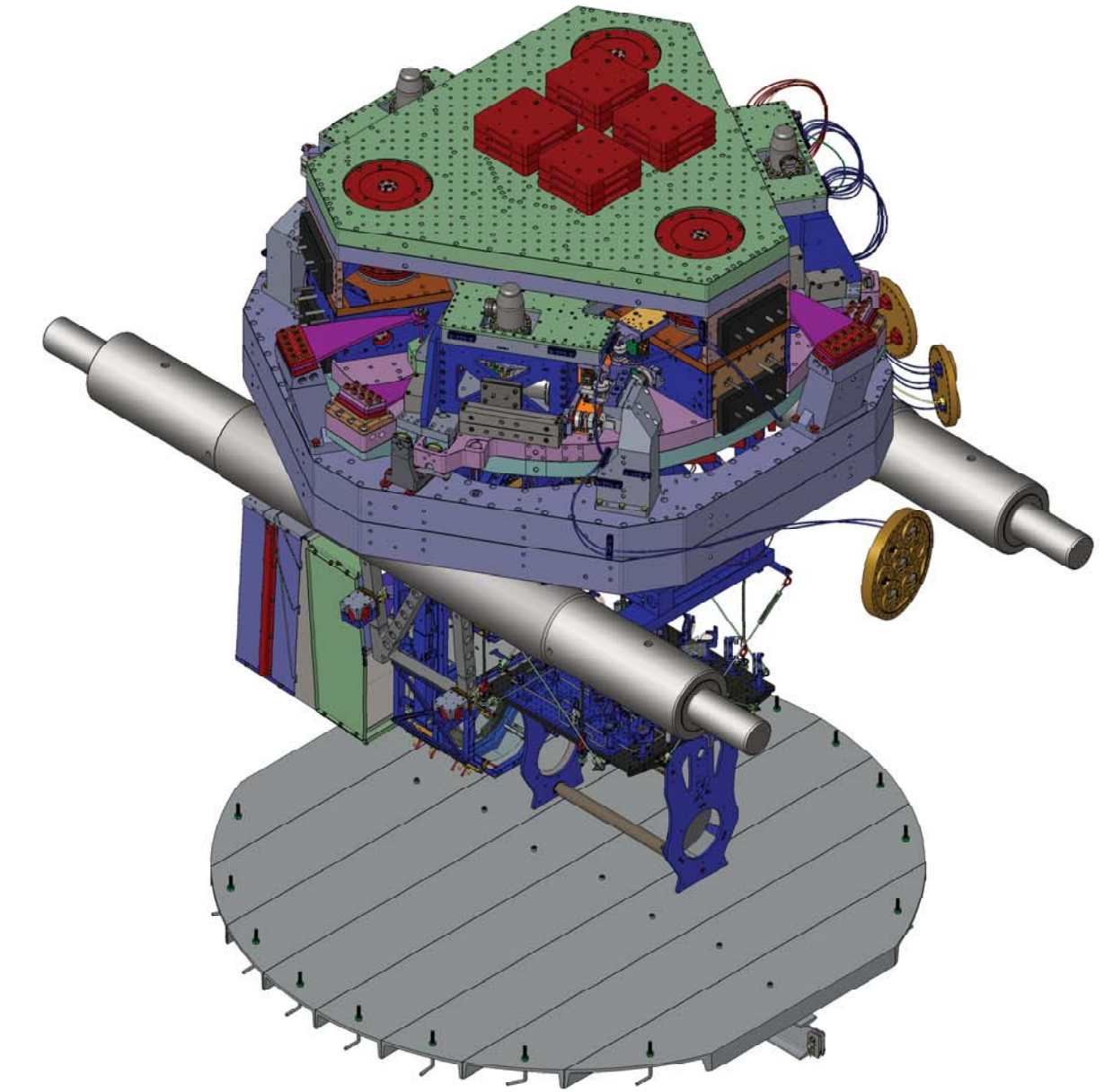
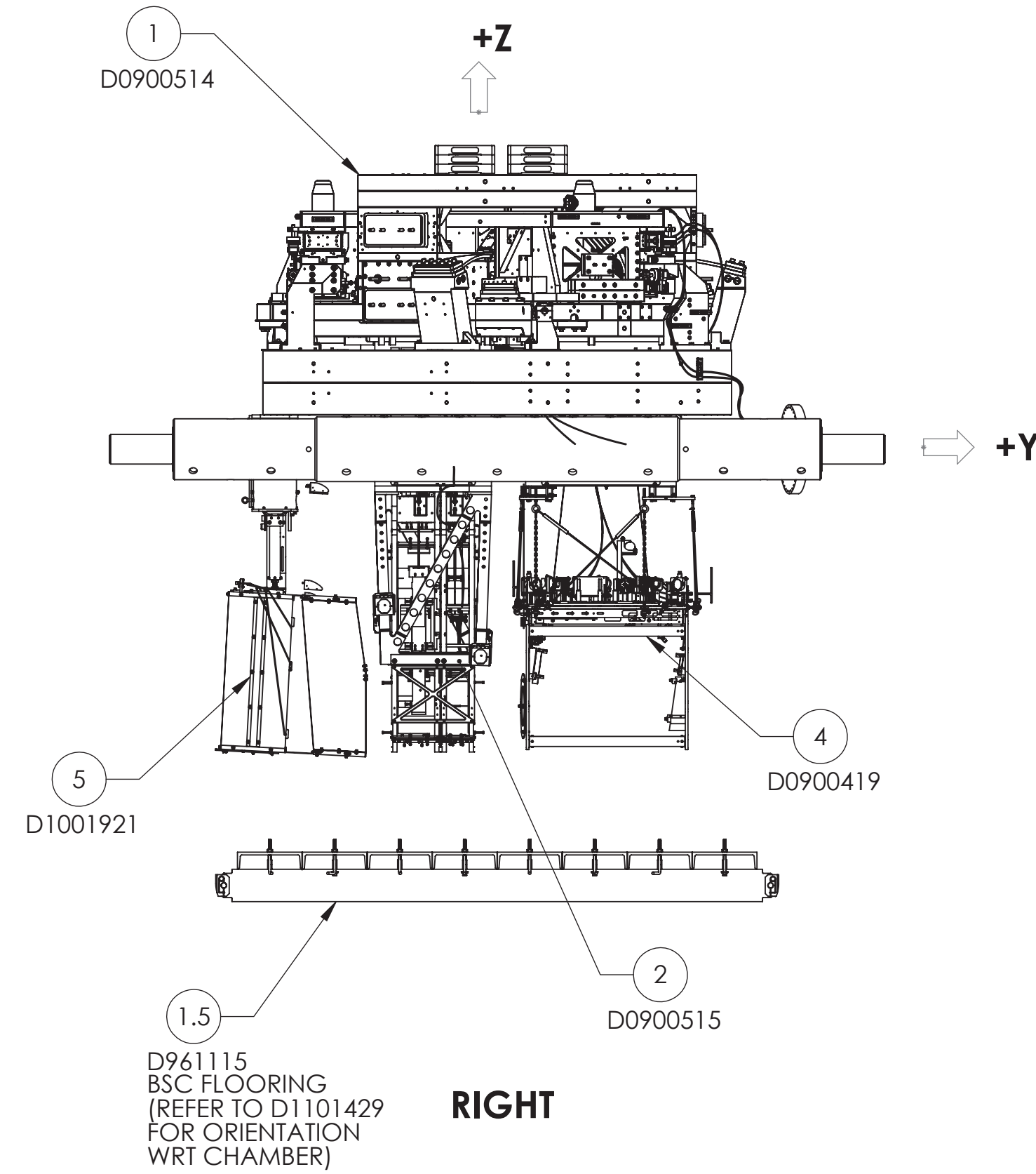
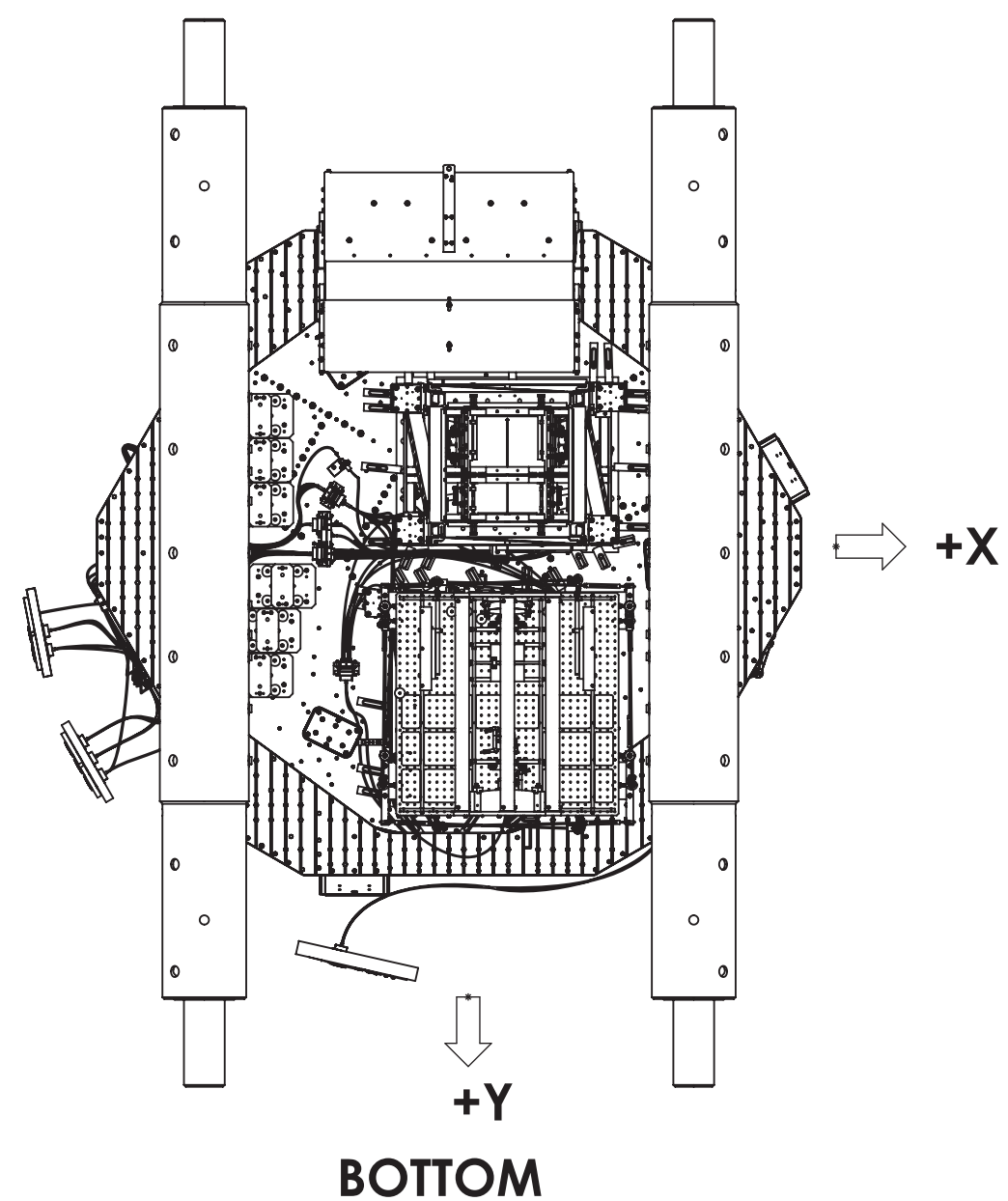
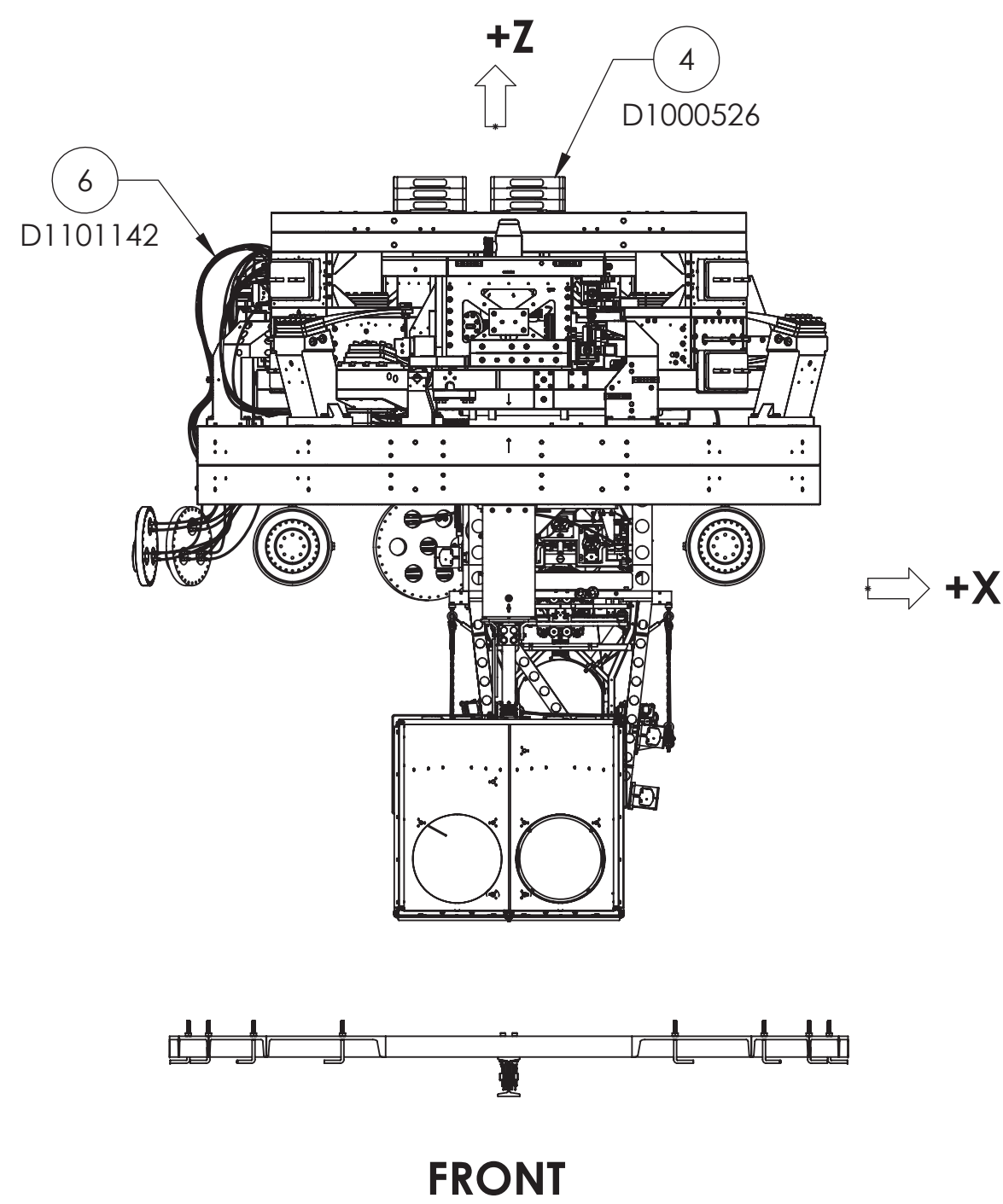
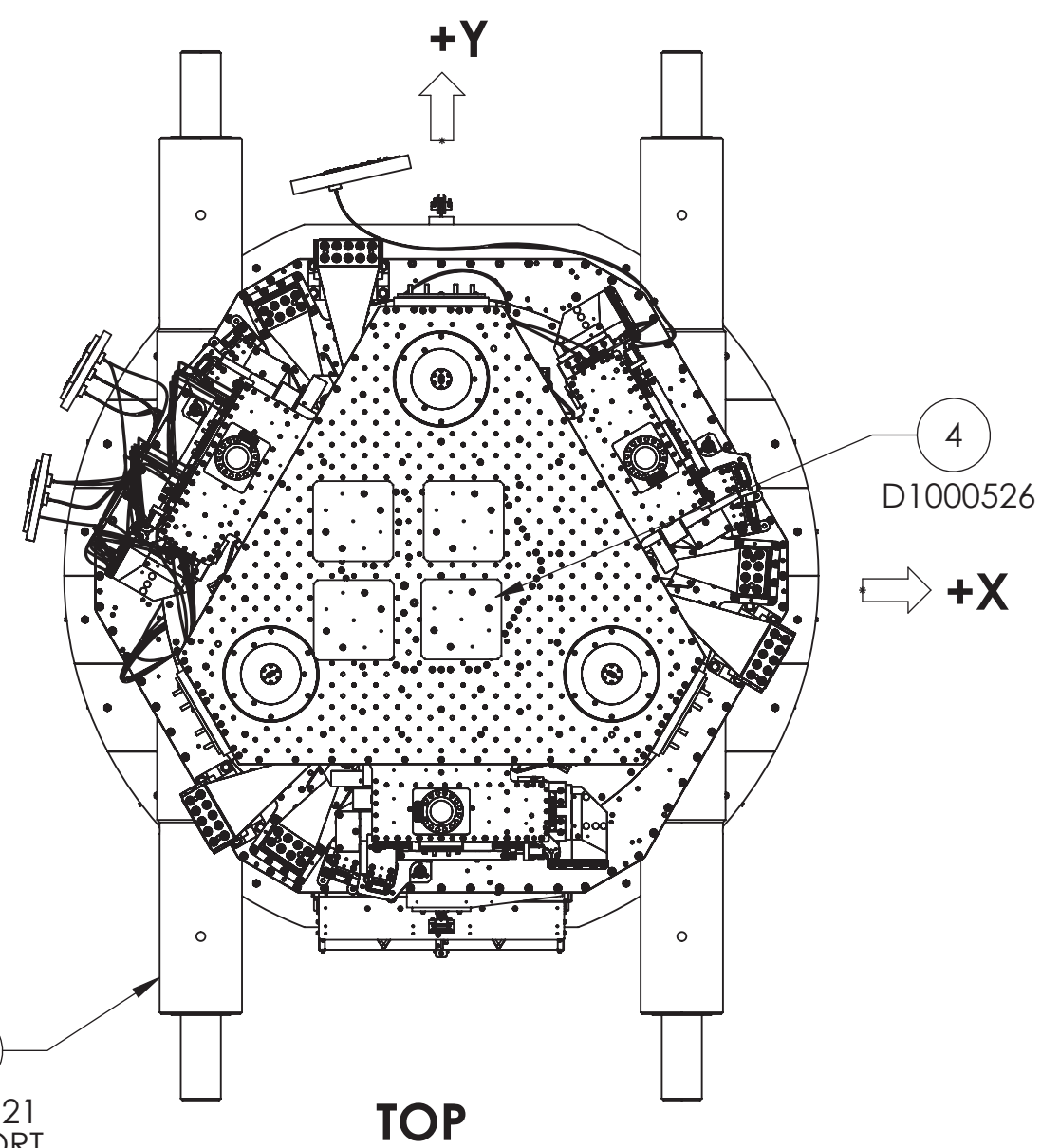

ITEM NO.	QTY.	PART NUMBER	DESCRIPTION
8	1	D1000513	HEPI ASSEMBLY, BSC aLIGO
7	1	D0900513	AdvLIGO Systems BSC6-H2, Vacuum Equipment Assembly
6	1	D1101478	ALIGO, CABLE HARNESS ROUTING, BSC-6
5	1	D1001921	AdvLIGO BSC6-H2, XYZ Local CS for SLC Arm Cavity Baffle
4	1	D1000897	AdvLIGO BSC6-H2 ISI Table, Balance Masses Assembly
3	1	D0900419	AdvLIGO SUS BSC6-H2, XYZ Local CSm for ETM Tel Assy
2	1	D0900515	AdvLIGO SUS BSC6-H2, XYZ Local CS for ETMY
1	1	D0900514	AdvLIGO SEI BSC6-H2, XYZ Local CS for ISI Table

LIGO CALIFORNIA INSTITUTE OF TECHNOLOGY
MASSACHUSETTS INSTITUTE OF TECHNOLOGY

SIZE DWG. NO. **D0900512** REV. **v11**

SCALE: 1:25 PROJECTION: SHEET 2 OF 3

D0900512 AdvLIGO Systems, BSC6-H2 Top Level Chamber Assembly, All PART PDM REV-X-109, DRAWING PDM REV-X-011

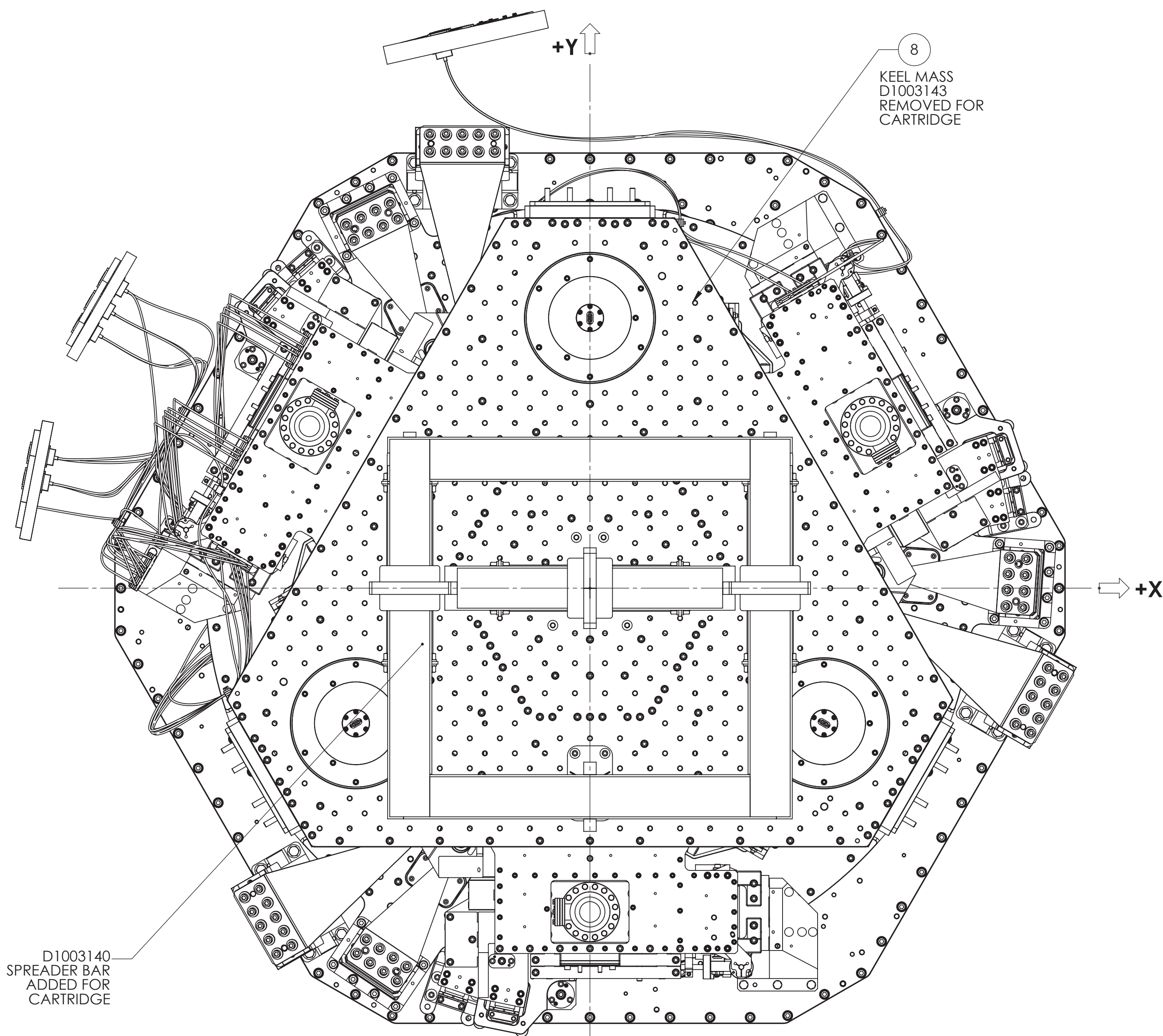

TOP VIEW
(Looking Down)

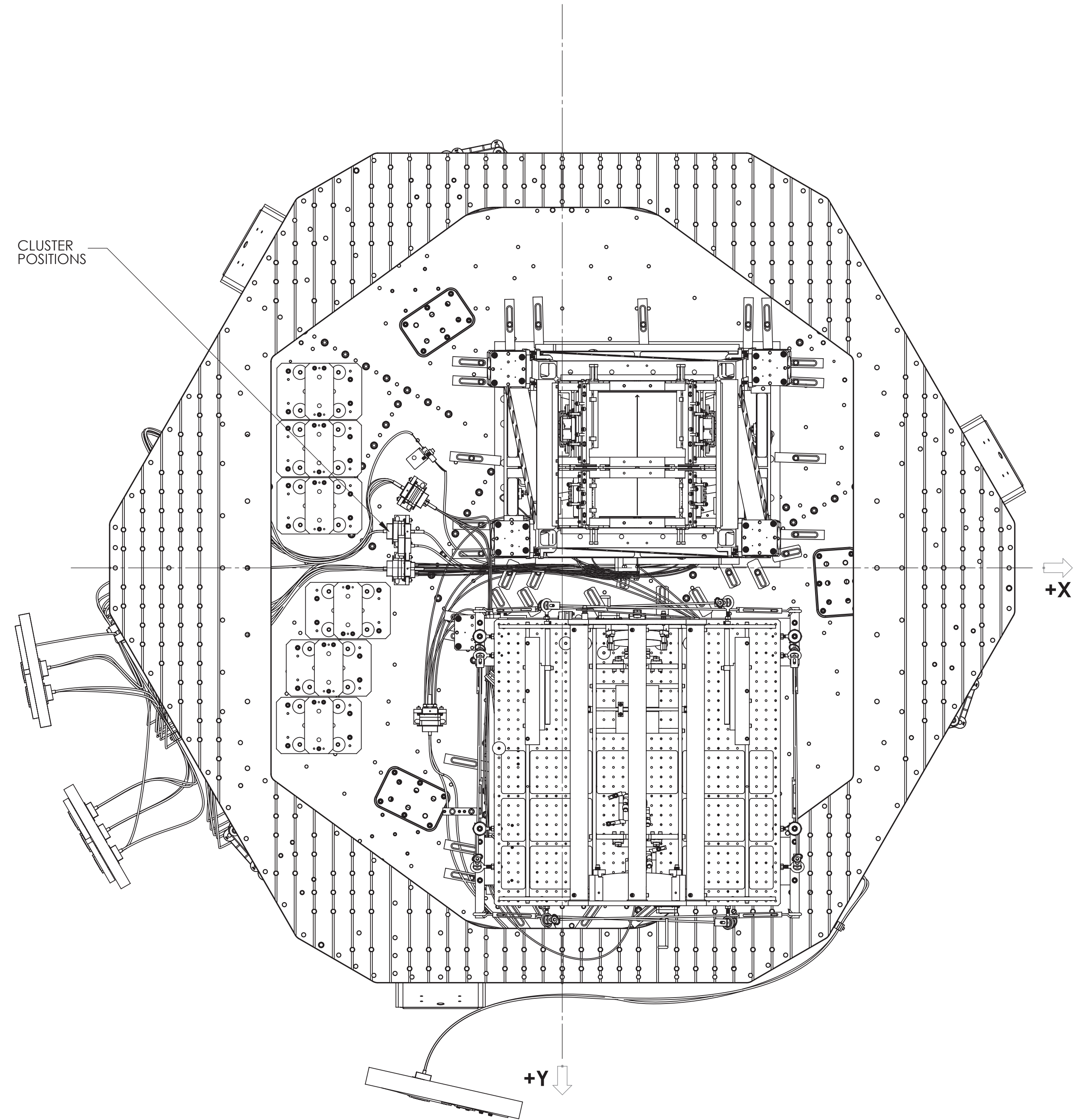

BOTTOM VIEW
(Looking Up)

D0900512_Ash/LIGO Systems_BSC6-H2 Top Level Chamber Assembly, All Part PDM REV-X-109, DRAWING PDM REV-X-011