

REV.	DATE	DCN #	DRAWING TREE #

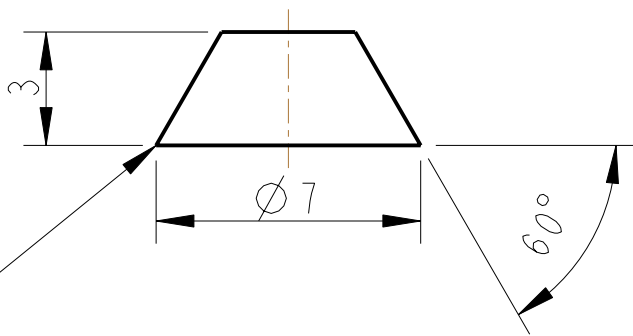
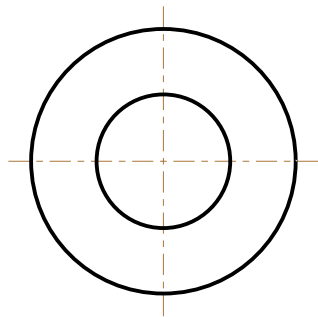

R MAX 0.5

NOTES: (UNLESS OTHERWISE SPECIFIED)

1. REMOVE ALL SHARP EDGES, R.02 MIN.
2. DO NOT SCALE FROM DRAWING.
3. ALL MACHINING FLUIDS SHALL BE WATER SOLUBLE AND FREE OF SULFUR, CHLORINE AND SILICONE, SUCH AS CINCINNATI MILACRON'S CIMTECH 410 (STAINLESS STEEL)
4. SCRIBE, ENGRAVE OR STAMP DRAWING PARTNUMBER ON NOTED SURFACE OF PART AND A THREE DIGIT SERIAL NUMBER. SERIAL NUMBERS START AT 001 FOR THE FIRST PART AND PROCEED CONSECUTIVELY. USE .07" HIGH CHARACTERS. EXAMPLE: D020188- 001. A VIBRATORY TOOL MAY BE USED.

DIMENSIONS ARE IN mm [INCHES]  
TOLERANCES:

X.XX ±0.2 mm  
ANGULAR ±0.25 °

MATERIAL: FUSED SILICA  
ANY GRADE

FINISH: CLEAN  
√μm [μin] Ra = 0.8

	NAME	DATE
DRAWN	I WILMUT	08/Dec/06
CHECKED	MB	15/MAR/10
APPROVED	JOD	15/MAR/10



SYSTEM	<b>aLIGO</b>
SUB-SYSTEM	<b>SUS</b>
NEXT ASSY	<b>QUAD LOWER STRUCTURE</b>
PART NAME	<b>FUSED SILICA EARTHQUAKE STOP</b>

SIZE	DRG. NO.	REV
<b>A</b>	<b>D060548</b>	<b>B.</b>
SCALE 5:1	PROJECTION:	SHEET 1 OF