

D070337\_Advanced\_LIGO\_SUS\_HLTS\_Test\_Mass\_Assembly\_PART PDM REV: X-021, DRAWING PDM REV: X-004

REV.	DATE	DCN #	DRAWING TREE #
v1	24 JUN 2009	E0900176	E080191
-	-	-	-
-	-	-	-

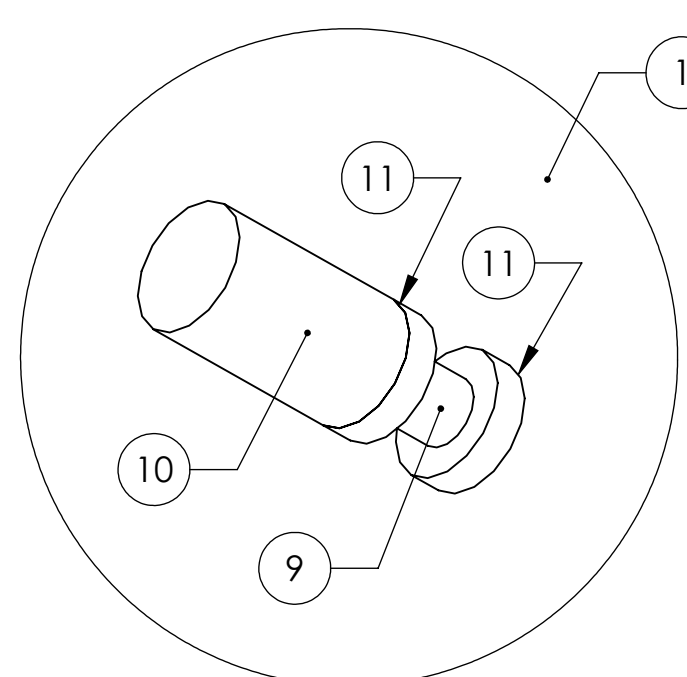

DETAIL A  
SCALE 10 : 1  
4X

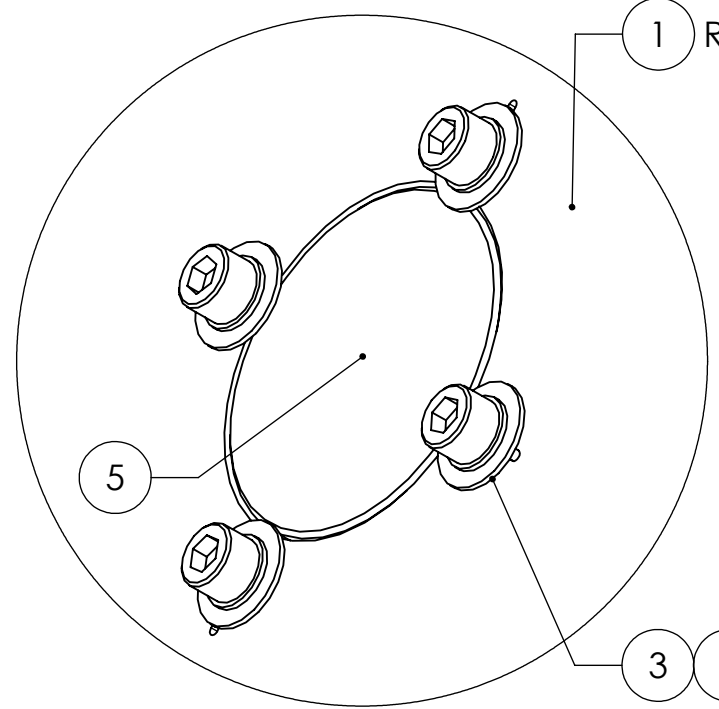

DETAIL B  
SCALE 2 : 1  
2X

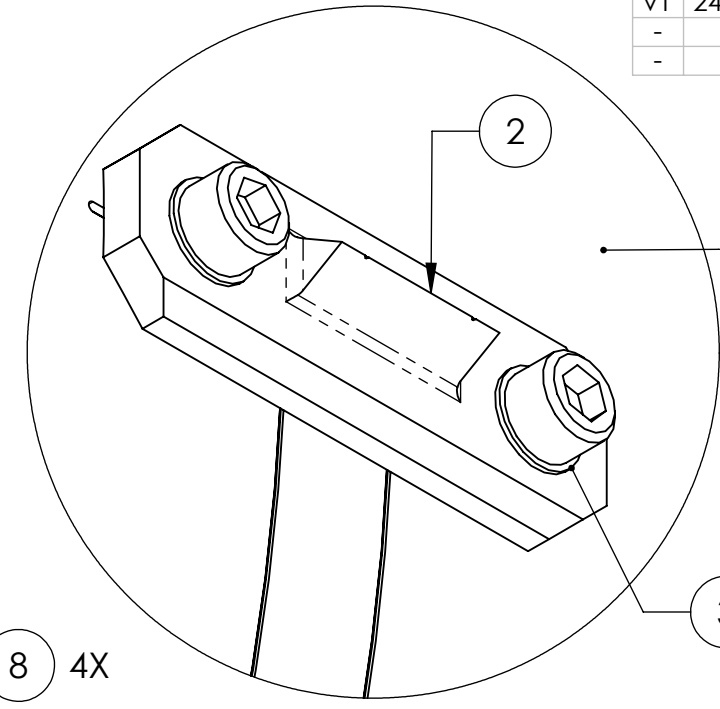

DETAIL C  
SCALE 2 : 1  
2X

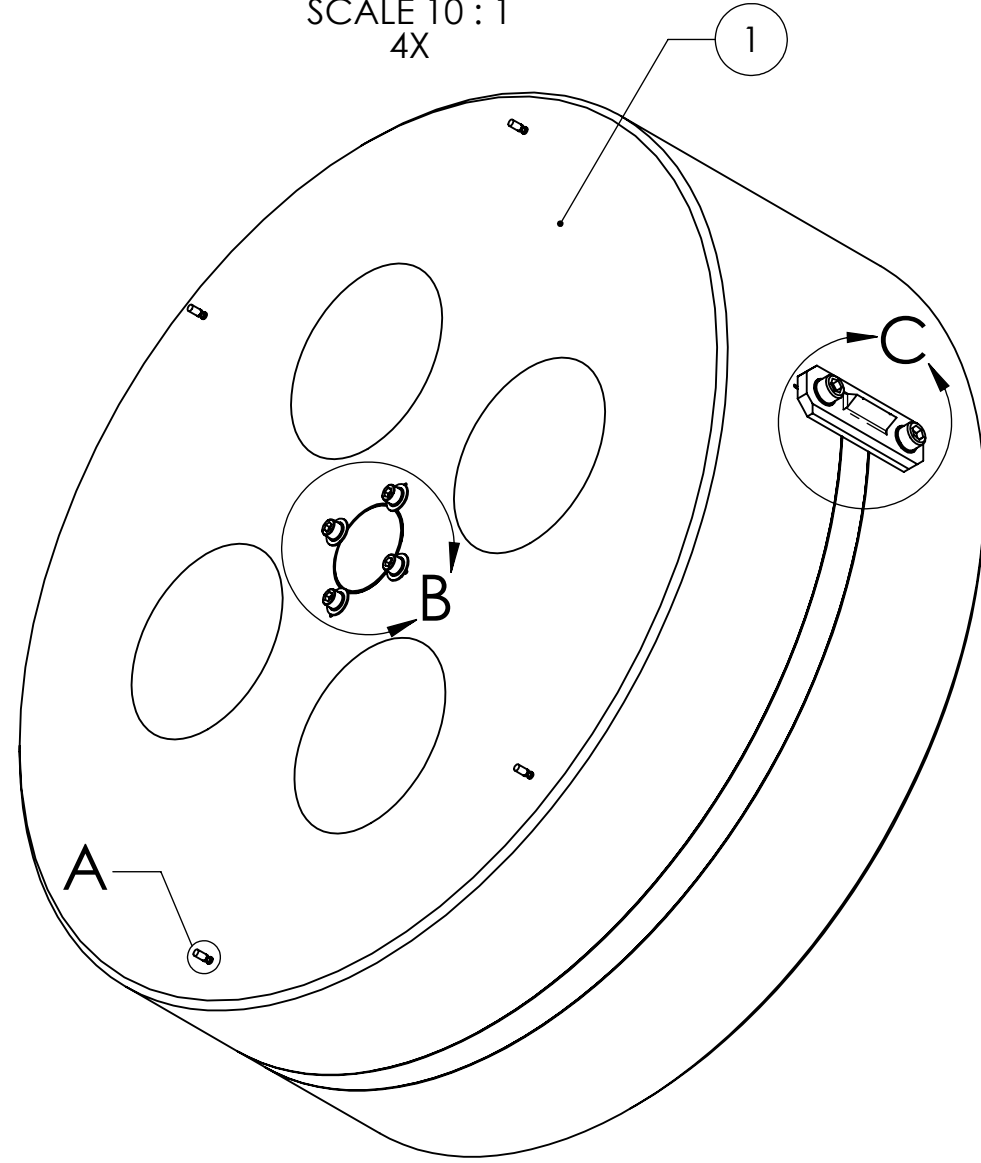

11	-	UHV-COMPATIBLE ADHESIVE (CERAMABOND #835M OR EQUIVALENT)	-	A/R	0	0
10	SCDS-750-125	SINTERED SmCo MAGNET, 0.075 X 0.125 (MMC P/N OR EQUIVALENT)	SmCo 2:17	4	1	5
9	D970075	DUMBBELL STANDOFF	6061-T6 Al	4	4	8
8	-	SCREW, SOCKET HEAD CAP, #4-40 UNC-2A X 0.5 LONG, VENTED	300 SSTL	8	2	10
7	-	WASHER, FLAT, #4 (NAS 620-C4L OR EQUIVALENT)	300 SSTL	8	2	10
6	Y1-1037-0	HIGH POWER Nd-YAG LASER MIRROR (CVI LASER P/N OR EQUIVALENT)	BK7 GLASS	ALT	0	0
5	PW1-1037-UV	LASER GRADE WINDOW (CVI LASER P/N OR EQUIVALENT)	FUSED SILICA	2	0	2
4	-	SCREW, SOCKET HEAD CAP, #8-32 UNC-2A X 0.75 LONG	300 SSTL	4	1	5
3	-	WASHER, FLAT, #8 (NAS 620-C8L OR EQUIVALENT)	300 SSTL	12	3	15
2	D080124	PRISM BREAKOFF, LOWER WIRE	304, 316 OR 302 SSTL	2	0	2
1	D070338	METAL TEST MASS	6061-T6 Al	1	0	1
ITEM NO.	PART NUMBER	DESCRIPTION	MATERIAL	REQ	SPARE	TOTAL

PARTS LIST

NOTES AND TOLERANCES: (UNLESS OTHERWISE SPECIFIED)

1. PARTS TO BE ASSEMBLED ACCORDING TO E080208 HLTS ASSEMBLY SPECIFICATION, USING D0901460 HLTS TEST MASS MAGNET PLACEMENT FIXTURE.

**LIGO** CALIFORNIA INSTITUTE OF TECHNOLOGY  
MASSACHUSETTS INSTITUTE OF TECHNOLOGY

SYSTEM: **ADVANCED LIGO** SUB-SYSTEM: **SUS**

NEXT ASSY: **HLTS SUSPENSION ASSY**

PART NAME: **TEST MASS ASSY**

DESIGNER: D. BRIDGES 14 JAN 2009  
DRAFTER: D. BRIDGES 26 JUL 2009  
CHECKER: J. ROMIE 27 JUL 2009  
APPROVAL:

SIZE: B DWG. NO.: **D070337** REV.: v1  
SCALE: 1:2 PROJECTION: SHEET 1 OF 1

MATERIAL: N/A FINISH: N/A μinch