

4

3

2

1

NOTES CONTINUED:

- 5. BAG ALL ITEMS INDIVIDUALLY AND MARK OR TAG EACH BAG WITH DRAWING NUMBER, REVISION, AND QUANTITY. EXAMPLE: DXXXXXX-VY, QTY: 1
- 6. PART IS TO BE FABRICATED FROM STOCK 1/4-20 UNC-2A SOCKET HEAD CAP SCREW, FULLY THREADED.

REV.	DATE	DCN #	DRAWING TREE #
v1	3 MAR 2009	E0900066	-
-	-	-	-
-	-	-	-

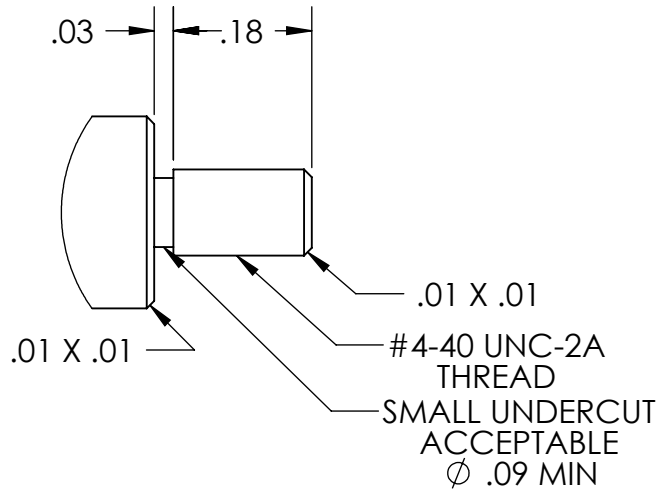

DETAIL A
SCALE 4 : 1

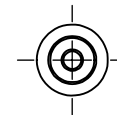
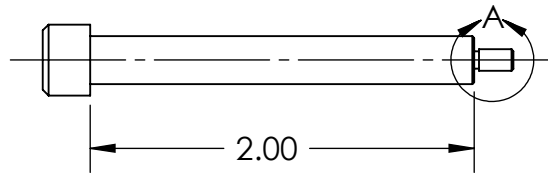
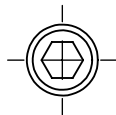
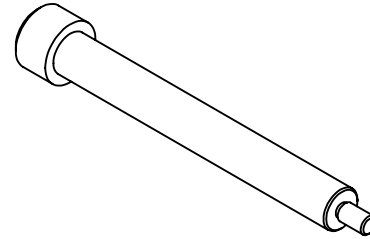

NOTES AND TOLERANCES: (UNLESS OTHERWISE SPECIFIED)

DIMENSIONS ARE IN INCHES

TOLERANCES:
 .XX ± .01
 .XXX ± .005

ANGULAR ± 0.1°

1. INTERPRET DRAWING PER ASME Y14.5-1994. 2. REMOVE ALL SHARP EDGES, R.02 MIN. 3. DO NOT SCALE FROM DRAWING. 4. ALL MACHINING FLUIDS SHALL BE WATER SOLUBLE AND FREE OF SULFUR, CHLORINE AND SILICONE, SUCH AS CINCINNATI MILACRON'S CIMTECH 410.	
MATERIAL	300 SSSL
FINISH	N/A μinch

LIGO CALIFORNIA INSTITUTE OF TECHNOLOGY
 MASSACHUSETTS INSTITUTE OF TECHNOLOGY

SYSTEM: **ADVANCED LIGO** SUB-SYSTEM: **SUS**

NEXT ASSY: **MULTIPLE ASSYS**

PART NAME		EARTHQUAKE STOP ADJUSTER AND MOUNT, 2 INCH	
DESIGNER	D. BRIDGES	6 MAY 2009	SIZE DWG. NO.
DRAFTER	D. BRIDGES	15 MAY 2009	A D0900906
CHECKER	M. MEYER	15 MAY 2009	REV. v1
APPROVAL			SCALE: 1:1 PROJECTION: SHEET 1 OF 1

4

3

2

1