

REV.	DATE	DCN #	DRAWING TREE #
v1	09 JUN 2012	E0900499	E0900353
v2	04 SEP 2012	E1200801	E0900061
-	-	-	-

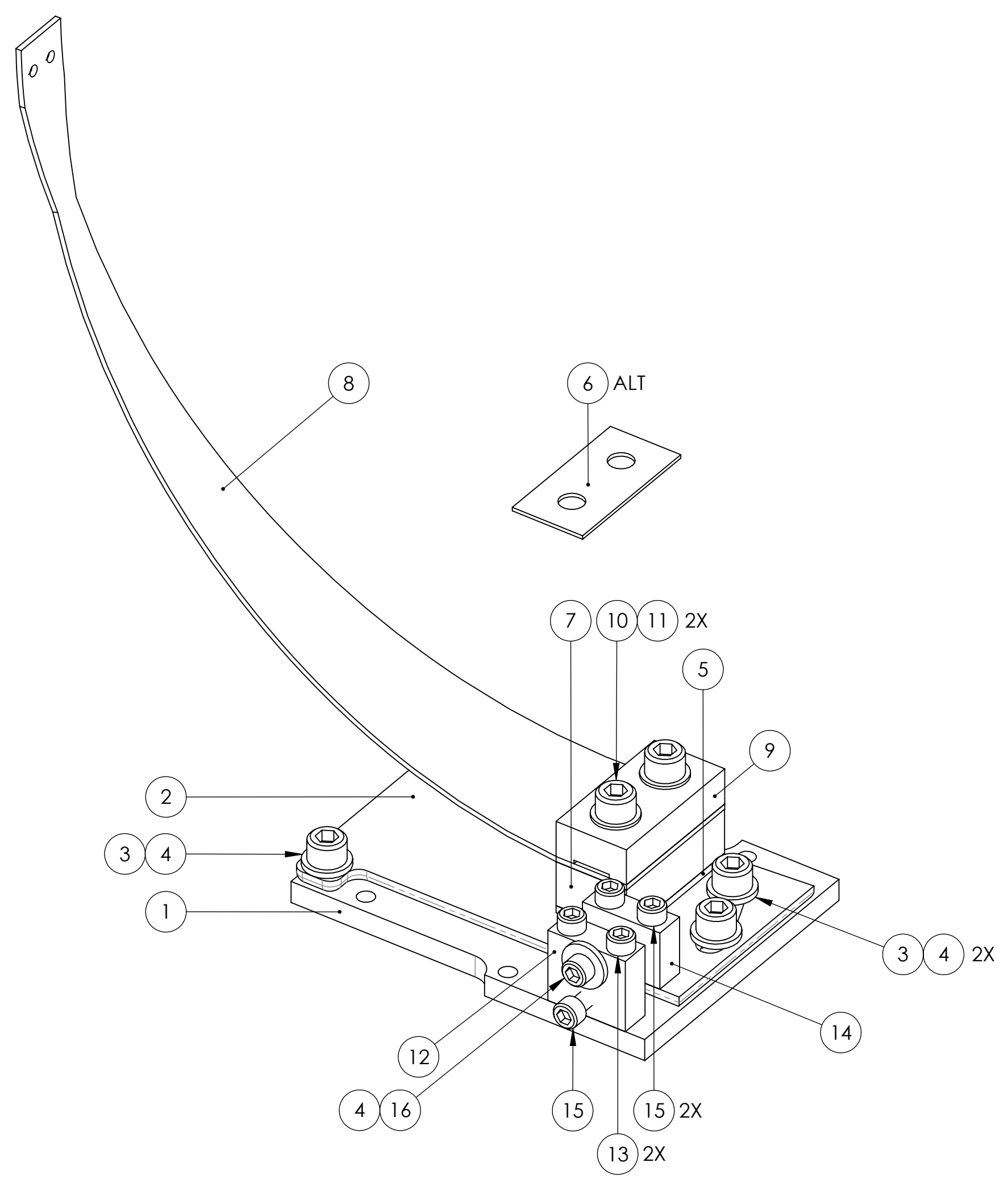

ITEM NO.	PART NUMBER	DESCRIPTION	MATERIAL	REQ	SPARE	TOTAL
16	-	SCREW, SOCKET HEAD CAP, #8-32 UNC-2A X 1 LONG	Ag-PLATED 300 SSSL	1	1	2
15	-	SCREW, SOCKET HEAD CAP, #8-32 UNC-2A X 0.75 LONG	Ag-PLATED 300 SSSL	3	1	4
14	D030450	PULL PLATE, ROTATIONAL ADJUSTER	304, 316 OR 302 SSSL	1	0	1
13	-	SCREW, SOCKET HEAD CAP, #8-32 UNC-2A X 1 LONG	300 SSSL	2	1	3
12	D030449	PUSH PLATE, ROTATIONAL ADJUSTER	304, 316 OR 302 SSSL	1	0	1
11	-	WASHER, FLAT, 1/4 (NAS 620-C416L OR EQUIVALENT)	300 SSSL	2	1	3
10	-	SCREW, SOCKET HEAD CAP, 1/4-20 UNC-2A X 1.25 LONG	Ag-PLATED 300 SSSL	2	1	3
9	D020116	UPPER BLADE CLAMP, UPPER SIDE, 0.0 DEGREE	304, 316 OR 302 SSSL	1	0	1
8	D080018	UPPER BLADE, OMCS	MARAGING STEEL C250	1	1	2
7	D030459	UPPER BLADE CLAMP, LOWER SIDE, 0.0 DEGREE	304, 316 OR 302 SSSL	1	0	1
6	D020679	UPPER BLADE CLAMP, LOWER SIDE, SHIM, 1mm	304, 316 OR 302 SSSL	ALT	0	0
5	D020680	UPPER BLADE CLAMP, LOWER SIDE, SHIM, 2mm	304, 316 OR 302 SSSL	1	0	1
4	D1100785-472	WASHER, FLAT, 0.25 X 0.472 O.D.	NITRONIC 60	4	1	5
3	-	SCREW, SOCKET HEAD CAP, 1/4-20 UNC-2A X 0.375 LONG	300 SSSL	3	1	4
2	D030447	ROTATING PLATE, ROTATIONAL ADJUSTER	304, 316 OR 302 SSSL	1	0	1
1	D030448	BASE PLATE, ROTATIONAL ADJUSTER	6061-T6 Al	1	0	1
PARTS LIST						

NOTES AND TOLERANCES: (UNLESS OTHERWISE SPECIFIED)				CALIFORNIA INSTITUTE OF TECHNOLOGY MASSACHUSETTS INSTITUTE OF TECHNOLOGY		PART NAME				ROTATIONAL ADJUSTER ASSY							
				SYSTEM		SUB-SYSTEM		DESIGNER		DATE		SIZE		DWG. NO.		REV.	
				ADVANCED LIGO		SUS		D. BRIDGES		21 SEP 2012		c		D030451		v2	
MATERIAL				FINISH		NEXT ASSY		CHECKER		DATE		SCALE		PROJECTION		SHEET 1 OF 1	
--				N/A μinch		SUSPENDED MASS ASSY, OMCS		B. MOORE		25 SEP 2012		SCALE: 1:1					