

| REV. | DATE       | DCN #        | DRAWING TREE # |
|------|------------|--------------|----------------|
| A    | 6 AUG 2008 | D080422-00-D |                |
|      |            |              |                |
|      |            |              |                |

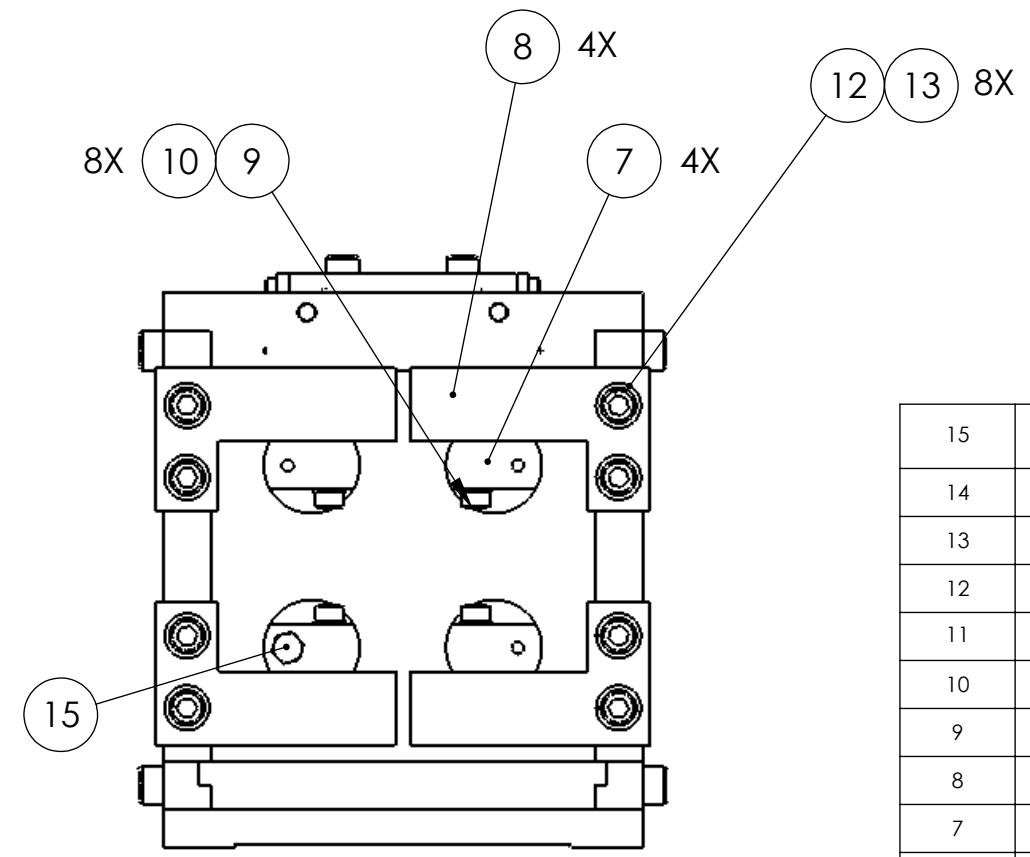
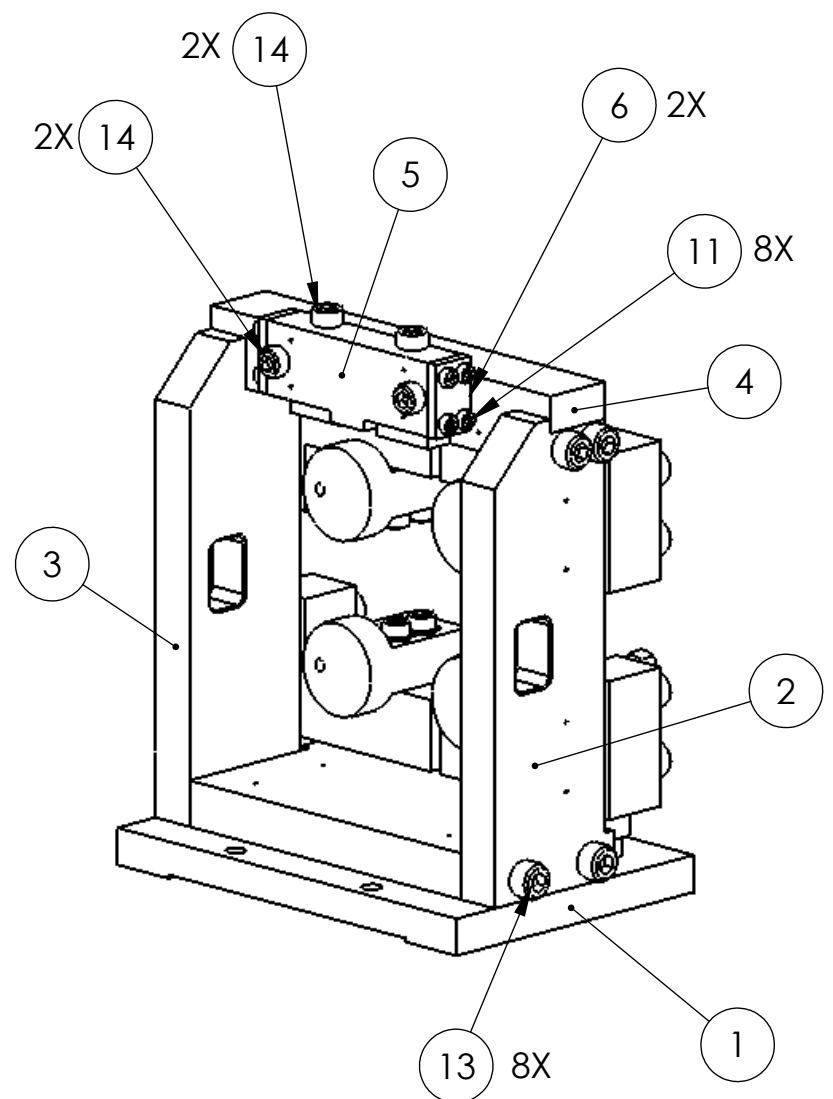

| ITEM NO. | REQ | SPARE | TOTAL | PART NUMBER | DESCRIPTION                              | MATERIAL              |
|----------|-----|-------|-------|-------------|--|-----------------------|
| 15       | A/R | -     | A/R   | D000255     | PAM Screw Assembly                       | Non-Magnetic SSSL     |
| 14       | 4   | 1     | 5     | -           | SCREW, SOCKET HEAD CAP, #10-24 X 1 LG    | 300 SSSL              |
| 13       | 16  | 4     | 20    | -           | SCREW, SOCKET HEAD CAP, 1/4-20 X 1 LG    | 300 SSSL              |
| 12       | 8   | 2     | 10    | -           | WASHER, FLAT, 1/4                        | 300 SSSL              |
| 11       | 8   | 2     | 10    | -           | SCREW, SOCKET HEAD CAP, #4-40 X 0.375 LG | Ag-PLATED 300 SSSL    |
| 10       | 8   | 2     | 10    | -           | WASHER, FLAT, #8                         | 300 SSSL              |
| 9        | 8   | 2     | 10    | -           | SCREW, SOCKET HEAD CAP, #8-32 X 1 LG     | 300 SSSL              |
| 8        | 4   | 1     | 5     | D080450     | PASSIVE ECD MOUNT                        | 6061-T6 AL            |
| 7        | 4   | 1     | 5     | D080449     | PASSIVE ECD                              | 6061-T6 AL            |
| 6        | 2   | 2     | 4     | D080065     | SUSPENSION WIRE CLAMP                    | 304, 316, OR 302 SSSL |
| 5        | 1   | 0     | 1     | D080064     | SUSPENSION BAR                           | 304, 316, OR 302 SSSL |
| 4        | 1   | 0     | 1     | D080063     | SUSPENSION BLOCK                         | 6061-T6 AL            |
| 3        | 1   | 0     | 1     | D080062     | STRUCTURE SIDE, LEFT                     | 6061-T6 AL            |
| 2        | 1   | 0     | 1     | D080061     | STRUCTURE SIDE, RIGHT                    | 6061-T6 AL            |
| 1        | 1   | 0     | 1     | D080060     | STRUCTURE BASE                           | 6061-T6 AL            |

**PARTS LIST**

NOTES: (UNLESS OTHERWISE SPECIFIED)

DIMENSIONS ARE IN INCHES  
 TOLERANCES:  
 .XX ± 0.01  
 .XXX ± 0.005  
 ANGULAR ± 0.5°  
 FINISH --  
 -- μ inch

|          |          |             |
|----------|----------|-------------|
| DRAWN    | M. Meyer | 31 JUL 2008 |
| CHECKED  | J. ROMIE | 4 AUG 2008  |
| APPROVED |          |             |

**LIGO** CALIFORNIA INSTITUTE OF TECHNOLOGY  
 MASSACHUSETTS INSTITUTE OF TECHNOLOGY  
 IGR, GLASGOW UNIVERSITY GEO 600 GROUP

SYSTEM **ADVANCED LIGO**  
 SUB-SYSTEM **SUS**  
 NEXT ASSY **D080447**  
 PART NAME **STRUCTURE ASSY (PASSIVE)**  
 SIZE DWG. NO. **D080448** REV. **A**  
 SCALE: 1:2 PROJECTION: SHEET 1 OF 1