

REV.	DATE	DCN #	DRAWING TREE #
A	13/OCT/06	E060239	.
B	19/DEC/07	E060239-B	.

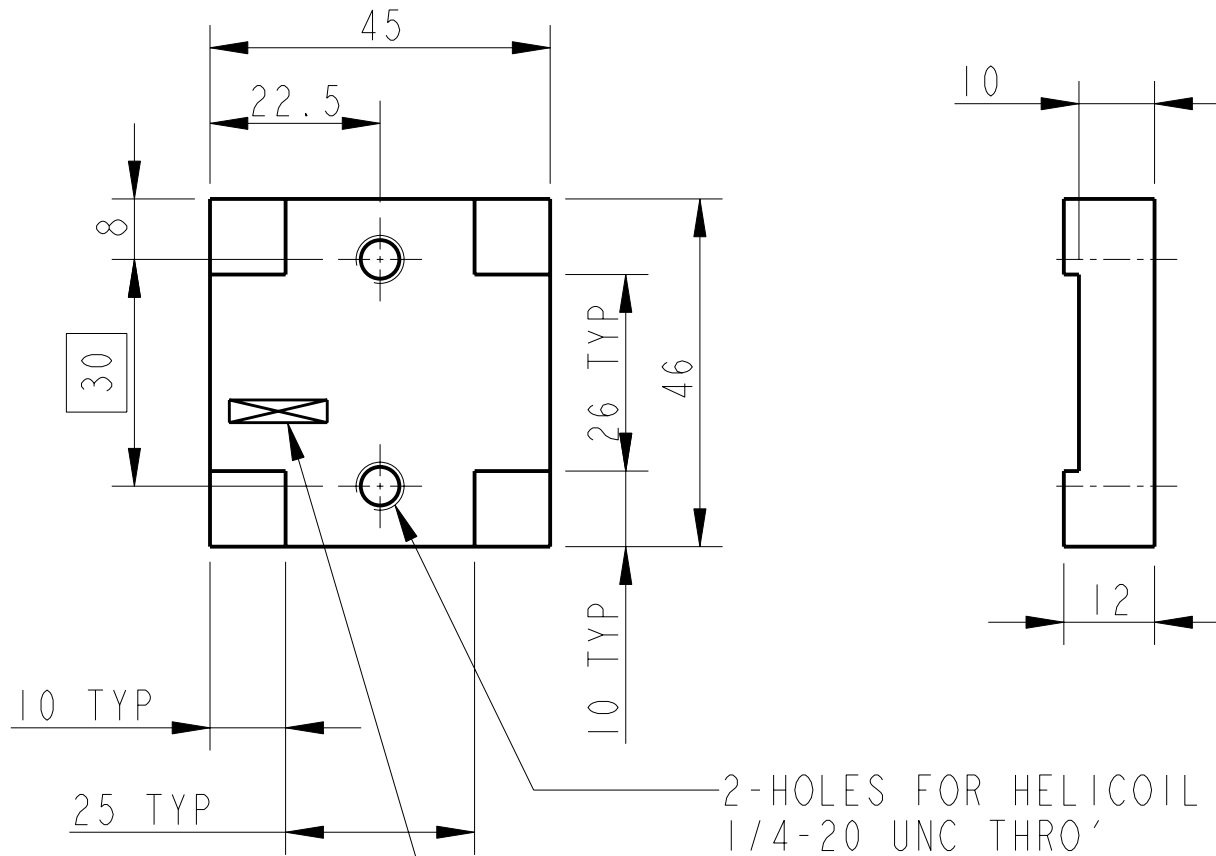

2-HOLES FOR HELICOIL
1/4-20 UNC THRO'

HELICOILS NOT TO BE FITTED. $\text{⊕} \text{⊘} 0.2$

PART NO. (SEE NOTE 4)
TO BE ETCHED OR STAMPED
IN APPROX POSITION SHOWN.

NOTES: (UNLESS OTHERWISE SPECIFIED)			CALIFORNIA INSTITUTE OF TECHNOLOGY MASSACHUSETTS INSTITUTE OF TECHNOLOGY IGR, GLASGOW UNIVERSITY GEO 600 GROUP RUTHERFORD APPLETON LABORATORIES	
1. REMOVE ALL SHARP EDGES, R.02 MIN. 2. DO NOT SCALE FROM DRAWING. 3. ALL MACHINING FLUIDS SHALL BE WATER SOLUBLE AND FREE OF SULFUR, CHLORINE AND SILICONE, SUCH AS CINCINNATI MILACRON'S CIMTECH 410 (STAINLESS STEEL) 4. SCRIBE, ENGRAVE OR STAMP DRAWING PARTNUMBER ON NOTED SURFACE OF PART AND A THREE DIGIT SERIAL NUMBER. SERIAL NUMBERS START AT 001 FOR THE FIRST PART AND PROCEED CONSECUTIVELY. USE .07" HIGH CHARACTERS. EXAMPLE: D020188- 001. A VIBRATORY TOOL MAY BE USED.	DIMENSIONS ARE IN mm [INCHES]			
	TOLERANCES:		X.XX ±0.2 mm ANGULAR ±0.25°	
	MATERIAL:	AL ALLOY 5083 T4	SYSTEM ADVANCED LIGO	
	FINISH:	SEE NOTE 3 √μm [μin] Ra = 1.6	SUB-SYSTEM SUS	
	NAME	DATE	NEXT ASSY QUAD N-PTYPE	
DRAWN	I WILMUT	26/JUN/06	PART NAME TABLECLOTH PINCH PLATE UPPER STRUCTURE	
CHECKED	J'OD	28/SEP/06	SIZE A	DRG. NO. D060315
APPROVED	IW	28/SEP/06	SCALE 1:1	PROJECTION:
			SHEET	1 OF 1