

REV.	DATE	DCN #	DRAWING TREE #
B	21/DEC/07	E060260-B	
C	22/JULY/08	E080372	

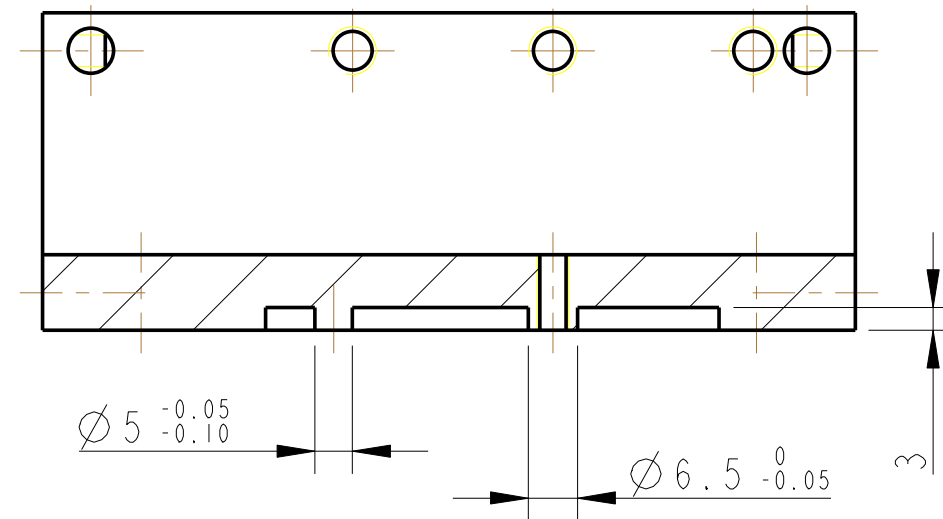

SECTION A-A

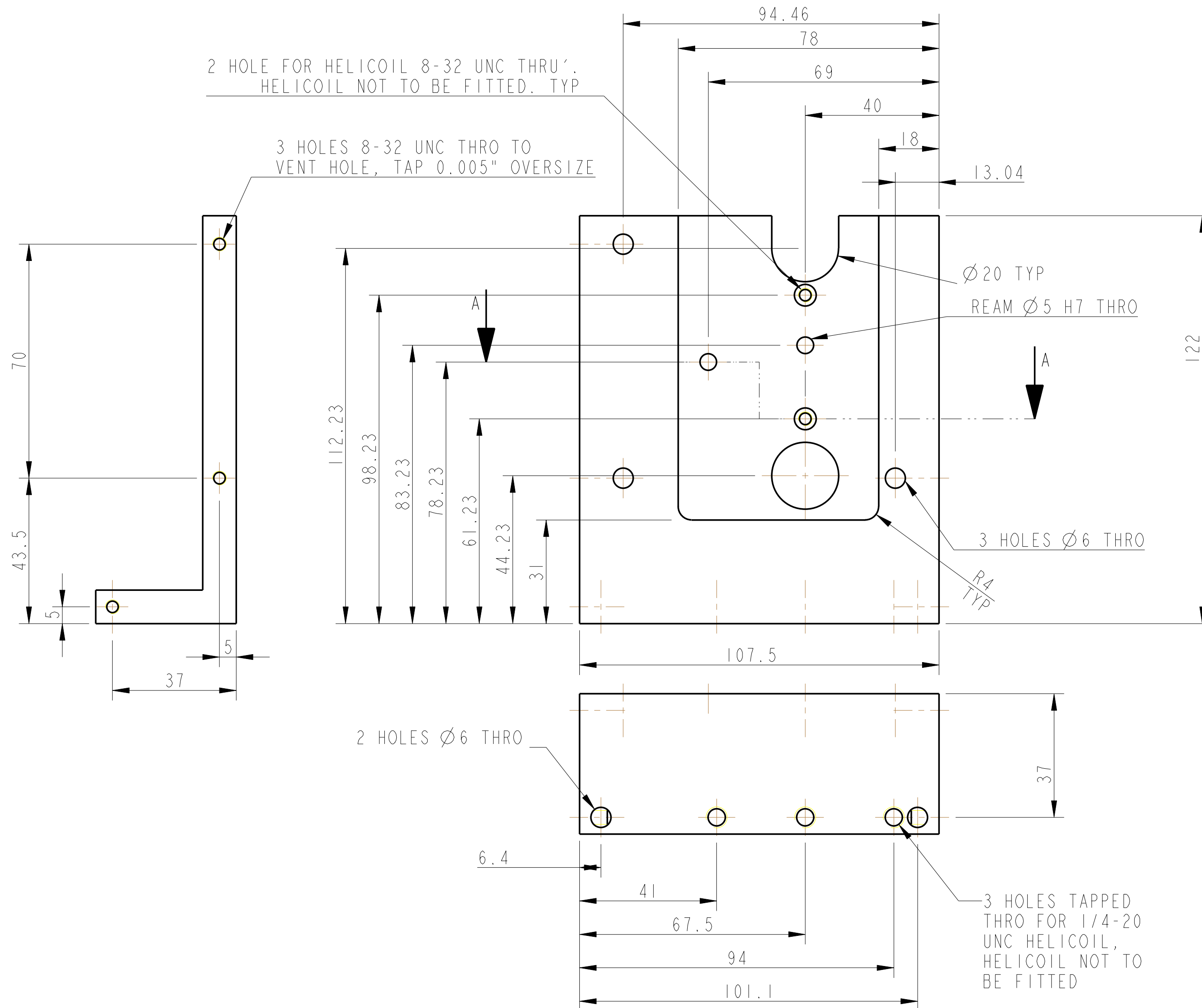

2 HOLE FOR HELICOIL 8-32 UNC THRU'. HELICOIL NOT TO BE FITTED. TYP

3 HOLES 8-32 UNC THRU TO VENT HOLE, TAP 0.005" OVERSIZE

Ø20 TYP
REAM Ø5 H7 THRO

3 HOLES Ø6 THRO

2 HOLES Ø6 THRO

3 HOLES TAPPED THRU FOR 1/4-20 UNC HELICOIL, HELICOIL NOT TO BE FITTED

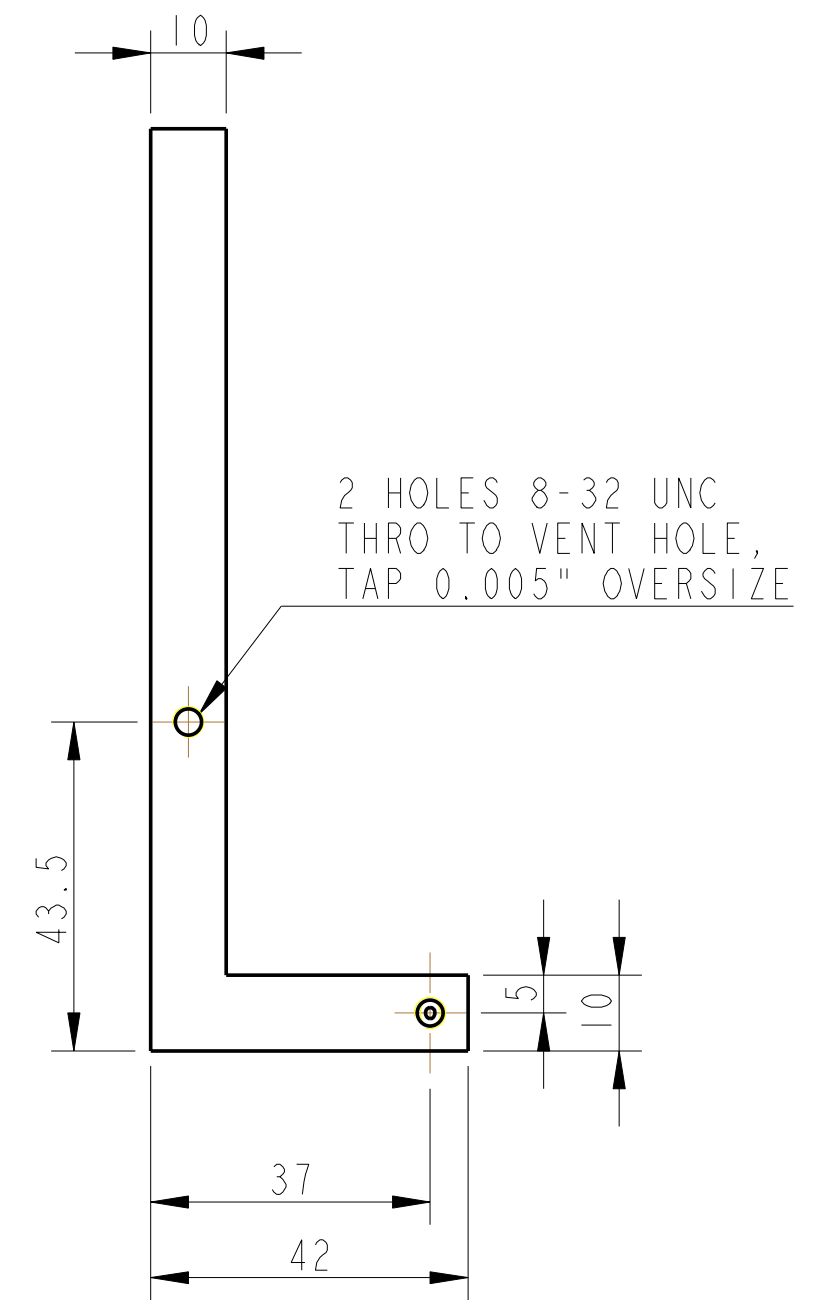

2 HOLES 8-32 UNC THRU TO VENT HOLE, TAP 0.005" OVERSIZE

NOTES: (UNLESS OTHERWISE SPECIFIED)		DIMENSIONS ARE IN mm (INCHES)	
1. REMOVE ALL SHARP EDGES. R.02 MIN.	2. DO NOT SCALE FROM DRAWING.	X.XX ± mm (INCHES)	ANGULAR ±0.25°
3. ALL MACHINING FLUIDS SHALL BE WATER SOLUBLE AND FREE OF SULFUR, CHLORINE AND SILICONE, SUCH AS CINCINNATI MILACRON'S CIMTECH 410 (STAINLESS STEEL)	4. SCRIBE, ENGRAVE OR STAMP DRAWING PART NUMBER ON NOTED SURFACE OF PART AND A THREE DIGIT SERIAL NUMBER. SERIAL NUMBERS START AT 001 FOR THE FIRST PART AND PROCEED CONSECUTIVELY. USE .07" HIGH CHARACTERS. EXAMPLE: D020188-001. A VIBRATORY TOOL MAY BE USED.	MATERIAL: AL ALLOY 6061	FINISH: CLEAN AND DEGREASED √µm [µin] Ra = 1.6
		DRAWN I WILMUT 29/NOV/07	CHECKED AJB 19MAY08
		APPROVED AJB 22/JULY/08	
		CALIFORNIA INSTITUTE OF TECHNOLOGY MASSACHUSETTS INSTITUTE OF TECHNOLOGY IGR, GLASGOW UNIVERSITY GEO 600 GROUP RUTHERFORD APPLETON LABORATORIES	
		SYSTEM ADVANCED LIGO	
		SUB-SYSTEM SUS	
		NEXT ASSY D080454	
		PART NAME REACTION CHAIN UIM STOP LEFT HAND	
		DRG. NO. D070546	REV. C
		SCALE 1:1 PROJECTION: SHEET 1 OF 1	