

Ass1-Flexure
 Capacitive readout
 AC actuation (coil on frame);
 use CW = 40.0
 c.o.w. position = +0.021 mm
 mass = 2.899 Kg

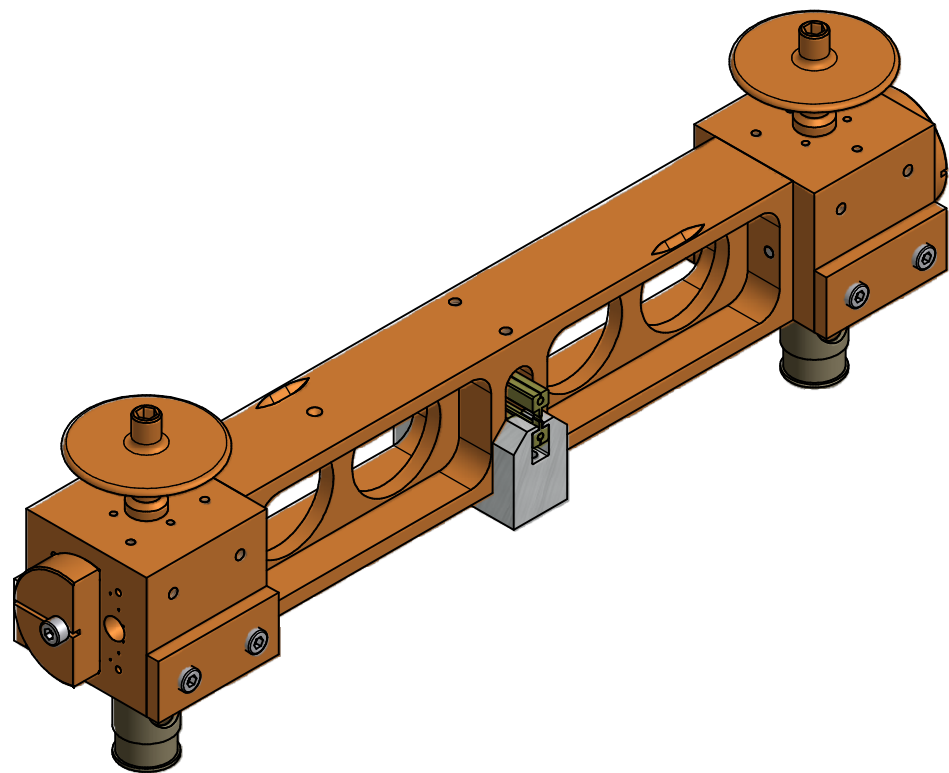

Ass2-Flexure
 Capacitive readout
 DC actuation (magnet on frame);
 use CW = 40.0
 c.o.w. position = +0.081 mm
 mass = 2.893 Kg

	LIGO PROJECT	DESIGNED FOR	R. De Salvo
		DRAWN BY	G. Gennaro-PROMEC
TITLE TILTMETER ASS. FLEXURE CAPACITIVE		DATE	14-06-08
		LIGO-D081019-00-D	
		SCALE	1/1
			A2