

NOTES:
 ① HELICOILS TO BE INSTALLED INTO ITEM NO. 1 BY LIGO PRIOR TO ASSEMBLY AND AFTER ALL PARTS ARE CLEANED AND BAKED.
 ② RIGHT HAND CONFIGURATION IDENTICAL EXCEPT ITEM NO. 1 IS REVERSED IN ORDER TO KEEP EQ STOP AWAY FROM CHAMFERED EDGE OF MASS.

REV.	DATE	DCN #	DRAWING TREE #
v1	12 OCT 2009	-	E0900353
v2	09 JUN 2010	E0900505	E0900353
-	-	-	-

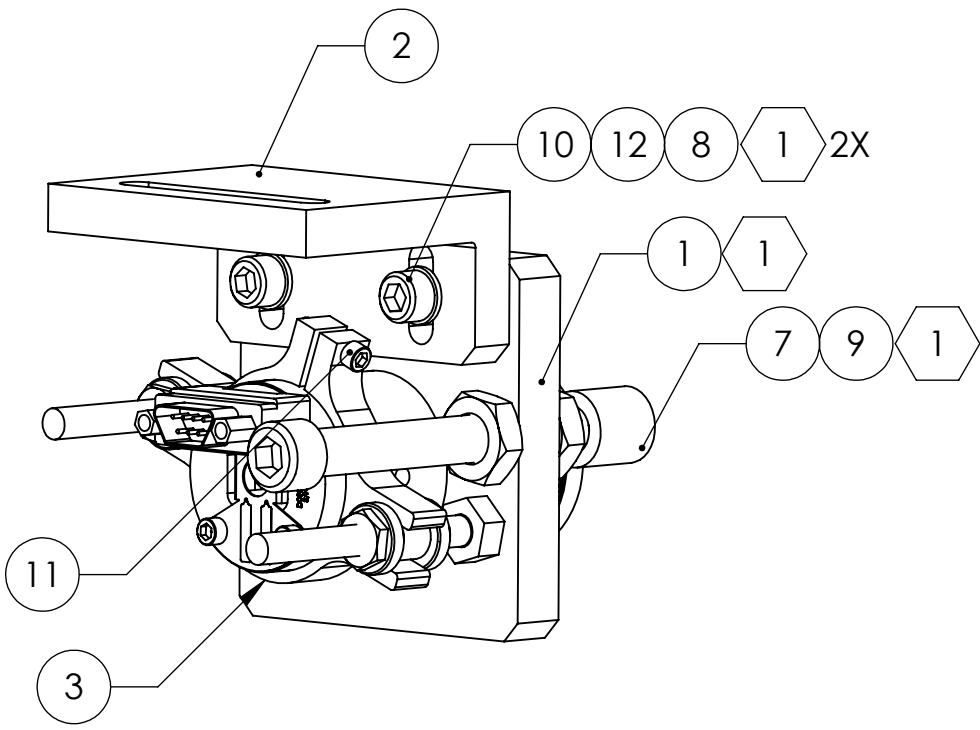

LEFT HAND CONFIGURATION ②

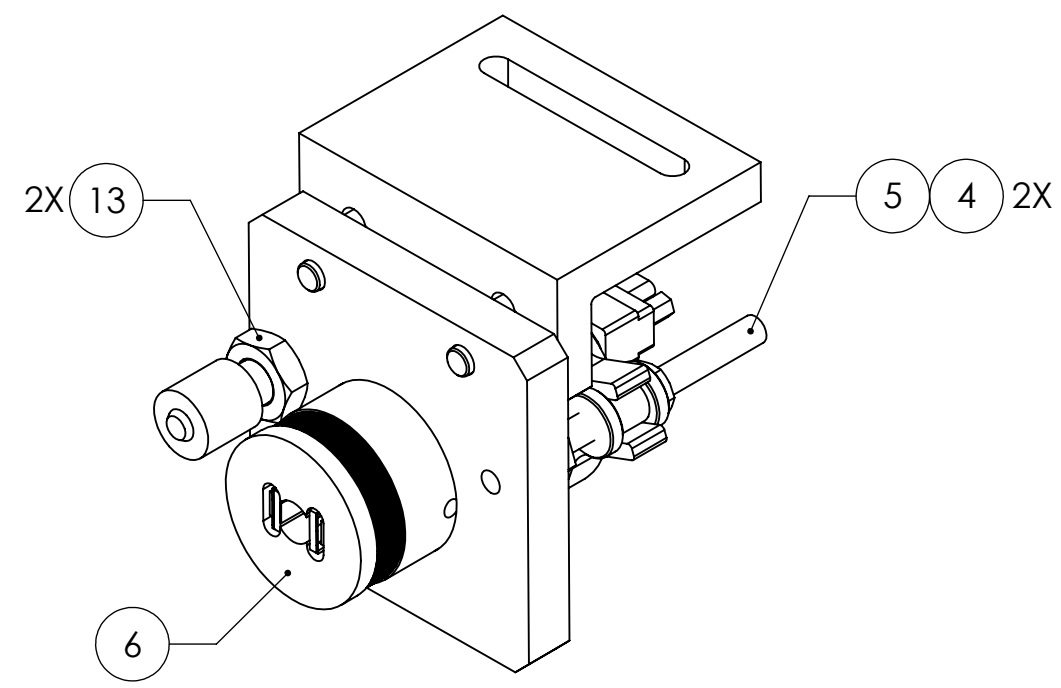

REVERSE ISOMETRIC VIEW

ITEM NO.	PART NUMBER	DESCRIPTION	MATERIAL	REQ	SPARE	TOTAL
13	-	JAM NUT, 1/4-20	300 SSSL	2	-	2
12	-	WASHER, FLAT, #8, VENTED (NAS 620-C8 OR EQUIVALENT)	300 SSSL	2	-	2
11	-	SCREW, SOCKET HEAD CAP, #2-56 UNC-2A X 0.375 LONG	300 SSSL	1	-	1
10	-	SCREW, SOCKET HEAD CAP, #8-32 UNC-2A X 0.625 LONG	300 SSSL	2	-	2
9	1185-4EN250	HELICOIL, 1/4-20 X 0.25 LONG ①	NITRONIC 60	1	1	2
8	1185-2EN246	HELICOIL, #8-32 X 0.246 LONG ①	NITRONIC 60	2	1	3
7	D0900932	EARTHQUAKE STOP FOR GLASS (GLASS TIP), SIMPLIFIED, 2 INCH	N/A	1	-	1
6	D0901065	AOSEM ASSEMBLY	N/A	1	-	1
5	D1000659	ADJUSTER SHAFT	304, 316 OR 302 SSSL	2	-	2
4	D1000660	ADJUSTMENT NUT	PEEK	2	1	3
3	D0901548	AOSEM ADJUSTMENT COLLAR	6061-T6 Al	1	-	1
2	D0902206	AOSEM ALIGNMENT BRACKET MOUNT, INT. MASS	6061-T6 Al	1	-	1
1	D0902414	AOSEM ALIGNMENT BRACKET, INTER. MASS ①	6061-T6 Al	1	-	1

CALIFORNIA INSTITUTE OF TECHNOLOGY MASSACHUSETTS INSTITUTE OF TECHNOLOGY		PART NAME AOSEM ALIGNMENT ASSY, TEST MASS	
SYSTEM ADVANCED LIGO	SUB-SYSTEM SUS	DESIGNER B. MOORE 07 AUG 2009	SIZE DWG. NO. B D0901924
DRAFTER B. MOORE 03 MAY 2010	CHECKER M. MEYER 04 MAY 2010	APPROVAL	REV. v2
NEXT ASSY D020700	SCALE: 1:1	PROJECTION:	SHEET 1 OF 1

D0901924_AdvLIGO_SUS_HSTS_AOSEM Alignment Assembly, Intermediate Mass, PART PDM REV: X-028, DRAWING PDM REV: X-015