

SECTION A-A

SECTION B-B

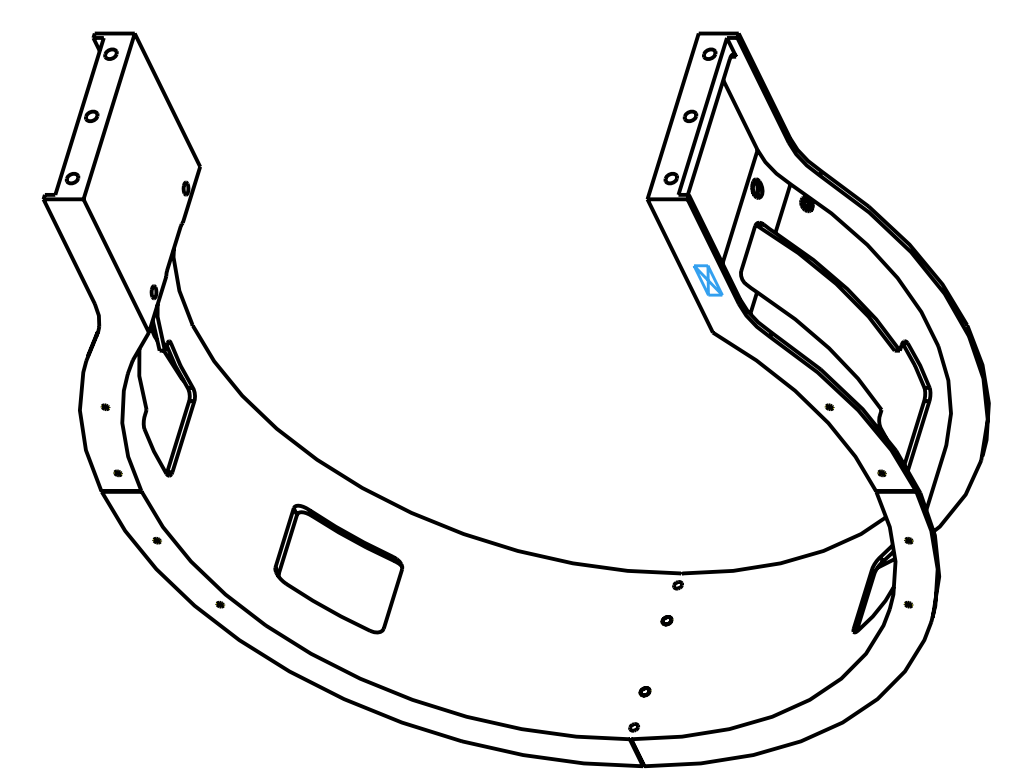

ENGRAVE 3 CENTRE LINES AROUND FACE, AND REPEAT ON OPPOSITE FACE (THESE ARE FOR VISUAL ALIGNMENT, AND WILL FORM A CROSS HAIR)

SEE DETAIL A

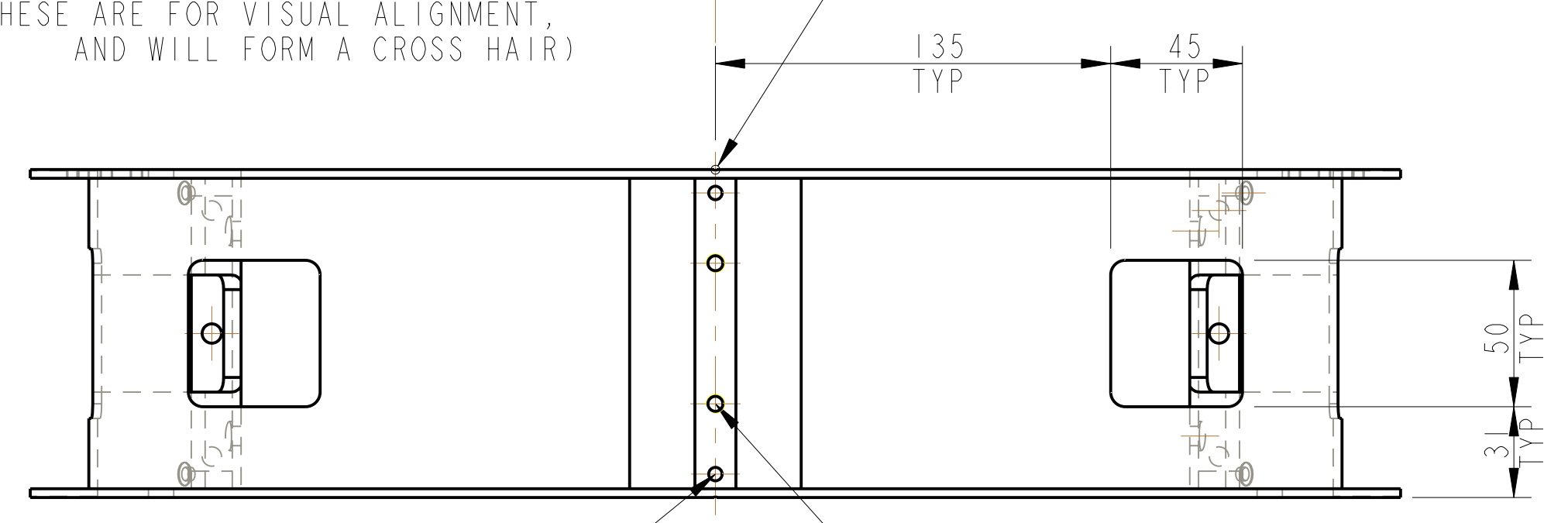

2 HOLES Ø4.6 THRU.

2 HOLES DR THRU. AND TAP FOR 1/4-20 UNC HELICOILS. HELICOILS NOT TO BE FITTED

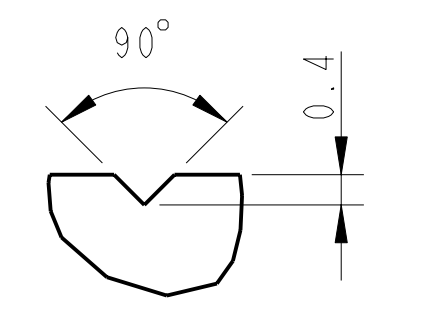

DETAIL A SCALE 10:1 TYP

NOTES: (UNLESS OTHERWISE SPECIFIED)

- REMOVE ALL SHARP EDGES. R.02 MIN.
- DO NOT SCALE FROM DRAWING.
- ALL MACHINING FLUIDS SHALL BE WATER SOLUBLE AND FREE OF SULFUR, CHLORINE AND SILICONE. SUCH AS CINCINNATI MILACRON'S CIMTECH 410 (STAINLESS STEEL).
- SCRIBE, ENGRAVE OR STAMP DRAWING PART NUMBER ON NOTED SURFACE OF PART AND A THREE DIGIT SERIAL NUMBER. SERIAL NUMBERS START AT 001 FOR THE FIRST PART AND PROCEED CONSECUTIVELY. USE 07* HIGH CHARACTERS. EXAMPLE: 000100-001 - A VIBRATORY TOOL MAY BE USED.

DIMENSIONS ARE IN mm (INCHES) TOLERANCES:

X XX ± 0.2 ANGULAR ±0.25 °

MATERIAL: AL ALLOY SORB OR SIMILAR

FINISH: CLEAN, GREASE FREE √(um) (1011) Ra = 1.6

NAME	DATE	SIZE
DRAWN	REV/FEL	DEC 2007
CHECKED	J'00	JAN 2008
APPROVED	TM	JAN 2008

SCALE: 1:1 PROJECTION: 4 SHEET 1 OF 1

CALIFORNIA INSTITUTE OF TECHNOLOGY MASSACHUSETTS INSTITUTE OF TECHNOLOGY OP. GLASGOW UNIVERSITY GEC ROU GROUP RUTHERFORD APPLTON LABORATORIES	SYSTEM ADVANCED LIGO
SUB-SYSTEM SUS	NEXT ASSY DOB0005
PART NAME BS LOWER STRUCTURE BS LS TOP HALF	DRG. NO. DOB0007