

$\varnothing 10 \begin{smallmatrix} 0 \\ -0.009 \end{smallmatrix} (h6)$

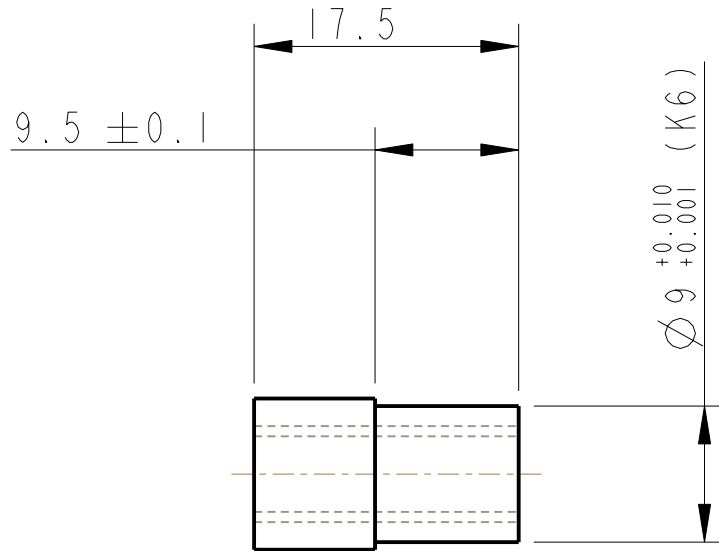
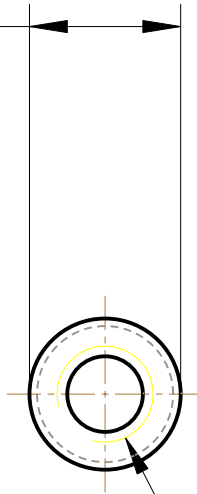

DRILL AND TAP THRO' FOR
1/4-20 UNC HELICOIL,
HELICOIL NOT TO BE FITTED

NOTES: (UNLESS OTHERWISE SPECIFIED)

1. REMOVE ALL SHARP EDGES, R.02 MIN.
2. DO NOT SCALE FROM DRAWING.
3. ALL MACHINING FLUIDS SHALL BE WATER SOLUBLE AND FREE OF SULFUR, CHLORINE AND SILICONE, SUCH AS CINCINNATI MILACRON'S CIMTECH 410 (STAINLESS STEEL)
4. SCRIBE, ENGRAVE OR STAMP DRAWING PARTNUMBER ON NOTED SURFACE OF PART AND A THREE DIGIT SERIAL NUMBER. SERIAL NUMBERS START AT 001 FOR THE FIRST PART AND PROCEED CONSECUTIVELY. USE .07" HIGH CHARACTERS. EXAMPLE: D020188- 001. A VIBRATORY TOOL MAY BE USED.

DIMENSIONS ARE IN mm [INCHES]
TOLERANCES:

X.XX ±0.2 mm
ANGULAR ±0.25 °

MATERIAL: PH.BRONZE
PB2

FINISH: CLEAN, GREASE FREE
√μm [μin]
Ra = 1.6

	NAME	DATE
DRAWN	REV/FEL	21/12/07
CHECKED	J'OD	DEC/07
APPROVED	IW	DEC/07

 CALIFORNIA INSTITUTE OF TECHNOLOGY
MASSACHUSETTS INSTITUTE OF TECHNOLOGY
IGR, GLASGOW UNIVERSITY GEO 600 GROUP
RUTHERFORD APPLETON LABORATORIES

SYSTEM **ADVANCED LIGO**

SUB-SYSTEM **SUS**

NEXT ASSY **D080080**

PART NAME **ROTATIONAL BUSH
BS TOP STAGE**

SIZE **A** DRG. NO. **D080091** REV **E**