

4

3

2

1

NOTES:
 Ⓛ HELICOILS TO BE INSTALLED INTO ITEM NO. 1 BY LIGO PRIOR TO ASSEMBLY AND AFTER ALL PARTS ARE CLEANED AND BAKED.

REV.	DATE	DCN #	DRAWING TREE #
v1	16 JUN 2010	E0900504	E0900353
v2	20 JUN 2011	E1100590	E0900353
-	-	-	-

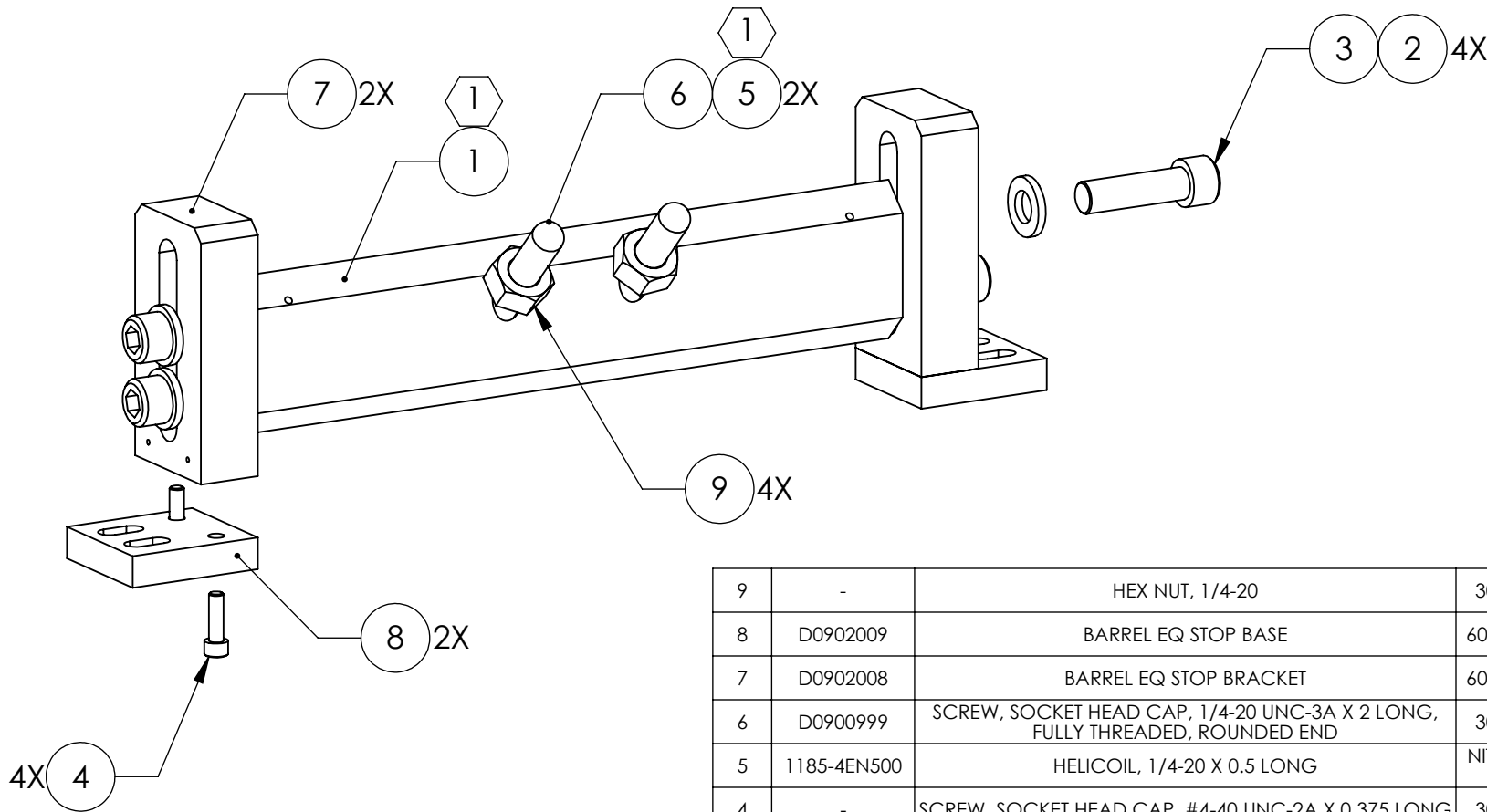

9	-	HEX NUT, 1/4-20	300 SSSL	4		4
8	D0902009	BARREL EQ STOP BASE	6061-T6 Al	2		2
7	D0902008	BARREL EQ STOP BRACKET	6061-T6 Al	2		2
6	D0900999	SCREW, SOCKET HEAD CAP, 1/4-20 UNC-3A X 2 LONG, FULLY THREADED, ROUNDED END	300 SSSL	2		2
5	1185-4EN500	HELICOIL, 1/4-20 X 0.5 LONG	NITRONIC 60	2		2
4	-	SCREW, SOCKET HEAD CAP, #4-40 UNC-2A X 0.375 LONG	300 SSSL	4		4
3	-	SCREW, SOCKET HEAD CAP, 1/4-20 UNC-2A X 0.875 LONG	300 SSSL	4		4
2	-	WASHER, FLAT, 1/4 (NAS 620-C416 OR EQUIVALENT)	300 SSSL	4		4
1	D0901925	BARREL EQ STOP CROSSBAR, INT. WIRE	6061-T6 Al	1		1
ITEM NO.	PART NUMBER	DESCRIPTION	MATERIAL	REQ	SPARE	TOTAL

PARTS LIST

CALIFORNIA INSTITUTE OF TECHNOLOGY MASSACHUSETTS INSTITUTE OF TECHNOLOGY		PART NAME		BARREL EQ STOP ASSY, INT. WIRE		
SYSTEM	ADVANCED LIGO	SUB-SYSTEM	SUS	DESIGNER	B. MOORE	10 OCT 2009
NEXT ASSY	D020700			DRAFTER	B. MOORE	11 JUN 2012
				CHECKER	D. BRIDGES	11 JUN 2012
				APPROVAL		
				SIZE	A	DWG. NO.
						D0902203
				REV.		v2
				SCALE:	3:4	PROJECTION:
						SHEET 1 OF 1

4

3

2

1