

NOTES:
 (1) SCREW DRIVE SYSTEM, UPPER MASS (F/N 11) ATTACHED WITH MARKED HARDWARE IN ORIENTATION AS SHOWN ON SHEET 3.

REV.	DATE	DCN #	DRAWING TREE #
A	24 JUN 2004	E040303-00	-
v1	19 MAR 2010	E0900501	E0900353
v2	20 JUN 2011	E1100590	E0900353

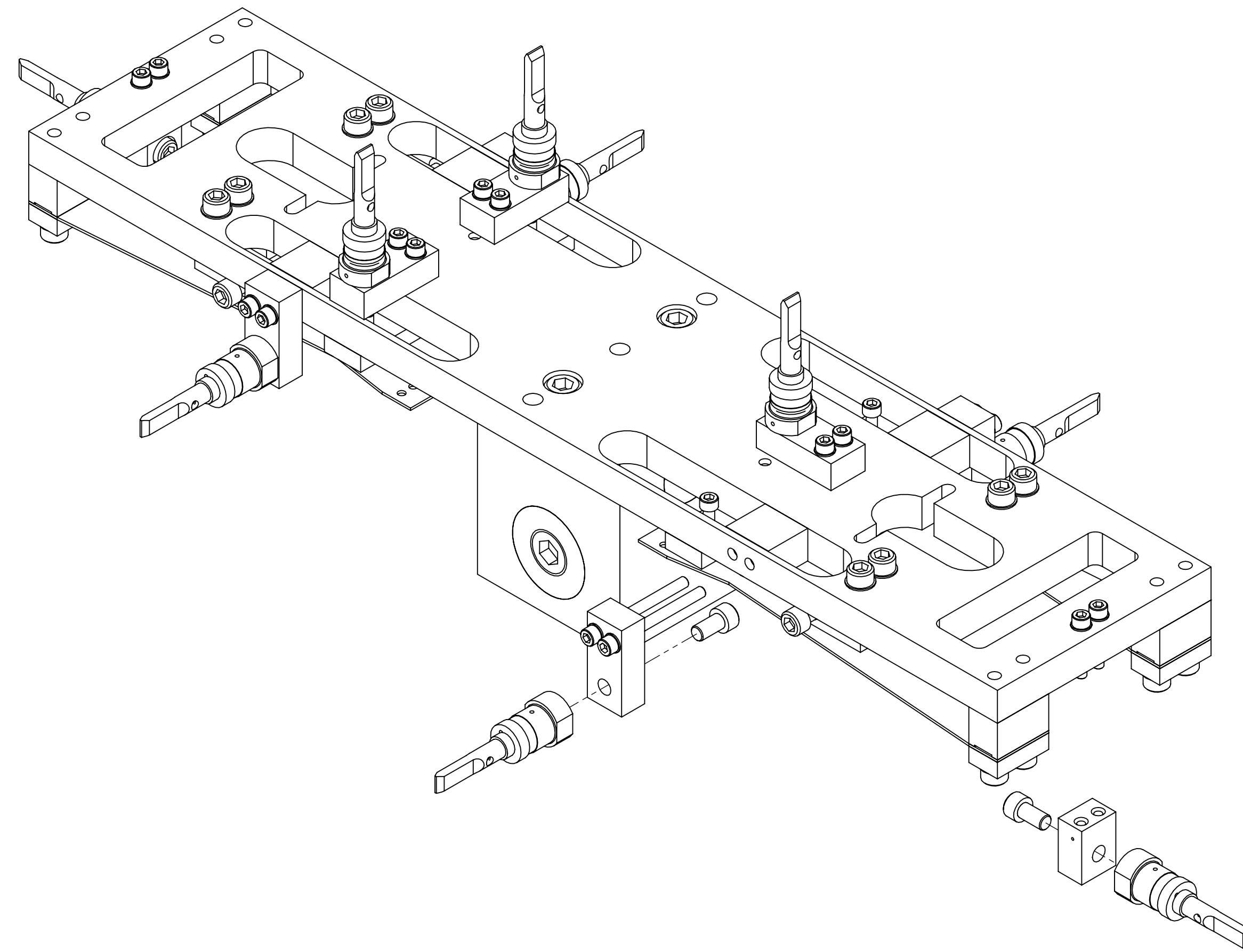

ISOMETRIC VIEW

ITEM NO.	PART NUMBER	DESCRIPTION	MATERIAL	REQ	SPARE	TOTAL
34	D1200447	UPPERMASS BLADE LOCKDOWN, HSTS	300 SSSL	2		2
33	-	SCREW, SOCKET HEAD CAP, #4-40 UNC-2A X 0.5 LONG	300 SSSL	4		4
32	D080761	HSTS LOWER BLADE	MARAGING STEEL C250	4		4
REF	D020677	LIBRARY OF CLAMPS	-	REF	-	REF
30	1185-04EN336	HELICOIL, #4-40 X 0.336 LONG	NITRONIC 60	4		4
29	1185-4EN250	HELICOIL, 1/4-20 X 0.25 LONG	NITRONIC 60	1		1
28	1185-04EN168	HELICOIL, #4-40 X 0.168 LONG	NITRONIC 60	4		4
27	-	SCREW, SOCKET HEAD CAP, #4-40 UNC-2A X 0.625 LONG, FULLY THREADED, ROUNDED	300 SSSL	2		2
26	-	SCREW, SOCKET HEAD CAP, #8-32 UNC-2A X 0.3125 LONG	300 SSSL	9		9
25	-	SCREW, SOCKET SET, #8-32 UNC-2A X 0.25 LONG	Ag-PLATED 300 SSSL	4	1	5
24	-	SCREW, SOCKET HEAD CAP, 1/4-20 UNC-2A X 0.375 LONG	Ag-PLATED 300 SSSL	2	1	3
23	-	SCREW, SOCKET HEAD CAP, #8-32 UNC-2A X 0.625 LONG	300 SSSL	8	2	10
22	-	WASHER, FLAT, #8 (NAS 620-C8L OR EQUIVALENT)	300 SSSL	16	3	19
21	-	SCREW, SOCKET HEAD CAP, #8-32 UNC-2A X 1 LONG	Ag-PLATED 300 SSSL	8	2	10
20	-	SCREW, SOCKET HEAD CAP, #4-40 UNC-2A X 1.25 LONG	Ag-PLATED 300 SSSL	8	2	10
19	-	SCREW, SOCKET HEAD CAP, #4-40 UNC-2A X 0.625 LONG	Ag-PLATED 300 SSSL	2	2	4
18	-	SCREW, SOCKET HEAD CAP, #4-40 UNC-2A X 0.625 LONG	300 SSSL	4	2	6
17	-	WASHER, FLAT, #4 (NAS 620-C4L OR EQUIVALENT)	300 SSSL	18	3	21
16	-	SCREW, SOCKET HEAD CAP, #4-40 UNC-2A X 0.625 LONG, VENTED	Ag-PLATED 300 SSSL	4	1	5
15	-	SCREW, SOCKET HEAD CAP, #8-32 UNC-2A X 0.75 LONG	300 SSSL	4		4
14	-	SCREW, SOCKET SET, 0.5-20 UNF-2A X 2 LONG	Ag-PLATED 300 SSSL	1	-	1
13	D0902418	MAGNET/FLAG ASSY (LONG), UPPER MASS	N/A	6	1	7
12	D0902492	MAGNET/FLAG ASSY (SHORT), UPPER MASS	N/A	3	1	4
11	D020482	SCREW DRIVE SYSTEM, UPPER MASS	6061-T6 Al	4	1	5
10	D020211	MAGNET HOLDER BRACE	6061-T6 Al	4	1	5
9	D020199	MAGNET-FLAG BASE (SHORT), UPPER MASS	6061-T6 Al	2	1	3
8	D0902493	MAGNET/FLAG ASSY BASE PLATE, UPPER MASS	6061-T6 Al	7	1	8
7	D020308	LOWER BLADE CLAMP, LOWER SIDE	304, 316 OR 302 SSSL	4	1	5
6	D020119	LOWER BLADE CLAMP, UPPER SIDE	304, 316 OR 302 SSSL	4	1	5
5	D0902030	BLADE GUARD, UPPER MASS	304, 316 OR 302 SSSL	2	-	2
4	D020676	ROLL INSERT, T-SECTION	304, 316 OR 302 SSSL	1	-	1
3	D020137	PITCH INSERT FOR T-SECTION	304, 316 OR 302 SSSL	1	-	1
2	D020136	T-SECTION FOR UPPER MASS	304, 316 OR 302 SSSL	1	-	1
1	D020134	MAIN SECTION UPPER MASS	304, 316 OR 302 SSSL	1	-	1

CALIFORNIA INSTITUTE OF TECHNOLOGY MASSACHUSETTS INSTITUTE OF TECHNOLOGY		PART NAME		UPPERMASS ASSEMBLY				
SYSTEM	ADVANCED LIGO	SUB-SYSTEM	SUS	DESIGNER	C. TORRIE 11 NOV 2002	SIZE	DWG. NO.	REV.
NEXT ASSY	D020535			DRAFTER	B. MOORE 02 JULY 2012	D	D020534	v2
				CHECKER	M. MEYER 29 OCT 2009			
				APPROVAL		SCALE: 1:1	PROJECTION:	SHEET 1 OF 3

D020534-AssemblyUppermass.PART PDM REV: X-085. DRAWING PDM REV: X-006

