

D1000670_alIGO AOS Photon Calibrator Pier Grout Plate, PART PDM REV: X-013, DRAWING PDM REV: X-005

REV.	DATE	DCN #	DRAWING TREE #
v1	05 MAR 2012	E1200249-x0	-
-	-	-	-
-	-	-	-

5. SCRIBE, ENGRAVE (A VIBRATORY TOOL MAY BE USED), LASER MARK OR MECHANICALLY STAMP (NO INKS OR DYES) DRAWING PART NUMBER, REVISION (AND VARIANT OR "TYPE" IF APPLICABLE) ON NOTED SURFACE OF PART FOLLOWED ON THE NEXT LINE WITH A THREE DIGIT SERIAL NUMBER, SERIAL NUMBERS START AT 001 FOR THE FIRST ARTICLE AND PROCEED CONSECUTIVELY. USE MINIMUM 0.12" HIGH CHARACTERS, UNLESS THE SIZE OF THE PART DICTATES SMALLER CHARACTERS. EXAMPLE: DXXXXXX-VY, TYPE-XX, S/N XXX
6. ALL PARTS SHALL BE MANUFACTURED IN ACCORDANCE WITH LIGO SPECIFICATION E0900364.
7. ALL MATERIAL IS TO BE VIRGIN MATERIAL (i.e. NO WELD REPAIRS, PLUGS OR RECYCLED MATERIAL). NO REPAIRS SHALL BE MADE UNLESS APPROVED IN ADVANCE, AND IN WRITING, BY LIGO LABORATORY. REFER TO LIGO-E0900364.
8. MATERIAL: 6061 ALUM. TOOL PLATE
9. HARD ANODIZE PER MIL-A-8625, TYPE III, CL 1.

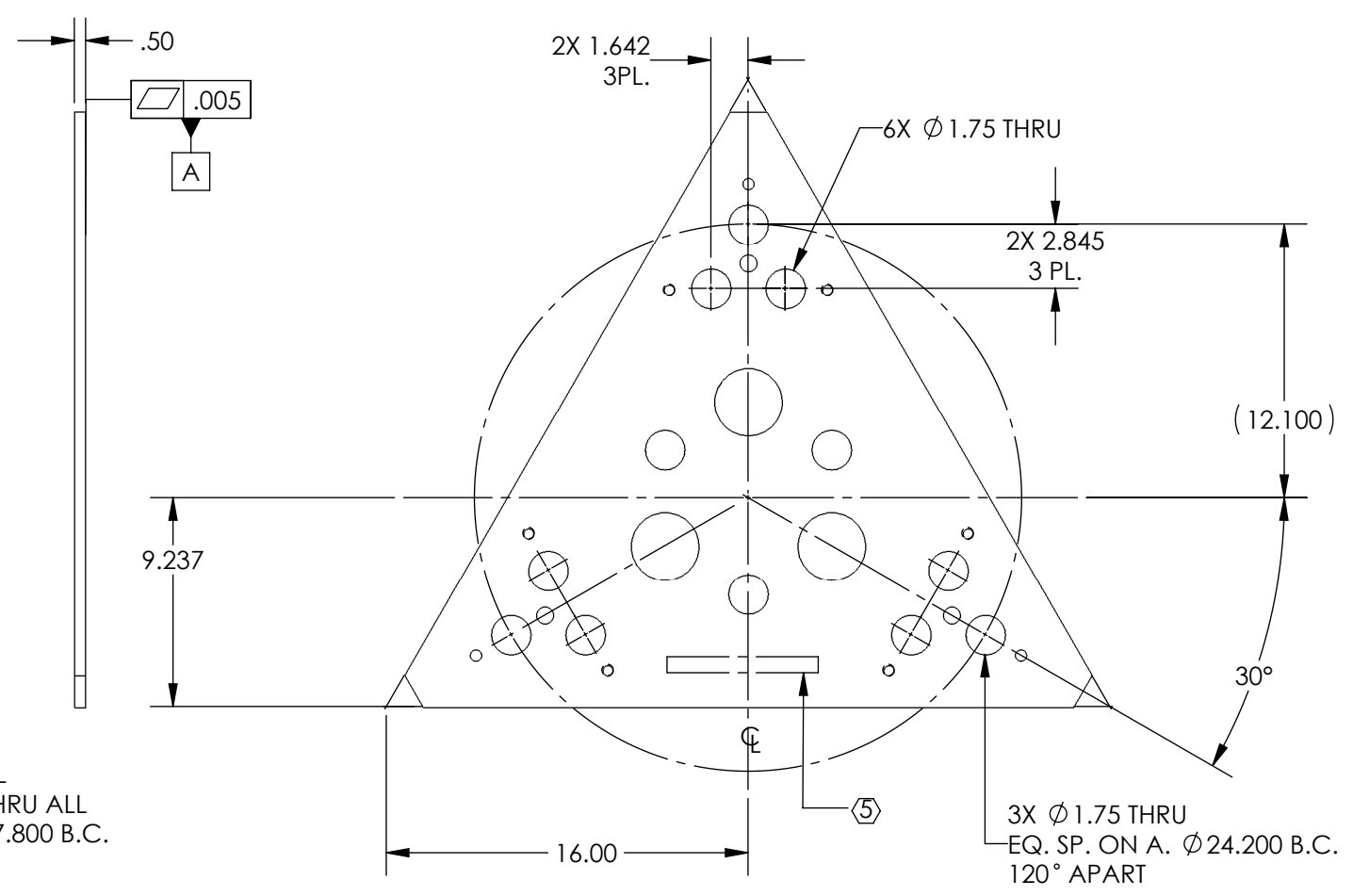
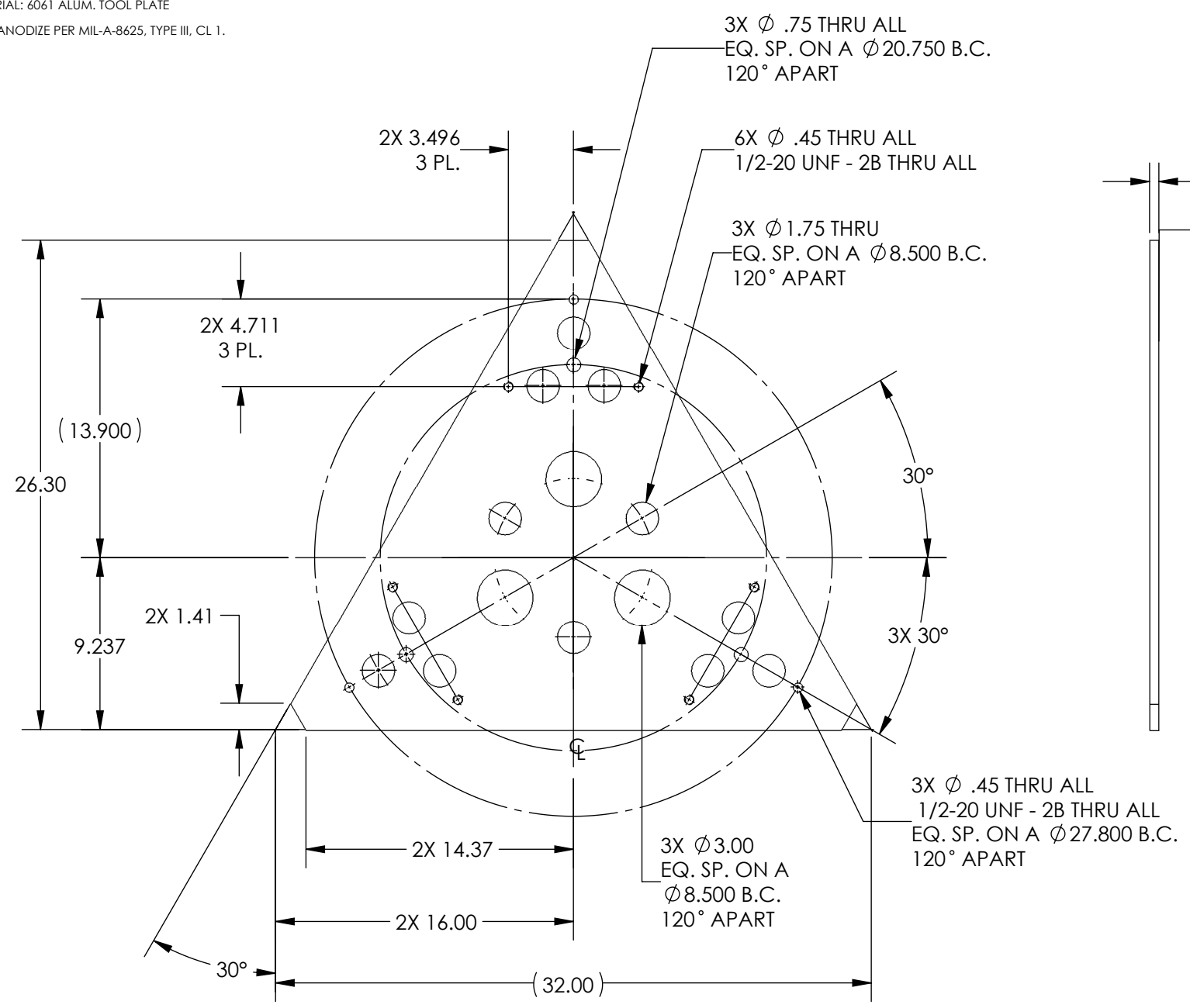

NOTES AND TOLERANCES: (UNLESS OTHERWISE SPECIFIED)	
DIMENSIONS ARE IN INCHES	
TOLERANCES: .XX ± .01 .XXX ± .005	
ANGULAR ± 0.5°	
MATERIAL	FINISH
6061 ALUM. TOOL PLATE	N/A μinch

CALIFORNIA INSTITUTE OF TECHNOLOGY MASSACHUSETTS INSTITUTE OF TECHNOLOGY		PART NAME ALIGO, AOS, PHOTOCAL TX, GROUT PLATE	
SYSTEM	SUB-SYSTEM	DESIGNER	DATE
ADVANCED LIGO	AOS	C. CONLEY	24 MAR 2010
CHECKER	SEE DCC	DRAFTER	05 MAR 2012
APPROVAL	SEE DCC	SEE DCC	SEE DCC
NEXT ASSY		SIZE	DWG. NO.
D1000676		B	D1000670
		SCALE	PROJECTION
		1:8	1st ANGLE
		SHEET 1 OF 1	