

NOTES CONTINUED:

REV.	DATE	DCN #	DRAWING TREE #
v1	02 AUG 2010	E1000285	E1000668
-	-	-	-
-	-	-	-

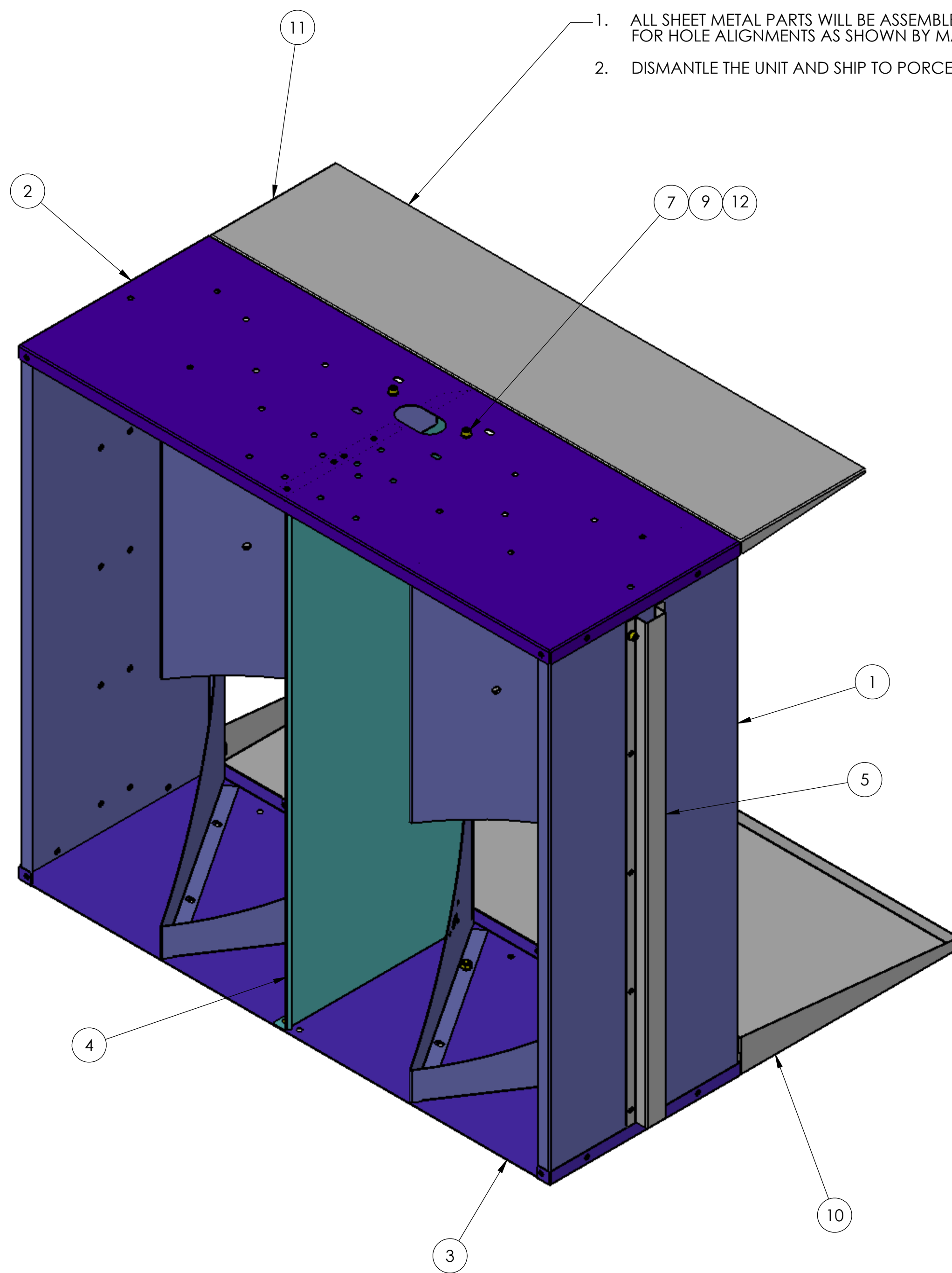

1. ALL SHEET METAL PARTS WILL BE ASSEMBLED AND INSPECTED FOR HOLE ALIGNMENTS AS SHOWN BY MANUFACTURING.
2. DISMANTLE THE UNIT AND SHIP TO PORCELAIN ENAMELING.

15	90313A200	WASHER, FLAT, #10 (NAS 620-C10 McMASTER	18-8 SSSL	30	15	45
14	92210A999	FLAT HD SHCS #10-24 UNDERCUT, McMaster	18-8 S/S	12	6	18
13	D1001365	ARM BAFFLE MIDDLE REINFORCING PLATE	Enamel A424 Type I	2		2
12	90313A204	WASHER, FLAT, 1/4 , McMASTER	18-8 SSSL	225	112	337
11	D1001026	ARM CAVITY BAFFLE UP LEAF	Enamel Steel A424 Type I	1		1
10	D1001027	ARM CAVITY BAFFLE LOWER LEAF	Enamel Steel A424 Type I	1		1
9	N-2520-A	HEX NUT, 1/4-20, SILVER PLATE, UC COMP.	18-8 S/S	75	37	112
8	N-1024-A	HEX NUT, #10-24, SILVER PLATE, UC COMP.	18-8 S/S	15	7	22
7	92200A537	SCREW, SOCKET HEAD CAP, 1/4-20 UNC-2A X 0.5L, McMaster	300 SSSL	75	37	112
6	92210A236	FLAT HD SHCS #10-24 X.25, UNDERCUT, McMASTER	18-8 SSSL	3	2	5
5	D1001363	ACB SIDE REINFORCING HATSECTION	Enamel Steel A424 Type I	2		2
4	D1000976	ARM CAVITY BAFFLE CTR SKIN	Enamel Steel A424 Type I	1		1
3	D1000975	ARM CAVITY BAFFLE BTM SKIN	Enamel Steel A424 Type I	1		1
2	D1000974	ARM CAVITY BAFFLE TOP SKIN	Enamel Steel A424 Type I	1		1
1	D1000973	ARM CAVITY BAFFLE SKIN	Enamel Steel A424 Type I	1		1

ITEM NO.	PART NUMBER	DESCRIPTION	MATERIAL	Defa ult/Q TY.	SPARE	TOTAL
----------	-------------	-------------	----------	----------------	-------	-------

PARTS LIST

DIMENSIONS ARE IN INCHES
 TOLERANCES:
 .XX ±
 .XXX ±
 ANGULAR ± °

NOTES AND TOLERANCES: (UNLESS OTHERWISE SPECIFIED)
 1. INTERPRET DRAWING PER ASME Y14.5-1994.
 2. REMOVE ALL SHARP EDGES, R.02 MIN.
 3. DO NOT SCALE FROM DRAWING.
 4. ALL MACHINING FLUIDS MUST BE FULLY SYNTHETIC, FULLY WATER SOLUBLE AND FREE OF SULFUR, SILICONE, AND CHLORINE.

LIGO CALIFORNIA INSTITUTE OF TECHNOLOGY
 MASSACHUSETTS INSTITUTE OF TECHNOLOGY

SYSTEM: ADVANCED LIGO SUB-SYSTEM: AOS

MATERIAL: BOM FINISH: N/A NEXT ASSY: D0901376

PART NAME: ARM CAVITY BAFFLE BOX ASSY

DESIGNER	N.Nguyen	01 Jun 2010	SIZE	DWG. NO.	REV.
DRAFTER	N.Nguyen	01 Jul 2010	D	D1000977	v1
CHECKER	M. Smith	10 NOV 2010			
APPROVAL	D. Coyne	20 NOV 2010	SCALE: 1:1	PROJECTION:	SHEET 1 OF 2

D1000977_AudiGO_AOS_31C_ARM Cavity Baffle Box Assy. PART PDM REV: X-059. DRAWING PDM REV: X-023

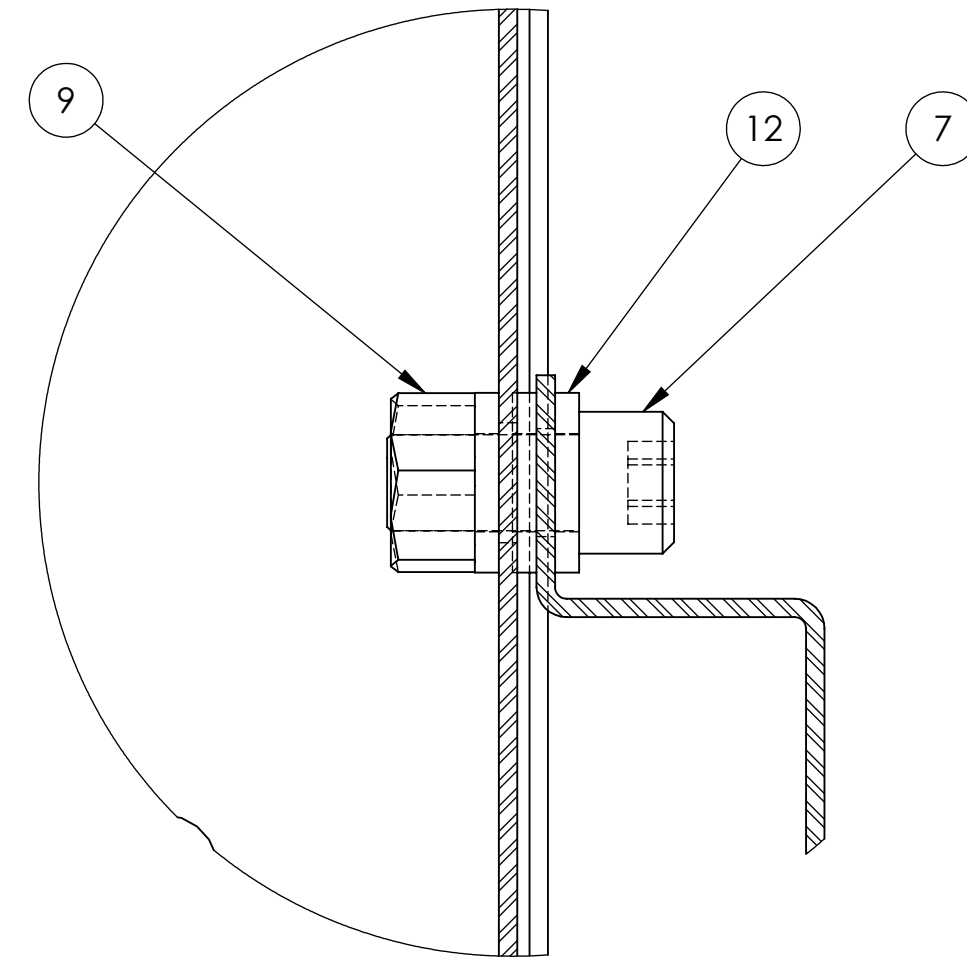
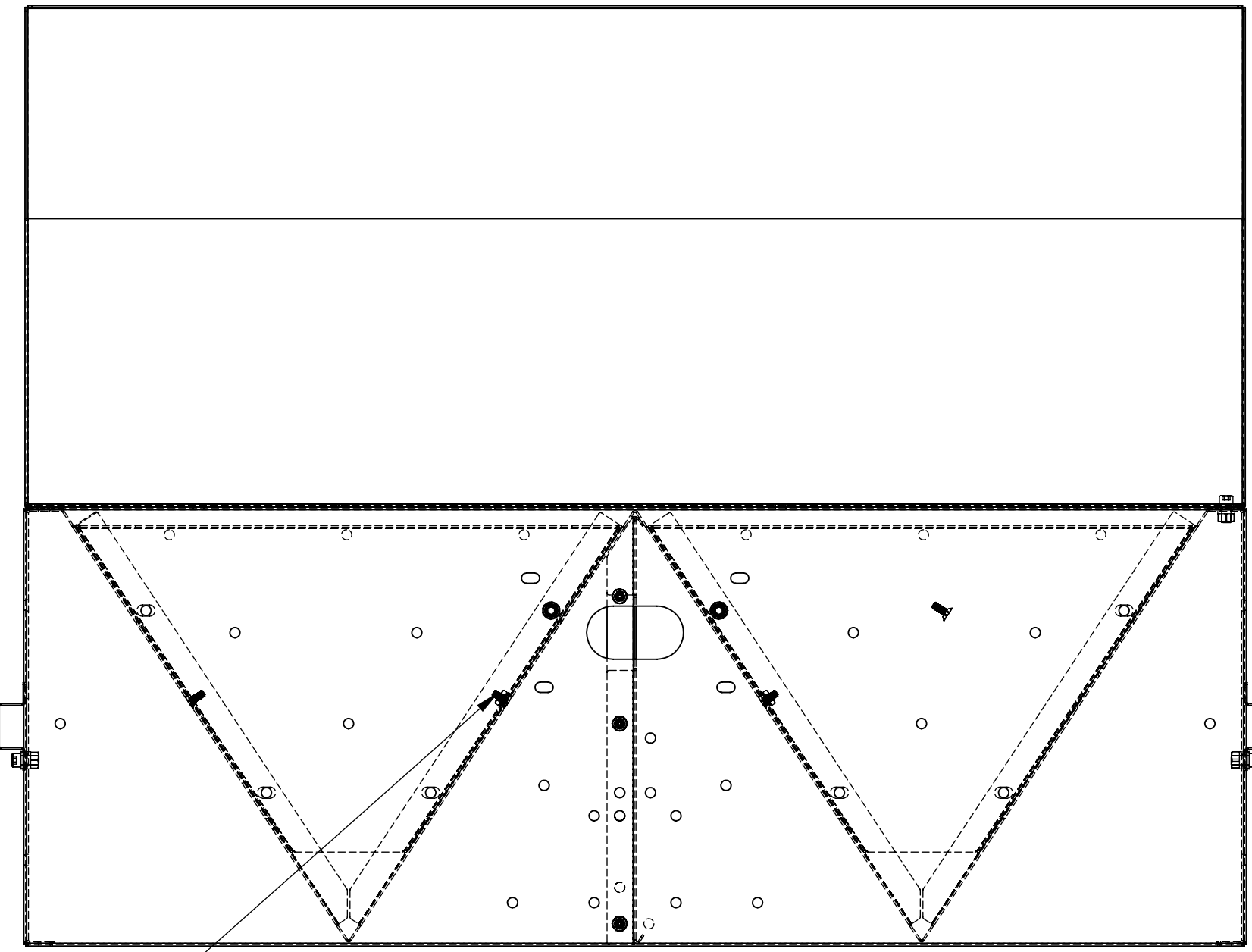

TYPICAL FASTENING DETAIL
SECTION A-A
SCALE 2:1

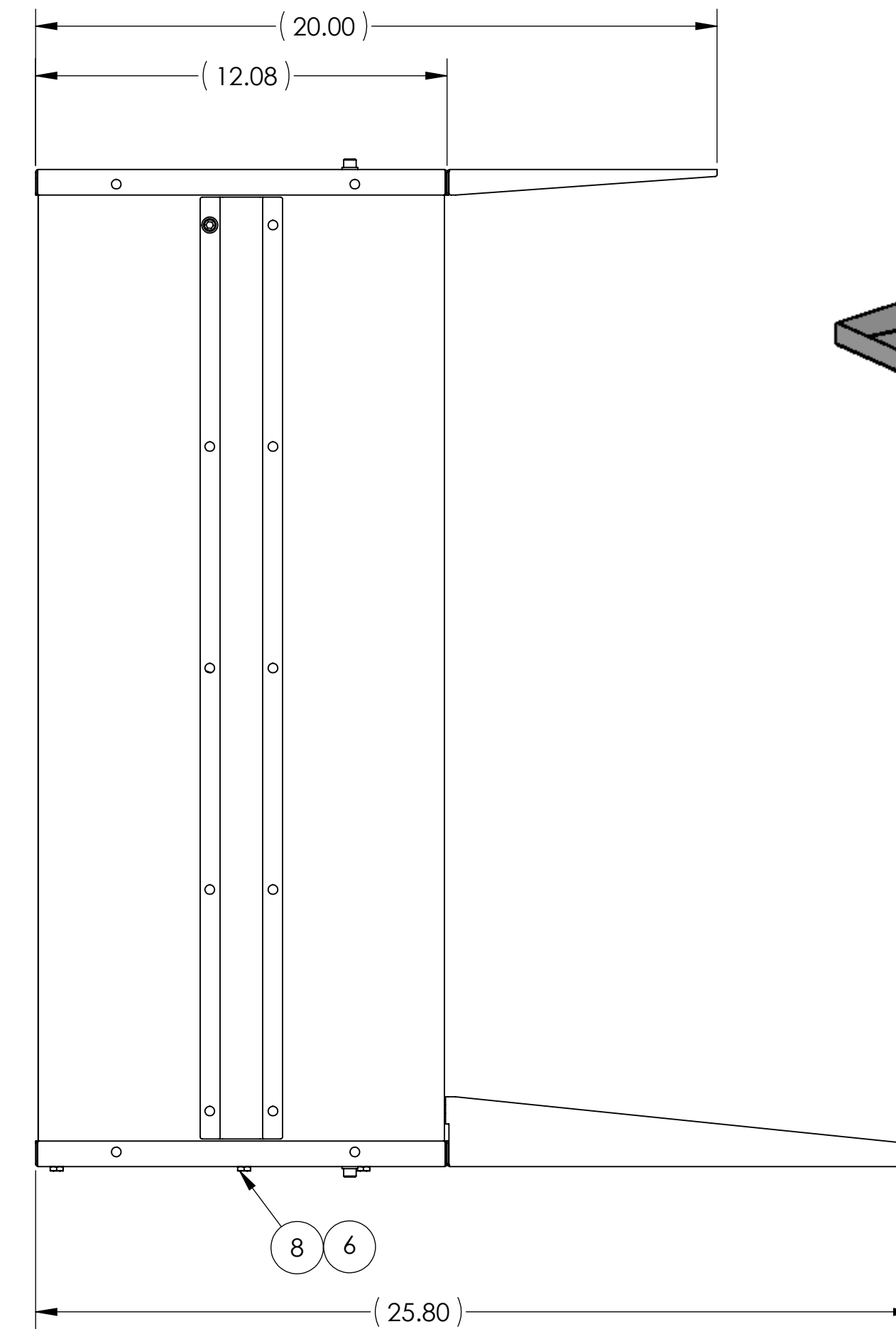
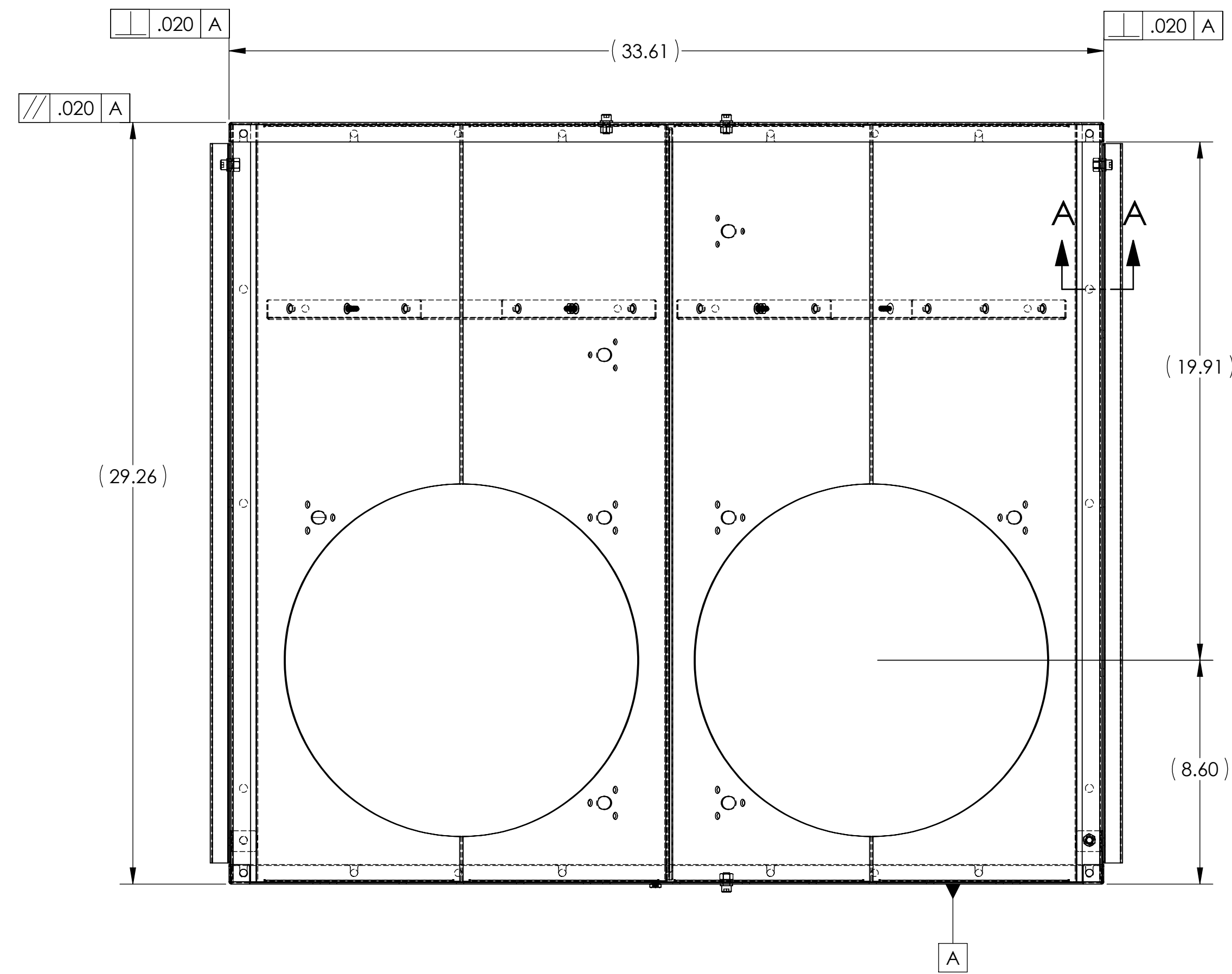
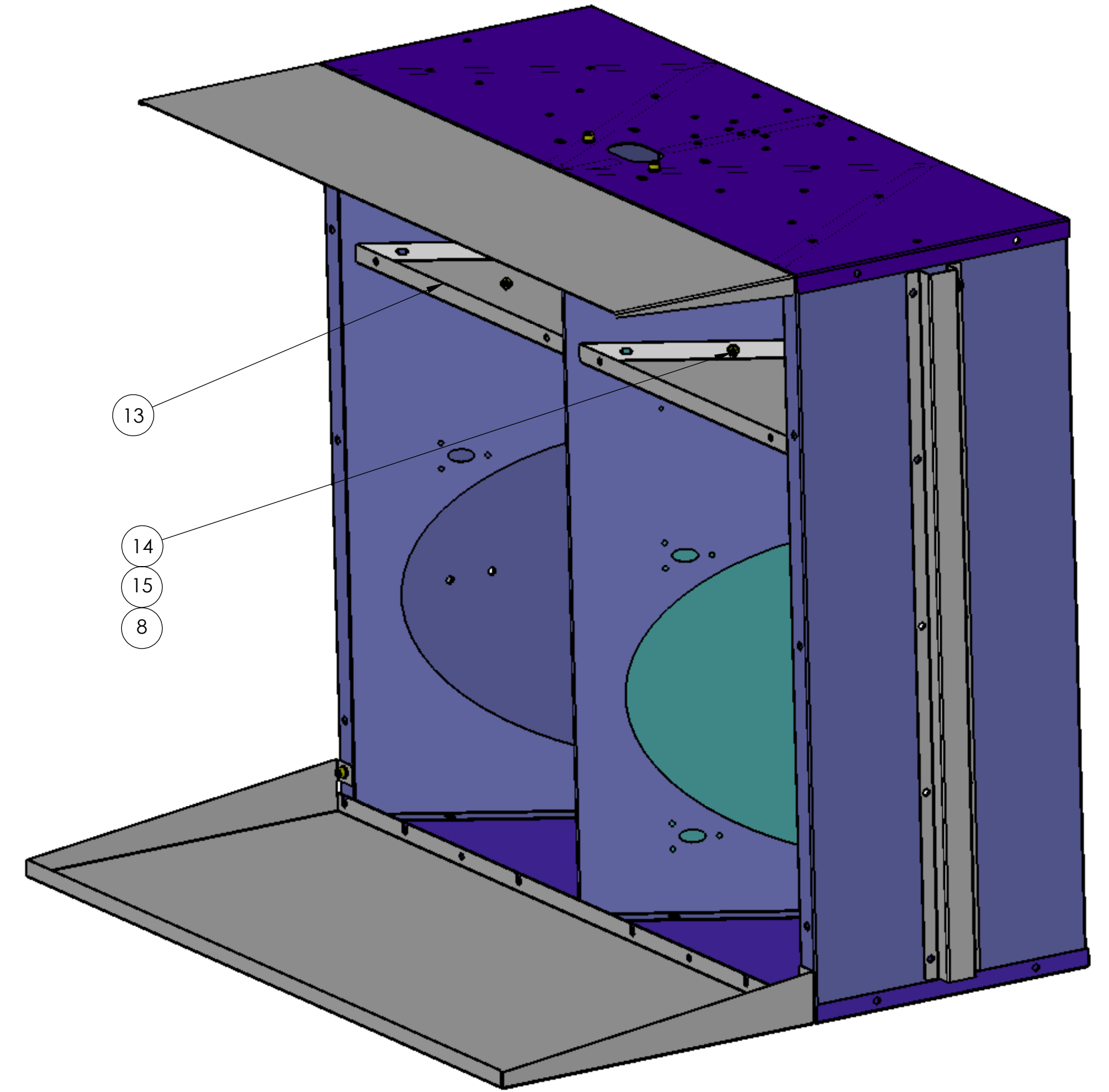

D1000977_AudiLIGO_ACS_SLC_ARM_Cavity_Baffle_Box_Asly_PART PDM REV: X-059 DRAWING PDM REV: X-023