

NOTES CONTINUED:

REV.	DATE	DCN #	DRAWING TREE #
v1	07 APR 2011	E1100216	E1000668
v2	18 Aug. 2011	PRELIMINARY	-
v3	28 SEP 2011	E1100335	-

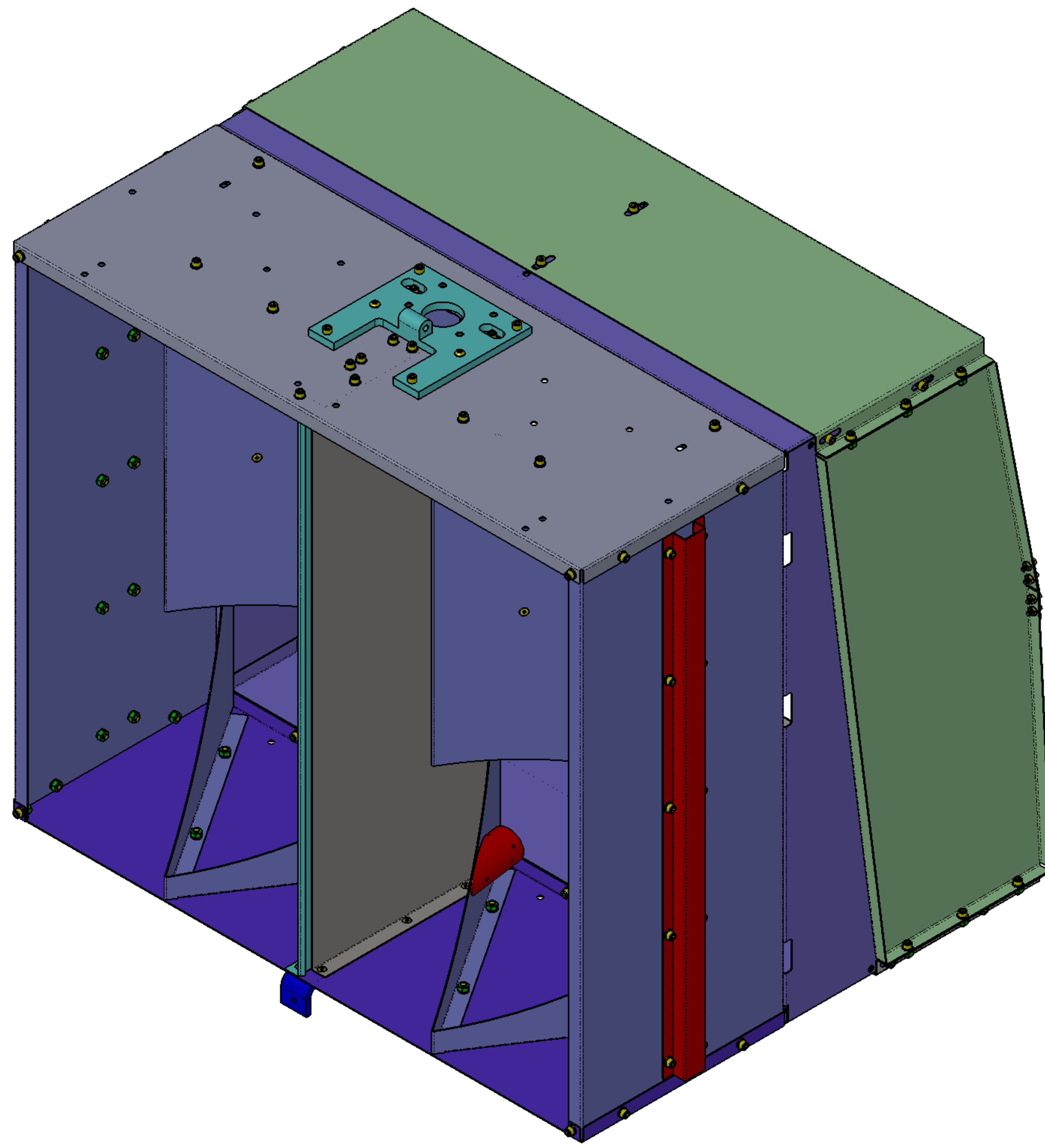

ITEM NO.	PART NUMBER	DESCRIPTION	MATERIAL	QTY.	SPARE	TOTAL
27	92210A999	FLAT HD SHCS #10-24 UNDERCUT		12		0
26	BU-2012-N	SCREW, BUTTON HD, SOC., .25-20 X .75 LG., 18-8 SSSL		2		0
25	D1101427	BRACE, LIFTING, ARM CAVITY BAFFLE	6061-T6 Al	1		0
24	92200A540	SHCS, .25-20 X .75 LG., Ms16995-50, 18-8 SSSL		4		0
23	N-2520-A	U-C COMP. NUT, HEX, .25-20 SILVER PLATED, 18-8 SSSL	18-8 SSSL	5		0
22	D1003013	ARM CAVITY BAFFLE PD ASSY	N/A	8		0
21	D1002173	ARM CAVITY BAFFLE HINGE ASSY	N/A	1		0
20	D1100288	SLC ACB TOP EXTENDER	18 GAUGE 304 SSSL	1		0
19	D1100353	ACB LEFT SIDE EXTENDER	18 GAUGE, 304 SSSL	1		0
18	D1100458	SLC ACB BOTTOM EXTENDER	18 GAUGE 304 SSSL	1		0
17	D1100354	ACB RIGHT SIDE EXTENDER	18 GAUGE, 304 SSSL	1		0
16	D1101234	ACB STIFFENER SIDE EXTENDER	6061-T6 Al	2		0
15	92200A242	SHCS, 10-24 X .50 LG., MS 16995-36		8		0
14	D1101796	ARM CAVITY BAFFLE CTR, MIRROR SKIN	18 GAUGE, 304 SSSL	1		0
13	UCC_C-2008-NA	SHCS, 1/4-20 x .50 AG PLATED	18-8 SSSL	12		0
12	N-2520-A	HEX NUT, 1/4-20 THRD SIZE	Ag-PLATED 300 SSSL	89		0
11	-	SCREW, SOCKET HEAD CAP, 1/4-20 UNC-2A X 0.5 LONG, FULLY THREADED	300 SSSL	86		0
10	-	WASHER, FLAT, 1/4 (NAS 620-C416 OR EQUIVALENT)	300 SSSL	227		0
9	N-1024-A	UC COMP, HEX NUT, #10-24, 18-8 SST	18-8 SSSL	27		0
8	92210A244	FLAT HD, SC SCREW, 10-24 X .64 LG., 18-8 SSSL		6		0
7	D1001363	ACB SIDE REINFORCING HATSECTION	304 SSSL	2		0
6	D1001365	ARM BAFFLE MIDDLE REINFORCING PLATE	18 GAUGE 304 SSSL	2		0
5	D1000976	ARM CAVITY BAFFLE CTR SKIN	18 GAUGE 304 SSSL	1		0
4	D1100391	ACB SHELF ASSY	N/A	1		0
3	D1000974	ARM CAVITY BAFFLE TOP SKIN	18 GAUGE 304 SSSL	1		0
2	D1000975	ARM CAVITY BAFFLE BTM SKIN	18 GAUGE 304 SSSL	1		0
1	D1000973	ARM CAVITY BAFFLE SKIN	18 GAUGE, 304 SSSL	1		0
ITEM NO.	PART NUMBER	DESCRIPTION	MATERIAL	QTY.	SPARE	TOTAL

NOTES AND TOLERANCES: (UNLESS OTHERWISE SPECIFIED)

1. INTERPRET DRAWING PER ASME Y14.5-1994.
2. REMOVE ALL SHARP EDGES, R.02 MIN.
3. DO NOT SCALE FROM DRAWING.
4. ALL MACHINING FLUIDS MUST BE FULLY SYNTHETIC, FULLY WATER SOLUBLE AND FREE OF SULFUR, SILICONE, AND CHLORINE.

DIMENSIONS ARE IN INCHES

TOLERANCES:
 .XX ±
 .XXX ±

ANGULAR ± °

MATERIAL	BOM	FINISH	N/A
----------	-----	--------	-----

LIGO CALIFORNIA INSTITUTE OF TECHNOLOGY
 MASSACHUSETTS INSTITUTE OF TECHNOLOGY

SYSTEM: ADVANCED LIGO SUB-SYSTEM: AOS

NEXT ASSY: D0901376

PART NAME: ARM CAVITY BAFFLE BOX ASSY

DESIGNER	N.Nguyen	01 Jun 2010	SIZE	DWG. NO.	REV.
DRAFTER	N.Nguyen	01 Jul 2010			
CHECKER	M. Smith	10 NOV 2010			
APPROVAL	D. Coyne	20 NOV 2010	SCALE: 1:3	PROJECTION:	SHEET 1 OF 5

D1000977 v3

D1000977_AudiGO_AOS_SLC_ARM_Cavity_Baffle_Box Assy_PART PDM REV: X-2211_DRAWING PDM REV: X-042

8 7 6 5 4 3 2 1

H
G
F
E
D
C
B
A

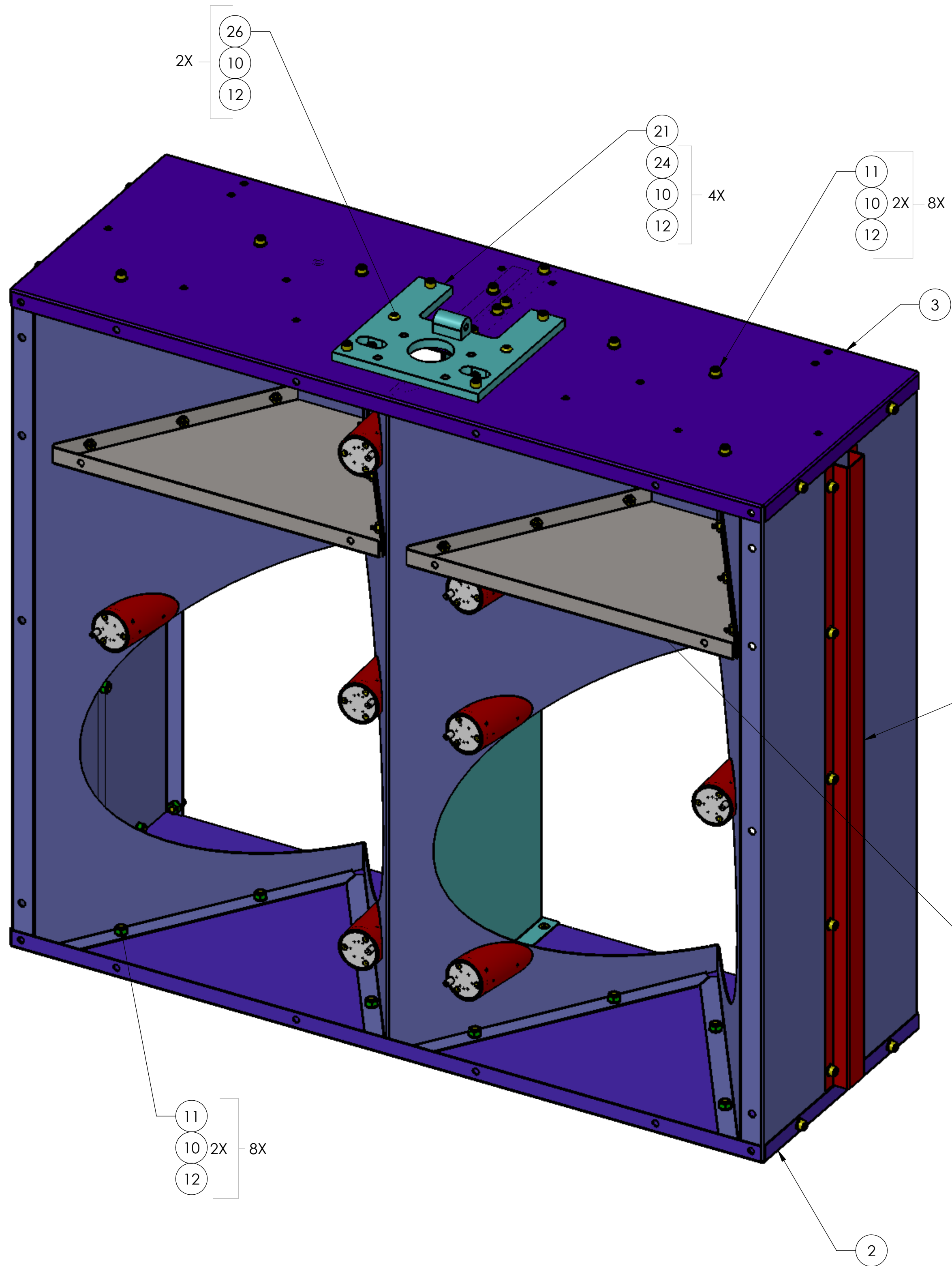

ASSEMBLY STEP 1

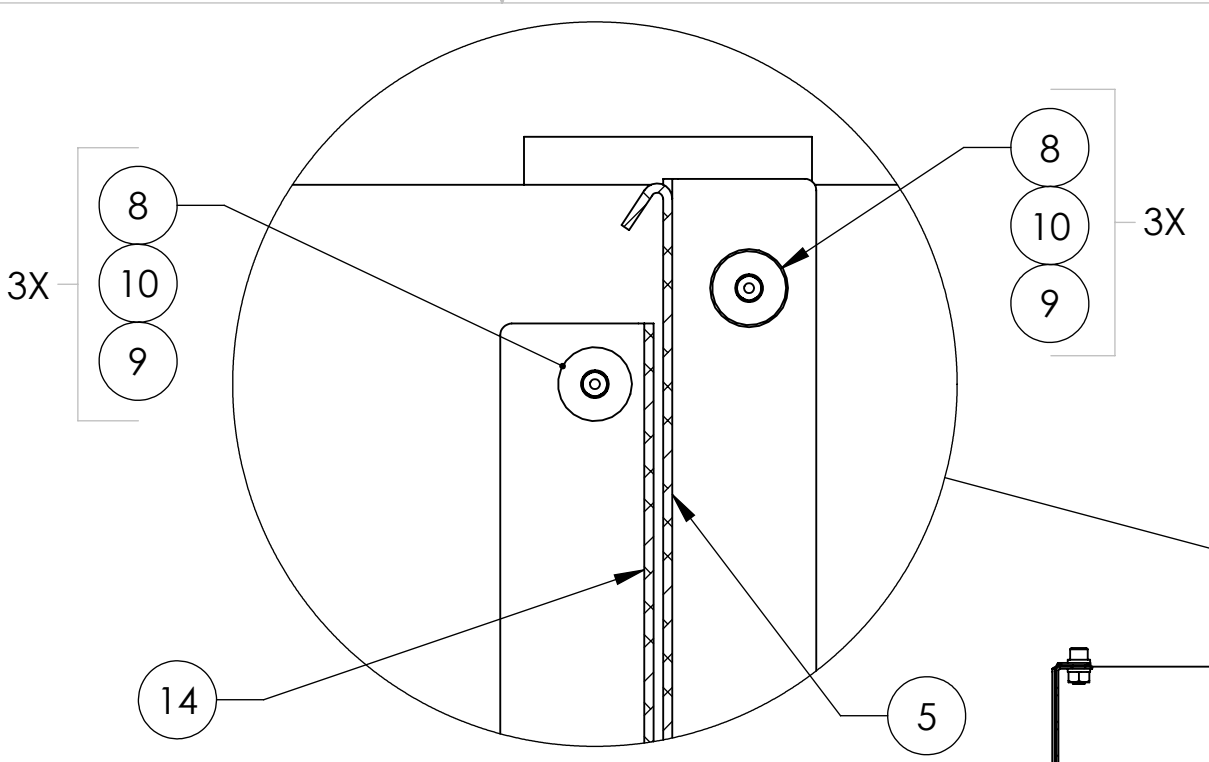

DETAIL C
SCALE 1 : 1
(INSTALL ITEMS 5 & 14 PRIOR TO
INSTALLING ITEM 3
INSTALL ITEM 25 (BRACE) ALSO)

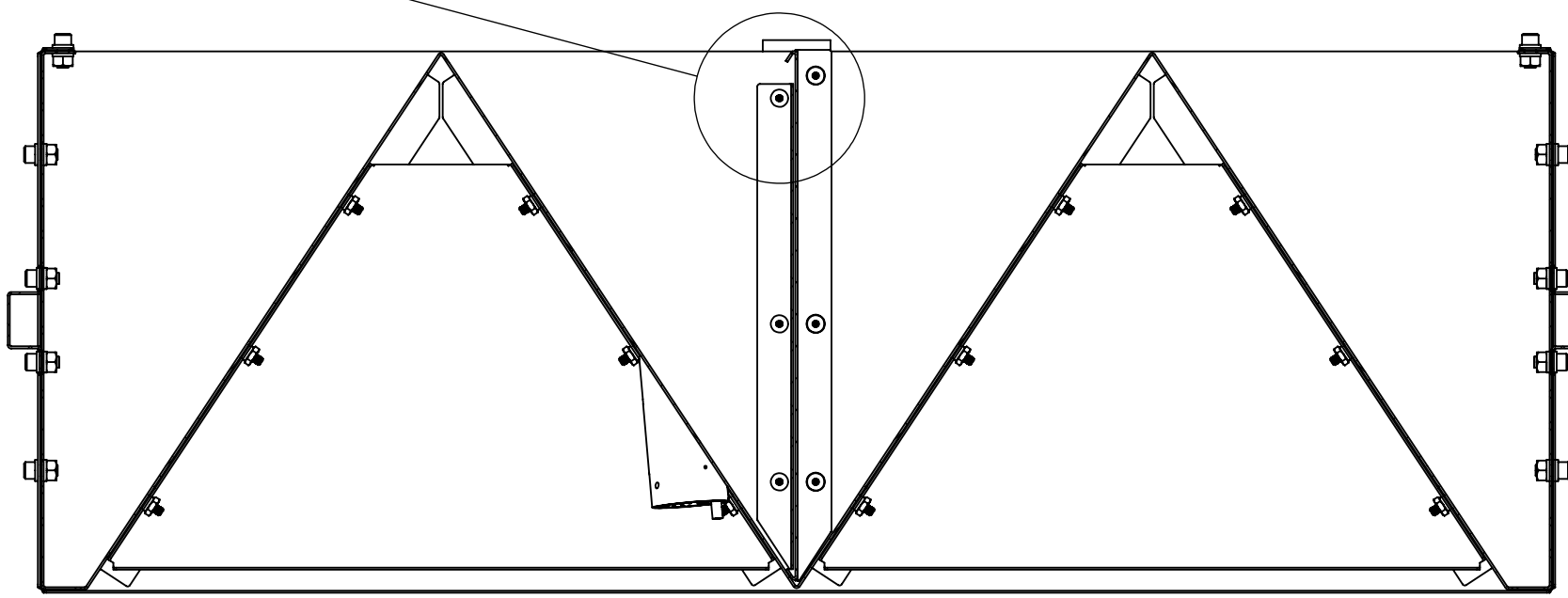

SECTION B-B
SCALE 1 : 4

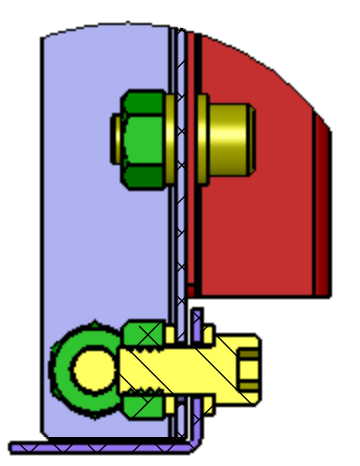
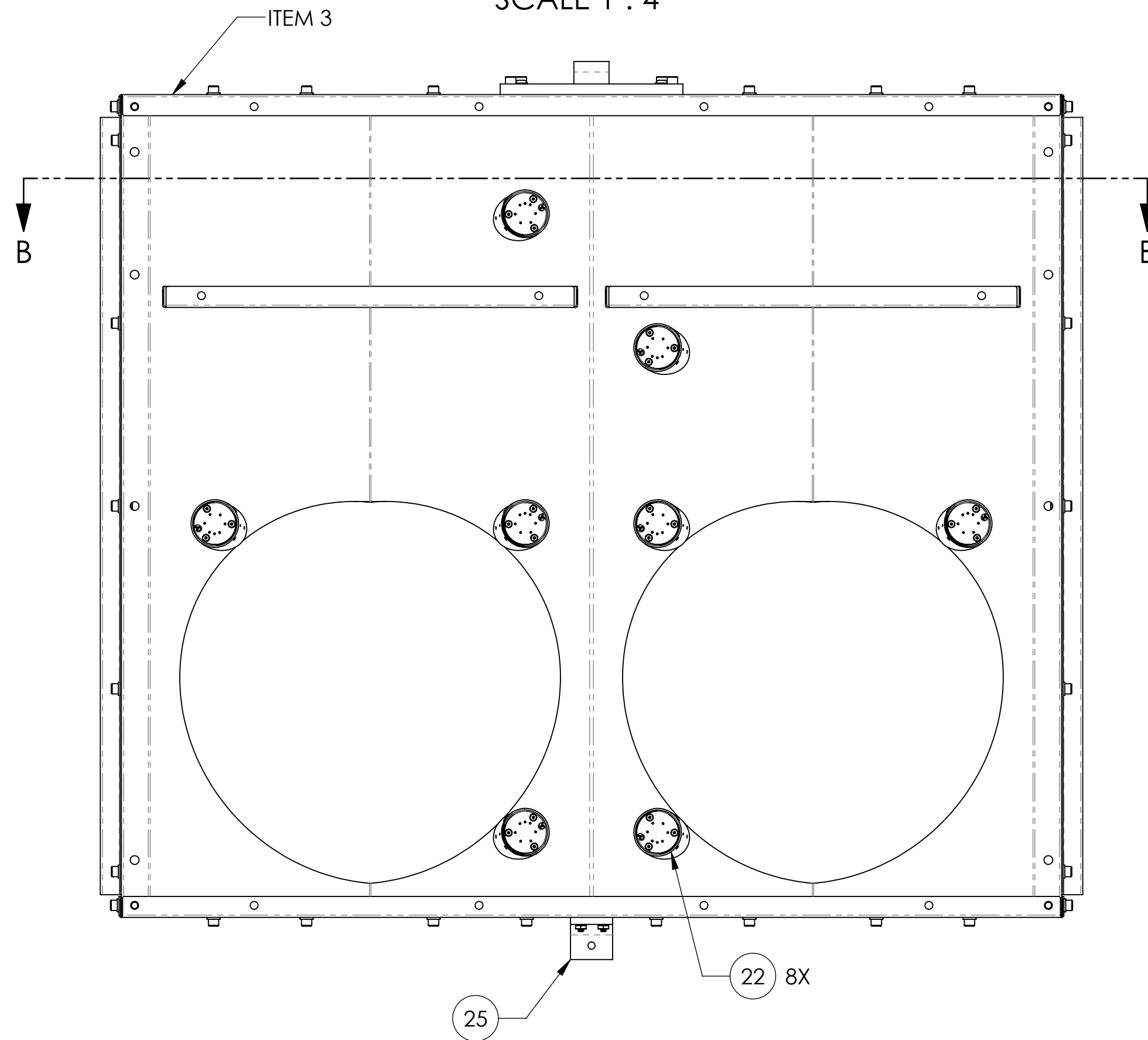

DETAIL A
SCALE 1 : 1
(TYPICAL FASTENER ASSEMBLY)

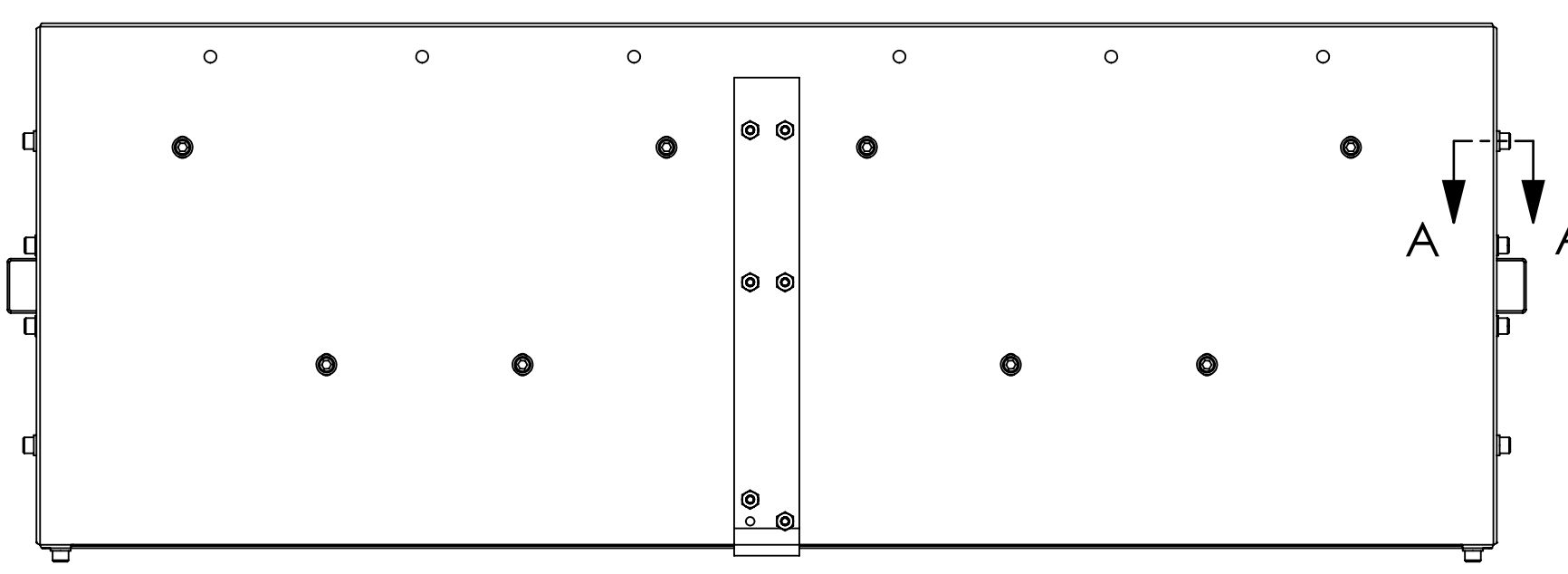

LIGO CALIFORNIA INSTITUTE OF TECHNOLOGY
MASSACHUSETTS INSTITUTE OF TECHNOLOGY

SIZE	DWG. NO.	REV.
D	D1000977	v3
SCALE: 1:3	PROJECTION:	SHEET 2 OF 5

8 7 6 5 4 3 2 1

D:\000977_AduLIGO_LACS_SLC_ARM_Covily_Bottle_Box_Assy_PART_PDM_REV_X-Z21_DRAWING_PDM_REV_X-Z42

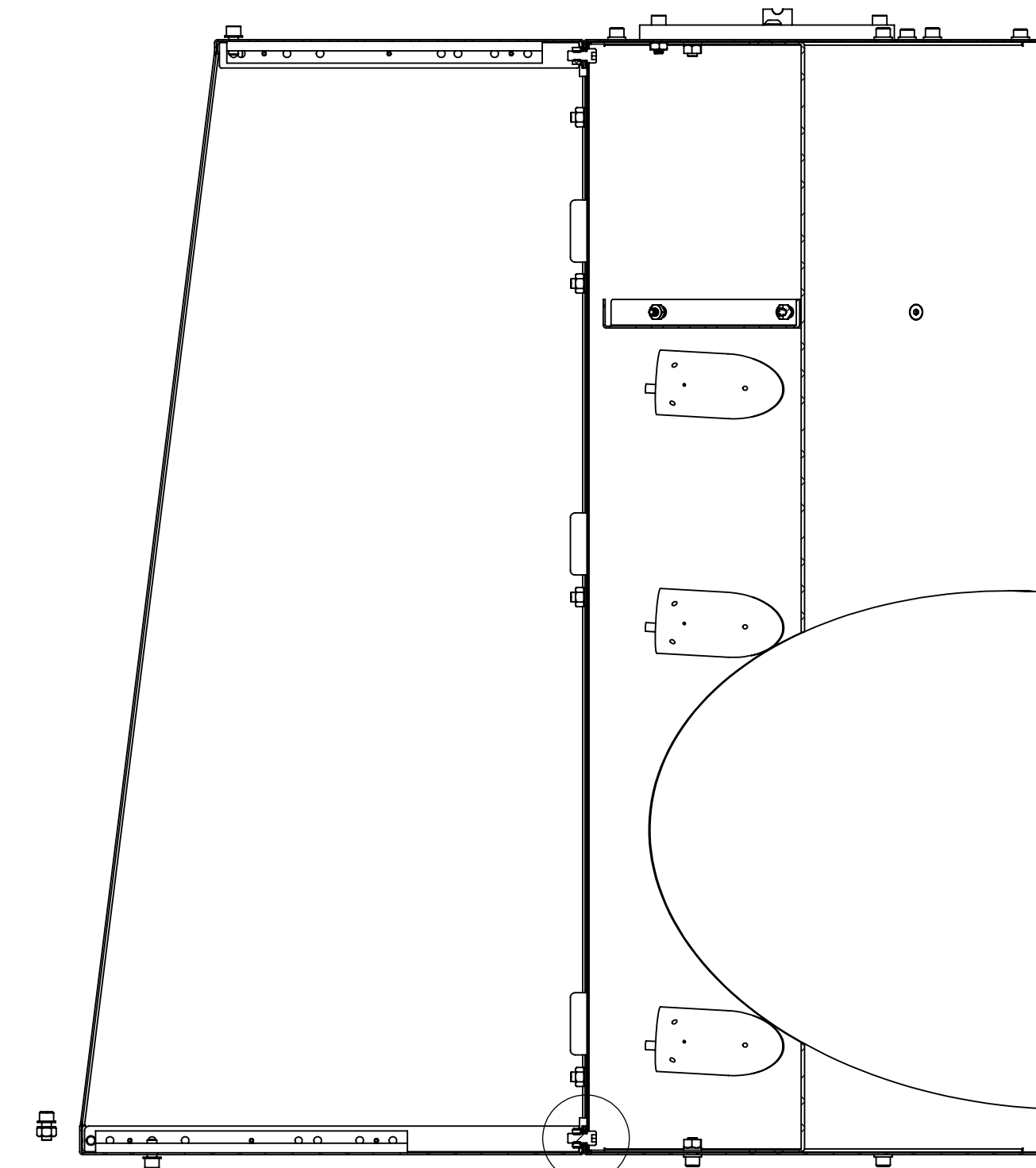
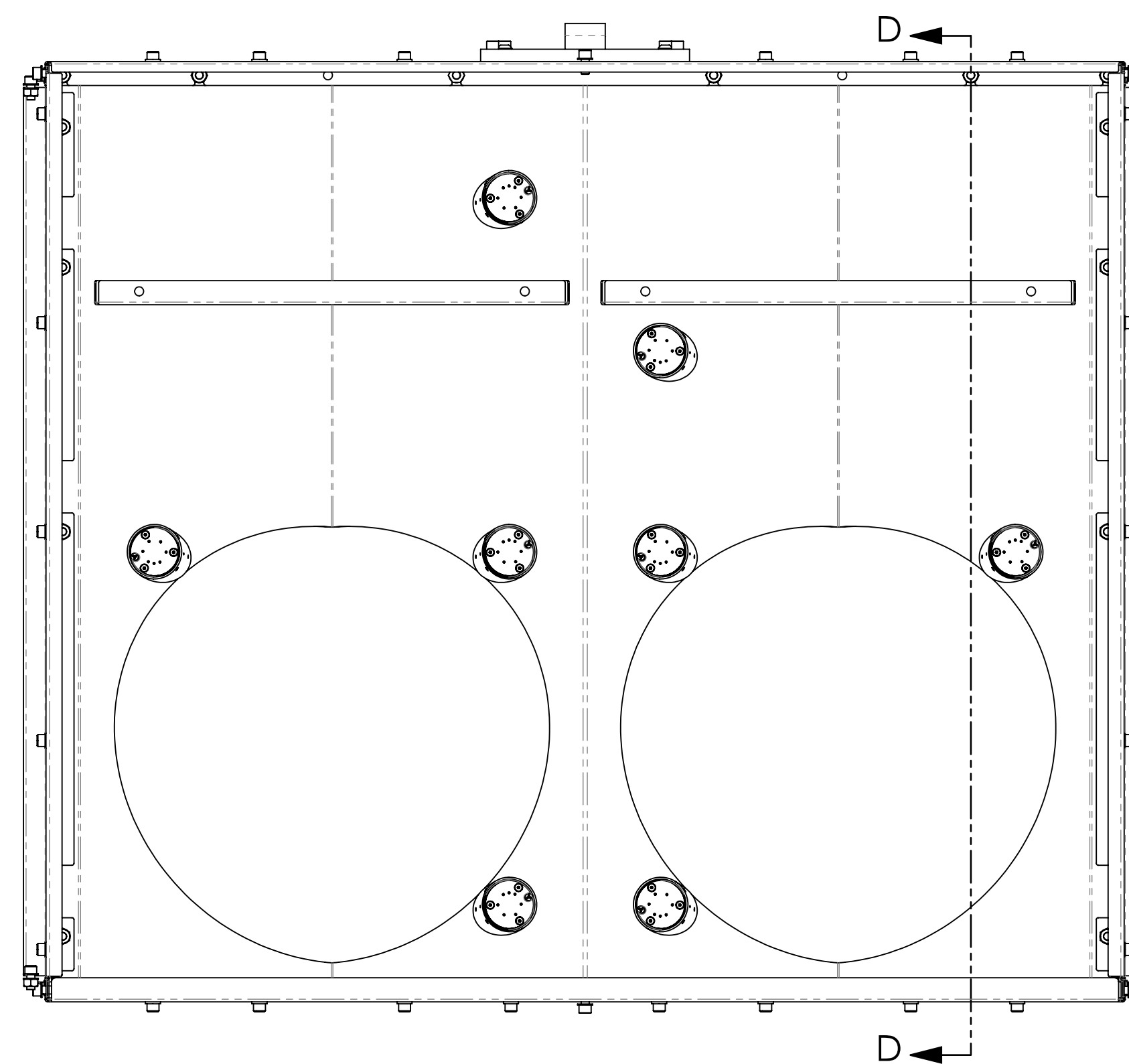
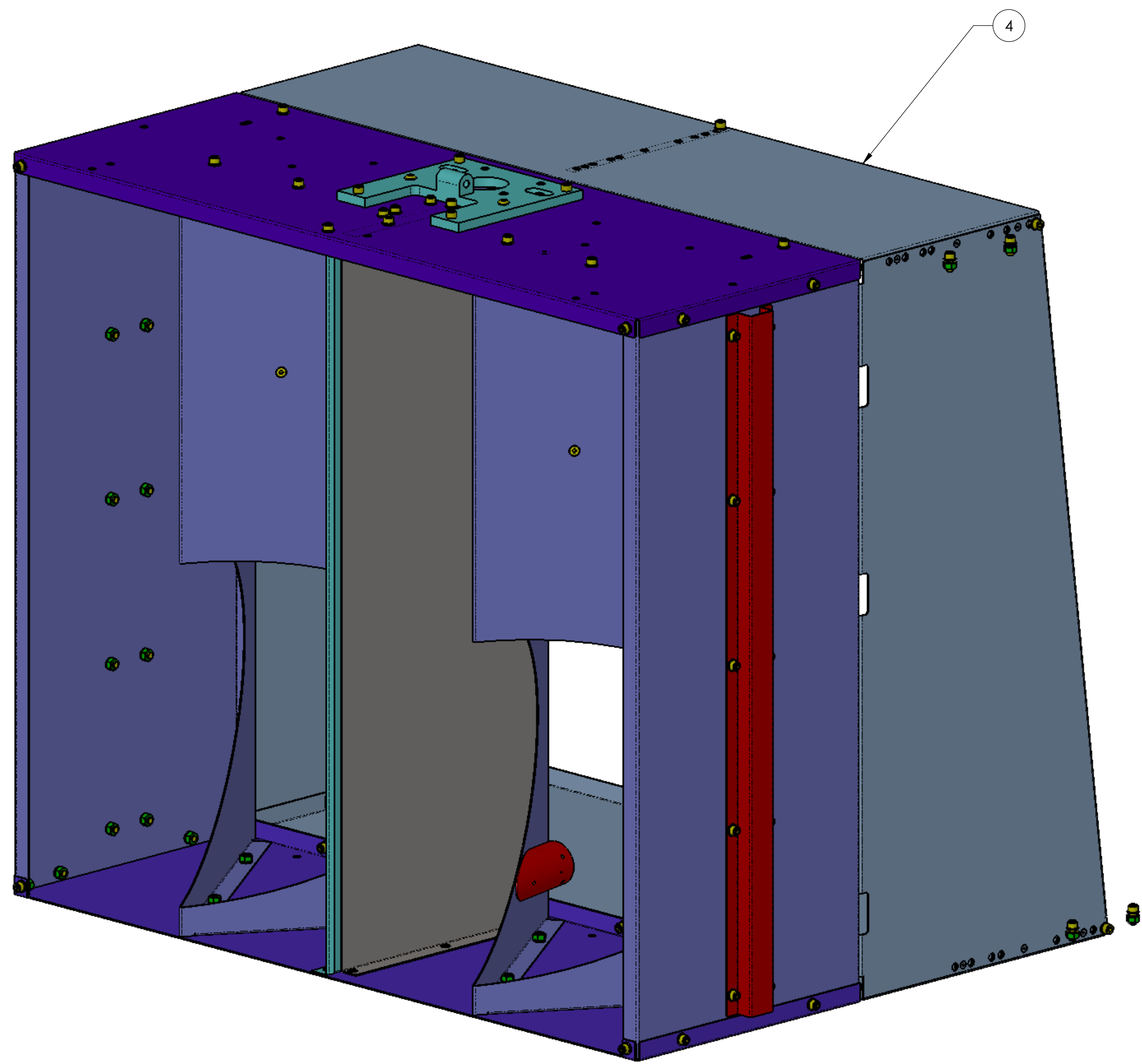

SECTION D-D
SCALE 1 : 4

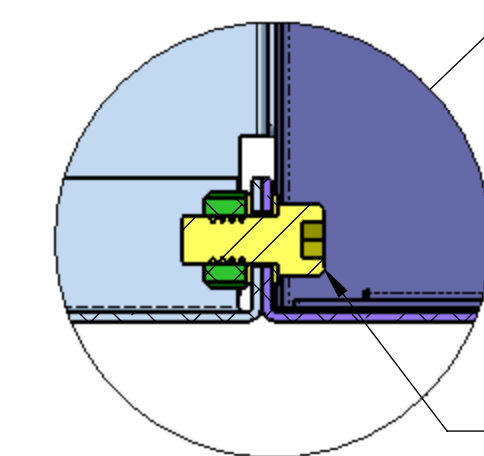

DETAIL E
SCALE 1 : 1

11
10 2X
12

ASSEMBLY STEP 2

LIGO CALIFORNIA INSTITUTE OF TECHNOLOGY MASSACHUSETTS INSTITUTE OF TECHNOLOGY		REV.
SIZE DWG. NO.	D1000977	v3
SCALE: 1:3	PROJECTION:	SHEET 3 OF 5

D1000977_AduIGO_AOS_SLC_ARM_Covily_Bottle_Box_Assy_PART_PDM_REV_X-Z21_DRAWING_PDM_REV_X-Z42

8 7 6 5 4 3 2 1

H
G
F
E
D
C
B
A

H
G
F
E
D
C
B
A

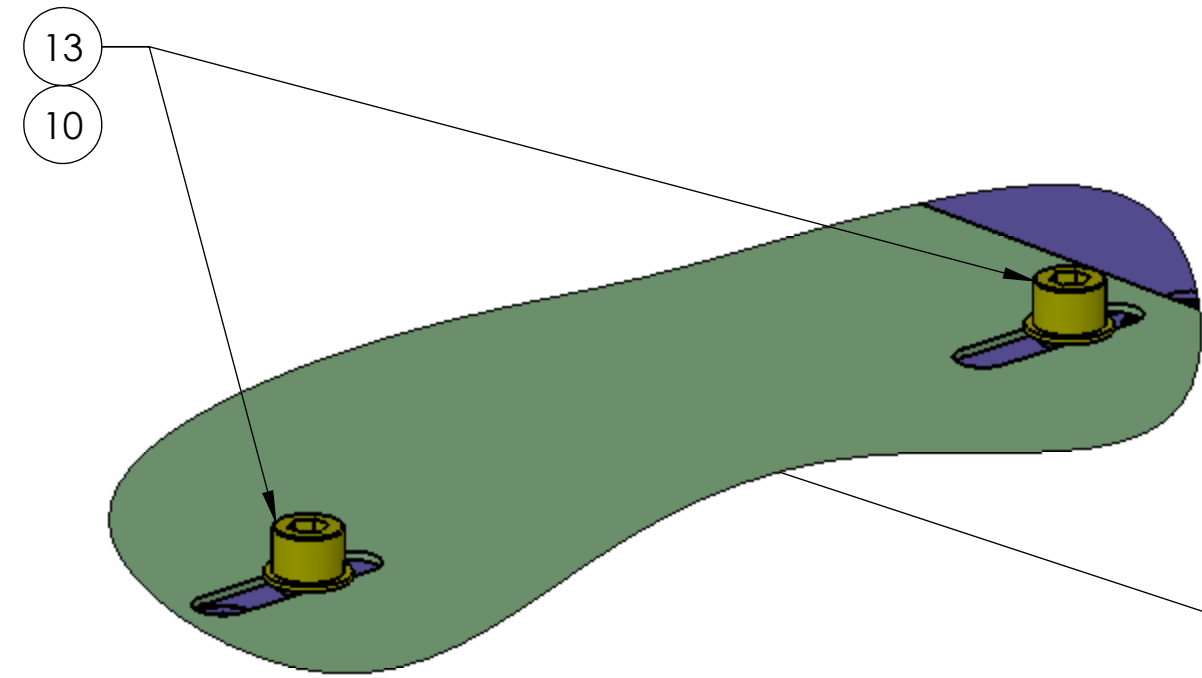

DETAIL F
SCALE 1 : 1
(TOP AND BOTTOM)

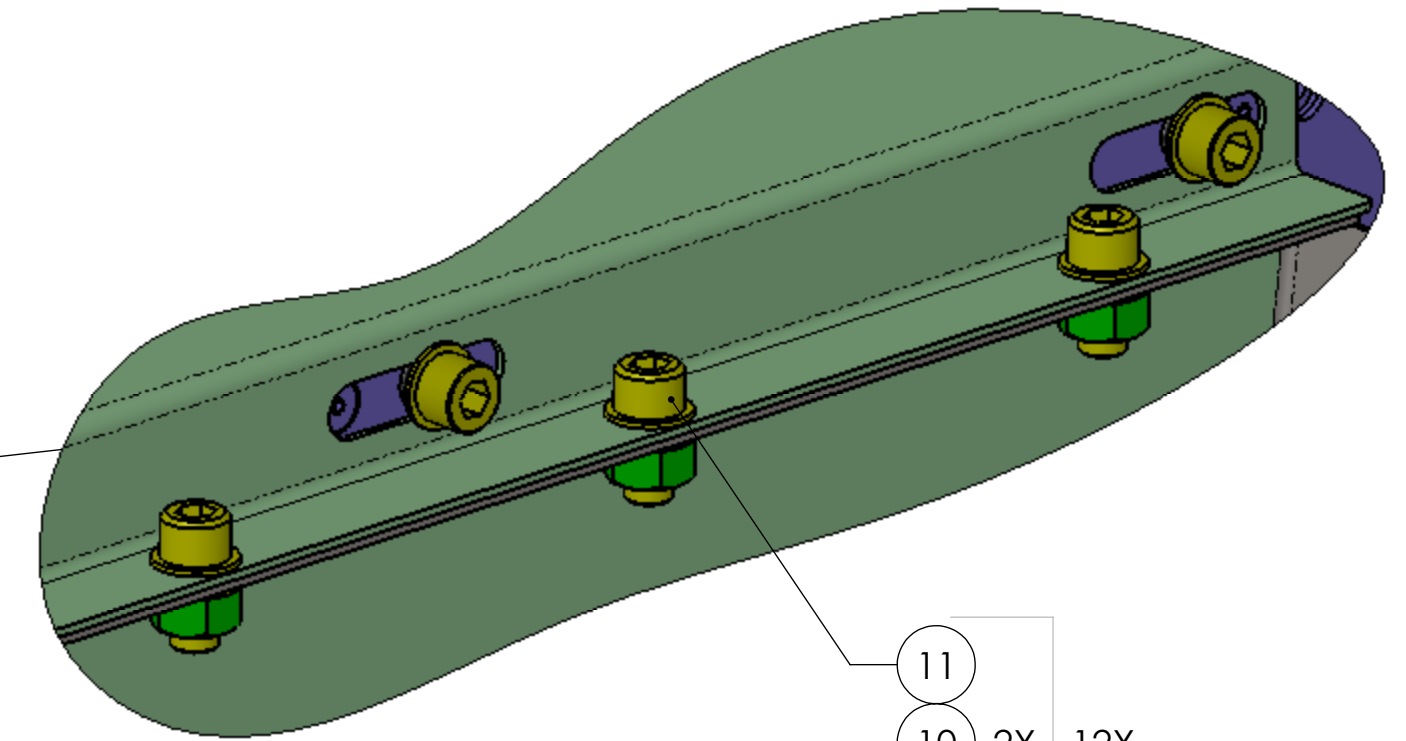
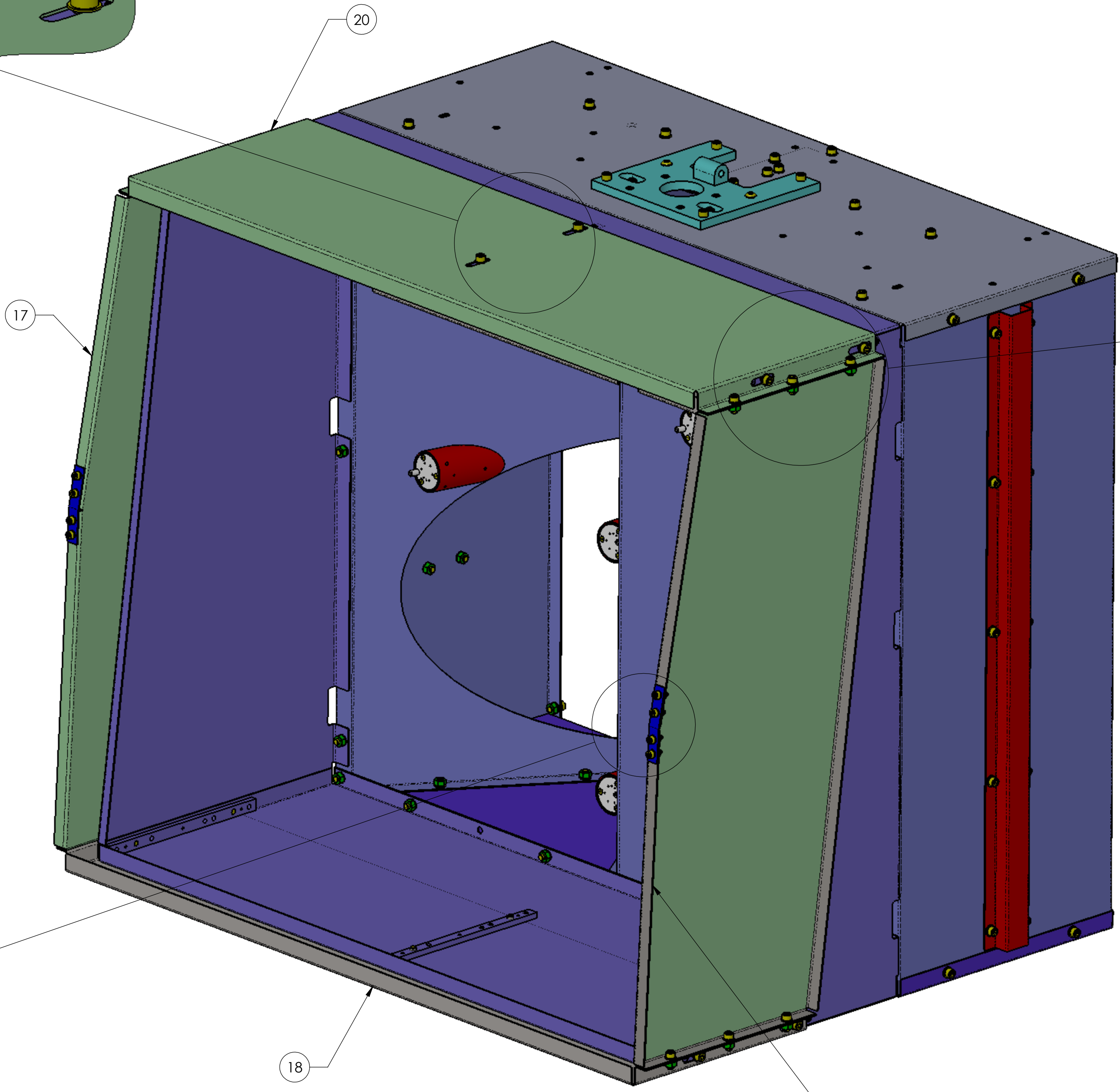

DETAIL G
SCALE 1 : 1

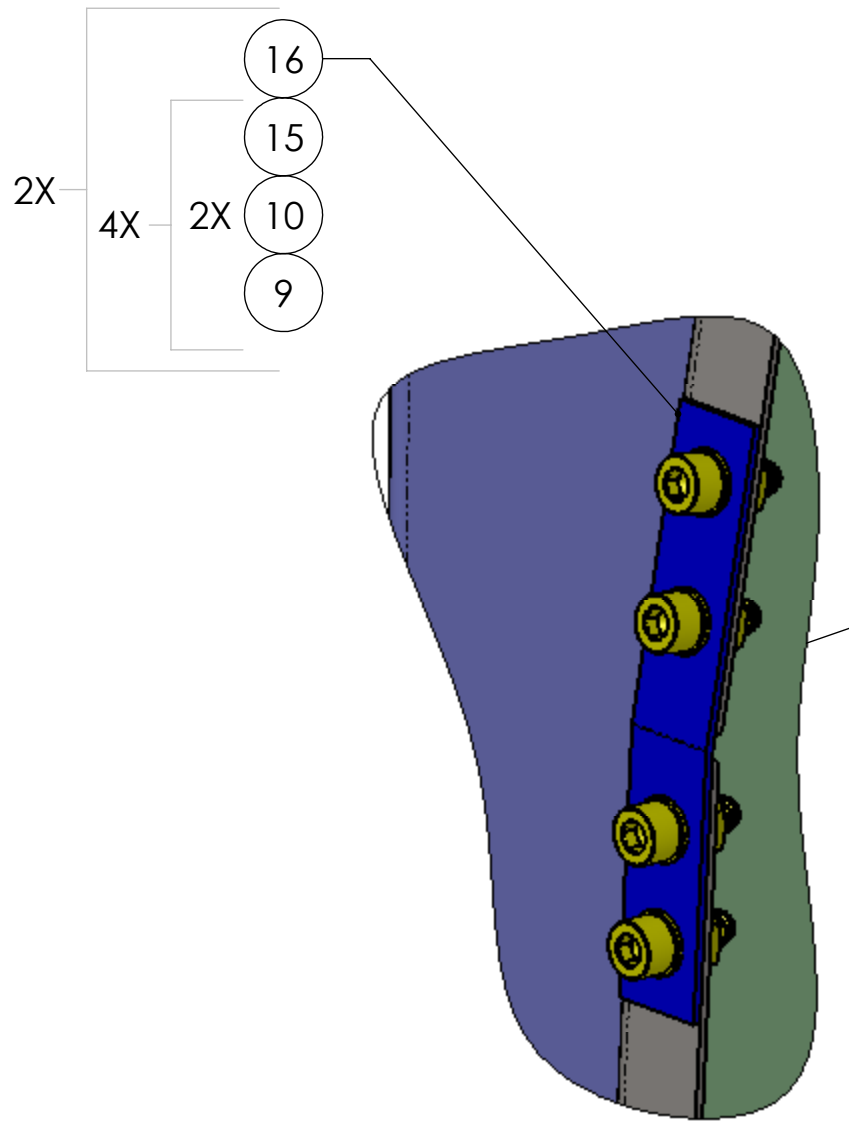

DETAIL H
SCALE 1 : 1

ASSEMBLY STEP 3

LIGO CALIFORNIA INSTITUTE OF TECHNOLOGY MASSACHUSETTS INSTITUTE OF TECHNOLOGY		REV.
SIZE DWG. NO.	D D1000977	v3
SCALE: 1:3	PROJECTION:	SHEET 4 OF 5

8 7 6 5 4 3 2 1

D:\00977_AudiGO_AOS_SLC_ARM_Cavity_Bottle_Box_Assy_PART_PDM_REV_X-221_DRAWING_PDM_REV_X-042

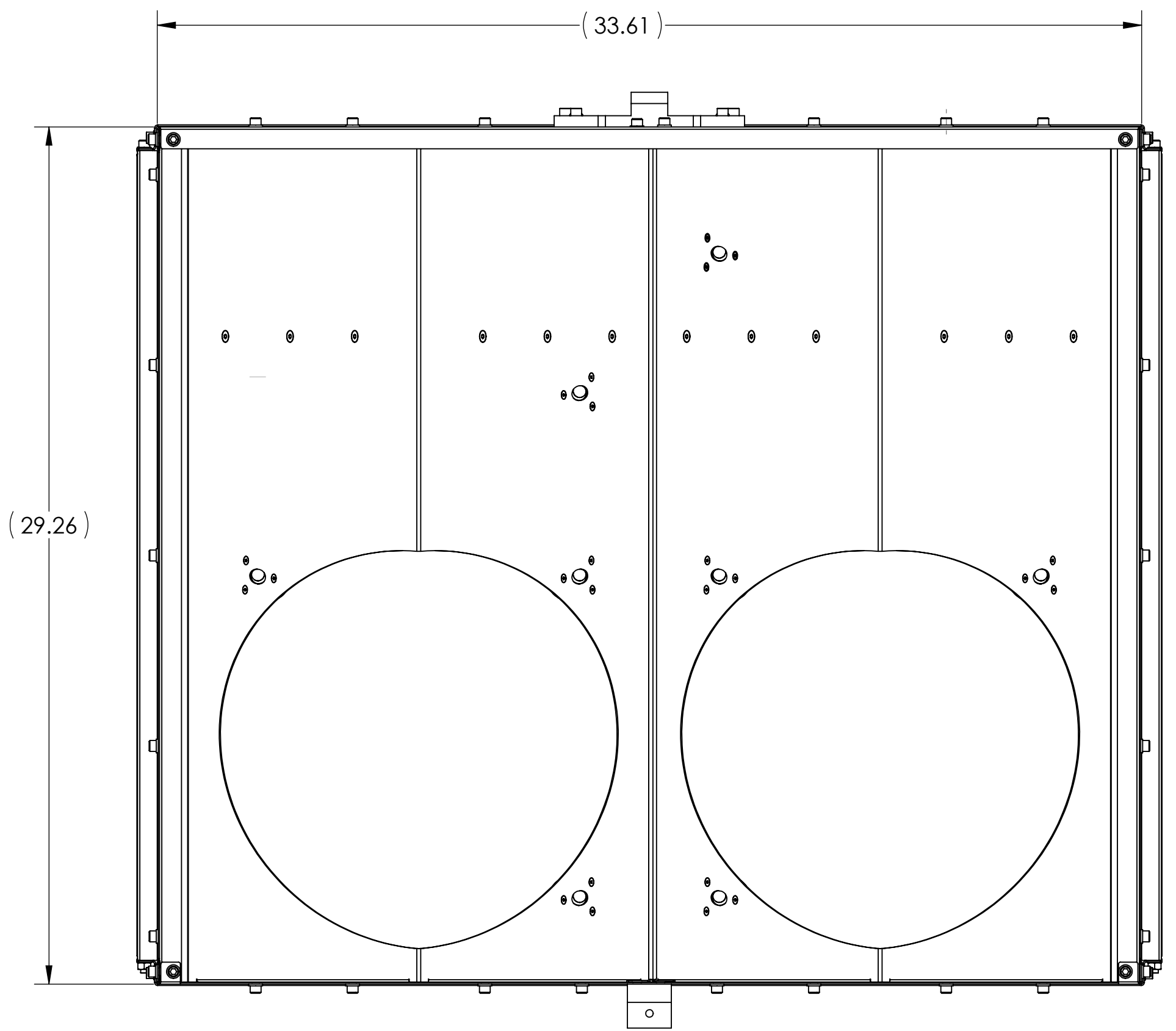
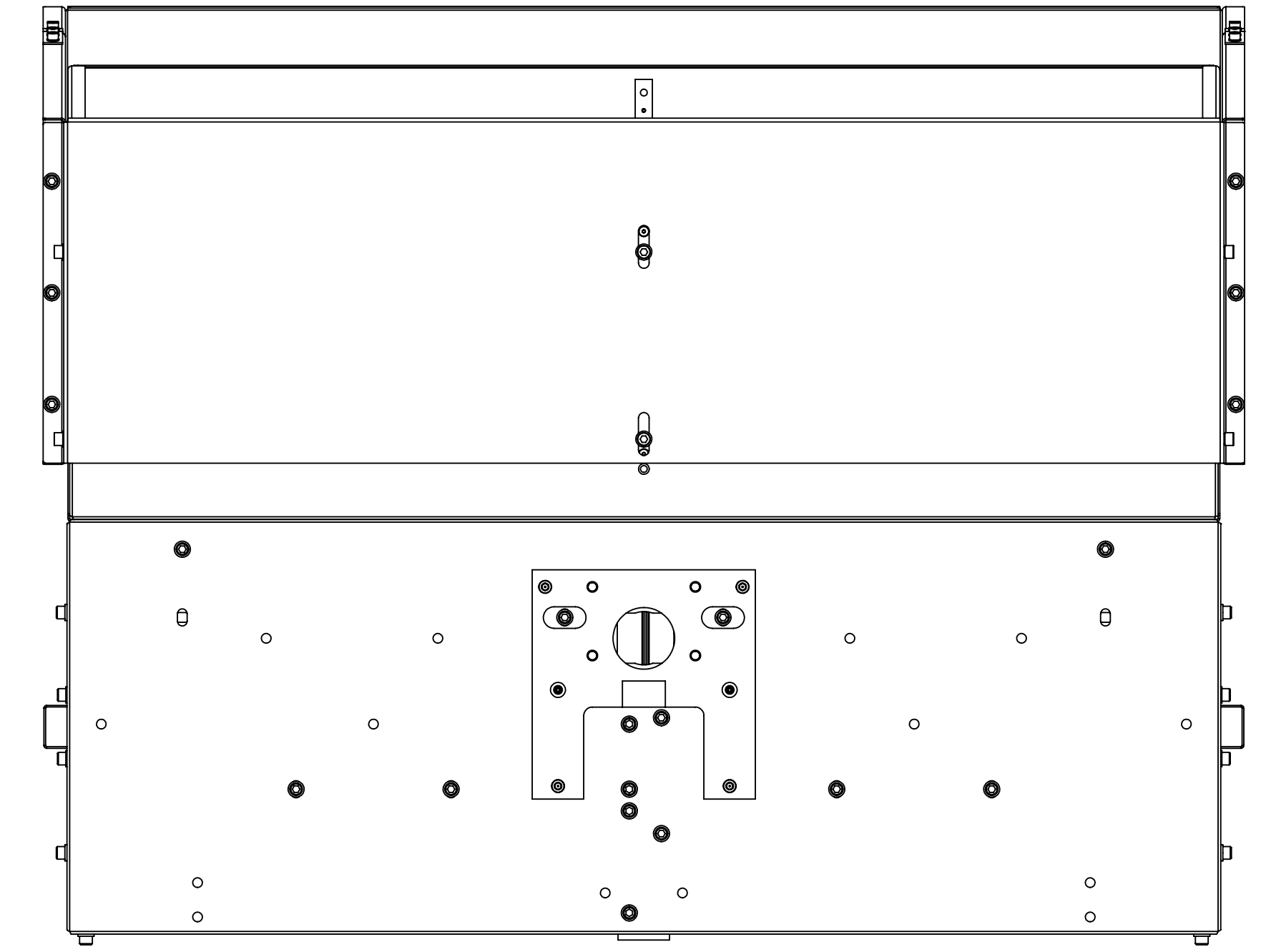

ASSEMBLY STEP 4

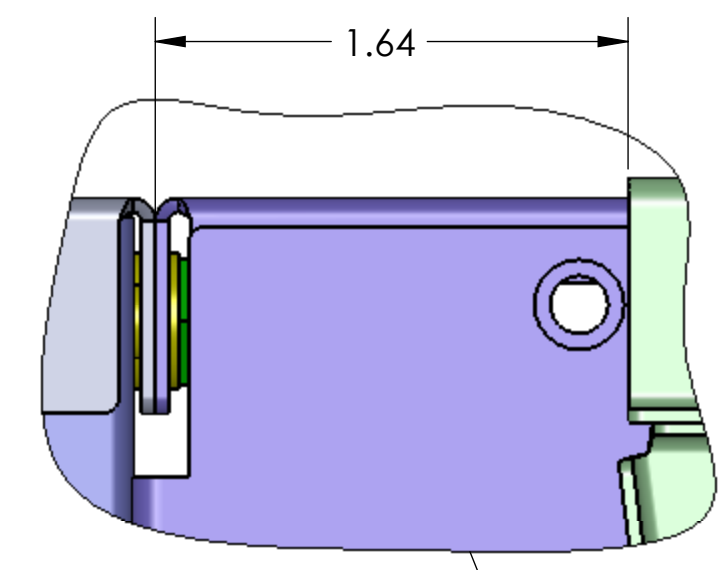

DETAIL K
SCALE 1.5 : 1

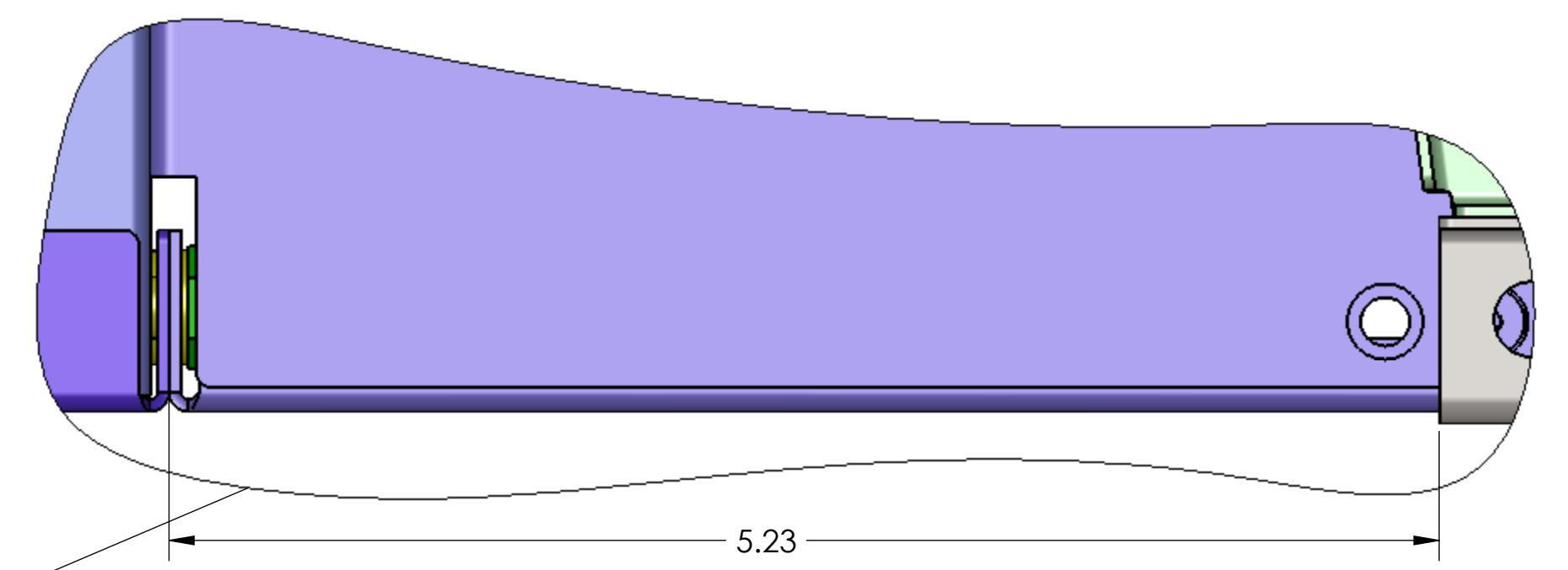
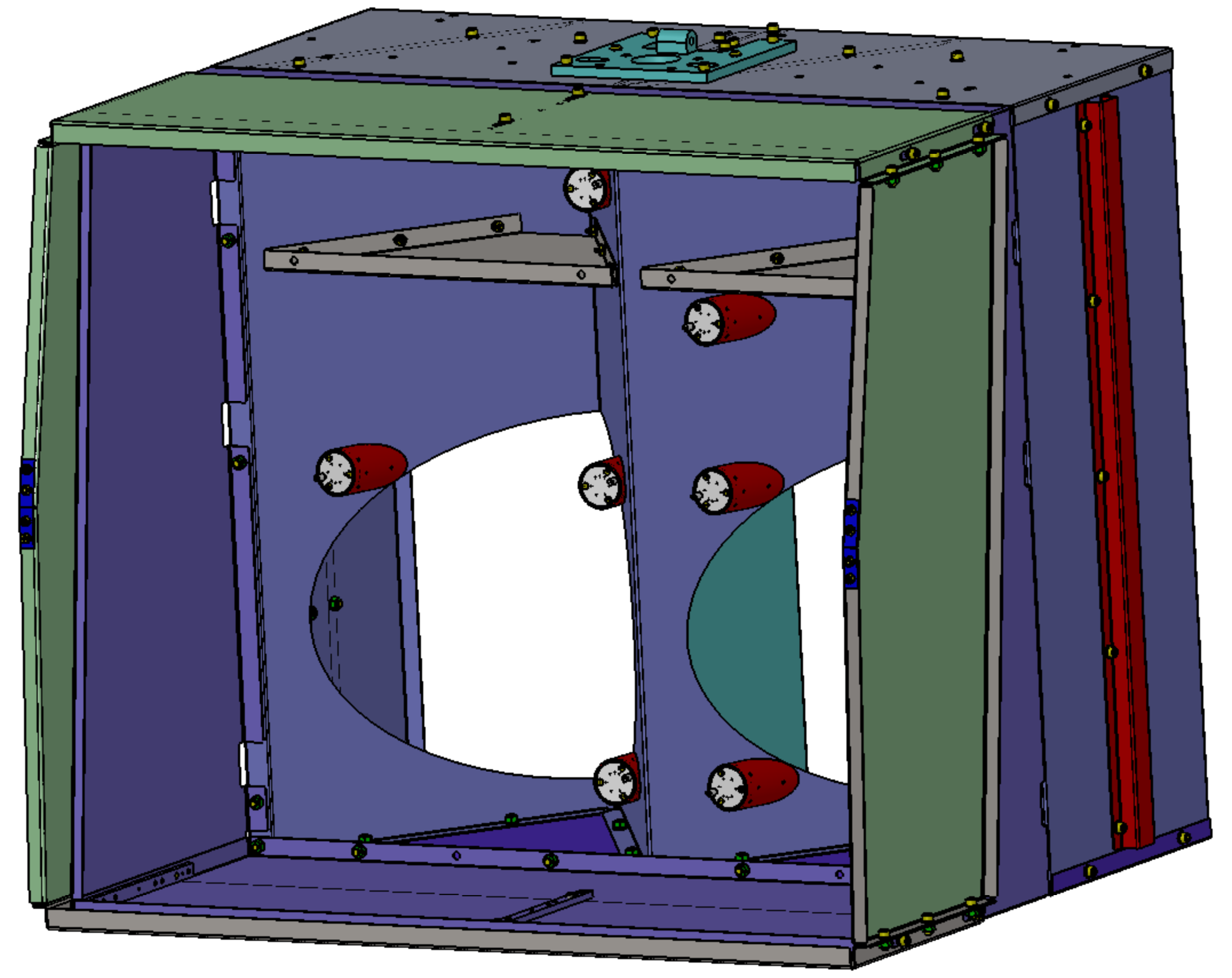
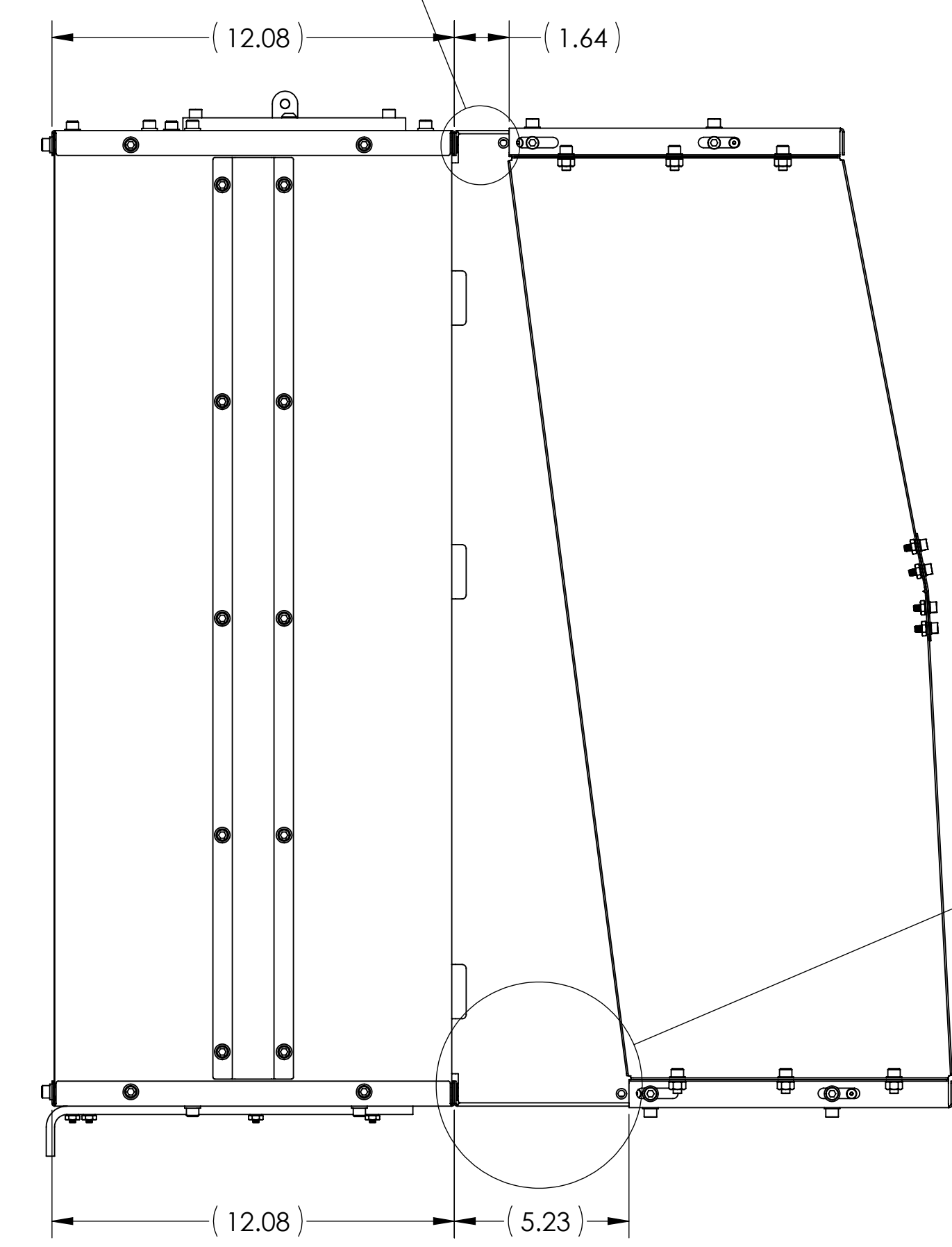

DETAIL J
SCALE 1.5 : 1

D1000977_AduIGO_AOS_SLC_ARM_Cavity_Bottle_Box_Assy_PART_PDM_REV_X-Z21_DRAWING_PDM_REV_X-Z42