

D1001096\_AdlIGO\_AOS\_SLC\_ARM Cavity Baffle Lo Tube Dummy Mass, PART PDM REV: X-012, DRAWING PDM REV: X-016

8 7 6 5 4 3 2 1

**NOTES CONTINUED:**  
 5. SCRIBE, ENGRAVE, OR MECHANICALLY STAMP (NO INKS OR DYES) DRAWING PART NUMBER, REVISION (AND VARIANT OR "TYPE" IF APPLICABLE) ON NOTED SURFACE OF PART FOLLOWED ON THE NEXT LINE WITH A THREE DIGIT SERIAL NUMBER. SERIAL NUMBERS START AT 001 FOR THE FIRST ARTICLE AND PROCEED CONSECUTIVELY. USE MINIMUM 0.12" HIGH CHARACTERS, UNLESS THE SIZE OF THE PART DICTATES SMALLER CHARACTERS. A VIBRATORY TOOL MAY BE USED.  
 EXAMPLE: DXXXXXX-VY, TYPE-XX, S/N XXX

REV.	DATE	DCN #	DRAWING TREE #
v1	19 JUL 2010	E1000191	

D 6. BRIGHT DIP PER E0900364 TO REMOVE ALL SURFACE OXIDES AND POTENTIALLY EMBEDDED CONTAMINANTS.

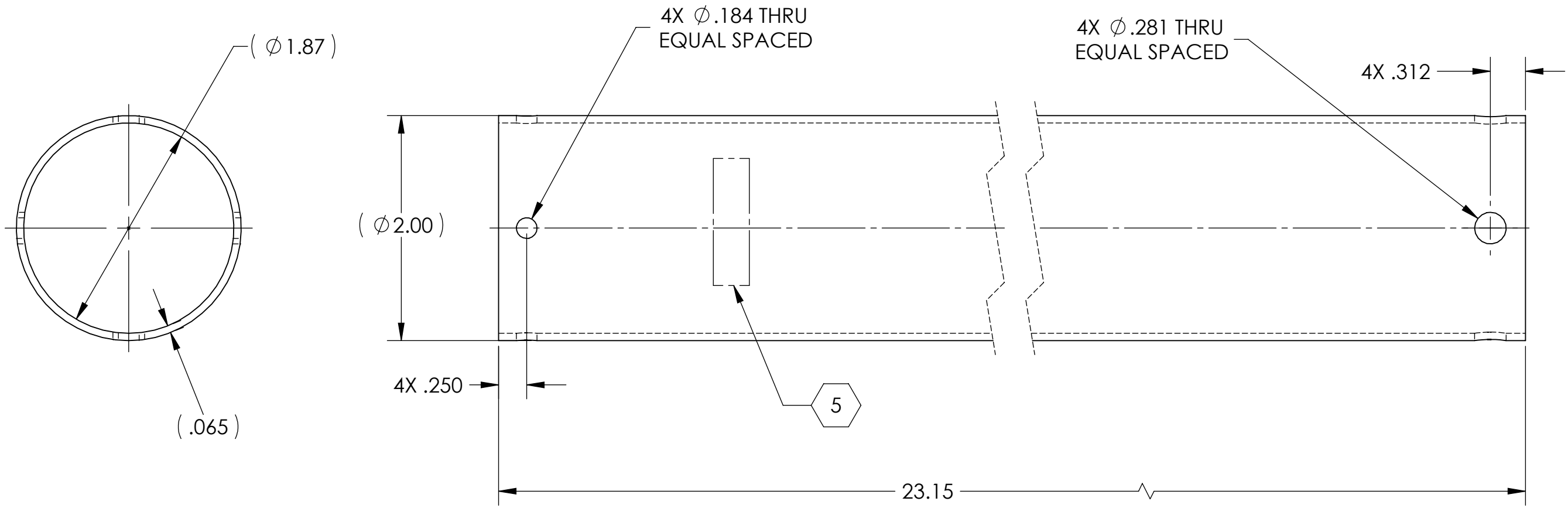

NOTES AND TOLERANCES: (UNLESS OTHERWISE SPECIFIED)				LIGO CALIFORNIA INSTITUTE OF TECHNOLOGY MASSACHUSETTS INSTITUTE OF TECHNOLOGY		PART NAME	
DIMENSIONS ARE IN INCHES				ADVANCED LIGO		SLC ACB TUBE LO DUMMY	
TOLERANCES: .XX ± .03 .XXX ± .005				SUB-SYSTEM AOS		DESIGNER TQ. NGUYEN 19 JUL 2010	
ANGULAR ± 1.0°				MATERIAL 6061-T6 Al		DRAFTER M. SMITH 19 JUL 2010	
FINISH 32 μinch				NEXT ASSY		CHECKER D. COYNE	
						APPROVAL	
						SIZE DWG. NO. B D1001096	
						REV. v1	
						SCALE: 1:1 PROJECTION: SHEET 1 OF 1	

8 7 6 5 4 3 2 1