

REV.	DATE	DCN #	DRAWING TREE #
v1	7 OCT 2010	E1000563	E1000531
v2	02 MAR 2011	E1000563	E1000531
v3	20 SEP 2012	E1000563	E1000531

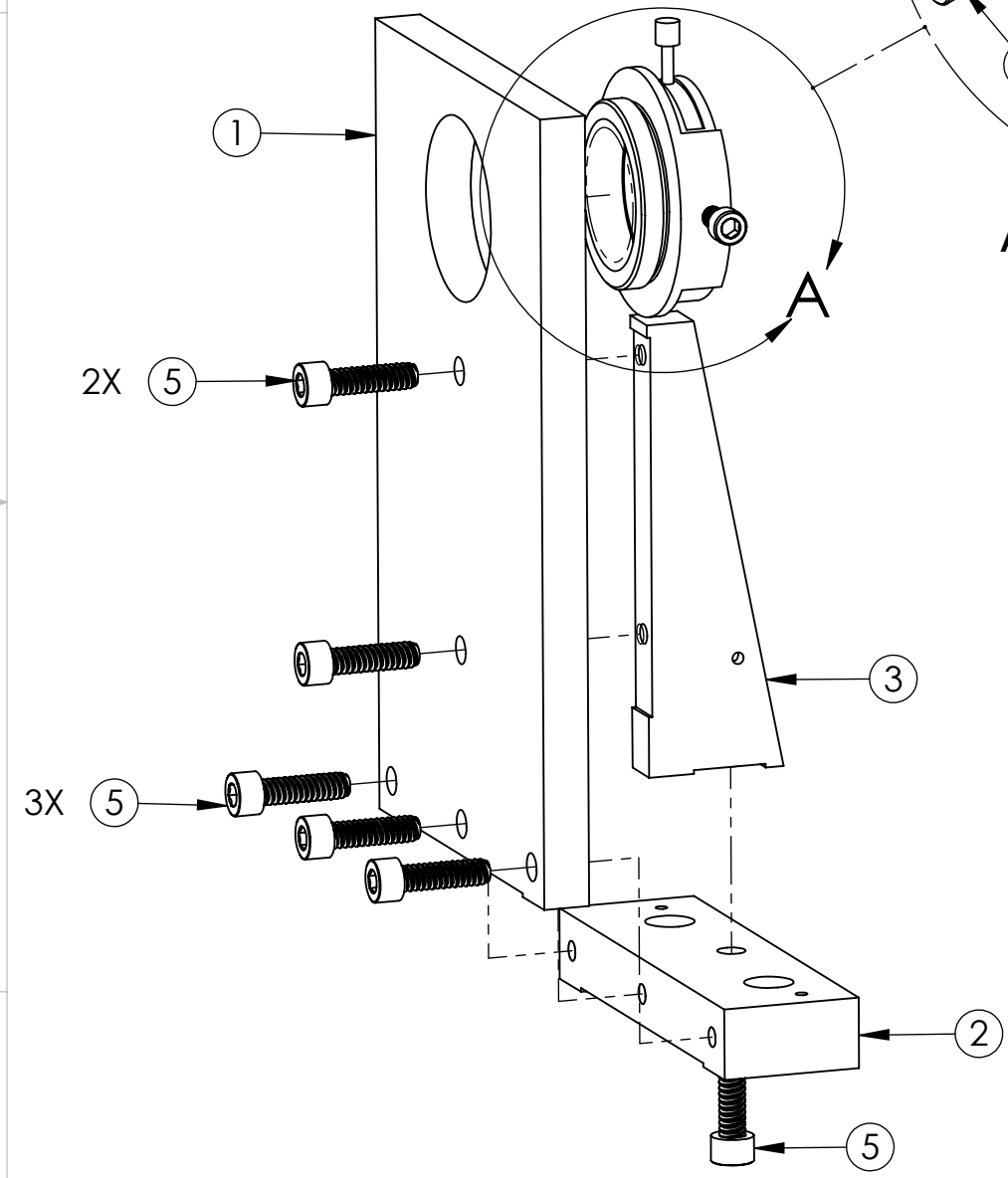
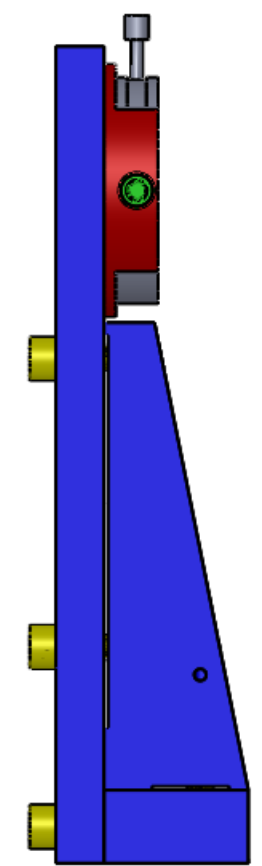
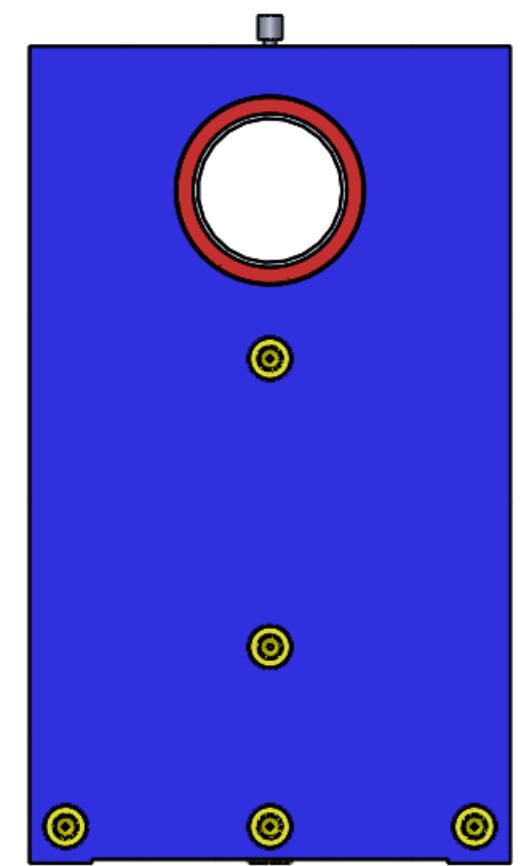
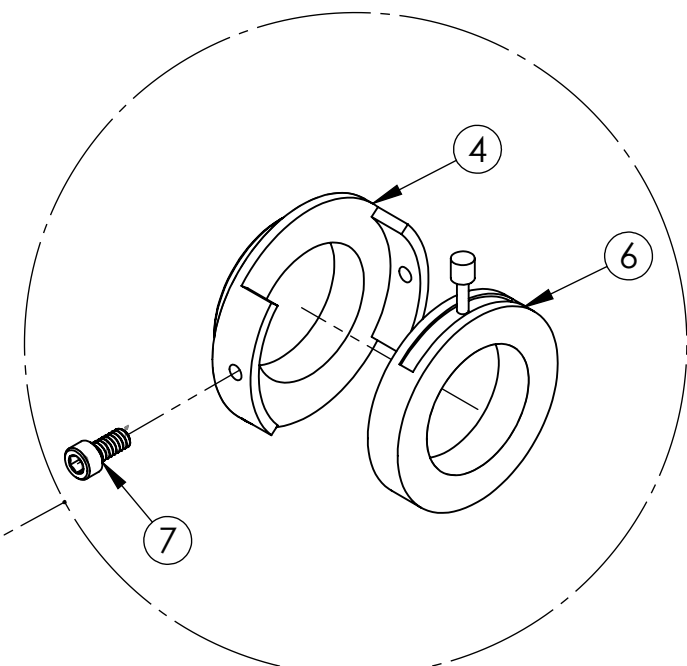

ALIGNMENT TOOLING DETAIL

EXPLODED VIEW

ITEM NO.	PART NUMBER	DESCRIPTION	MATERIAL	QTY.
7	C-404-NA	#4-40 X 0.250", 18-8 SSTL, SILVER PLATED	Ag-PLATED 300 SSTL	1
6	D20S	DIAPHRAGM D20S OFI	-	1
5	C-608-N	SHCS, 6-32 x .50, 300 SSTL, MS16995-18	300 SSTL	6
4	D1100556	IRIS DIAPHRAGM MOUNT	304, 316 OR 302 SSTL	1
3	D1001962	OUTPUT ALIGNMENT FIXTURE SUPPORT	6061-T6 Al	1
2	D1001961	OUTPUT ALIGNMENT FIXTURE BASE	6061-T6 Al	1
1	D1001959	RETICLE HOLDER	6061-T6 Al	1

PARTS LIST

NOTES AND TOLERANCES: (UNLESS OTHERWISE SPECIFIED)

1. INTERPRET DRAWING PER ASME Y14.5-1994.  
 2. REMOVE ALL SHARP EDGES, R.02 MIN.  
 3. DO NOT SCALE FROM DRAWING.  
 4. ALL MACHINING FLUIDS MUST BE FULLY SYNTHETIC, FULLY WATER SOLUBLE AND FREE OF SULFUR, SILICONE, AND CHLORINE.

DIMENSIONS ARE IN INCHES  
 TOLERANCES:  
 .XX ± .01  
 .XXX ± .005  
 ANGULAR ± 0.5°

MATERIAL		FINISH		NEXT ASSY		PART NAME	
N/A		N/A μinch		D0900623		OUTPUT ALIGNMENT FIXTURE ASSY	

LIGO CALIFORNIA INSTITUTE OF TECHNOLOGY MASSACHUSETTS INSTITUTE OF TECHNOLOGY  
 SYSTEM ADVANCED LIGO SUB-SYSTEM AOS  
 DESIGNER TQ. NGUYEN 20 JUL 2010 DRAFTER TQ. NGUYEN 25 AUG 2010 CHECKER M. SMITH APPROVAL D. COYNE  
 SCALE: 1:2 PROJECTION: SHEET 1 OF 1  
 REV. v3

D1001963\_alIGO\_AOS\_Output Baffle ASSY, PART PDM REV: X-027, DRAWING PDM REV: X-015