

8 7 6 5 4 3 2 1

- NOTES CONTINUED:**
- ⑤ BAG AND TAG PARTS WITH THEIR DRAWING PART NUMBER, REVISION, VARIANT OR "TYPE" (IF APPLICABLE), AND QUANTITY. IF PARTS ARE TOO SMALL TO SCRIBE, BAGGING AND TAGGING ALONE IS SUFFICIENT. EXAMPLE (TAG): DXXXXXX-VY, TYPE-XX, QTY: TBD
 - 6. APPROXIMATE WEIGHT = .02 LB [8G].
 - 7. ALL PARTS TO BE MANUFACTURED IN ACCORDANCE WITH LIGO SPECIFICATION E0900364.
 - 8. ALL MATERIAL IS TO BE VIRGIN MATERIAL (i.e. NOT WELD REPAIRS OR PLUGS UNLESS APPROVED IN ADVANCE IN WRITING BY LIGO. REFER TO LIGO-E0900364.
 - 9. NO REPAIRS SHALL BE MADE UNLESS APPROVED IN ADVANCE, AND IN WRITING, BY LIGO LABORATORY. IN GENERAL WELD REPAIRS AND PRESS FIT INSERT REPAIRS ARE NEVER ACCEPTABLE; THE MATERIAL SHOULD BE MADE WITH VIRGIN MATERIAL. SPECIAL CIRCUMSTANCES CAN BE REVIEWED IF / WHEN BROUGHT TO THE ATTENTION OF LIGO CONTRACTING OFFICER'S REPRESENTATIVE (COTR) THROUGH A MATERIAL REVIEW BOARD (MRB) PROCESS. REFER TO LIGO-E0900364.
 - ⑩ MCMaster CARR# 92196A209, 8-32 X 3.00 SHCS, 18-8 SS OR EQUIVALENT.
 - ⑪ ELECTROPOLISH TO REMOVE .0005-.001 FROM ALL SURFACES.
 - ⑫ CHASE FULL THREAD TO DIMENSION SHOWN.

REV.	DATE	DCN #	DRAWING TREE #
v1	08/12/2010	E1000318	-
v2	10/29/2010	E1000602	-
v3	26 MAR 2012	E1200317-x0	-

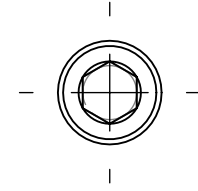
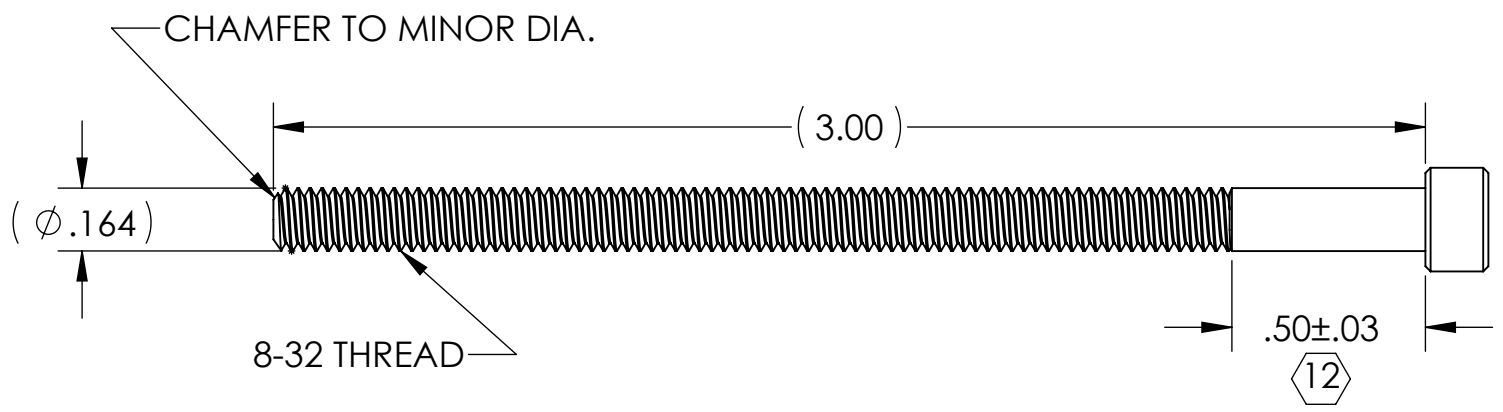
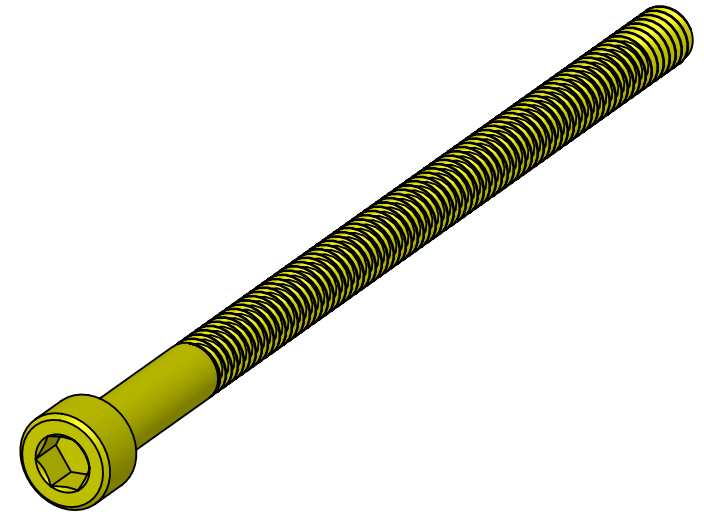

D1001973 aLIGO TMS FOCUS SCREW, PART PDM REV: X-021, DRAWING PDM REV: X-023

NOTES AND TOLERANCES: (UNLESS OTHERWISE SPECIFIED)				LIGO CALIFORNIA INSTITUTE OF TECHNOLOGY MASSACHUSETTS INSTITUTE OF TECHNOLOGY		PART NAME					
DIMENSIONS ARE IN INCHES				SYSTEM		SUB-SYSTEM		DESIGNER		SIZE DWG. NO.	
TOLERANCES: .XX ± .01 .XXX ± .005				NEXT ASSY		AOS		K. MAILAND 07/20/2010		B D1001973	
ANGULAR ± 1.0°				MATERIAL		D1001600		SEE DCC		REV. v3	
1. INTERPRET DRAWING PER ASME Y14.5-1994. 2. REMOVE ALL SHARP EDGES, .005 - .015. 3. DO NOT SCALE FROM DRAWING. 4. ALL MACHINING FLUIDS MUST BE FULLY SYNTHETIC, FULLY WATER SOLUBLE AND FREE OF SULFUR, SILICONE, AND CHLORINE.				FINISH		APPROVAL		SEE DCC		SCALE: 1:1 PROJECTION:	
⑩				⑪		SEE CC		SHEET 1 OF 1			

8 7 6 5 4 3 2 1