

PROPRIETARY AND CONFIDENTIAL  
 THE INFORMATION CONTAINED IN THIS  
 DRAWING IS THE SOLE PROPERTY OF  
 GNB CORPORATION. ANY  
 REPRODUCTION IN PART OR AS A WHOLE  
 WITHOUT THE WRITTEN PERMISSION OF  
 GNB CORPORATION IS PROHIBITED.

REVISIONS				
ZONE	REV.	DESCRIPTION	DATE	APPROVED
	A	RELEASED TO PRODUCTION	8/24/2010	MKM2

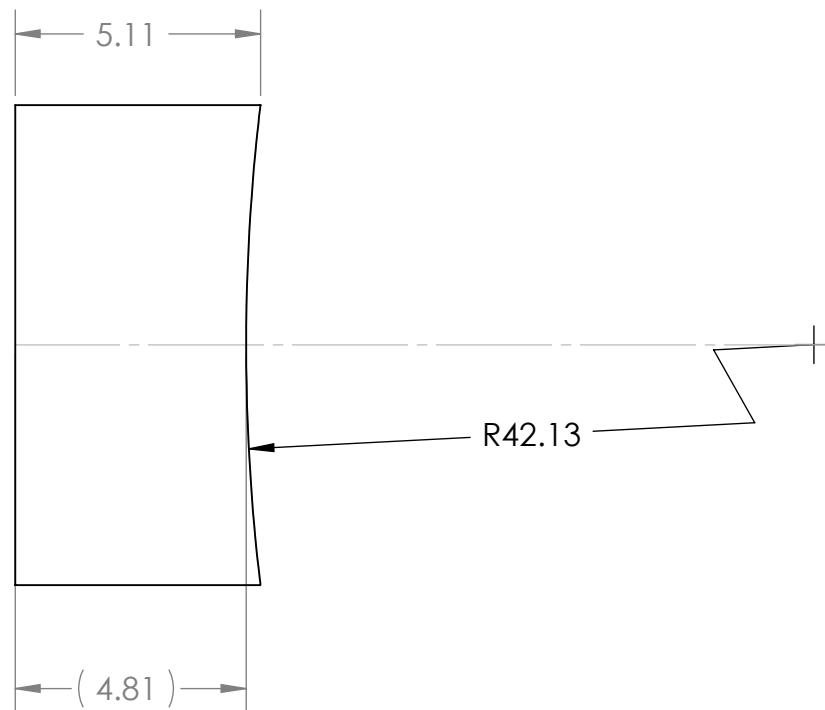
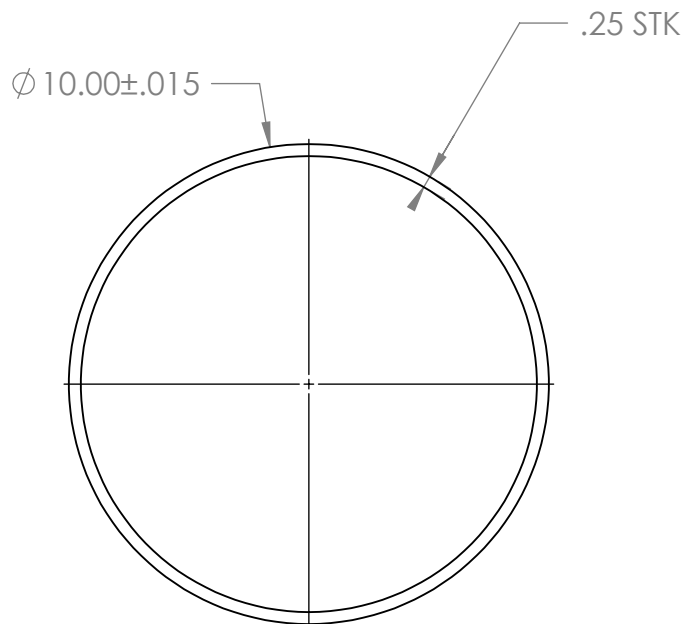

NOTES:

1. THE FOLLOWING ARE NOT ALLOWED: GRINDING, HONING, LAPPING, POLISHING, BUFFING, SANDING, BLASTING.
2. NO HYDROCARBONS ALLOWED IN THE COOLANT. COOLANT LIMITS AS FOLLOWS
  - a. WATER LEACHABLE CHLORIDES: 100PPM
  - b. TOTAL HALOGENS (INCLUDING CHLORIDES): 1000PPM
  - c. TOTAL SULFUR: 1000PPM
3. DO NOT ALLOW PART TO BE CONTAMINATED BY CARBON STEEL OR IRON CONTACT.
4. MACHINING TO BE IN LINE WITH LIGO SPECIFICATION E0900406, LATEST REVISION.

DESCRIPTION: TUBE, 10.00 OD, .25 WALL, 5.11 LG		WEIGHT: 10.96 #	
MATERIAL: AISI 304/AISI 304L DUAL CERT PER SA240		APPROVALS	
UNLESS OTHERWISE SPECIFIED: DIMENSIONS ARE IN INCHES TOLERANCES: FINISH ANGULAR: $\pm 0^{\circ}30'$ .XX $\pm .01$ .XXX $\pm .005$ UNSPECIFIED FILLETS: R.015 BREAK EDGES .010 x 45° REMOVE ALL BURRS //  WITHIN .03		NAME	DATE
THIRD ANGLE PROJECTION 		DRAFTER MKM2	6/25/10
		CHECKER RW	7/22/10
		ENGINEER MKM2	6/25/10
DO NOT SCALE DRAWING		GNB CORPORATION SCIENTIFIC AND INDUSTRIAL EQUIPMENT 3200 DWIGHT RD, SUITE 100 ELK GROVE, CA 95758 916-395-3003 FAX: 916-395-3363 WWW.GNBVALVES.COM	
		TITLE: TUBE, PORT, 12" CF	
		DWG. NO. 114215-00S	
		SCALE: 1:4	
		SHEET 1 OF 1	
		REV A	