

NOTES CONTINUED:
 ⑤ SCRIBE, ENGRAVE, OR MECHANICALLY STAMP (NO DYES OR INKS) A UNIQUE THREE DIGIT SERIAL NUMBER & REVISION NUMBER ON EACH PART. SERIAL NUMBERS START AT 001 FOR THE FIRST ARTICLE AND PROCEED CONSECUTIVELY. BAG AND TAG PARTS WITH THEIR DRAWING PART NUMBER, REVISION, VARIANT OR "TYPE" (IF APPLICABLE), AND QUANTITY. IF PARTS ARE TOO SMALL TO SCRIBE, BAGGING AND TAGGING ALONE IS SUFFICIENT.
 EXAMPLE (PART): 001-v1
 EXAMPLE (TAG): DXXXXXX-VY, TYPE-XX, QTY: TBD

REV.	DATE	DCN #	DRAWING TREE #
V1	9 AUG 2010		
V2	9 SEPT 2010		

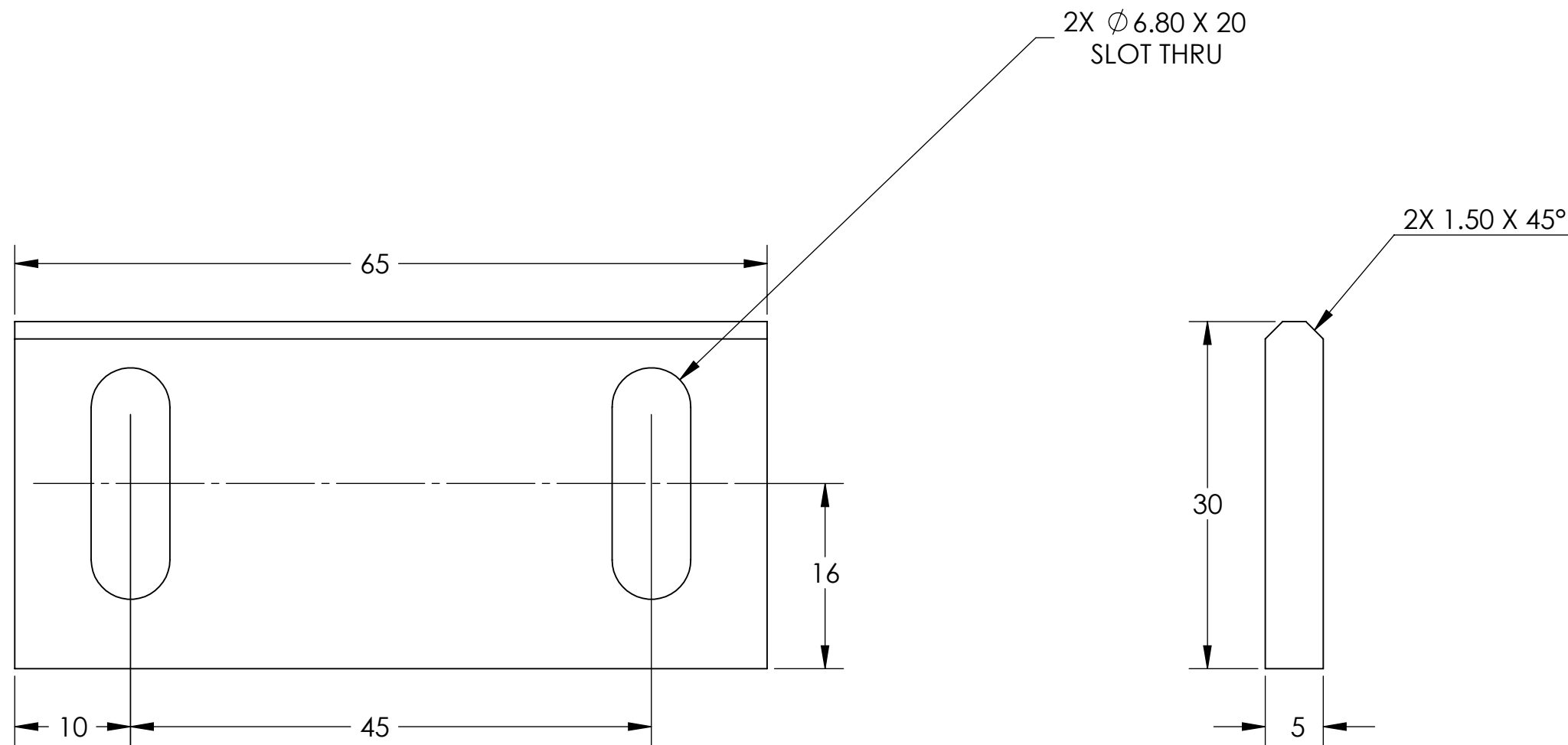

D1002058 LSAT CAPTURE AND UNION PLATE, ALIGO, SUS, PART PDM REV: X-000, DRAWING PDM REV: X-000

D
C
B
A

D
C
B
A

NOTES AND TOLERANCES: (UNLESS OTHERWISE SPECIFIED)				LIGO CALIFORNIA INSTITUTE OF TECHNOLOGY MASSACHUSETTS INSTITUTE OF TECHNOLOGY		PART NAME	
DIMENSIONS ARE IN MILLIMETERS				ADVANCED LIGO		CAPTURE AND UNION PLATE	
TOLERANCES: .X ± .25 .XX ± .13				SUB-SYSTEM SUS		DESIGNER K. BUCKLAND 9 AUG 2010	
ANGULAR ± 0.5°				NEXT ASSY D1001221		DRAFTER K. BUCKLAND 9 AUG 2010	
MATERIAL 6061-T6 (SS)				FINISH 32 µinch		CHECKER	
						APPROVAL	
						SCALE: 2:1 PROJECTION:	
						SIZE DWG. NO. B D1002058	
						REV. v2	
						SHEET 1 OF 1	