

8 7 6 5 4 3 2 1

**NOTES CONTINUED:**  
 ☞ SCRIBE, ENGRAVE, OR MECHANICALLY STAMP (NO INKS OR DYES) DRAWING PART NUMBER, REVISION (AND VARIANT OR 'TYPE' IF APPLICABLE) ON NOTED SURFACE OF PART FOLLOWED ON THE NEXT LINE WITH A THREE DIGIT SERIAL NUMBER. SERIAL NUMBERS START AT 001 FOR THE FIRST ARTICLE AND PROCEED CONSECUTIVELY. USE MINIMUM 0.12" HIGH CHARACTERS, UNLESS THE SIZE OF THE PART DICTATES SMALLER CHARACTERS. A VIBRATORY TOOL MAY BE USED.  
 EXAMPLE: DXXXXXX-VY, TYPE-XX, S/N XXX

REV.	DATE	DCN #	DRAWING TREE #
-	-	-	-
-	-	-	-
-	-	-	-

( $\phi$ 370)

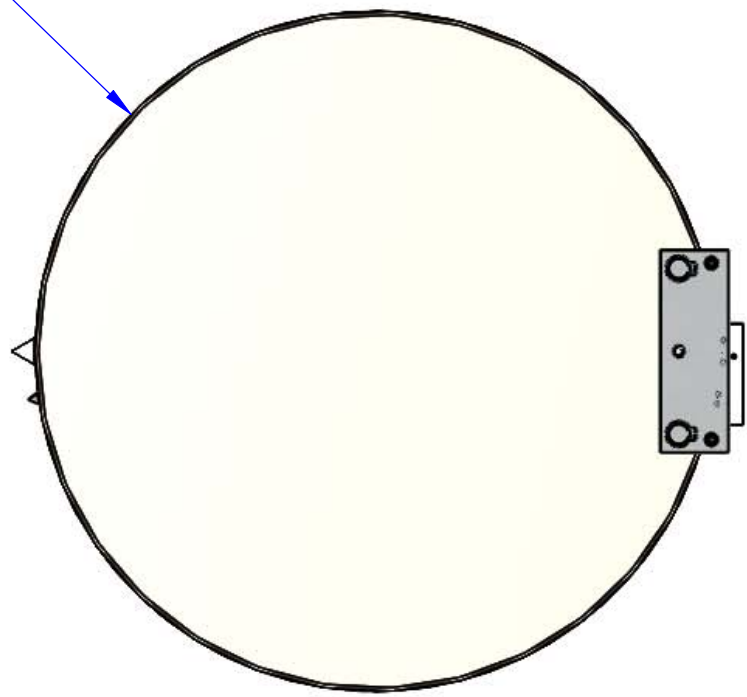

(59.8)

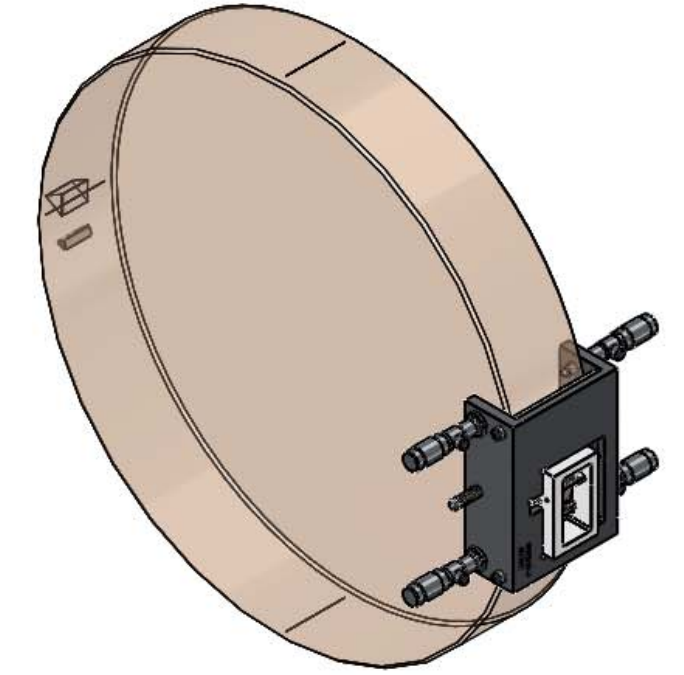
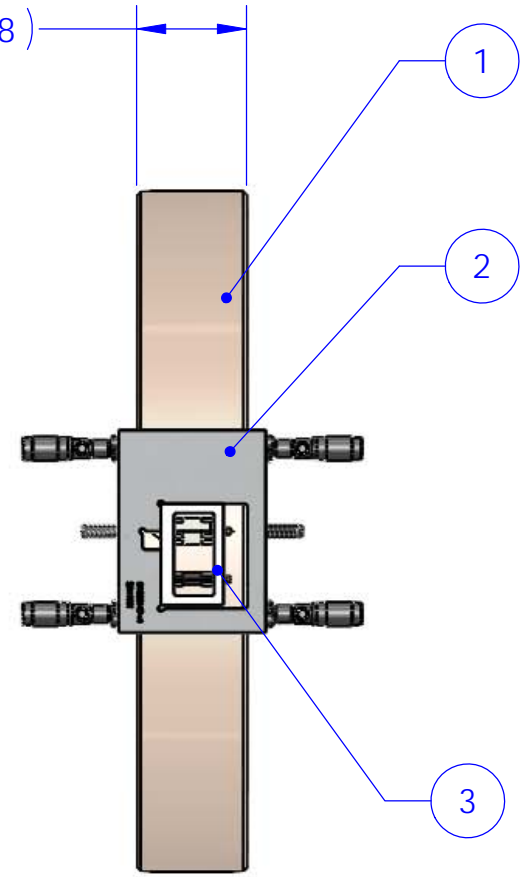

ITEM NO.	PART NUMBER	DESCRIPTION	QTY.
3	D1002152	Prism Holder Assembly	1
2	D1002148	Prism bonding fixture	1
1	D1000576	FM OPTIC WITH PRISMS ASSEMBLY	1

**NOTES AND TOLERANCES: (UNLESS OTHERWISE SPECIFIED)**

DIMENSIONS ARE IN MILLIMETERS

TOLERANCES:  
 .XX ± N/A  
 .XXX ± N/A  
 ANGULAR ± °N/A

1. INTERPRET DRAWING PER ASME Y14.5-1994.  
 2. REMOVE ALL SHARP EDGES, R.5 MIN.  
 3. DO NOT SCALE FROM DRAWING.  
 4. ALL MACHINING FLUIDS MUST BE FULLY SYNTHETIC, FULLY WATER SOLUBLE AND FREE OF SULFUR, SILICONE, AND CHLORINE.

MATERIAL: N/A

FINISH: N/A  $\mu$ m

**PARTS LIST**

CALIFORNIA INSTITUTE OF TECHNOLOGY  
 MASSACHUSETTS INSTITUTE OF TECHNOLOGY

SYSTEM: aLIGO SUB-SYSTEM: SUS

PART NAME: BS/FM PRISM BONDING JIG

DESIGNER: M.V.VEGGEL/R.JONES  
 DRAFTER: R.JONES  
 CHECKER: M.V.VEGGEL  
 APPROVAL: --

SEPT10  
 OCT10  
 OCT10  
 --

SIZE: B DWG. NO.: D1002147

SCALE: 1:4 PROJECTION:

REV. v1 SHEET 1 OF 1

D1002147\_aligo\_BSFM\_PRISM\_BONDING\_JIG, PART PDM REV: v1, DRAWING PDM REV:

8 7 6 5 4 3 2 1