

D1002303 DOWEL INSTALLATION BUSHING, .38 DIA, aLIGO BSC ISI, PART PDM REV: X-001, DRAWING PDM REV: X-003

**NOTES CONTINUED:**  
 5. SCRIBE, ENGRAVE, OR MECHANICALLY STAMP (NO INKS OR DYES) DRAWING PART NUMBER, REVISION (AND VARIANT OR "TYPE" IF APPLICABLE ON NOTED SURFACE OF PART FOLLOWED ON THE NEXT LINE WITH A THREE DIGIT SERIAL NUMBER. SERIAL NUMBERS START AT 001 FOR THE FIRST ARTICLE AND PROCEED CONSECUTIVELY. USE MINIMUM 0.12 HIGH CHARACTERS, UNLESS THE SIZE OF THE PART DICTATES SMALLER CHARACTERS. A VIBRATORY TOOL MAY BE USED. EXAMPLE DXXXXXX-VY, TYPE-XX, S/N XXX.  
 6. APPROXIMATE WEIGHT = 0.7 LB.  
 7. MACHINE ALL SURFACES TO REMOVE OXIDES AND MILL FINISH, USE OF ABRASIVE REMOVAL TECHNIQUES (INCLUDING SANDING OR SCOURING FOR MATTE FINISH) IS NOT ALLOWED.  
 8. ALL PARTS SHALL BE MANUFACTURED IN ACCORDANCE WITH LIGO SPECIFICATION E0900364.

REV.	DATE	DCN #	DRAWING TREE #
v1	30 Aug 2010	E1000373	-
v2	09 Nov. 2010	E1000685	-

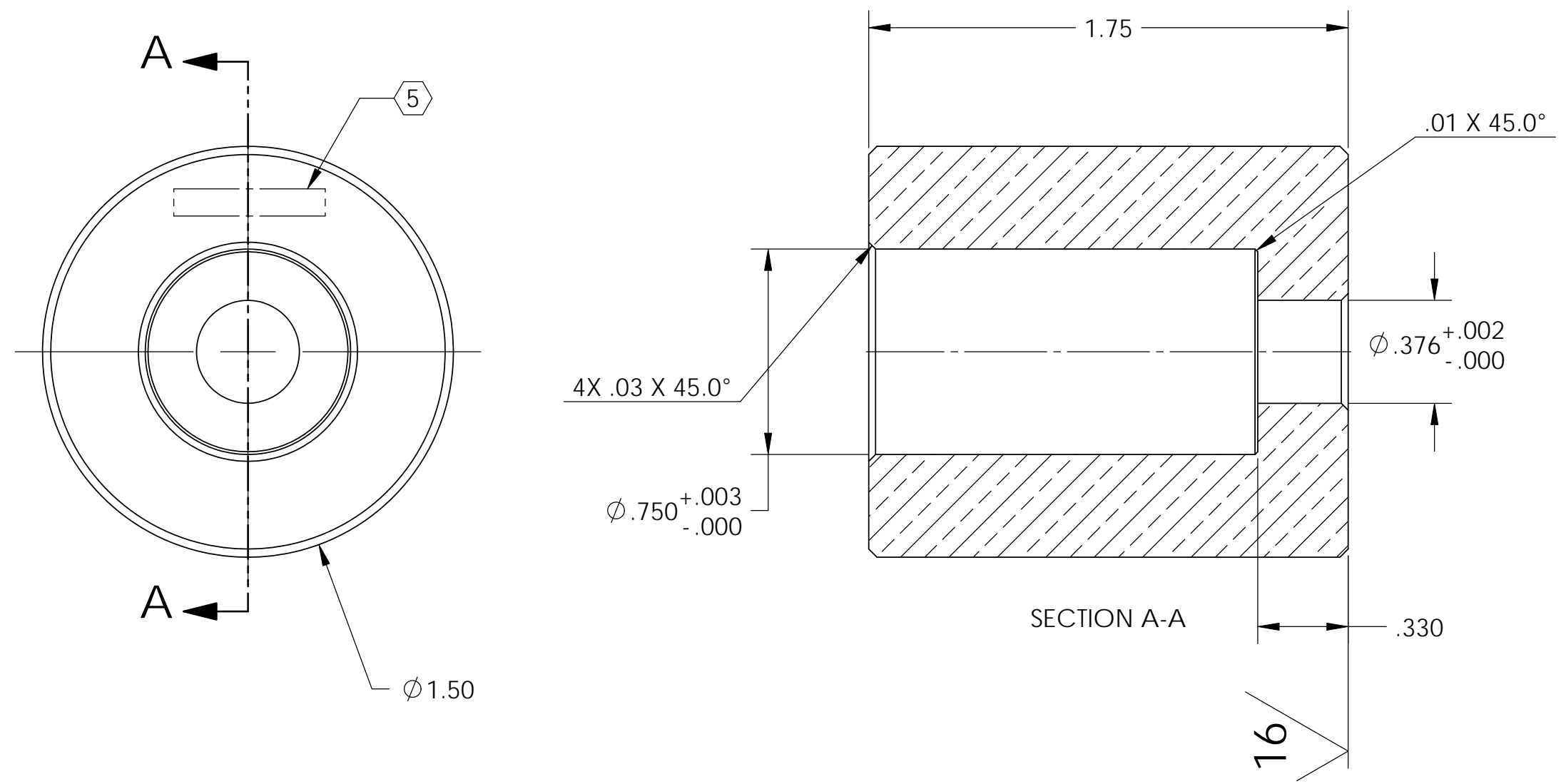

NOTES AND TOLERANCES: (UNLESS OTHERWISE SPECIFIED)				LIGO		CALIFORNIA INSTITUTE OF TECHNOLOGY MASSACHUSETTS INSTITUTE OF TECHNOLOGY		PART NAME			
DIMENSIONS ARE IN INCHES				ADVANCED LIGO		SEI		DOWEL INSTALLATION BUSHING, 3/8 DIA. aLIGO BSC ISI			
TOLERANCES: .XX ± .015 .XXX ± .005				NEXT ASSY		DESIGNER	M.HILLARD	27 Aug 2010	SIZE	DWG. NO.	REV.
ANGULAR ± .5°				MATERIAL		DRAFTER	M.HILLARD	30 Aug 2010	B	D1002303	v2
FINISH				Brass		CHECKER	F.MATICHERD	30 Aug 2010	SCALE: 2:1	PROJECTION:	SHEET 1 OF 1
32 μinch						APPROVAL	K.MASON	30 Aug 2010			