

1 EXISTING STRUCTURAL ROOF FRAMING
1/16" = 1' - 0"

EXISTING STORAGE BUILDING
25'-0" PEAK, 18' EAVES
160' X 80'

NOTE: REFER TO MECHANICAL FOR RELOCATED MECH. UNITS
PROVIDE TWO (2) ADDITIONAL ZEE PURLINS FOR EACH MECHANICAL UNIT, AT ITS NEW LOCATION
MATCH EXISTING ZEE PURLINS DESIGN STRENGTH AND DIMENSIONS

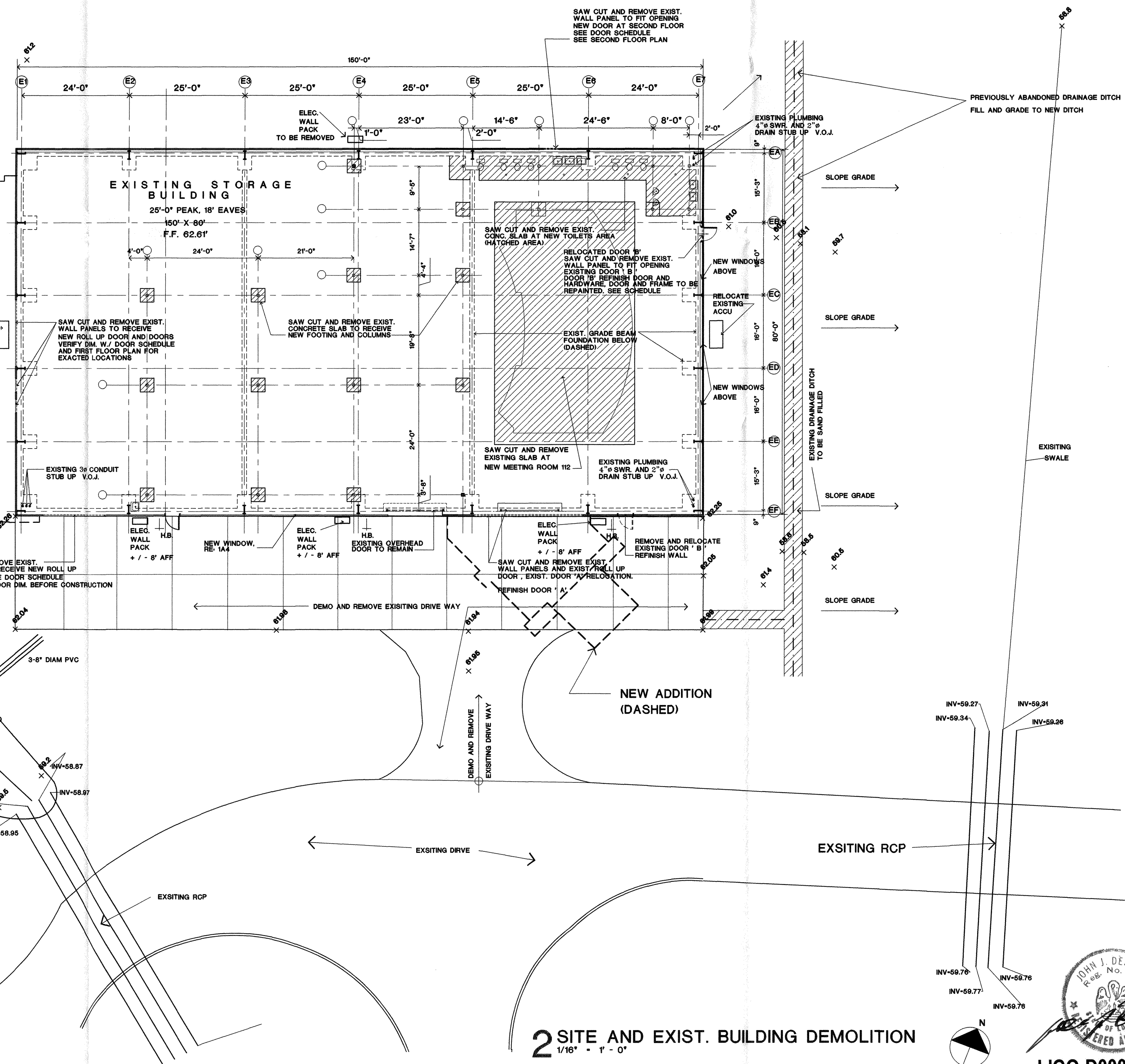

2 SITE AND EXIST. BUILDING DEMOLITION
1/16" = 1' - 0"

LIGO-D000271-00-L

EXISTING SITE AND BUILDING DEMOLITION PLANS

NEW STAGING BUILDING FOR

LIGO
LIVINGSTON, LOUISIANA

LIGO-D000271-00-L

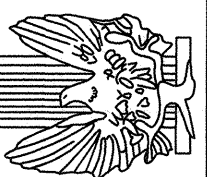

JOHN DESMOND & ASSOCIATES ARCHITECTS/PLANNERS
703 LAUREL ST. BATON ROUGE, LA. 70802
MEMBER AMERICAN INSTITUTE OF ARCHITECTS

DATE 09.08.2000
SHEET

A1.2

OF