

8

7

6

5

4

3

2

1

REV.	DATE	DCN #	DRAWING TREE #
05	07/FEB/2003	SPRING PINS NOW USED RATHER THAN SPACERS	
06	24/FEB/2003	ADDITION OF INSULATING SPACERS, SHOULDERS ETC.	
07	01/MAY/2003	ADDITION OF COILD FORMER ONE PIECE & NOTE ON ISOLATION	

D

D

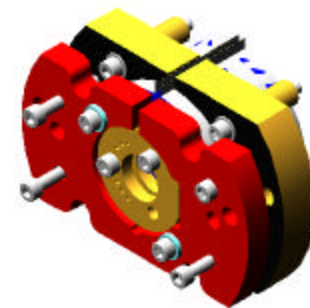
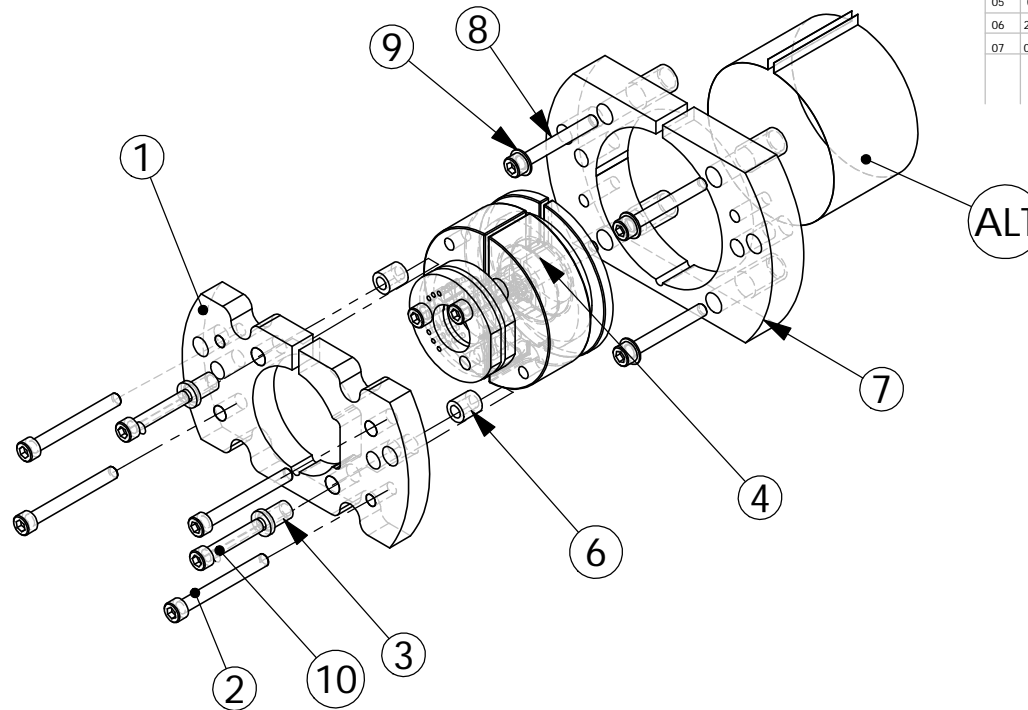
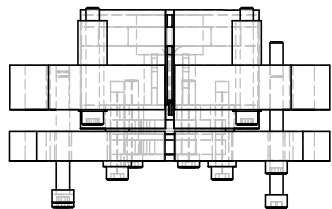

C

C

B

B

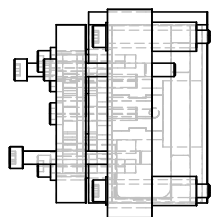
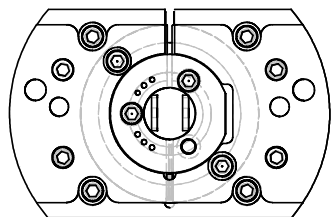

ITEM NO	REQ.	SPARE	TOT.	PART NUMBER	DESCRIPTION	MATERIAL
10	2	1	3		SST VENTED SOCKET HEAD CAP SCREW #4-40 UNC-3A X 0.625 LONG	Ag 300 SST
9	4	2	6		FLAT WASHERS NAS 620-5L (OR EQUIV.)	300 SSSL
8	4	4	8		Ag-SST SOCKET HEAD CAP SCREW #4-40 UNC-3A X 0.875 LONG	Ag 300 SSSL
7	1	1	2	D030183	COIL FORMER CLAMP ONE PIECE	6061-T6-AI
6	2	1	3	D030123	SPACER FOR COIL FORMER BRACKET	TEFLON
ALT	1	1	2	D030124	KAPTON FILM 0.002" THICK (FOR COIL FORMER) 1.0" WIDE BY 4.7" LONG	KAPTON
4	1	0	1	D030105	ASSEMBLY COIL FORMER AND ASSOCIATED PARTS	
3	2	1	3	D030122	SHOULDER FOR COIL FORMER BRACKET	MACOR
2	4	2	6		Ag-SST SOCKET HEAD CAP SCREW #4-40 UNC-3A X 1 LONG	Ag 300 SSSL
1	1	0	1	D020282	COIL FORMER BRACKET	300 SSSL
ITEM NO REQ. SPARE TOT. PART NUMBER DESCRIPTION MATERIAL						

A

A

**SolidWorks Educational License
Instructional Use Only**

NOTES: (UNLESS OTHERWISE SPECIFIED)

- DIMENSIONS IN INCHES.
- REMOVE ALL SHARP EDGES, R.02 MIN.
- ALL MACHINING FLUIDS SHALL BE WATER SOLUBLE AND FREE OF SULFUR, CHLORINE AND SILICONE, SUCH AS CINCINNATI MILACRON'S CIMTECH 410 (STAINLESS STEEL).
- ASSEMBLE ACCORDING TO HYBRID OSEM ASSEMBLY SPECIFICATION, LIGO E030084-00-D.
- ADDITIONAL ISOLATION OF THE COIL HEAD ASSEMBLY, D030105, SUPPLIED BY A COMBINATION OF D030122, D030123, D030124 SHOULD BE USED AS REQUIRED.

PARTS LIST

DRAWN	NAME	DATE
CIT		02/12/02
CHECKED		
CALIFORNIA INSTITUTE OF TECHNOLOGY MASSACHUSETTS INSTITUTE OF TECHNOLOGY		
SYSTEM ADVANCED LIGO		
SUB-SYSTEM SUS		
NEXT ASSY MC: COIL		
PART NAME COIL ASSEMBLY		
SIZE	DWG. NO.	REV.
B	D020225	09
SCALE: NTS	PROJECTION:	SHEET 1 OF 1

DIMENSIONS ARE IN INCHES
TOLERANCES:

XX ± 0.01
XXX ± 0.005

ANGULAR ± 0.5 °

FILE NAME/LOCATION: 1

8

7

6

5

4

3

2

1