

REV.	DATE	DCN #	DRAWING TREE #
A	Fall'02		
B	7/16/03	E030373-00-E	

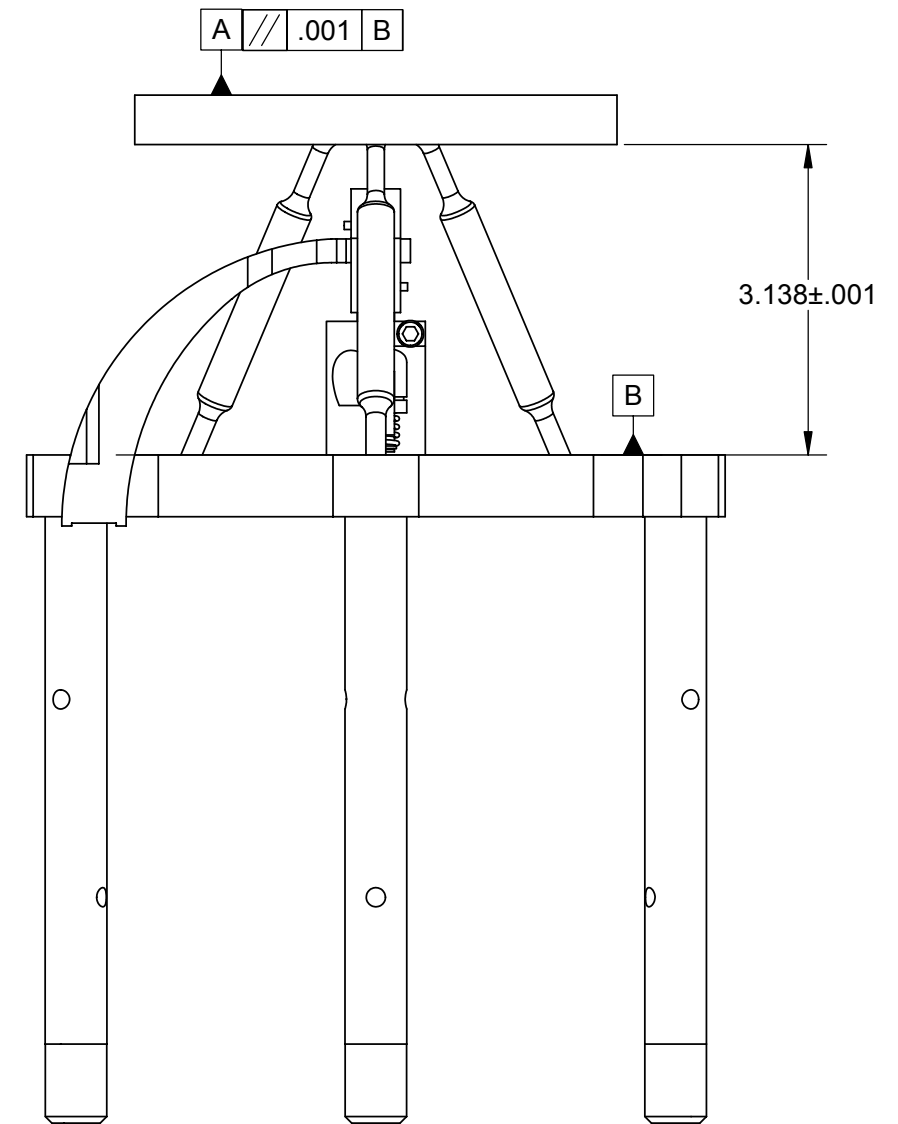
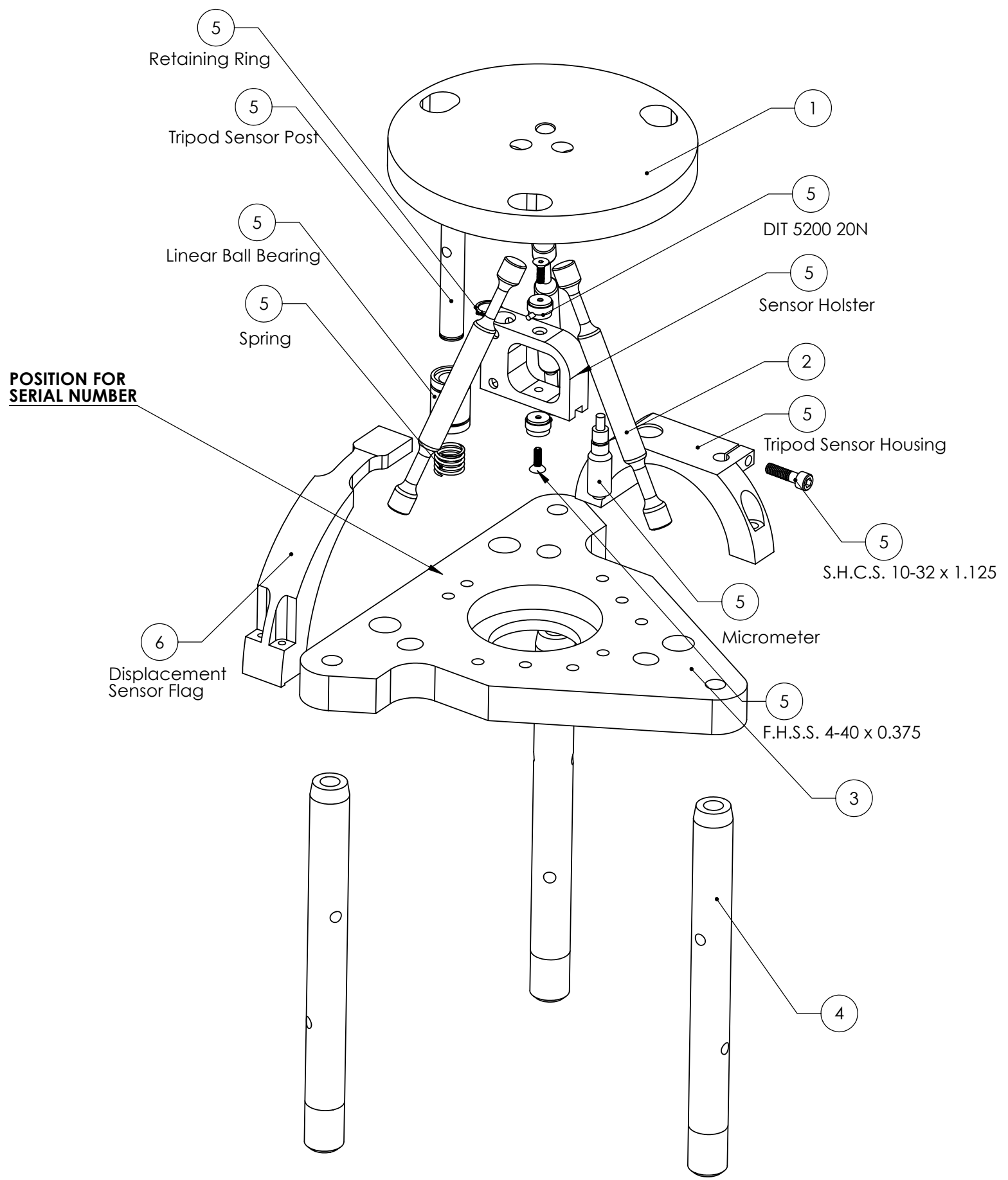

NOTE:
ASSEMBLE IN FIXTURE, TACK WELD 6 SPOTS
AND VACCUM BRAZE TRIPOD BARS TO
ATTACHMENT PLATE AND TRIPOD BASE

ITEM NO.	QTY.	PART NO.	DESCRIPTION	MATERIAL / VENDOR	SHT. NO.
6	1	D030705-A	Quarter Round Displacement Sensor Flag		41
5	1	D020368-B	TRIPOD DISPLACEMENT ASSEMBLY		37
4	3	D020371-B	TRIPOD VERTICAL POST		39
3	1	D020371-B	TRIPOD BASE		39
2	3	D020369-A	TRIPOD BAR		38
1	1	D020369-A	ATTACHMENT PLATE		38

UNLESS OTHERWISE SPECIFIED:	DATE	NAME	CALIFORNIA INSTITUTE OF TECHNOLOGY MASSACHUSETTS INSTITUTE OF TECHNOLOGY
DIMENSIONS ARE IN INCHES	4/02	Hardham	
TOLERANCES: :XX ± 0.020"	Fall' 02	Hammond	
:XXX ± 0.005"	7/16/03	Spjeld	
ANGULAR ± 30°	CHECKED	2/9/03	Kern
MATERIAL	COMMENTS:		PART NAME
FINISH 32 RMS unless noted	1 Required for each actuator		HEPI Tripod Assembly
	SIZE	DWG. NO.	REV
	C	D020368	B
	SCALE:	1:1 unless noted	Sht. No. 37 / 43