

UNISTRUT DUCT/TUBE SUPPORT, TYP

9"x9" ACCESS DOOR, RUSKIN ADH-14

ATTACH UNISTRUT TO HORIZONTAL Z-MEMBERS FOR FAN AND DUCT SUPPORT

SEE DET 1-2-3 FOR DUCT AND TUBE SUPPORT

SEE DET 4 PENETRATION SEALING DETAIL

LOCATE DUCT PENETRATION TO ACCOMMODATE JOIST SPACING
CONNECT TO FILTER (BY OTHERS) WITH FLEXIBLE DUCT. EXTEND DUCT AS REQUIRED.

13"ØD/10"ID (PERF)

13"ØD/10"ID (PERF)

13"ØD/10"ID (PERF)

13"ØD/10"ID (PERF)

A LAE WALL SECTION
SCALE: 1/2" = 1'-0"

B LAE WALL SECTION
SCALE: 1/2" = 1'-0"

SCALE IN FEET

SCALE IN FEET

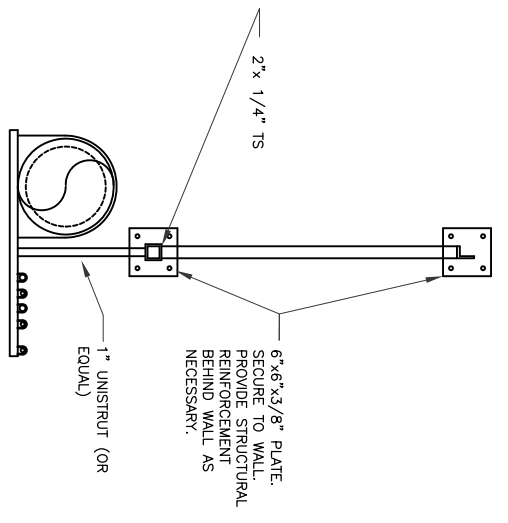

1 DUCT SUPPORT SECTION
SCALE: 1" = 1'-0"

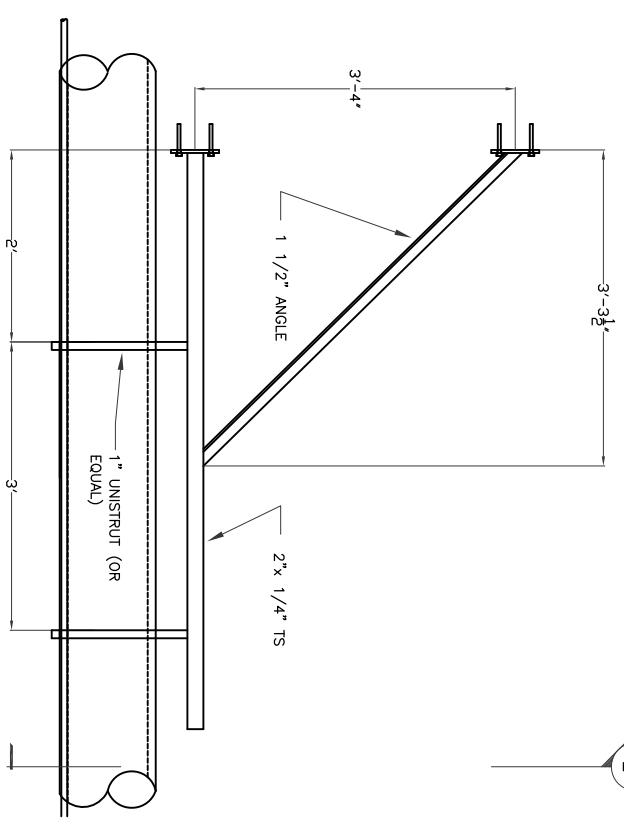

2 DUCT/TUBE SUPPORT DETAIL
SCALE: 1" = 1'-0"

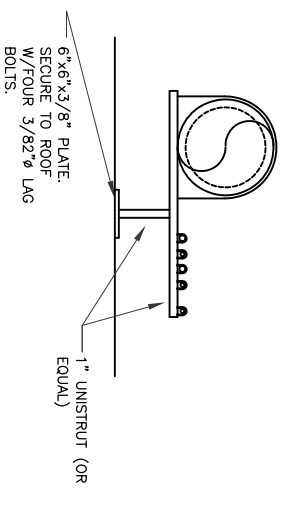

3 DUCT/TUBE SUPPORT DETAIL
SCALE: 1" = 1'-0"

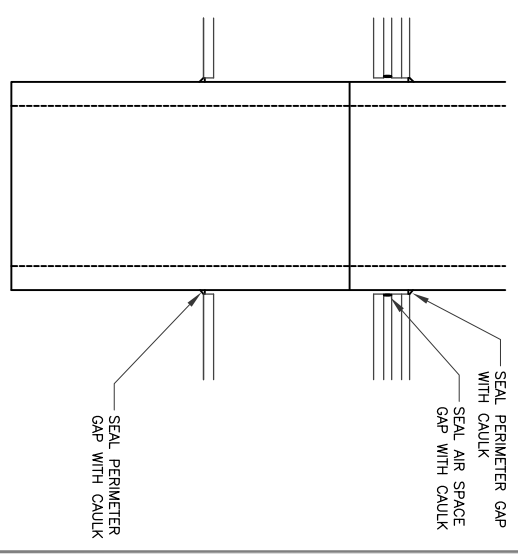

4 DUCT/TUBE SUPPORT DETAIL
SCALE: 1/2" = 1'-0"

DRAWING: LIGO-D1002393

PRINTED BY: GII on 2/3/2011 5:44 PM

© 2011 Hibbs Engineering, Inc.

CALIFORNIA INSTITUTE OF TECHNOLOGY
LIGO LIVINGSTON OBSERVATORY
HIBBS ENGINEERING, INC.
KENNEWICK, WASHINGTON

L1 LASER AREA ENCLOSURE
MECHANICAL
SECTIONS & DETAILS

PROJECT NUMBER: 1036.01
CAD FILE: 1036L1V5

DRAWN BY: GLH
CHECKED BY: DESIGN GM
HEI APPROVAL

REV No	DATE	BY	DESCRIPTION	APPROVED
v2	10/21/10	GLH	Moved supply air duct south. Added tube support.	
v3	1/17/11	GLH	INCREASE DUCT OD TO 13", ADD EXHAUST DUCT AND BACKDRAFT DAMPER	
v4	2/3/11	GLH	DELETE ERRONEOUS DIMENSIONS IN SECTION B, MODIFIED PVC CONDUIT LOCATIONS.	