

8 7 6 5 4 3 2 1

NOTES:
 4. VENDOR REFERENCES ARE PROVIDED AS EXAMPLES OF PARTS MEETING ALL REQUIRED SPECIFICATIONS. EQUIVALENTS ARE ALWAYS ACCEPTABLE UNLESS OTHERWISE SPECIFIED.
 5. REFER TO LIGO E0900357 FOR ASSEMBLY AND LOADING PROCEDURE.

REV.	DATE	DCN #	DRAWING TREE #
v1	24 Mar. 2011	E1100015	E1100016

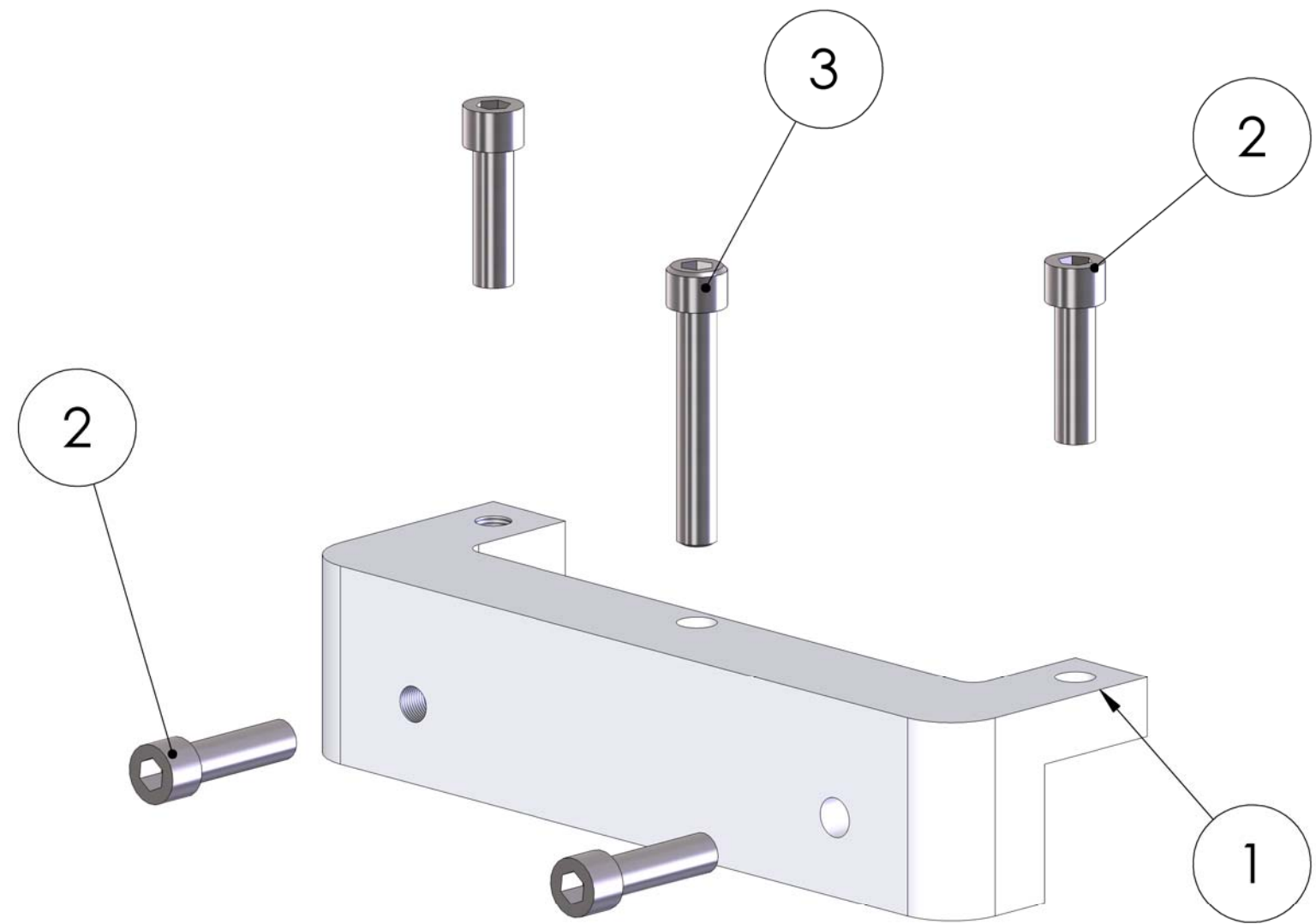

ITEM NO.	PART NUMBER	DESCRIPTION	MATERIAL	REQ
1	D020269	DOUBLE CLAMP	AISI 1018 Steel, Cold Rolled	1
2	HOLOKROME_73136	SCREW, 1/2-20 X 1.75 LG, SHCS	Alloy Steel	4
3	HOLOKROME_72242	SCREW 1/2-13 X 3" LG SHCS	Alloy Steel	1

PARTS LIST										
PART NAME					REV.					
DOUBLE CLAMP ASSEMBLY. aLIGO HEPI					v1					
DESIGNER	O.SPJELD	8 June 2004	SIZE	DWG. NO.	B D030367					
DRAFTER	M.HILLARD	24 Mar. 2011	SCALE: 1:1							PROJECTION:
CHECKER	K.MASON	8 June 2004	SHEET 1 OF 1							
APPROVAL	K.MASON	24 Mar. 2011								

NOTES AND TOLERANCES: (UNLESS OTHERWISE SPECIFIED)	
DIMENSIONS ARE IN INCHES	1. INTERPRET DRAWING PER ASME Y14.5-1994.
TOLERANCES: .XX ± N/A .XXX ± N/A	2. REMOVE ALL SHARP EDGES, .03 x 45°.
ANGULAR ± N/A*	3. DO NOT SCALE FROM DRAWING.
MATERIAL	SEE BOM
FINISH	N/A μinch

LIGO CALIFORNIA INSTITUTE OF TECHNOLOGY MASSACHUSETTS INSTITUTE OF TECHNOLOGY	
SYSTEM	SUB-SYSTEM
ADVANCED LIGO	SEI
NEXT ASSY	D040002, D040001

D030367, PART PDM REV: X-003, DRAWING PDM REV: X-000

8 7 6 5 4 3 2 1