

NOTES: (UNLESS OTHERWISE SPECIFIED)

MAKE 2 PARTS PER ASSEMBLY

ENG NOTE .125 TRIM AFTER WELD

REV.	DATE	DCN #	DRAWING TREE #
A	4-21-04	E040214-00-D	

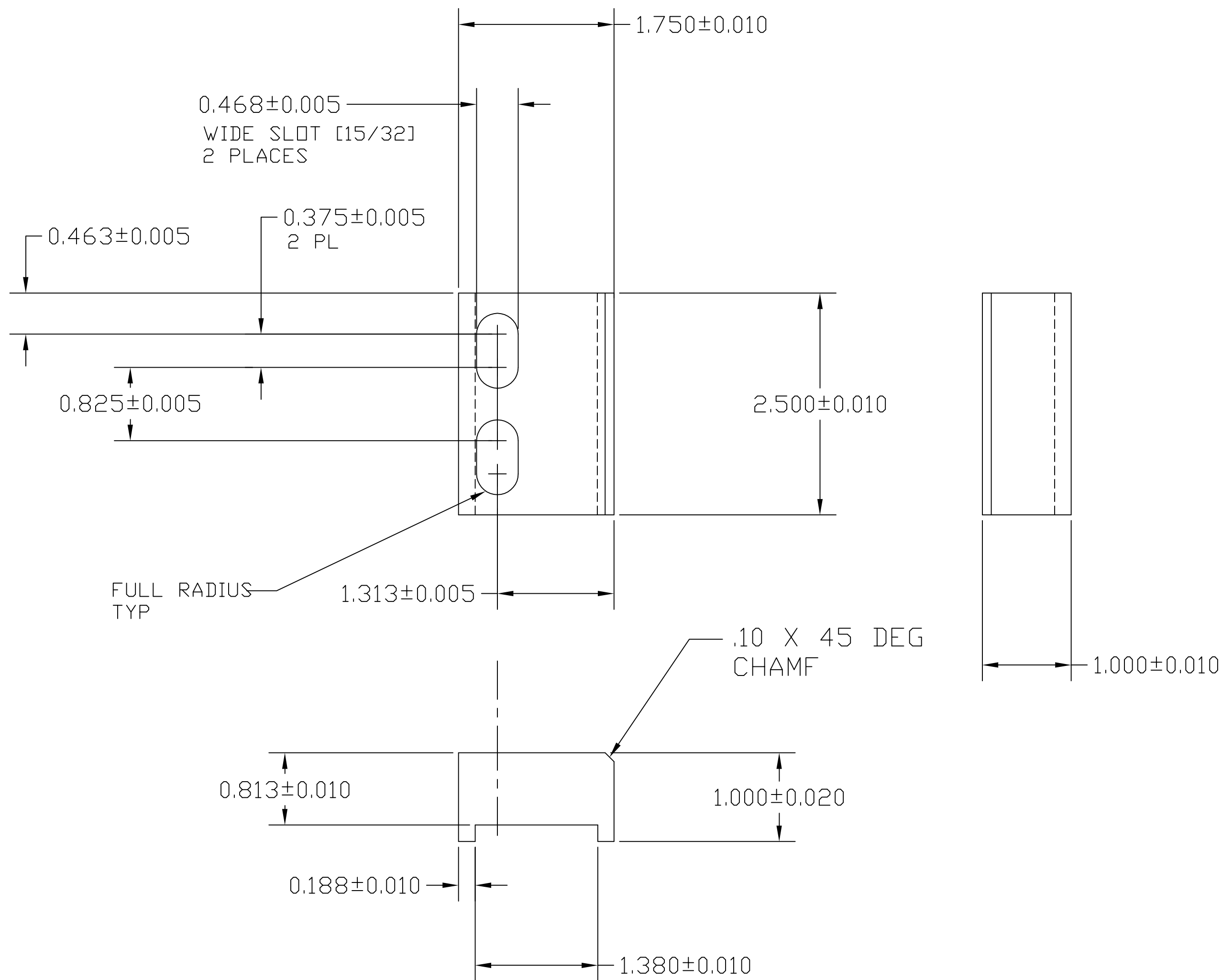

ITEM NO.	REQ. QUANTITY	SPARE	TOT. QUANTITY	PART NUMBER	DESCRIPTION	SUPPLIER
PARTS LIST						
UNLESS OTHERWISE SPECIFIED:				DATE	NAME	
DIMENSIONS ARE IN INCHES				DRAWN	4/21/04	KENM
TOLERANCES:				CHECKED		
XX ± .005						
XXX ± .01						
ANGULAR ± 3 DEG						
MATERIAL MILD STEEL				COMMENTS:		
FINISH NICKEL PLT. AFTER ASSEM.						
				SIZE	DWG. NO.	REV
				C	D030778-A	
				SCALE:		SHEET 1 OF 1