

NOTES: (UNLESS OTHERWISE SPECIFIED)

REV	DATE	DCN #	DRAWING TREE #

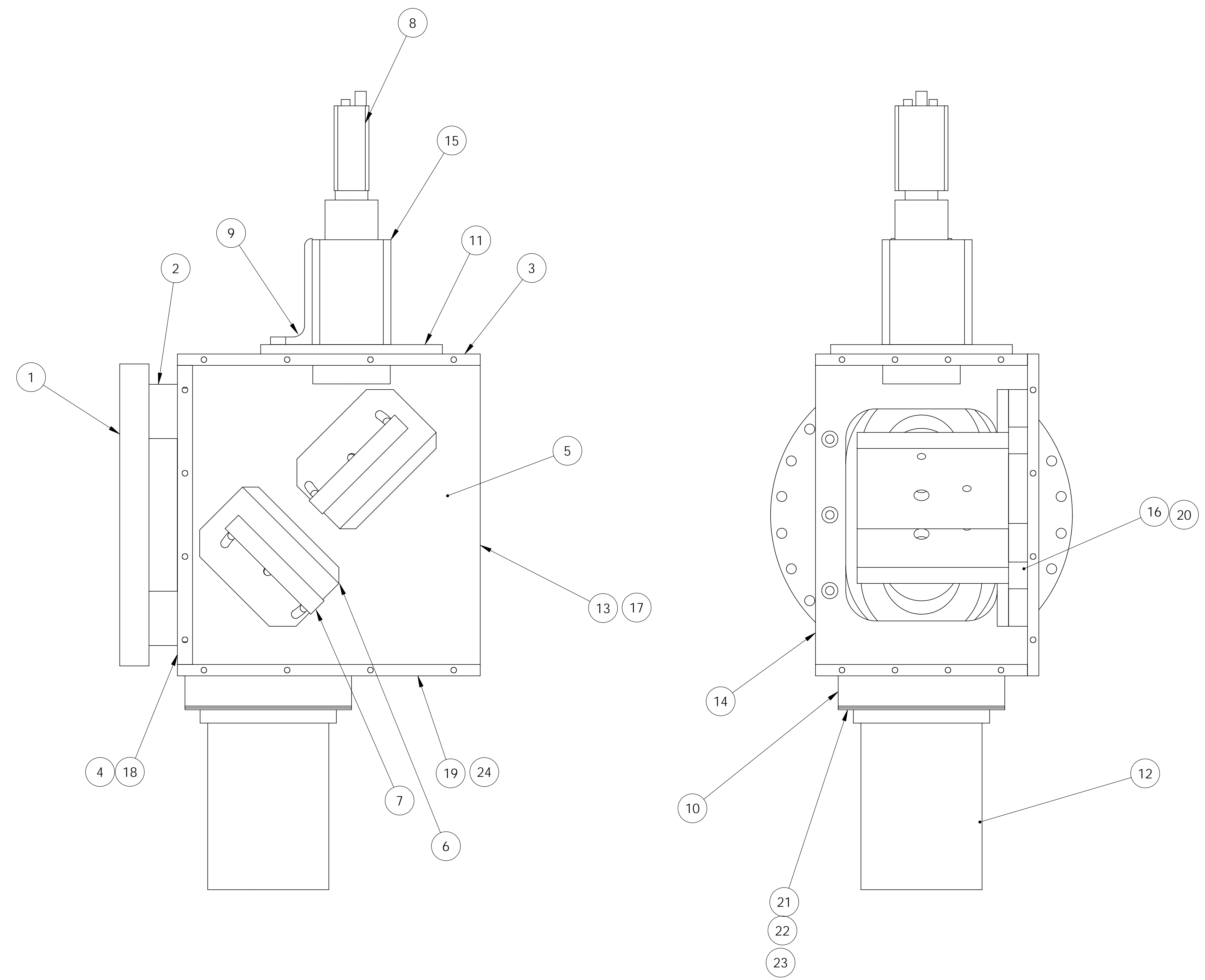

ITEM NO.	PART NUMBER	DESCRIPTION	QTY.
1	031111-1-01	Double Viewport, Norcal	1
2	D040010-A	Viewport Adapter Plate	1
3	D040008-A	UPPER PLATE, CAMERA BOX	1
4	D040016-A	Face Plate, Camera Box	1
5	D040009-A	Side Plate, Camera Box	1
6	D030803-A	Angle Mount, Modified	1
7	32071566	Elliptical Mirror, Edmund	1
8	XC-75	Sony Camera	1
9	D040189-A	CAMERA ANGLE PLATE	1
10	D040011-A	Beam Tube Adapter	1
11	D040007-A	CAMERA MOUNTING PLATE	1
12	D040012-A	Beam Tube	To fit
13	D040014-A	Back Cover, Camera Box	1
14	D040013-A	Side Cover, Camera Box	1
15	H20 x 15M	Rainbow Zoom Lens	1
16	D040187-A	OPTIC SPACER	1
17	92196A540	1/4-20 x 3/4 lg SHCS	12
18	-	5/16-18 x 1.0 lg SHCS	4
19	-	10-32 x .75 lg SHCS	36
20	-	1/4-20 X 1.25 LONG SHCS	6
21	-	1/4-20 X 1.75 LONG SHCS	4
22	D040236-A	BELLOWS	2
23	D040234-A	BACKING PLATE	2
24	D040191-A	LOWER PLATE, CAMERA BOX	1

ITEM NO.	REQ.	SPARE	TOT.	PART NUMBER	DESCRIPTION	SUPPLIER

UNLESS OTHERWISE SPECIFIED:		DATE	NAME
DIMENSIONS ARE IN INCHES			
TOLERANCES:			
.XX ± .01			
.XXX ± .005			
ANGULAR ± 1 DEG			

CHECKED	DATE	SYSTEM
KMASON	5/12/04	

PARTS LIST		REV
CALIFORNIA INSTITUTE OF TECHNOLOGY MASSACHUSETTS INSTITUTE OF TECHNOLOGY		
PART NAME		
LASER THERMAL COMPENSATOR		
CAMERA HOUSING - 2K		
SIZE	DWG. NO.	
D	D040041-A-D	
SCALE:		