

NOTES: (UNLESS OTHERWISE SPECIFIED)

NOTES: (UNLESS OTHERWISE SPECIFIED)

1. ALL DIMENSIONS ARE IN MILLIMETERS AND DEGREE-MINUTES.
2. DRAWING TO BE INTERPRETED PER ANSI Y14.5M-1992.
3. POLISH ALL FACES, EDGES AND CHAMFERS PER SPECIFICATION LIGO-E040470

REV.	DATE	DCN #	DRAWING TREE #
A	11/9/04	E040472-00-D	

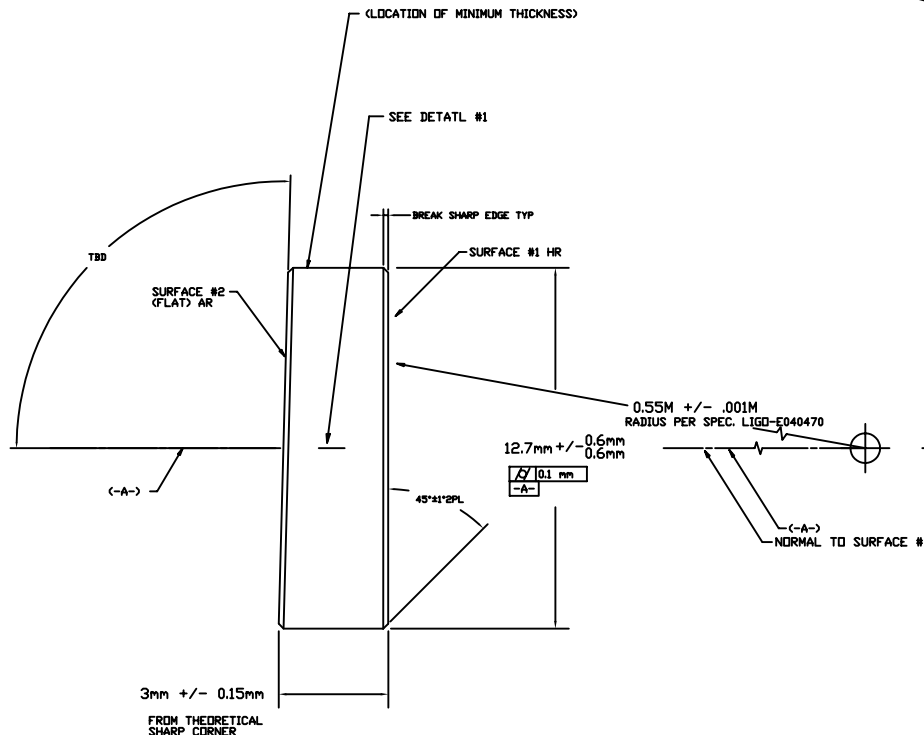

DETAIL #1
ETCH OR GRIND 0.25 MM ±0.05MM WIDE × 1MM ±1MM LONG LINE, CENTERED BETWEEN SURFACES #1 AND #2, AND AT LOCATION OF MINIMUM PART THICKNESS ±1°0'

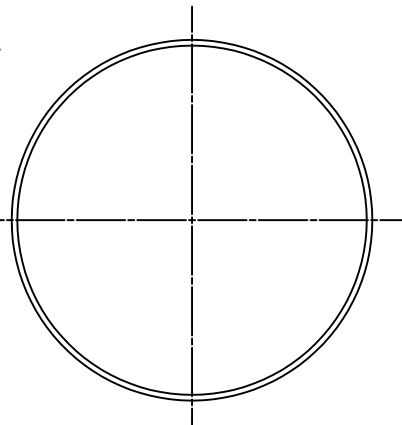

ITEM NO.	REQ. QUANTITY	SPARE	TOT.	PART NUMBER	DESCRIPTION	SUPPLIER
UNLESS OTHERWISE SPECIFIED: DIMENSIONS ARE IN INCHES						
TOLERANCES:				DATE	NAME	
XXX±.005				11/9/04	KENM	
XXXX±.0030						
ANGULAR±						
MATERIAL FUSED SILICA				PARTS LIST		
FINISH N/A				LIGO CALIFORNIA INSTITUTE OF TECHNOLOGY MASSACHUSETTS INSTITUTE OF TECHNOLOGY		
				SYSTEM LIGO		
				SUB-SYSTEM		
				NEXT ASSY TBD		
				PART NAME: PONDEROMOTIVE INTERFEROMETER END MIRROR SUBSTRATE		
SIZE B		DWG. NO. D040540 -A		REV		
SCALE:				SHEET 1 OF 1		