

LTR		ZONE		REVISIONS										
				DESCRIPTION	DWN	CHK	P-ENG	CONFIG	ME	STRS	MATL	PROJ	QA	RELEASE DATE
A				INITIAL RELEASE										

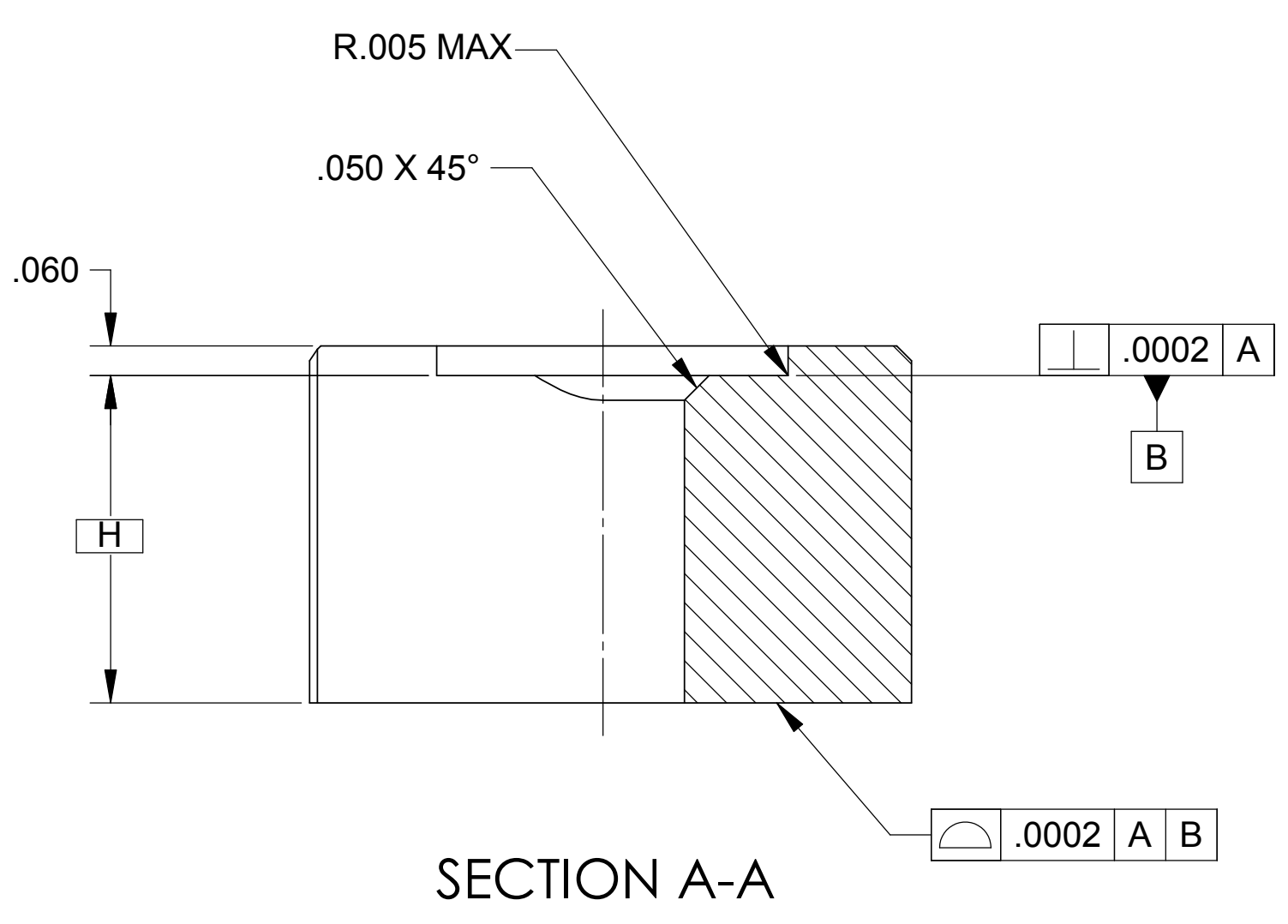
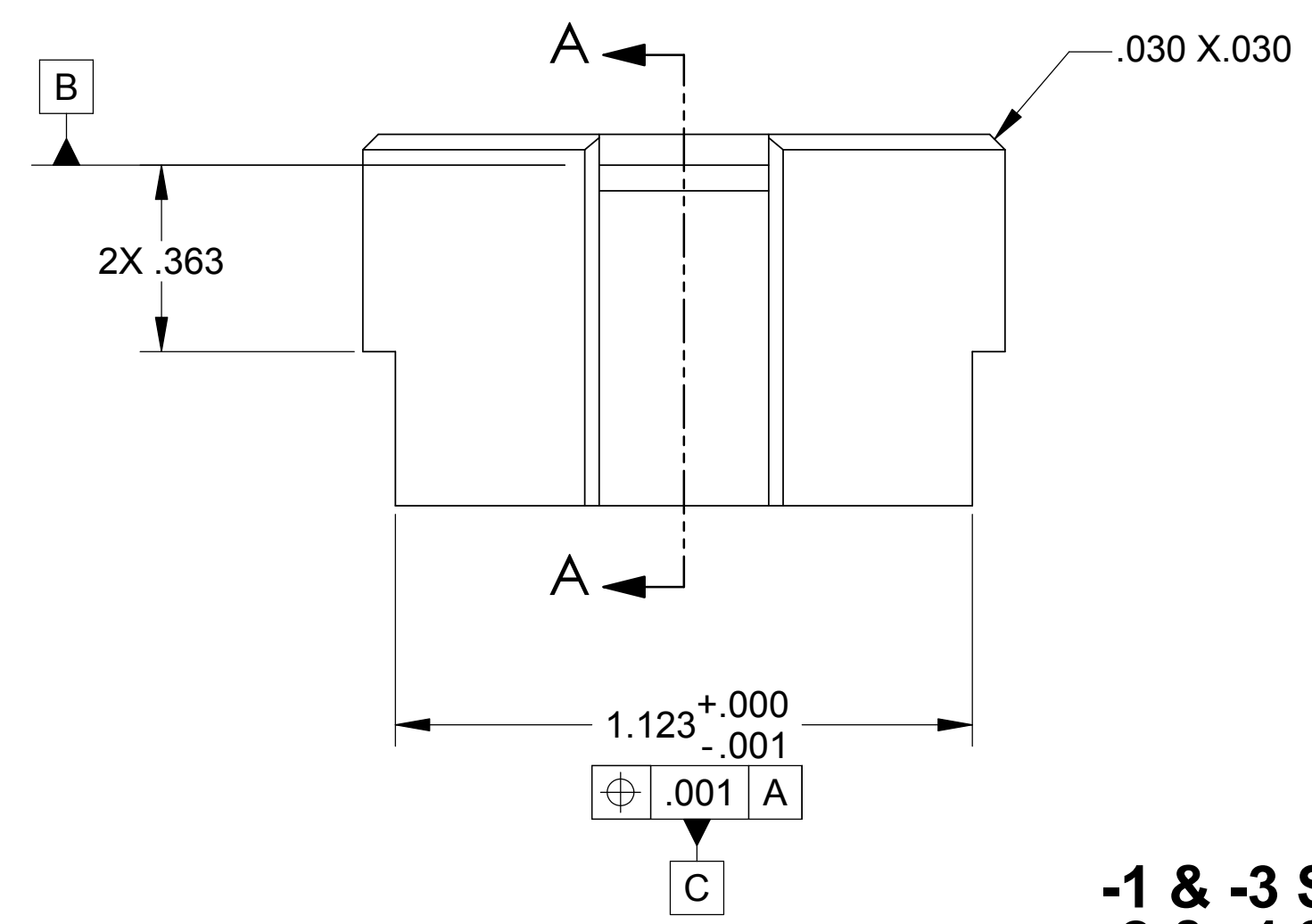
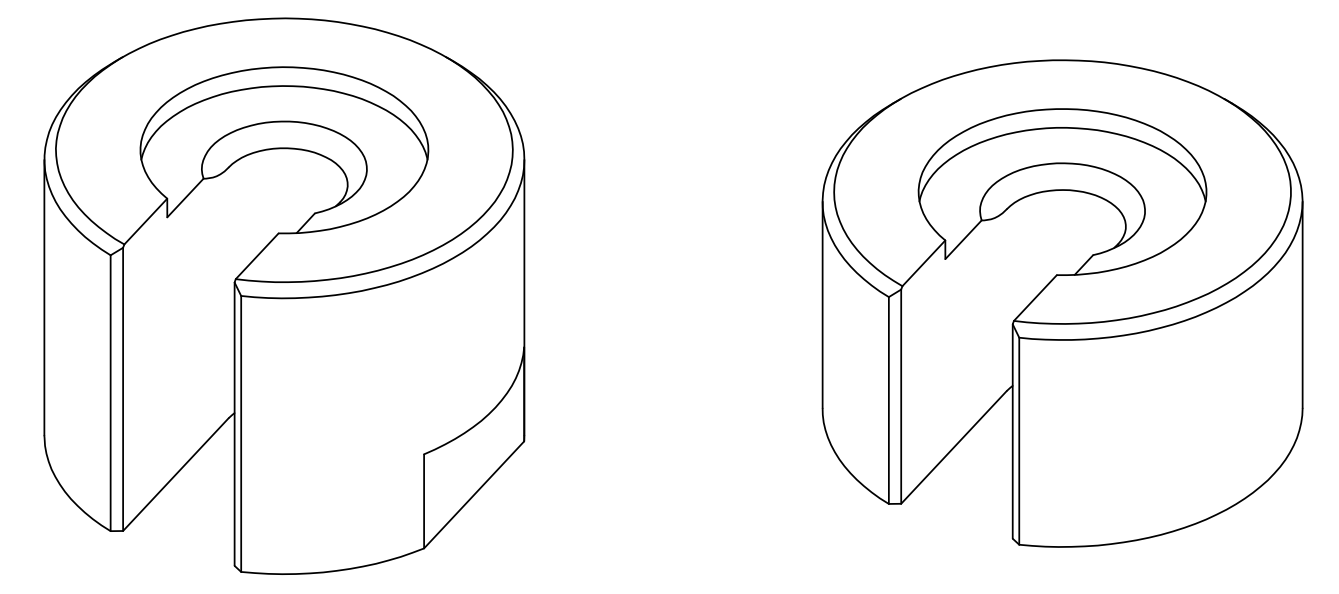
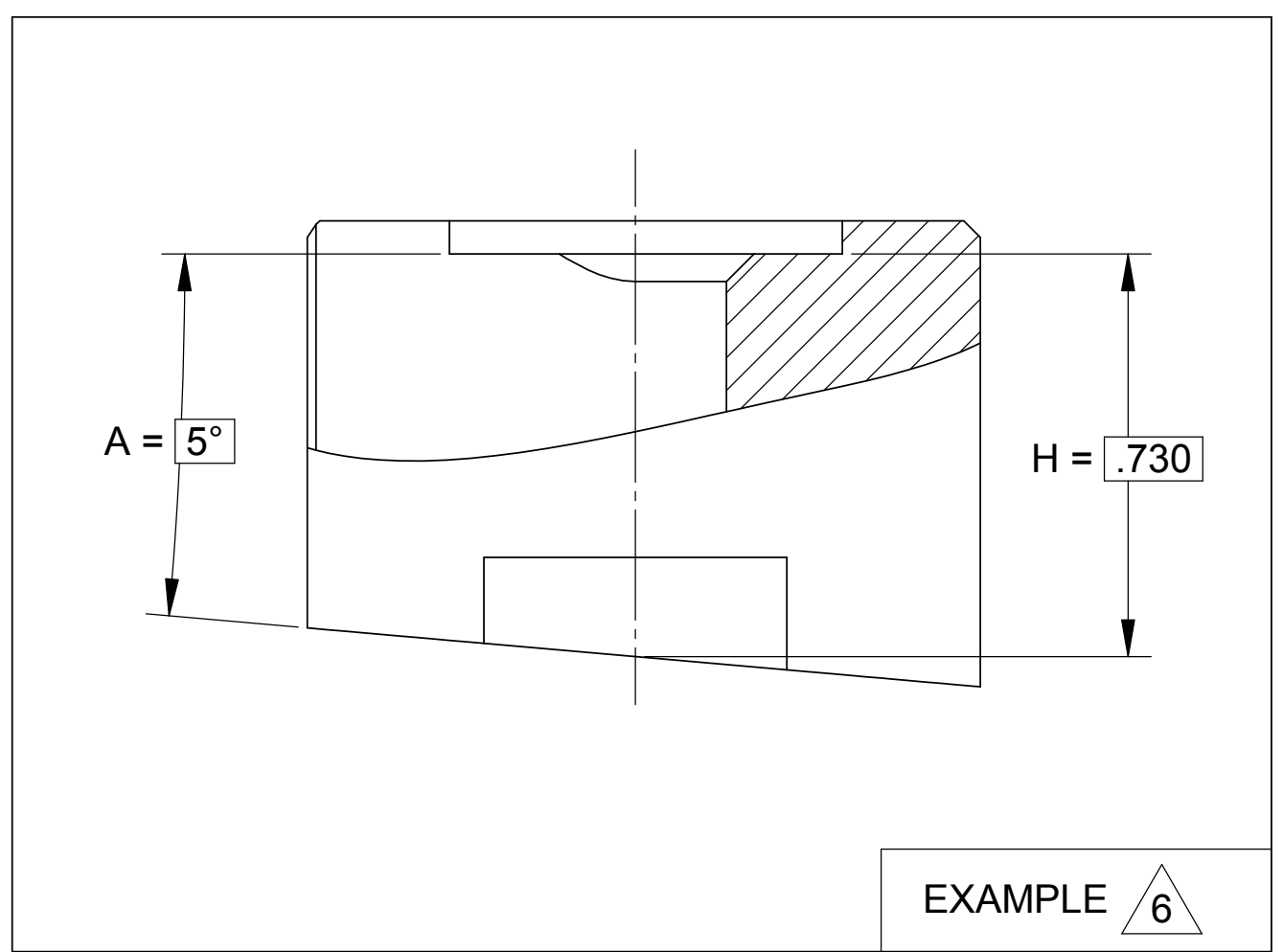
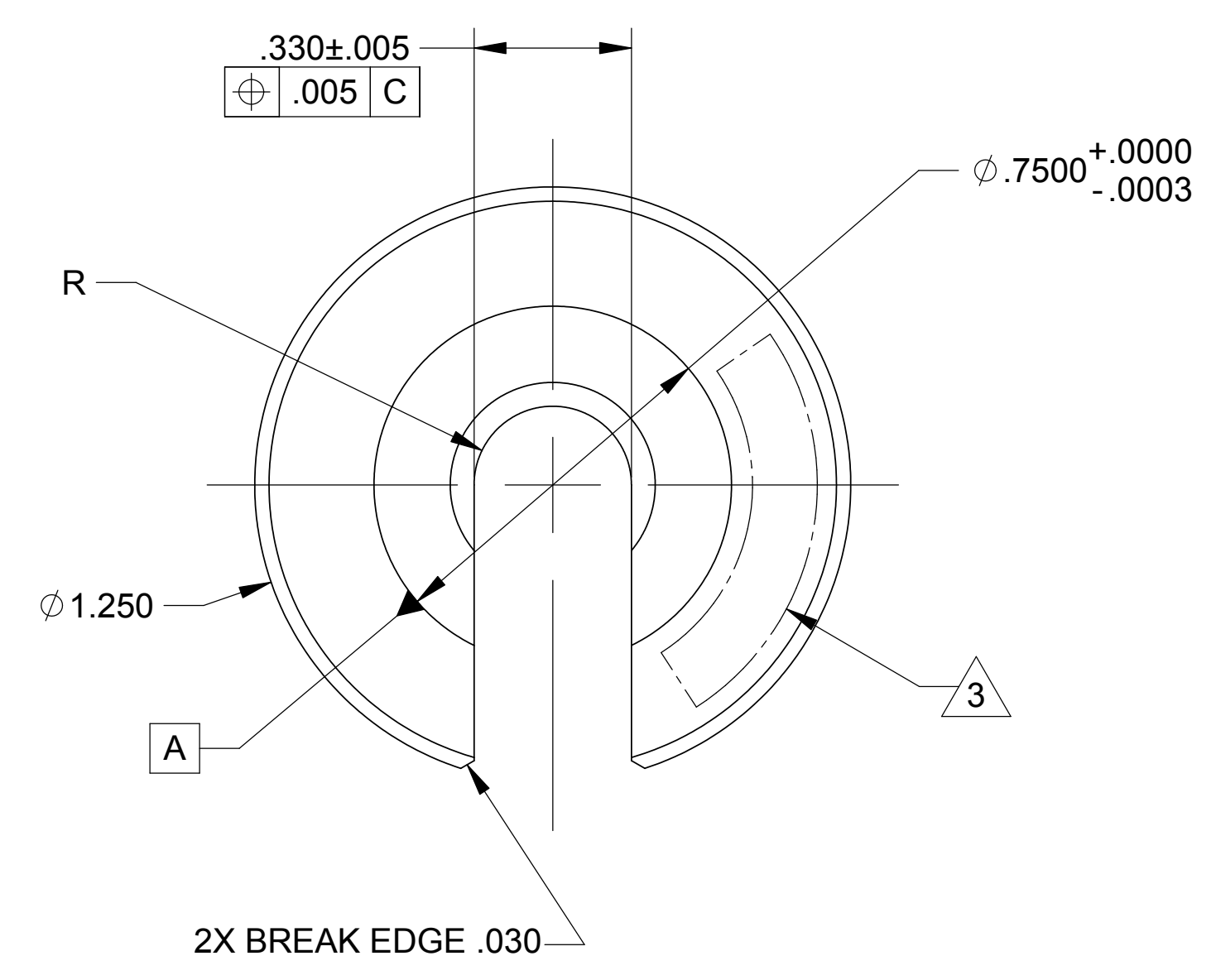

DASH NO.	H	A	APPLICATION
-1	0.663	0	STAGE 0-1, BLADE SIDE
-2	0.630	0	STAGE 0-1 & 1-2, BRKT SIDE
-3	0.850	0	STAGE 1-2, BLADE SIDE
-4	1.000	0	UNCUT
EXAMPLE	0.730	5.000	EXAMPLE

**-1 & -3 SHOWN  
-2 & -4 SEE SHEET 2**

NOTES: UNLESS OTHERWISE SPECIFIED.

- ALL PARTS SHALL BE MANUFACTURED IN ACCORDANCE WITH ASI SPECIFICATION 20008225 (LIGO E048225).
- REMOVE ALL BURRS AND SHARP EDGES .005-.015.
- MARK PART AND SERIAL NUMBER IN LOCATION APPROXIMATELY AS SHOWN USING 0.13-INCH HIGH CHARACTERS IN ACCORDANCE WITH 20006686, TYPE I, CLASSES 4, 5, OR 6. SERIAL NUMBERS START AT 001 FOR FIRST PART AND PROCEED CONSECUTIVELY. PARTS TOO SMALL TO MARK SHALL BE IDENTIFIED IN ACCORDANCE WITH 20006686, TYPE II.
- RECORD WEIGHT TO NEAREST 0.1 LB ON INSPECTION REPORT AFTER FINAL MACHINING. ESTIMATED WEIGHT IS 0.3 LBS FOR -1 & -3, 0.2 LBS FOR -2 & -4.
- TABLE SHOWS PARAMETRIC VALUES FOR NOMINAL AND UNCUT SHIMS. NOMINAL VALUES FOR DIMENSIONS H AND A SUBJECT TO CHANGE AFTER FIRST INSTALLATION AND PERFORMANCE EVALUATION.
- CORRECTIONS TO -1 AND -3 VERSIONS MAY FOLLOW AFTER FIRST INSTALLATION AND PERFORMANCE EVALUATION. CORRECTIONS MAY REQUIRE A CHANGE TO THE DIMENSION H AS WELL AS AN ANGULAR CORRECTION AS SHOWN. IN THIS CASE, DIMENSIONS A AND H ARE MEASURED AS SHOWN IN THE EXAMPLE.

20007881-4	SHIM, UNCUT
20007881-3	SHIM, STAGE 1-2, BLADE SIDE
20007881-2	SHIM, STAGE 0-1 & 1-2, BRKT SIDE
20007881-1	SHIM, STAGE 0-1, BLADE SIDE

QTY REQD	ITEM NO	REF DES	CAGE NO	PART OR IDENTIFYING NO	NOMENCLATURE OR DESCRIPTION	SPECIFICATION	MATERIAL OR NOTE	ZONE
PARTS LIST								
CONTRACT NO				UNLESS OTHERWISE SPECIFIED DIMENSIONS ARE IN INCHES TOLERANCES DECIMALS .XX ±.03 .XXX ±.010 ANGLES ± 1/2° MACHINE FINISH 63 DO NOT SCALE DRAWING INTERPRET DWG PER ASME Y14.5M-1994				
20007890				303 CRES FORGING PER AMS A 473				
NEXT ASSEMBLY				APPLICATION				
20007881-1				20007881-2				
20007881-3				20007881-4				
20007881-4				20007881-1				
20007881-1				20007881-2				
20007881-2				20007881-3				
20007881-3				20007881-4				
20007881-4				20007881-1				

**RELEASED**  
2/25/2005

ALLIANCE SPACESYSTEMS, INC.  
1250 Lincoln Ave., Suite 100  
Pasadena, CA 91103

**STAGES 0-1 & 1-2  
FLEXURE ROD SHIM  
LIGO D7881**

SIZE <b>D</b>	CAGE CODE 1KNU9	<b>20007881</b>	REV <b>A</b>
SCALE 3:1		UNCLASSIFIED	SHEET 1 OF 2

THIS DOCUMENT MAY CONTAIN ITAR CONTROLLED INFORMATION AND/OR COMMERCE CONTROLLED INFORMATION EXPORT RESTRICTIONS MAY APPLY

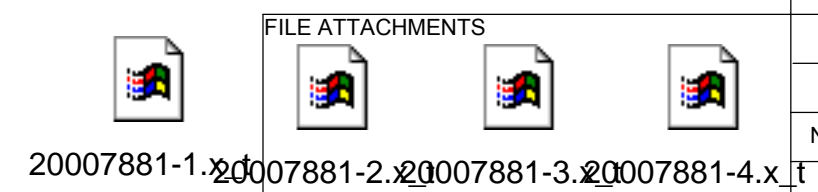

RELEASED  
2/25/2005

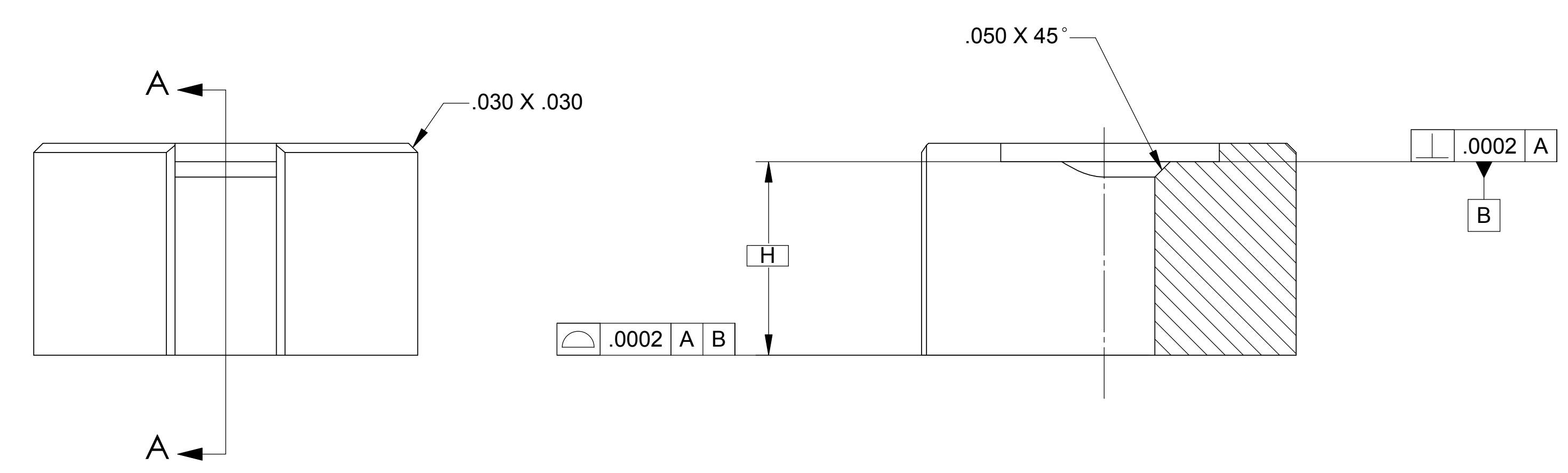
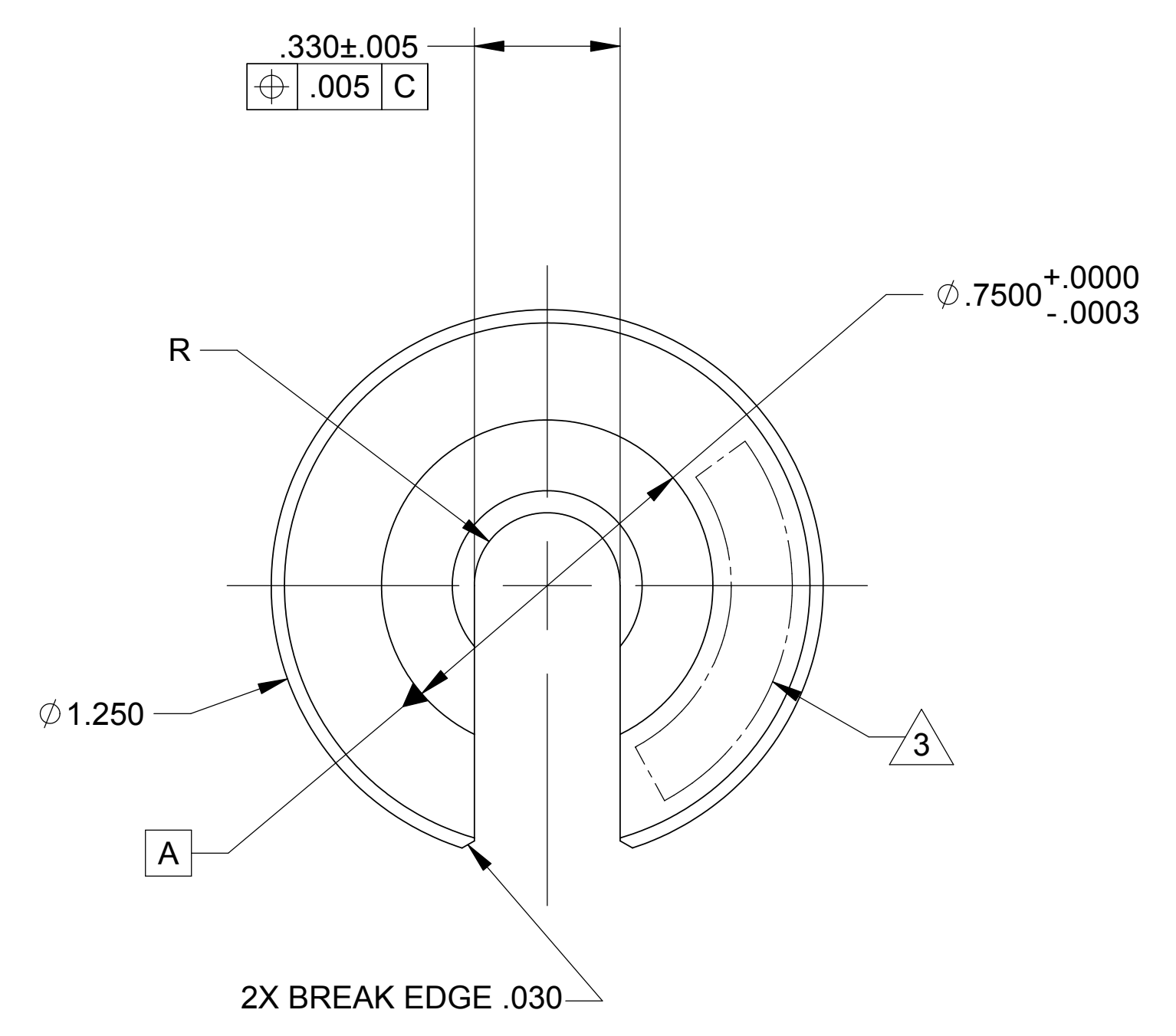

**-2 & -4 SHOWN  
-1 & -3 SEE SHEET 1**

NOTES: SEE SHEET ONE.

THIS DOCUMENT MAY CONTAIN ITAR CONTROLLED INFORMATION  
AND/OR COMMERCE CONTROLLED INFORMATION  
EXPORT RESTRICTIONS MAY APPLY

		ALLIANCE SPACESYSTEMS, INC. 1250 Lincoln Ave., Suite 100 Pasadena, CA 91103	
SIZE <b>D</b>	CAGE CODE 1KNU9	<b>20007881</b>	REV <b>A</b>
SCALE 3:1	UNCLASSIFIED	SHEET 2 OF 2	

REV 3/03