

NOTES: (UNLESS OTHERWISE SPECIFIED)

REV.	DATE	CON #	DRAWING TREE #
A	9-8-05	E05022-00	

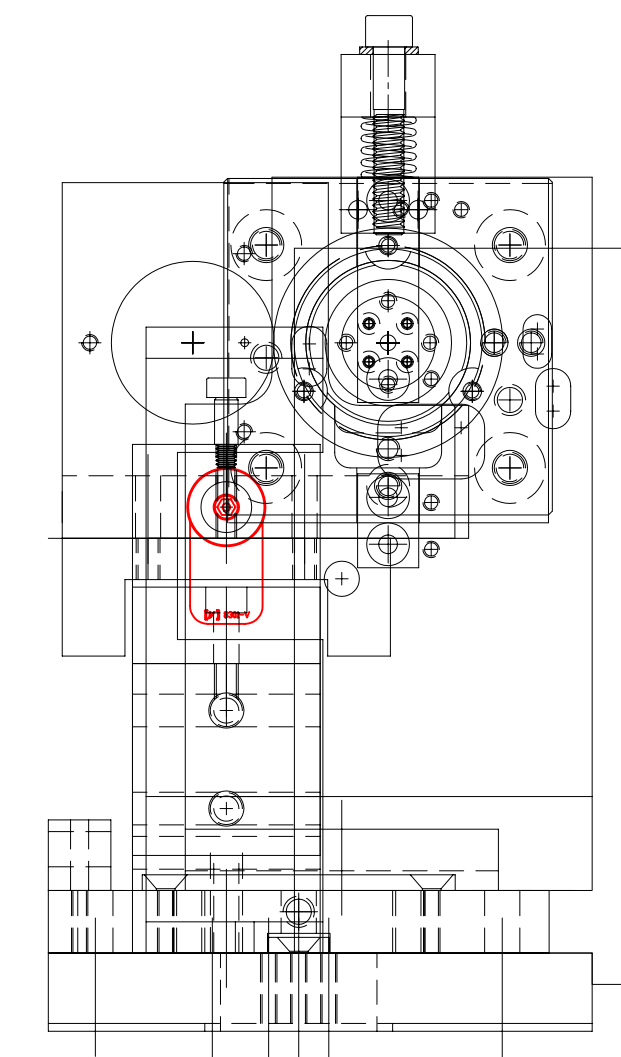
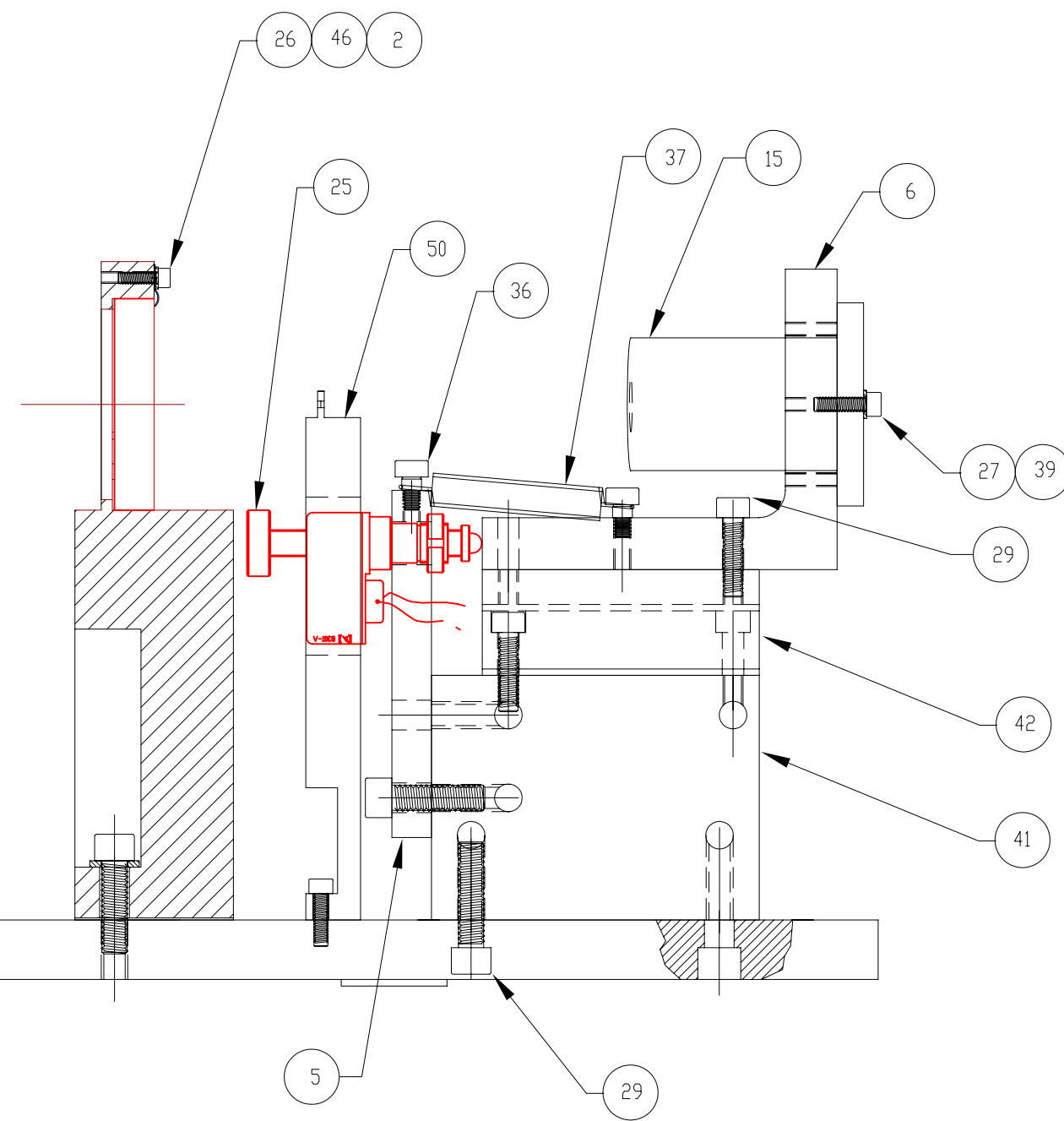
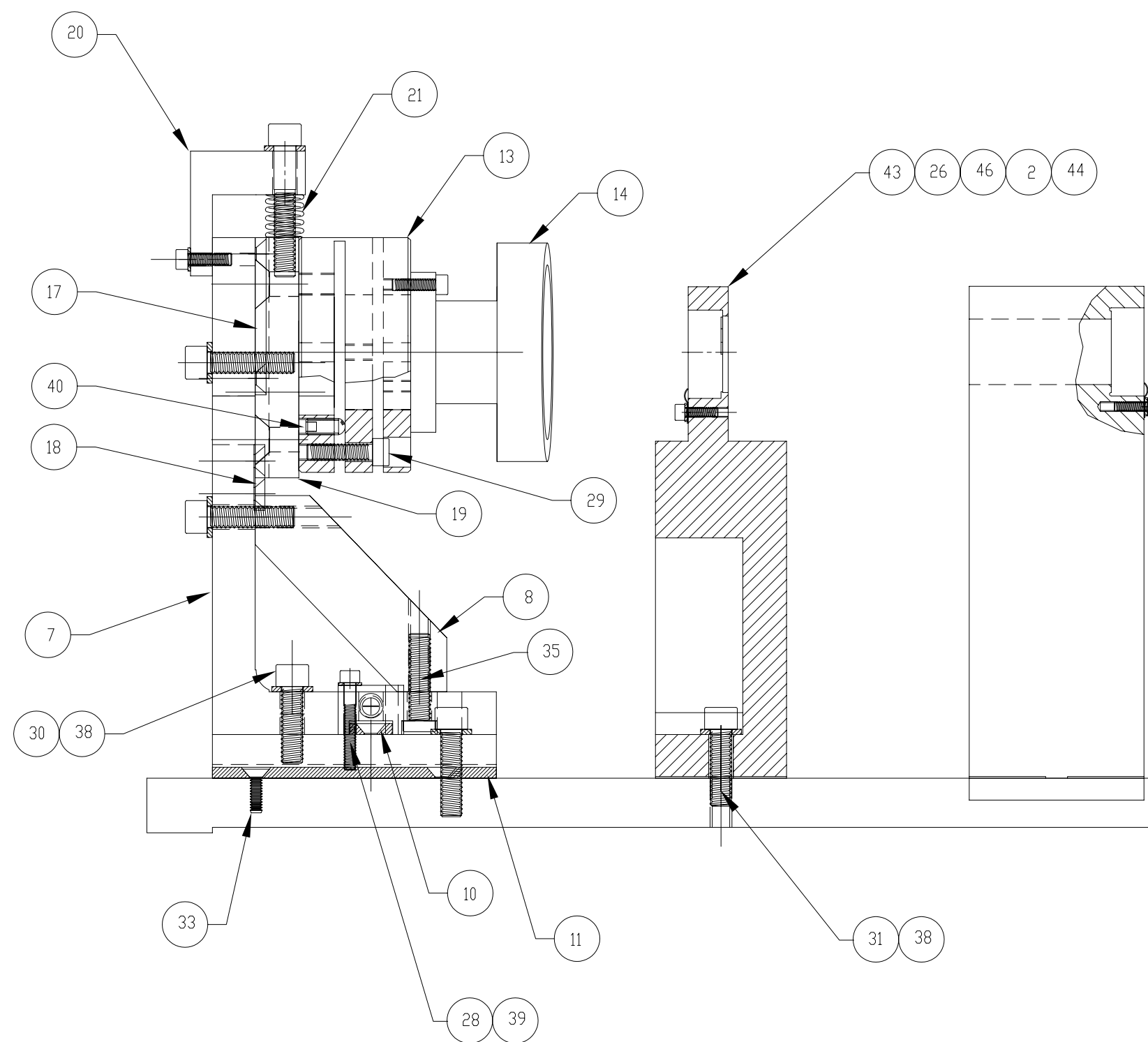
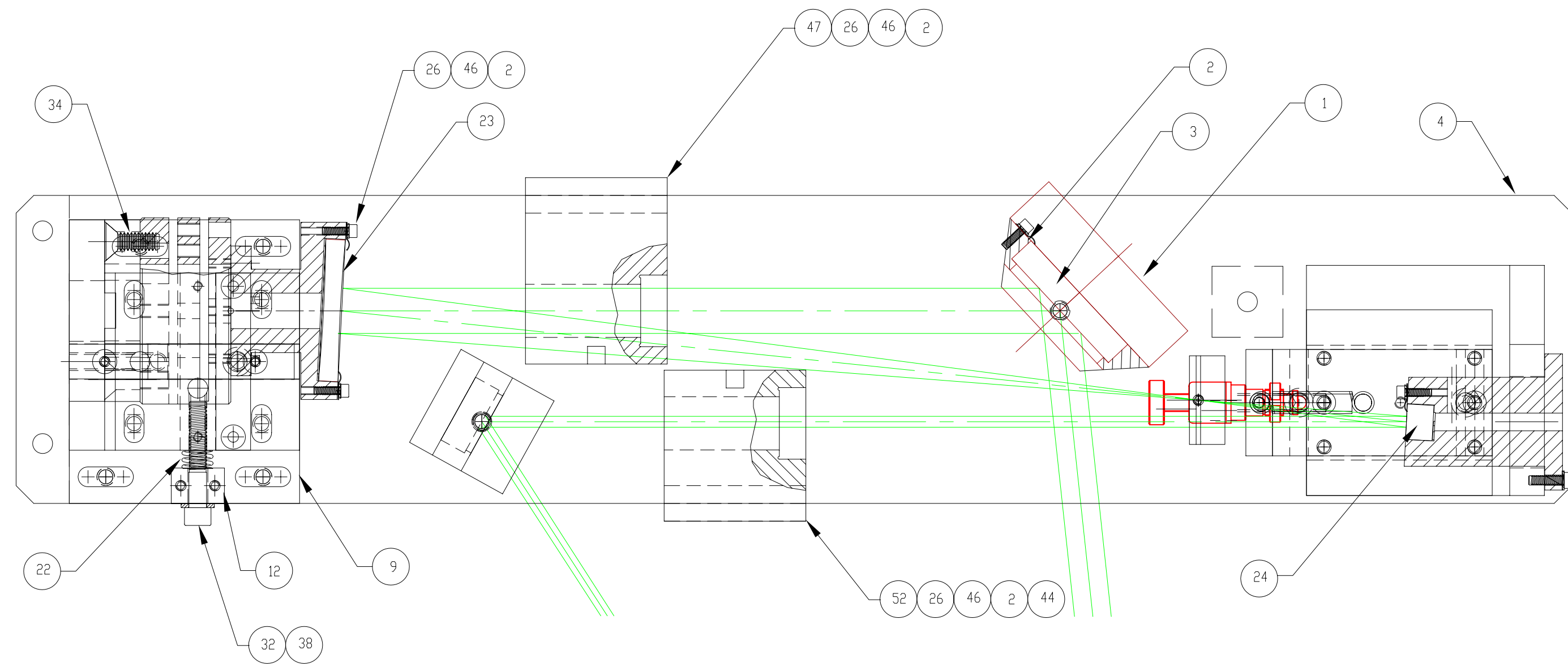

ITEM NO.	QTY	PART NUMBER	DESCRIPTION	SUPPLIER
52	1	3050315	Secondary alignment mirror mount	LLD
51	1	3050317	Pinhole alignment fixture	LLD
47	1	3050316	Primary alignment mirror mount	LLD
46	12	98019A309	24 Flat washer 0.13 ID x 0.25 OD SS	Mc Master-Carr
44	3	Y1-1037-45-P	High energy Nd:YAG laser mirror	CVI Laser
43	1	3050313	Secondary steering mirror mount	LLD
42	1	S3-1SS-3P	Precision ball slide, in travel	Isotech
41	1	3020590	Support ball slide	ASCD
40	2	3020592	Flexure adjusting screw	ASCD
39	3	98019A314	#6 Flat washer 0.312 ID x 0.627 thk	Mc Master-Carr
38	13	98017A660	0.25 Flat washer 0.50 OD x 0.053 thk	Mc Master-Carr
37	1	9654K912	Extension spring 1/32 OD x 1 1/2 long	Mc Master-Carr
36	2	94035A201	8-32 x 0.125 shoulder screw	Mc Master-Carr
35	1	93619A420	0.25-26 x 1.0 SHCS	Mc Master-Carr
34	4	92210A540	0.25-20 x 0.75 FHCS	Mc Master-Carr
33	8	92210A148	4-32 x 0.5 FHCS	Mc Master-Carr
32	2	92196A546	0.25-20 x 1.50 SHCS	Mc Master-Carr
31	1	92196A542	0.25-20 x 1.0 SHCS	Mc Master-Carr
30	6	92196A541	0.25-20 x 0.875 SHCS	Mc Master-Carr
29	8	92196A272	10-32 x 0.75 SHCS	Mc Master-Carr
28	4	92196A153	6-32 x 1.0 SHCS	Mc Master-Carr
27	9	92196A148	6-32 x 0.5 SHCS	Mc Master-Carr
26	18	92196A108	4-40 x 0.375 SHCS	Mc Master-Carr
25	1	8302-V	Picometer, 10 in travel, VAC	New Focus
24	1	Y1-0537-0 UNF-0.1500	Mode matching telescope secondary mirror	CVI Laser
23	1	3100-5638-6104-0-116	Mode matching telescope primary mirror	CVI Laser
22	1	3020214	Mirror alignment spring 0.25	LLD
21	2	3020213	Mirror alignment spring 0.45	LLD
20	1	3020520	Bushin block vertical	ASCD
19	1	3020539	Slide base vertical	ASCD
18	1	3020538	Slide guide vertical lower	ASCD
17	1	3020537	Slide guide vertical upper	ASCD
16	1	3050312	Secondary mirror holder	ASCD
15	1	3050310	Primary mirror holder	ASCD
14	1	3020516	Flexure	ASCD
13	1	3020515	Bushin block	ASCD
12	2	3020514	Slide guide axial	ASCD
11	1	3020513	Slide guide transverse	ASCD
10	1	3020512	Slide base axial	ASCD
9	1	3020511	Stiffener gusset	ASCD
8	1	3020510	Secondary mirror platform	ASCD
7	1	3020509	Primary mirror platform	ASCD
6	1	3020508	Bico motor mount plate	ASCD
5	1	3020506	Base plate	ASCD
4	1	Y1-2037-45-P	High energy Nd:YAG laser mirror	CVI Laser
3	12	3020439	Mirror clip, vacuum mirror mount G3 req'd	ASCD
2	1	3050314	Primary steering mirror	LLD

ITEM		TOTL	PARTS LIST	
NO.	QUANTITY		DATE	NAME
UNLESS OTHERWISE SPECIFIED				
DIMENSIONS ARE IN INCHES				
TOLERANCES:				
XX	±		DATE	NAME
XXX	±			
ANGULAR	±			
FINISH				
COMMENTS				
SCALE: D				
DWG. NO. D050308-00-D				
REV. A				
SHEET 1 OF 1				