

		REVISIONS																			
LTR	ZONE	DESCRIPTION									DWN	CHK	P-ENG	CONFIG	ME	STRS	MATL	PROJ	QA	RELEASE DATE	
A		INITIAL RELEASE																			
B		ADDED MISSING C'BORE DIMENSION																			

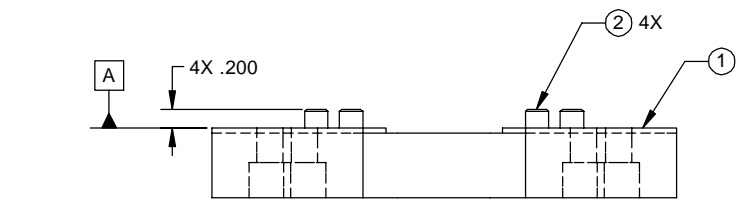
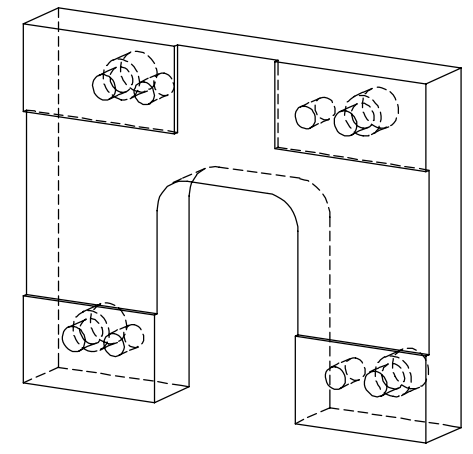
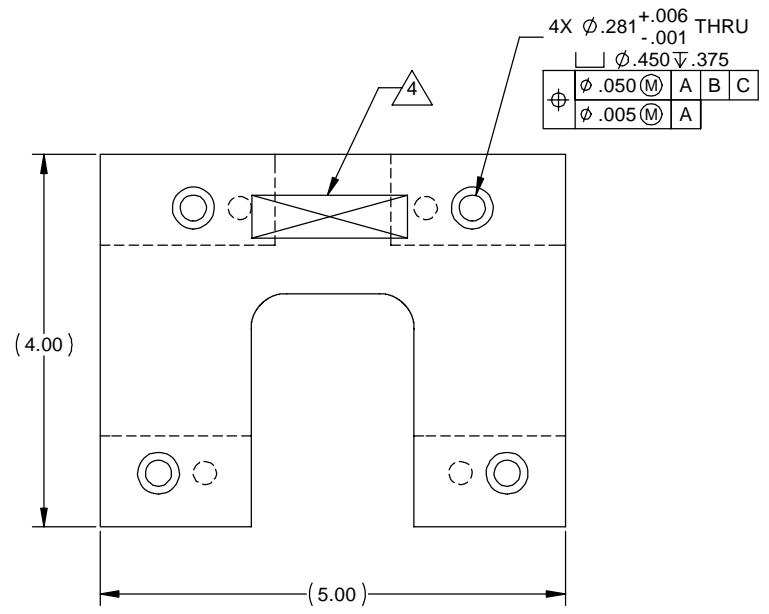
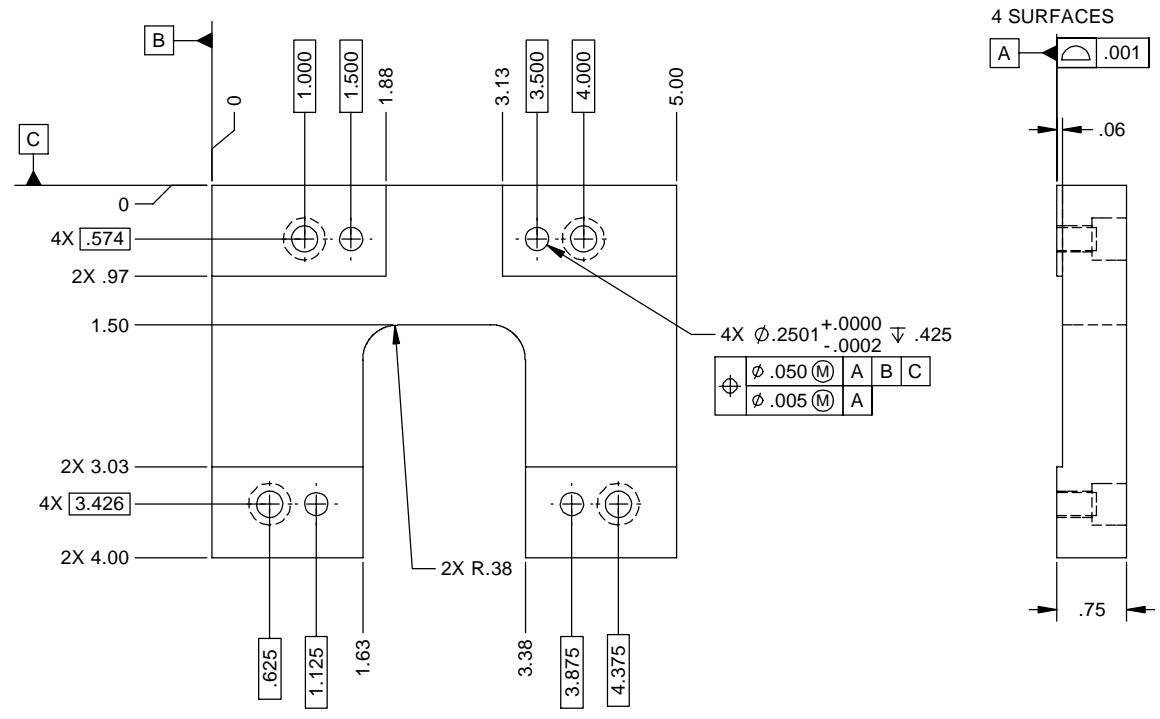

NOTES: UNLESS OTHERWISE SPECIFIED.

- ALL PARTS SHALL BE MANUFACTURED IN ACCORDANCE WITH ASI SPECIFICATION 20008225 (LIGO E048225).
- REMOVE ALL BURRS AND SHARP EDGES .005-.015.
- MACHINE FILLET RADII .003-.015.
- MARK PART AND SERIAL NUMBER IN LOCATION APPROXIMATELY AS SHOWN USING 0.13-INCH HIGH CHARACTERS IN ACCORDANCE WITH 20006686, TYPE I, CLASSES 4, 5, OR 6. SERIAL NUMBERS START AT 001 FOR FIRST PART AND PROCEED CONSECUTIVELY. PARTS TOO SMALL TO MARK SHALL BE IDENTIFIED IN ACCORDANCE WITH 20006686, TYPE II.
- COUNTERSINK 82° ALL DRILLED HOLES .015-.030 DEEP BOTH SIDES.

4	2			McMASTER CARR P/N 98380A539	PIN $\phi .250 \times .625$ L			CRES	
1	1			2000XXXX-1	STAGE 1-2 VERT ACTUATOR SETUP TOOLING, BASEPLATE				
-1									
QTY REQD	ITEM NO	REF DES	CAGE NO	PART OR IDENTIFYING NO	NOMENCLATURE OR DESCRIPTION	SPECIFICATION	MATERIAL OR NOTE	ZONE	

CONTRACT NO		UNLESS OTHERWISE SPECIFIED DIMENSIONS ARE IN INCHES TOLERANCES DECIMALS .XX ±.03 .XXX ±.010 ANGLES ±1/2° MACHINE FINISH 63		THIS DRAWING IS PRELIMINARY AND NOT UNDER CONFIGURATION CONTROL UNLESS A RED RELEASED STAMP APPEARS HERE.		ALLIANCE SPACESYSTEMS, INC. 1250 Lincoln Ave., Suite 100 Pasadena, CA 91103	
NEXT ASSEMBLY		MATERIAL AL 6061-T651 AMS-QQ-A-250/11		DWN J. LARAMEE 10/07/04 PROJ ENGR STRS		STAGE 1-2 VERT ACTUATOR SETUP TOOLING, BASEPLATE LIGO D04XXXX-A	
PROJECT CODE		1388		CHK MATL		SIZE D CAGE CODE 1KNU9 D050352-00-D REV 0	
APPLICATION				CONFIG PROJ		SCALE 1:1 SHEET 1 OF 1	

THIS DOCUMENT MAY CONTAIN ITAR CONTROLLED INFORMATION AND/OR COMMERCE CONTROLLED INFORMATION EXPORT RESTRICTIONS MAY APPLY