

5

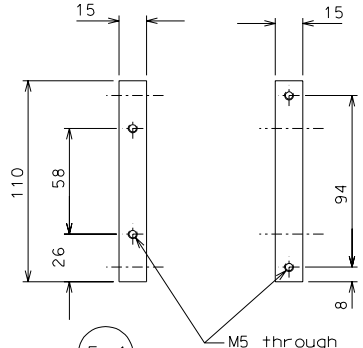

5.1

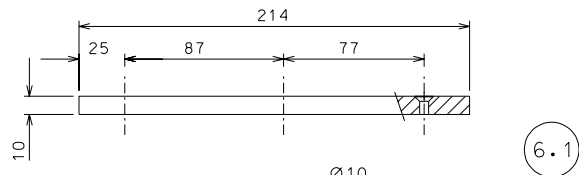

6.1

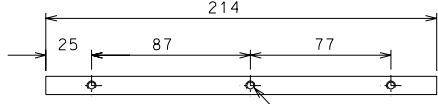

6.2

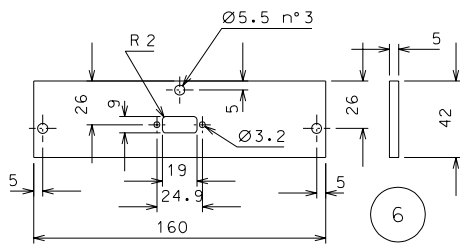
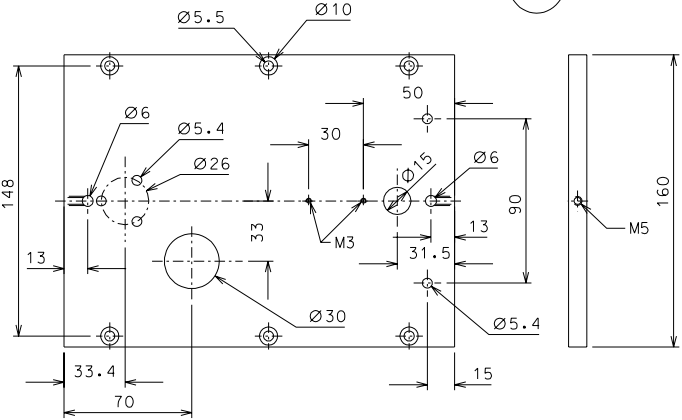
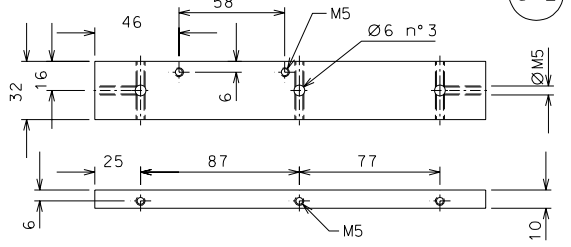

6

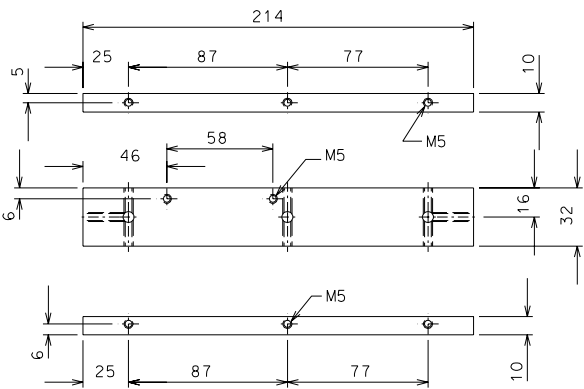

6.3

modified dimension parts 6-6.2-6.3	08-09-06	
modified holes part 5	06-09-06	
added holes for connection	19-06-06	
replaced the holes on the base	30-03-06	

ref.	note	date	time
modifiche			
6.2	4 EN 6082 1/2		
6.1	4 EN 6082 1/2		
6	8 EN 6082 1/2		
5.1	8 AISI 304 1/2		
5	4 AISI 304 1/2	6.3	4 EN 6082 1/2
ref.	pieces	mat. and treatments	scale

General machining tolerances UNI 5307-63								
Dimensions	< 6	6-30	30-120	120-315	315-1000	>1000-2000	>2000-4000	>4000
Linear Toli.	± 0.1	± 0.2	± 0.3	± 0.5	± 0.8	± 1.2	± 2	± 3
angular Toli.	± 1'	± 30'	± 20'	± 10' referred to the shortest side				

designed for	R.De Salvo
draw. by	G. Gennaro-PROME
date	04-09-06
scale	1/2
title	HAM-OPTICAL BENCH
DETAILS LVDT ACTUATOR	LIGO-D051130-04-D
detail from	105
	A 2