

227

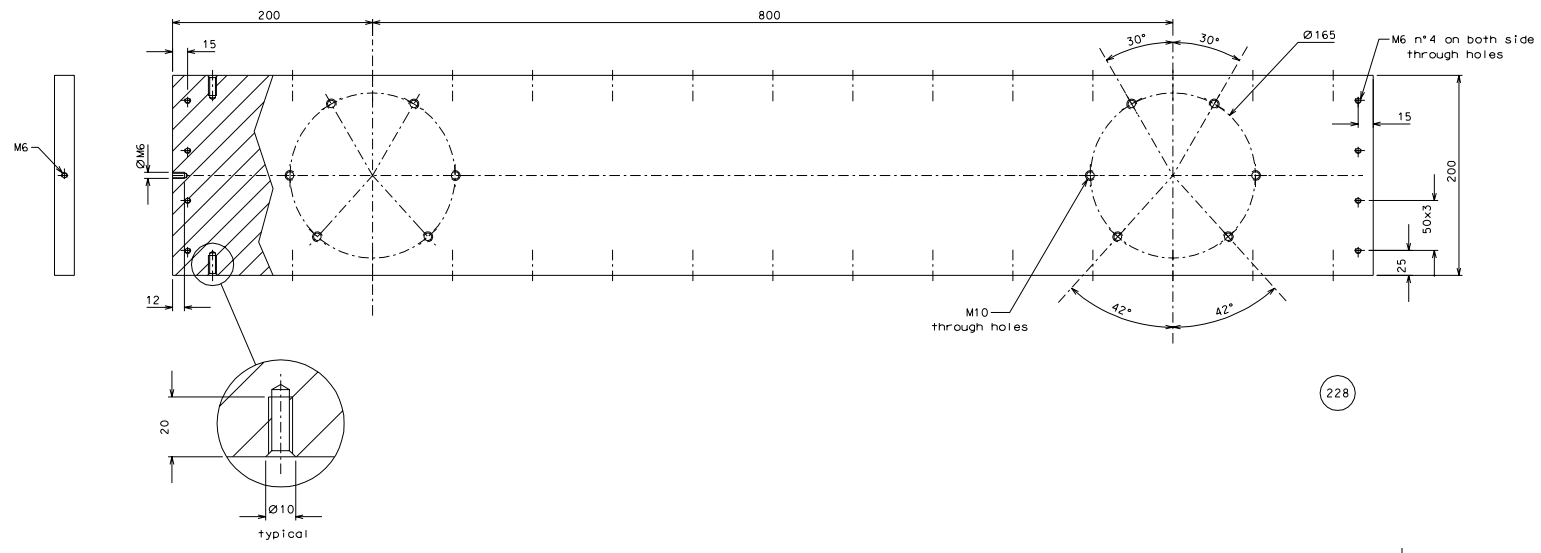
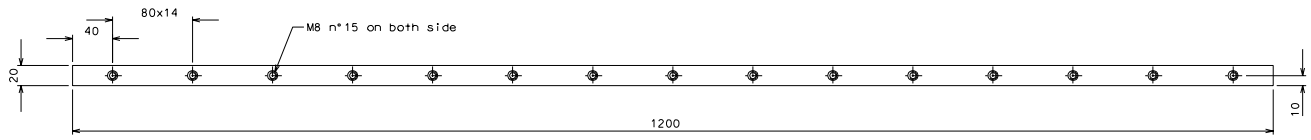

228

ref.	name	date	signature
modifications			
228	1	EN 6082	1/2.5
227	1	EN 6082	1/2.5
ref.	drawn	date and treatments	scale
ref.	checked	date and treatments	scale

General machining tolerances UNI 5301-85			
dimension	< 4	4-30	> 30-100
linear tol.	± 0.1	± 0.2	± 0.3
angular tol.	± 1'	± 30'	± 20'

designed by	R. De Salvo
drawn by	G. Gemmaro-PROMECH
date	29-04-06
scale	1/2.5
title	HAM-OPTICAL BENCH
IP TEST	LIGO-D051214-00-D
sheet	212
of	A 1