

REV.	DATE	DCN #	DRAWING TREE #
A	1-18-06	LIGO-E060004-00	

NOTES: (UNLESS OTHERWISE SPECIFIED)

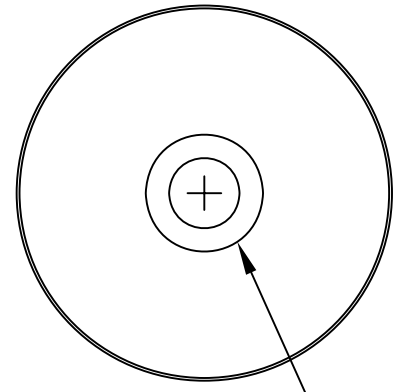

C'BORE .625+/- .015 DIA  
X .250+/- .010 DEEP

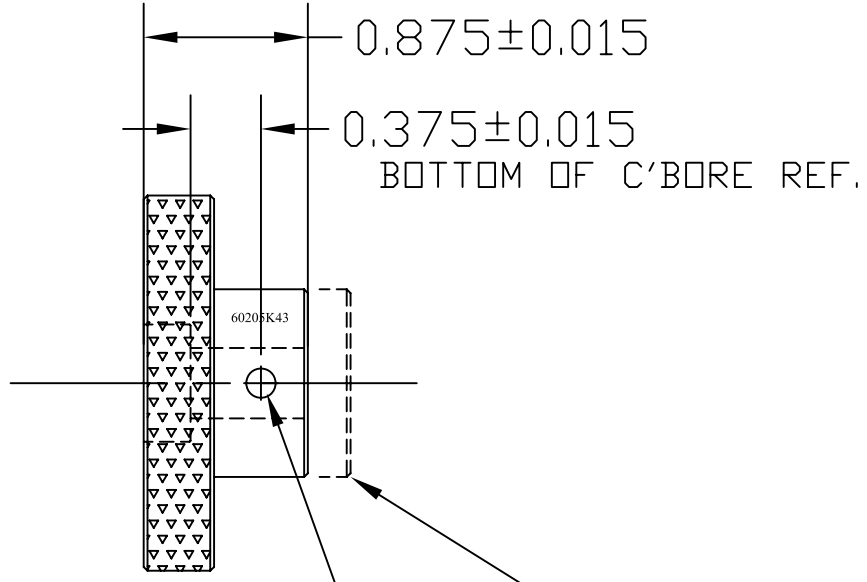

MAKE 1

DRILL AND REAM LPF FOR  
.156 DIA ROLL PIN THRU  
BOTH WALLS INLINE

see assembly for  
adjacent part short  
screw shaft

ITEM NO.	REQ.	SPARE	TOT.	PART NUMBER	DESCRIPTION	SUPPLIER	
PARTS LIST							
UNLESS OTHERWISE SPECIFIED:				DATE	NAME	CALIFORNIA INSTITUTE OF TECHNOLOGY MASSACHUSETTS INSTITUTE OF TECHNOLOGY	
DIMENSIONS ARE IN INCHES				DRAWN	2/11/06		KENM
TOLERANCES:				CHECKED			
.XX±:							
.XXX±:							
ANGULAR±:							
MATERIAL				COMMENTS:		SYSTEM LASTI SUB-SYSTEM QUAD SUSPENSION NEXT ASSY D060145-A PART NAME ROTATION KNOB MODIFICATION	
MCMaster #60205K43 303 stainless w/.37 hole thru						SIZE DWG. NO. D060010-A REV	
FINISH N/A						SCALE: SHEET 1 OF 1	