

NOTES: (UNLESS OTHERWISE SPECIFIED)
 1. BREAK ALL SHARP EDGES .2/.5 X 45°
 2. ALL DIMENSIONS IN MILLIMETER

HC= HOLE CENTER

FILET 4x R 0.50 mm

4X, 1-72 UNC-2B, THRU ALL
 STARTING FROM 45deg SURFACE

2X 1-72 UNC-2B
 THRU ALL

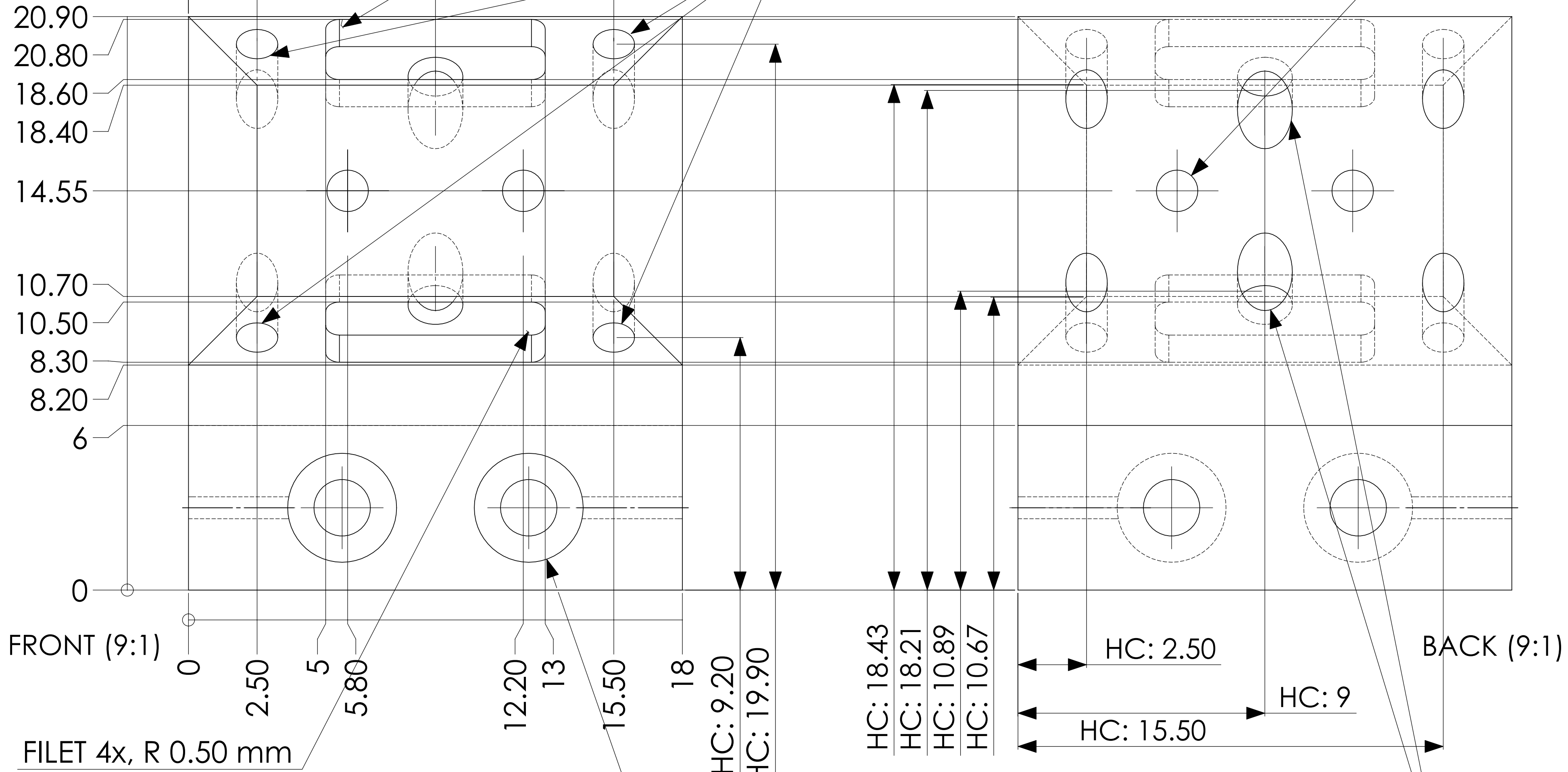

FRONT (9:1)

BACK (9:1)

FILET 4x, R 0.50 mm

2x, φ 2.00 mm
 STARTING FROM 45deg SURFACE

2x, φ 2.06 mm THRU
 □ φ 3.97 mm, ▽ 1.55 mm
 (CBORE #1 SOCKET HEAD CAP SCREW)

UNLESS OTHERWISE SPECIFIED:		NAME	DATE	Massachusetts Institute of Technology LIGO project
DIMENSIONS ARE IN mm TOLERANCES ARE: ± 0.05mm ANGULAR: ± .25°		DRAWN Edith Innerhofer	02/2006	
MATERIAL Aluminum		MODIFIED Edith Innerhofer	06/2006	TITLE: RPI, OSEM-side-base
FINISH 32/		COMMENTS:		SIZE C
DO NOT SCALE DRAWING				DWG. NO. LIGO-D060027-03-R
				REV 03
				SCALE: 9:1 WEIGHT: SHEET 1 OF 3

NOTES: (UNLESS OTHERWISE SPECIFIED)
 1. BREAK ALL SHARP EDGES .2/.5 X 45°
 2. ALL DIMENSIONS IN MILLIMETER

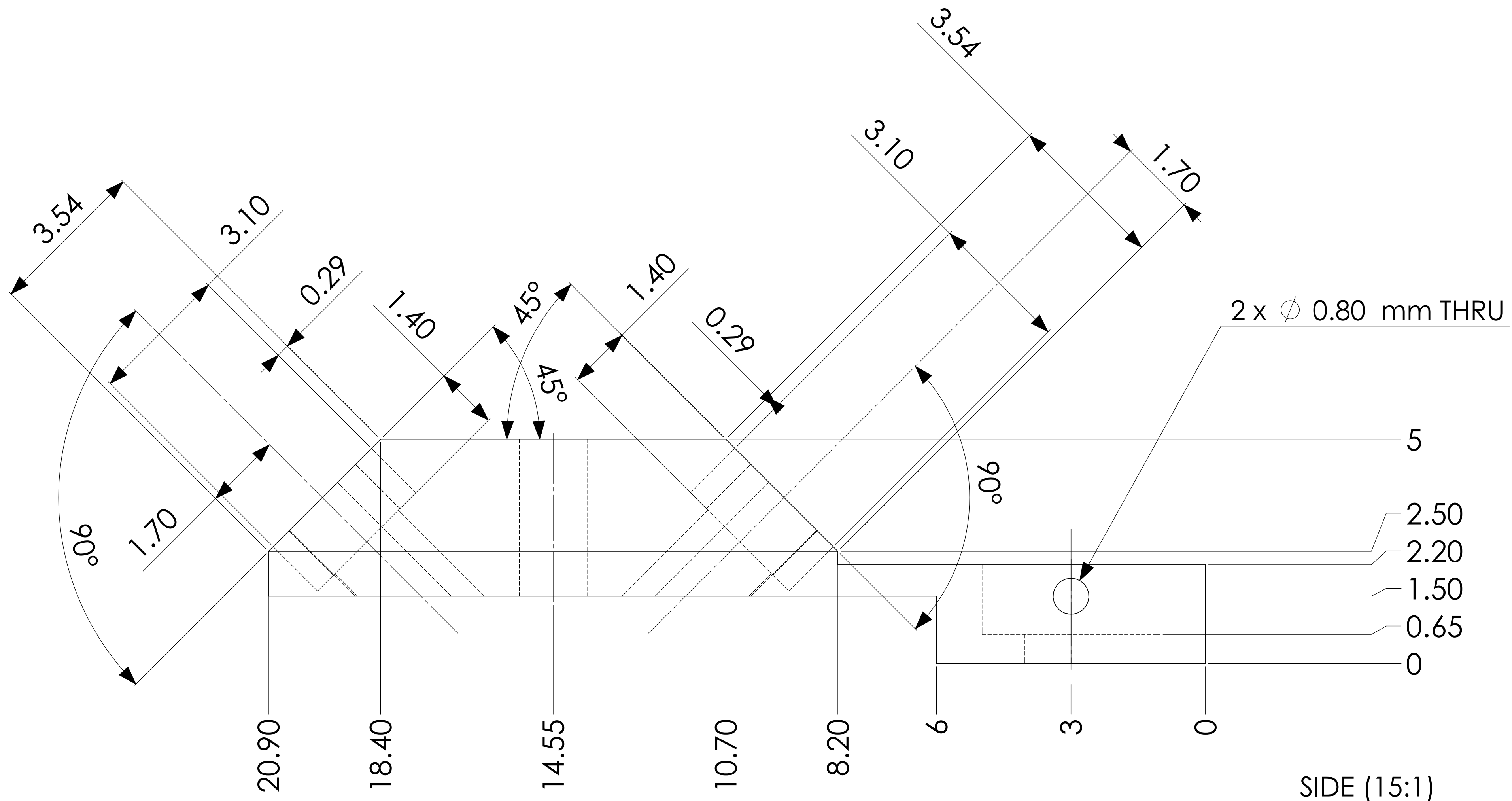

SIDE (15:1)

UNLESS OTHERWISE SPECIFIED:		NAME	DATE	Massachusetts Institute of Technology LIGO project	
DIMENSIONS ARE IN mm		DRAWN	Edith Innerhofer	02/2006	TITLE: RPI, OSEM-side-base
TOLERANCES ARE: ± 0.05mm		MODIFIED	Edith Innerhofer	06/2006	
ANGULAR: ± .25°		COMMENTS:		SIZE	DWG. NO.
MATERIAL Aluminum				C	LIGO-D060027-03-R
FINISH $\sqrt{32}$				SCALE: 9:1	WEIGHT:
DO NOT SCALE DRAWING				SHEET 2 OF 3	

NOTES: (UNLESS OTHERWISE SPECIFIED)
 1. BREAK ALL SHARP EDGES .2/.5 X 45°
 2. ALL DIMENSIONS IN MILLIMETER

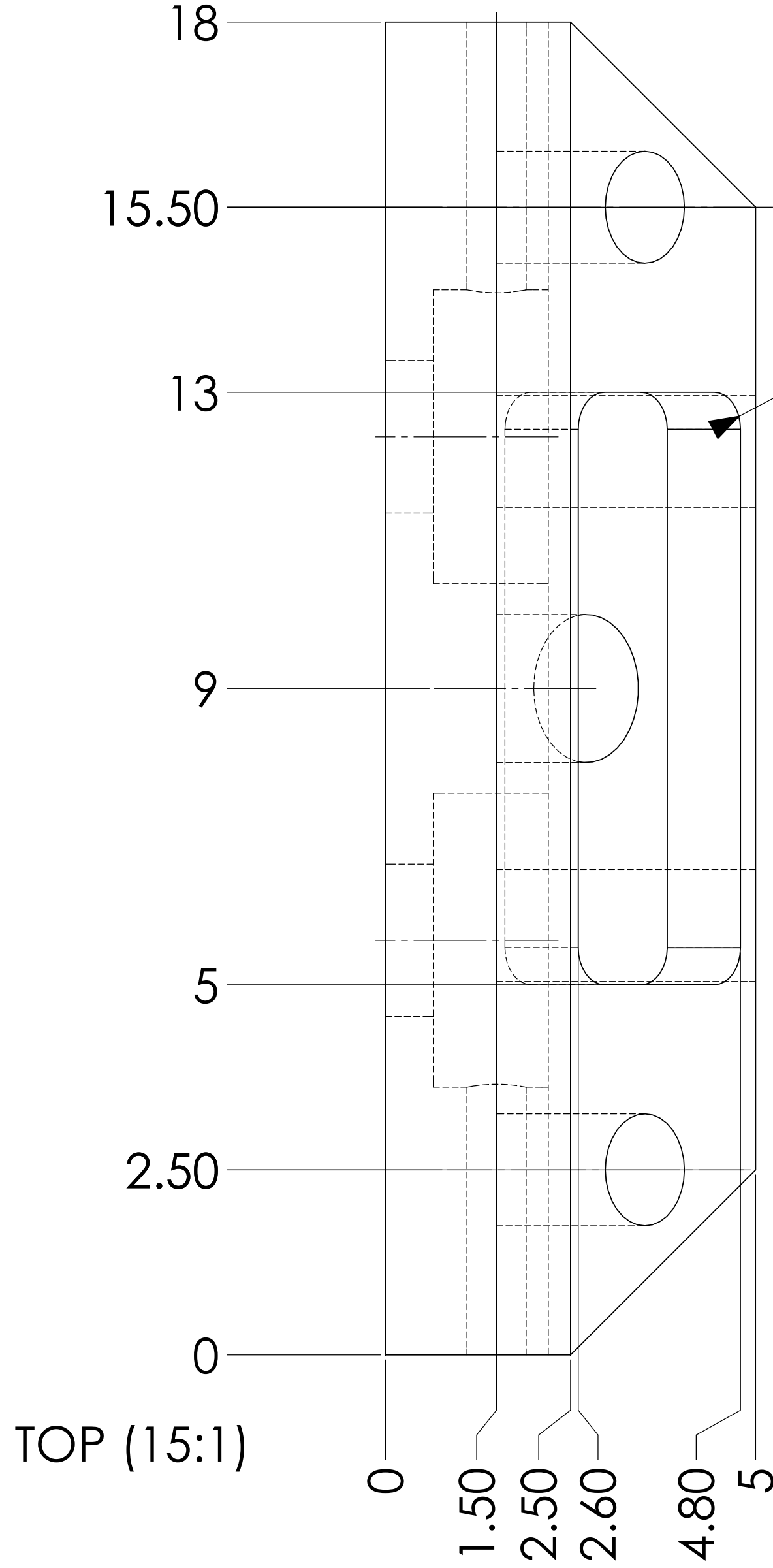

FILET
 4x, R 0.50 mm
 4x, lower extrude

TAP DRILLS AND HOLES
 STARTING FROM
 45 DEG SURFACE

45deg surface

45 deg surface

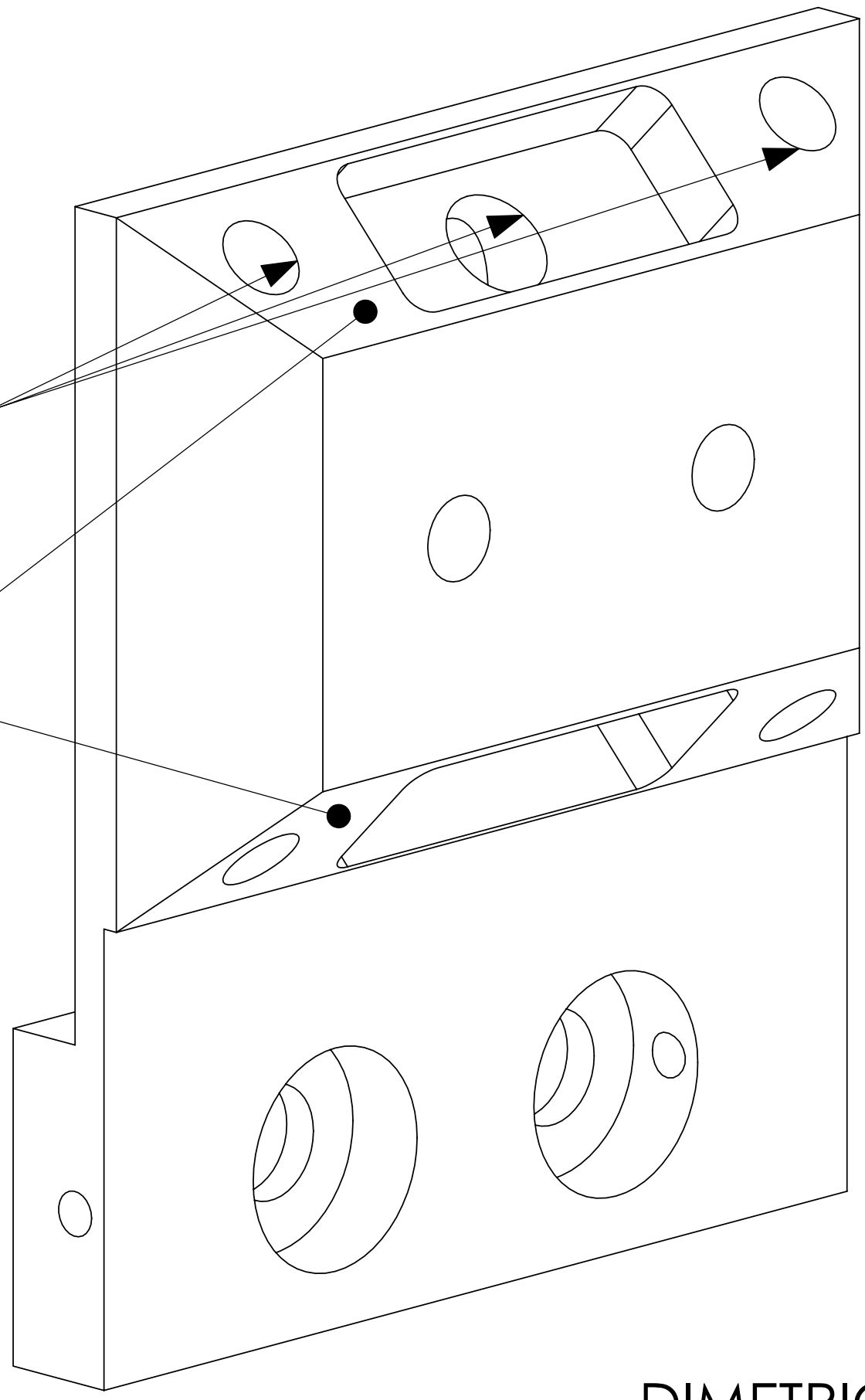

DIMETRIC (10:1)

UNLESS OTHERWISE SPECIFIED:		NAME	DATE	Massachusetts Institute of Technology LIGO project	
DIMENSIONS ARE IN mm TOLERANCES ARE: ± 0.05mm ANGULAR: ± .25°		DRAWN	Edith Innerhofer	02/2006	TITLE: RPI, OSEM-side-base
		MODIFIED	Edith Innerhofer	06/2006	
MATERIAL Aluminum		COMMENTS:			SIZE
FINISH 32/					DWG. NO. LIGO-D060027-03-R
DO NOT SCALE DRAWING					REV 03
		SCALE: 15:1		WEIGHT: 1	SHEET 3 OF 3