

REV.	DATE	DCN #	DRAWING TREE #
A	30-OCT-06	E060260-00	.

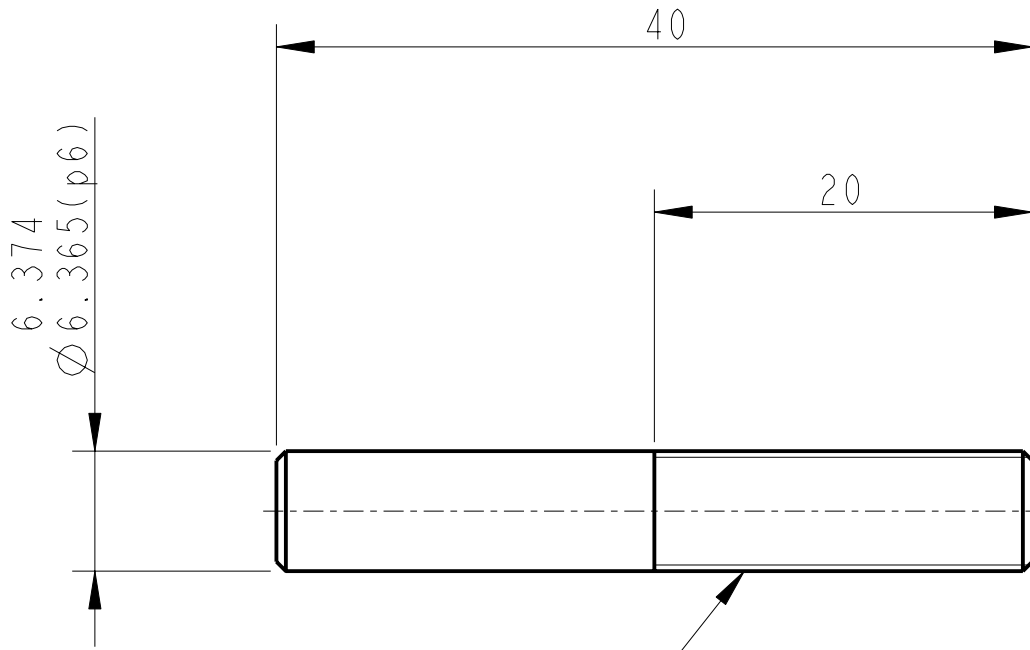

1/4-20 UNC THREAD

1-VENT HOLE
 ϕ 2 THRU'

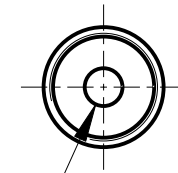

NOTES: (UNLESS OTHERWISE SPECIFIED)			CALIFORNIA INSTITUTE OF TECHNOLOGY MASSACHUSETTS INSTITUTE OF TECHNOLOGY IGR, GLASGOW UNIVERSITY GEO 600 GROUP RUTHERFORD APPLETON LABORATORIES	
1. REMOVE ALL SHARP EDGES, R.02 MIN. 2. DO NOT SCALE FROM DRAWING. 3. ALL MACHINING FLUIDS SHALL BE WATER SOLUBLE AND FREE OF SULFUR, CHLORINE AND SILICONE, SUCH AS CINCINNATI MILACRON'S CIMTECH 410 (STAINLESS STEEL) 4. SCRIBE, ENGRAVE OR STAMP DRAWING PARTNUMBER ON NOTED SURFACE OF PART AND A THREE DIGIT SERIAL NUMBER. SERIAL NUMBERS START AT 001 FOR THE FIRST PART AND PROCEED CONSECUTIVELY. USE .07" HIGH CHARACTERS. EXAMPLE: D020188- 001. A VIBRATORY TOOL MAY BE USED.	DIMENSIONS ARE IN mm [INCHES] TOLERANCES:			
	X.XX ±0.2 mm ANGULAR ±0.25 °		SYSTEM ADVANCED LIGO	
	MATERIAL: ST. STEEL 303/304/316		SUB-SYSTEM SUS	
	FINISH: CLEAN $\sqrt{\mu m}$ [μin] Ra = 1.6		NEXT ASSY QUAD N-PTYPE LOWER STRUC	
	NAME	DATE	PART NAME STUD (ADJUSTABLE PAD ASSYS)	
DRAWN	NJS/FEL	02/AUG/06	SIZE A	DRG. NO. D060485
CHECKED	J'OD	--/--/--	SCALE 5:2	PROJECTION:
APPROVED	IW	--/--/--	SHEET 1 OF 1	