

REV.	DATE	DCN #	DRAWING TREE #
	6/30/08	E080353-00-E	

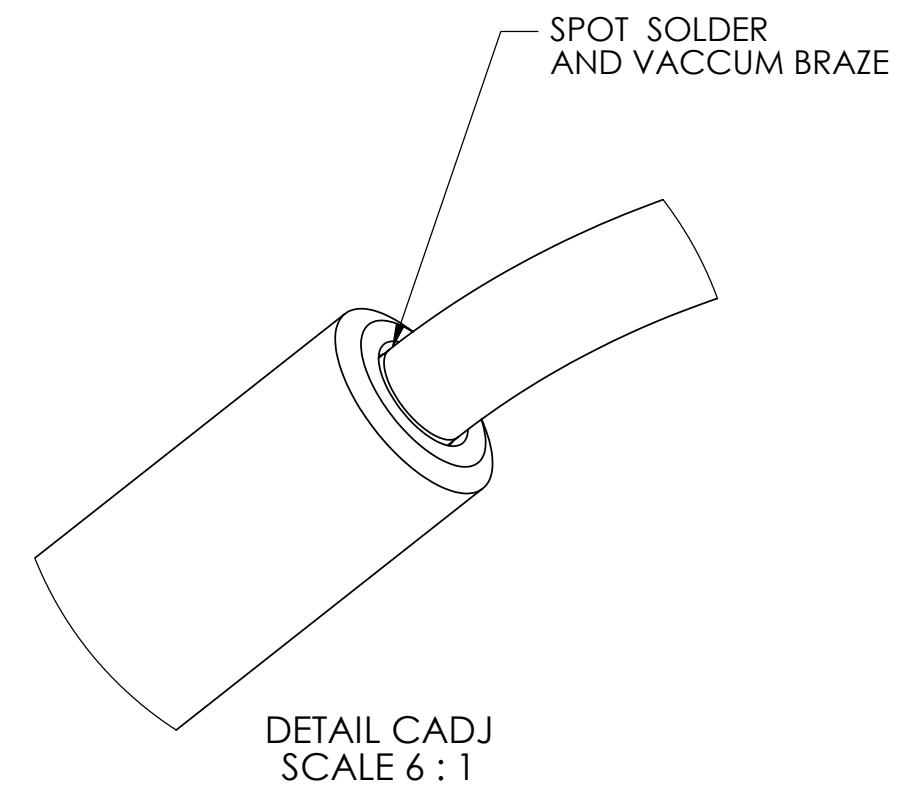
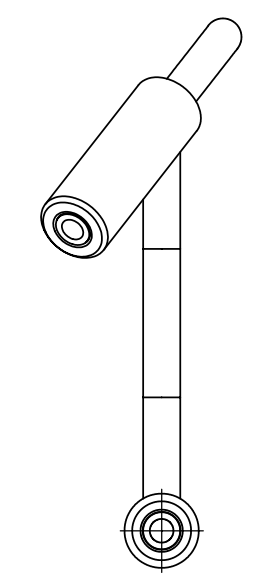
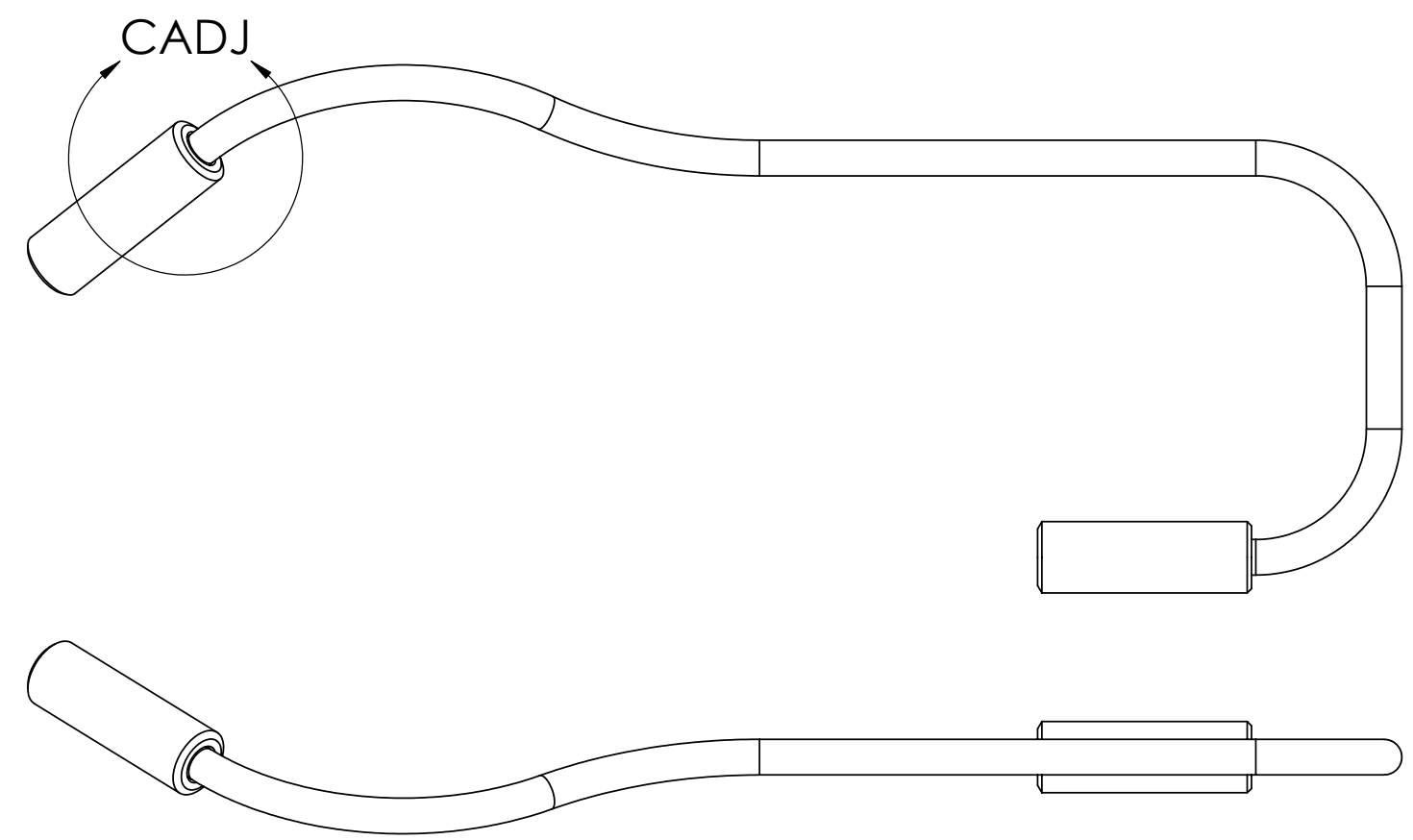
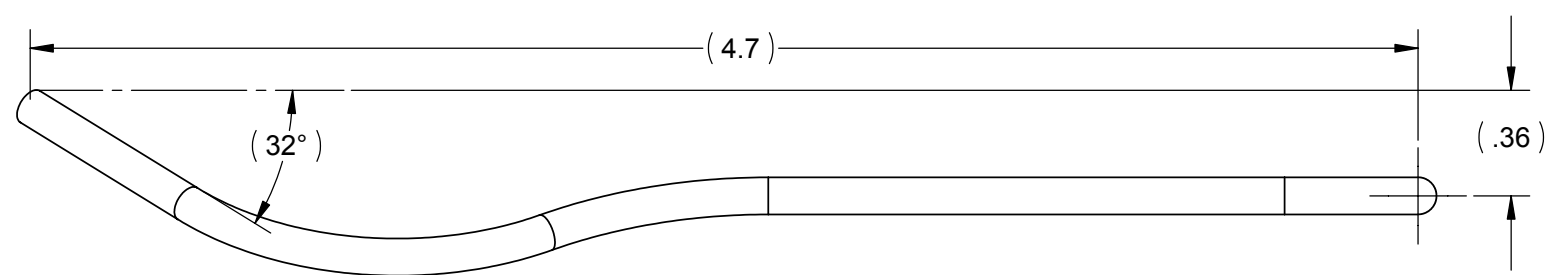
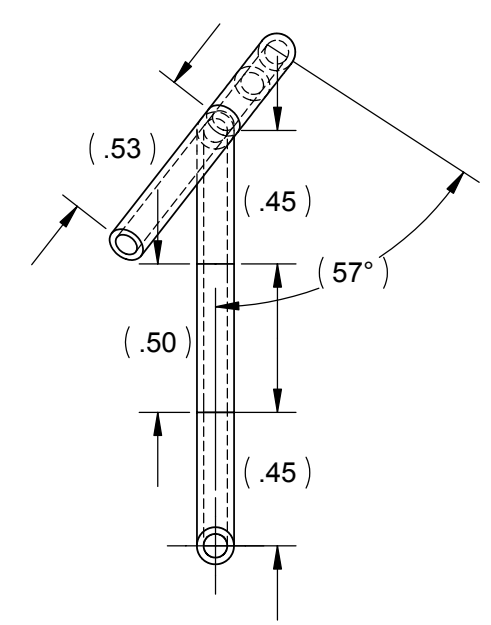
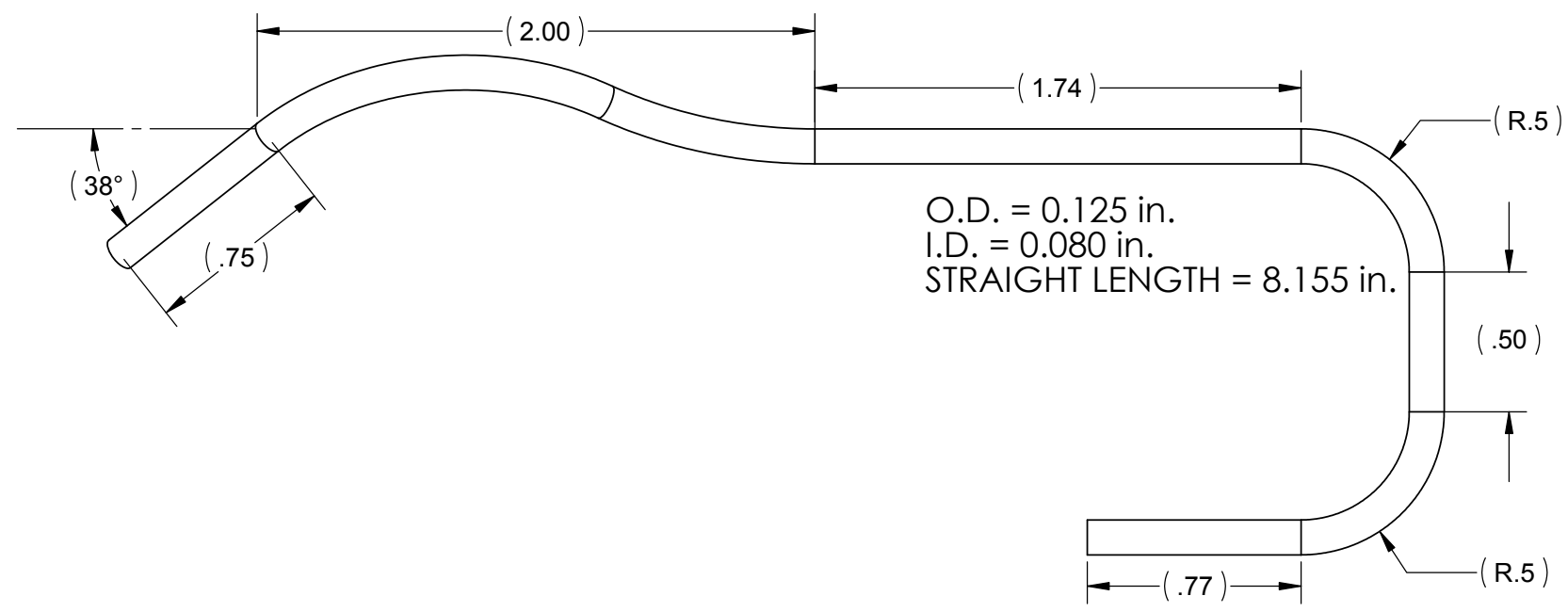

2	2	D020373-00	ACTUATOR BLEED TUBE INSERT SLEEVE		43
1	1	D020374-00	ACTUATOR BLEED TUBE		42
ITEM NO.	QTY.	PART NO.	DESCRIPTION	MATERIAL / VENDOR	SHT. NO.
UNLESS OTHERWISE SPECIFIED:					
DIMENSIONS ARE IN INCHES			DATE	NAME	
TOLERANCES:			DRAWN	6/25/03	Spjeld
.XX ± 0.020"			CHECKED		
.XXX ± 0.005"					
ANGULAR ± 30°					
MATERIAL			COMMENTS:		
FINISH 120 RMS unless noted			One (1) bleed tube assembly required per actuator assembly		
			SIZE	DWG. NO.	REV
			C	D080344	A
			SCALE:	2:1	Sht. No. 42 / 43

LIGO CALIFORNIA INSTITUTE OF TECHNOLOGY
MASSACHUSETTS INSTITUTE OF TECHNOLOGY

SYSTEM LASTI
SUB-SYSTEM HEPI
NEXT ASSY

PART NAME HEPI Actuator Bleed Tube Assembly