

PROFILE
 SCALES: HORIZ: 1" = 50'
 VERT: 1" = 5'

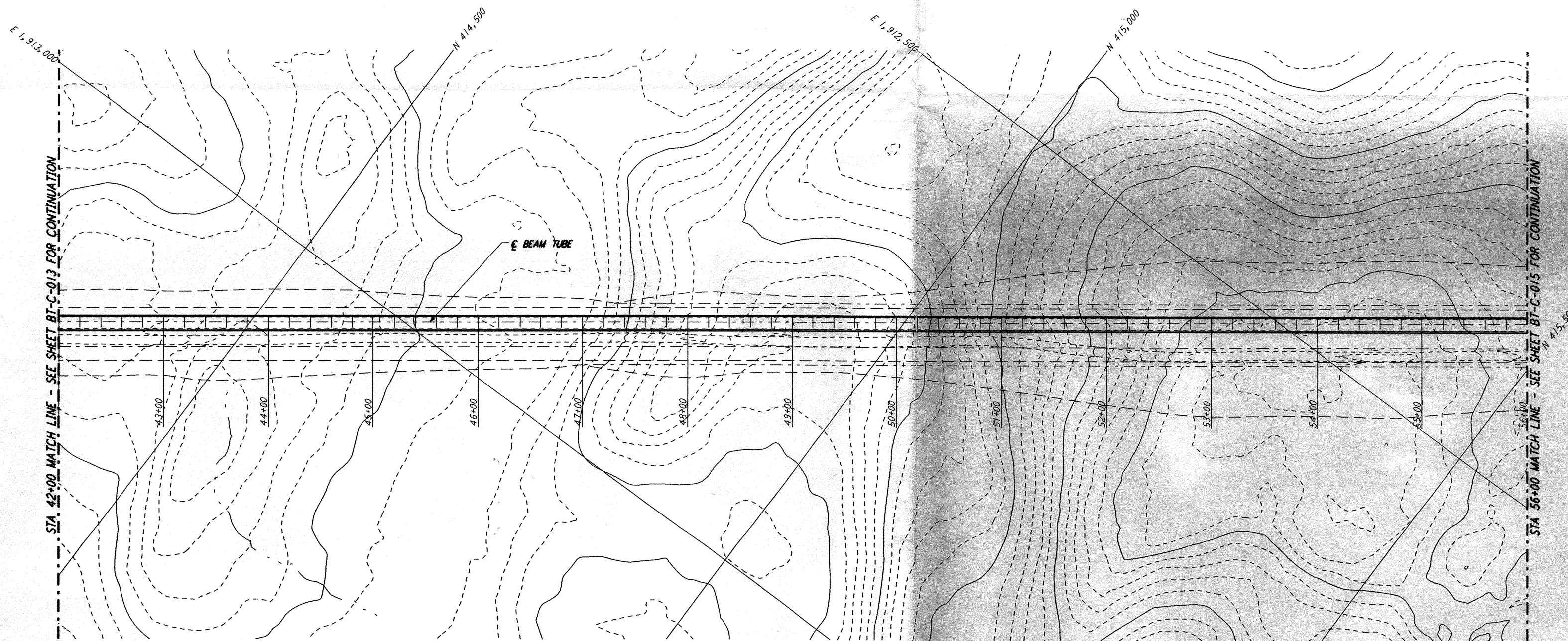

PLAN
 SCALE: 1" = 50'

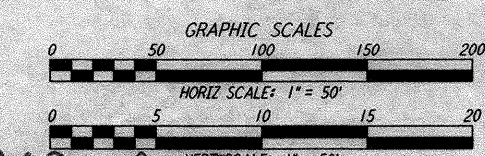
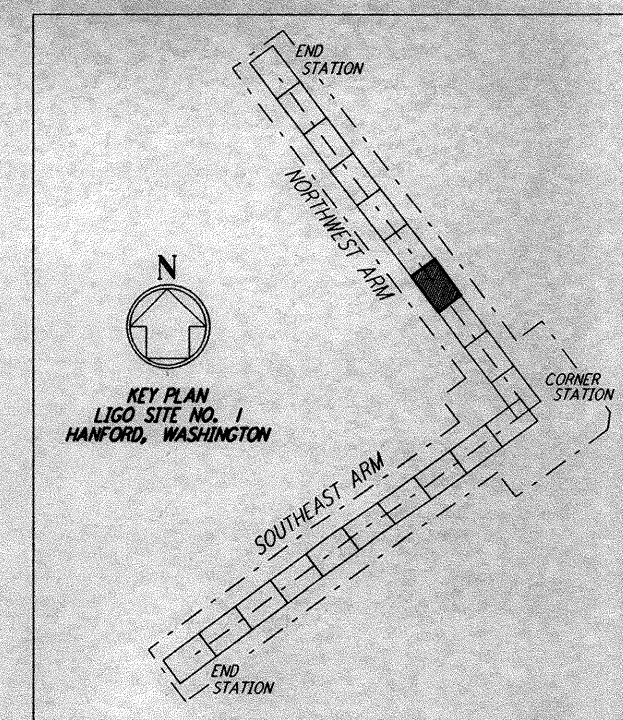
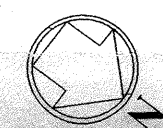

D960169-A-0

NO.	DATE	APRD BY	DESCRIPTION OF REVISION
9			
8			
7			
6			
5			
4			
3			
2			
1			

NO.	DATE	APRD BY	ISSUED FOR
1	8-14-95		PRELIMINARY DESIGN REPORT

DATE	8-10-95
DRAWN	WRB
CHECKED	
SECT HD	
PROJ MGR	
CLIENT	

PARSONS
 100 WEST WALNUT STREET
 PASADENA, CALIFORNIA

LIGO
 CALIFORNIA INSTITUTE OF TECHNOLOGY
 MASSACHUSETTS INSTITUTE OF TECHNOLOGY

LASER INTERFEROMETER
 GRAVITATIONAL-WAVE OBSERVATORY
 BEAM TUBE ENCLOSURE - HANFORD, WA

TITLE	NORTHWEST ARM PLAN AND PROFILE STA 42+00 TO STA 56+00	SCALE	AS NOTED	CONTRACT NUMBER	PPI 50969	PROJECT NUMBER	8094
SHEET NUMBER	BT - C - 014	REVISIONS					

This document and the design it covers are the property of PARSONS. They are loaned only with the borrower's expressed written agreement that they will not be reproduced, copied, loaned, exhibited, or used in any other way, except by written consent from PARSONS to the borrower.

Thu Aug 10 16:14:18 1995 s3-v18h2 k:\PILOTS\OILFILES\VI8R2\CF014C.PRF