

This document and the design it covers are the property of PARSONS. They are loaned only with the borrower's expressed written agreement that they will not be reproduced, copied, loaned, exhibited, or used in any other way, except by written consent from PARSONS to the borrower.

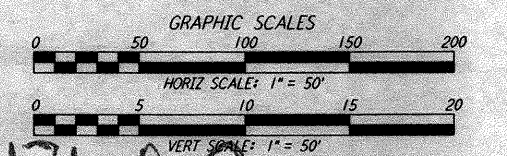
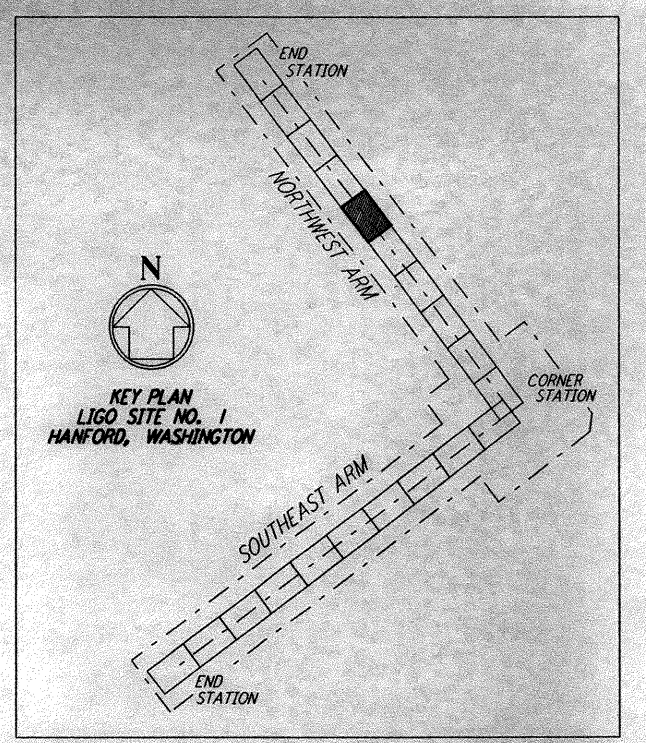
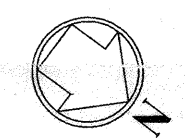
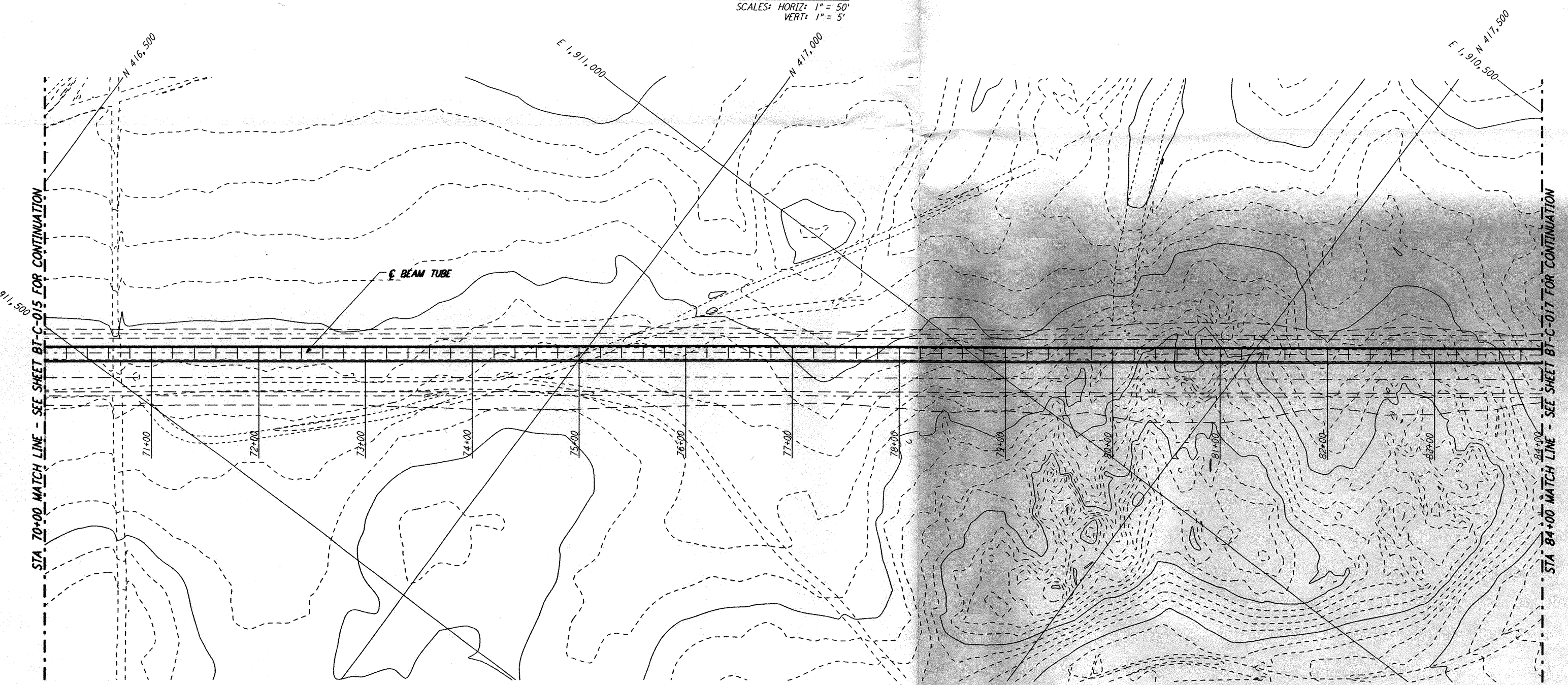
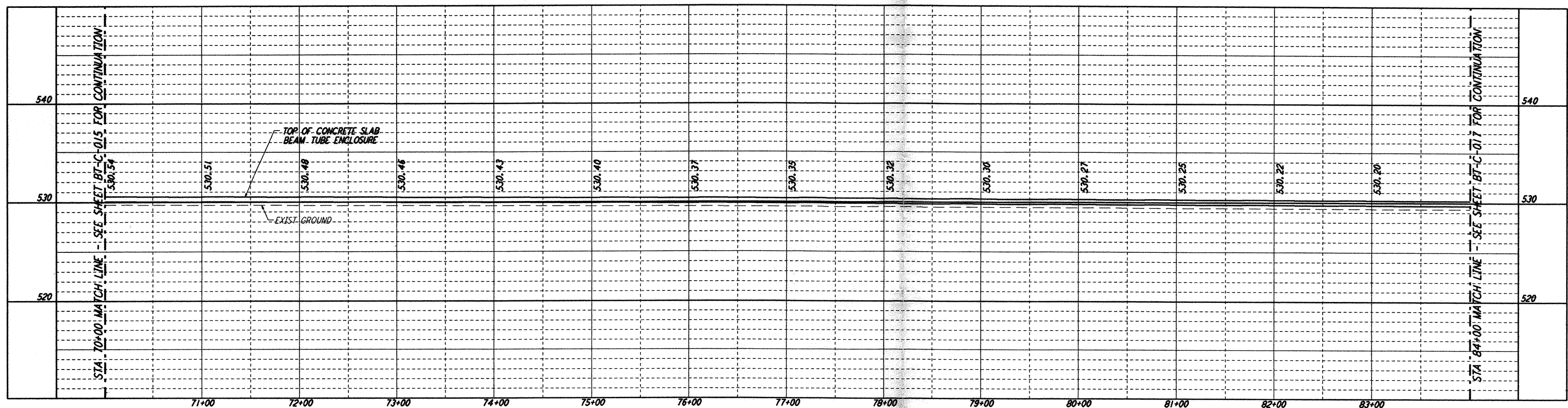

D960171-A-0

REVISION		ISSUE	
NO.	DATE	NO.	DESCRIPTION
9		9	
8		8	
7		7	
6		6	
5		5	
4		4	
3		3	
2		2	
1	8-14-95	1	PRELIMINARY DESIGN REPORT

DATE	8-10-95
DRAWN	WRB
CHECKED	
SECT HD	
PROJ MGR	
CLIENT	

PARSONS
 100 WEST WALNUT STREET
 PASADENA, CALIFORNIA

LIGO
 CALIFORNIA INSTITUTE OF TECHNOLOGY
 MASSACHUSETTS INSTITUTE OF TECHNOLOGY

**LASER INTERFEROMETER
 GRAVITATIONAL-WAVE OBSERVATORY
 BEAM TUBE ENCLOSURE - HANFORD, WA**

TITLE: NORTHWEST ARM PLAN AND PROFILE
 STA 70+00 TO STA 84+00

SCALE: AS NOTED
 CONTRACT NUMBER: PPI50969
 PROJECT NUMBER: 8094

SHEET NUMBER: BT-C-016