

PROFILE
 SCALES: HORIZ: 1" = 50'
 VERT: 1" = 5'

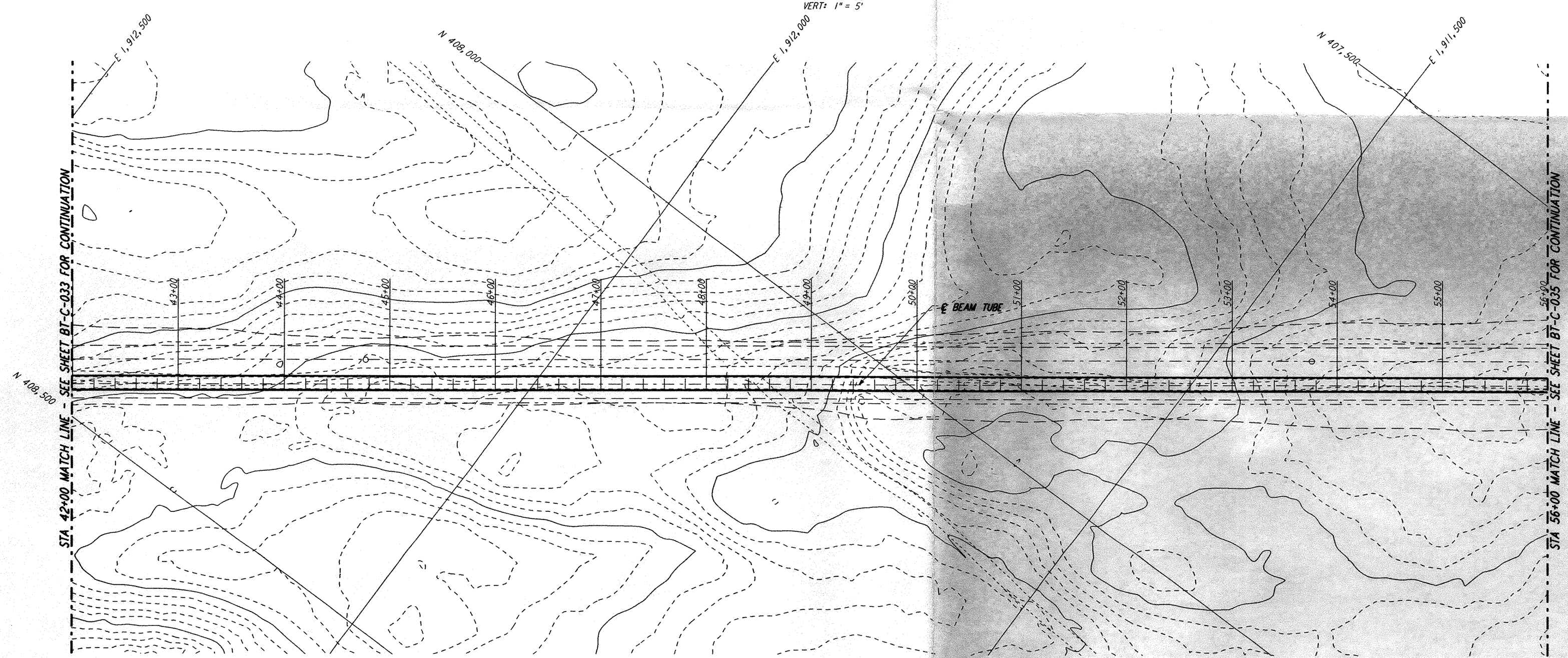

PLAN
 SCALE: 1" = 50'

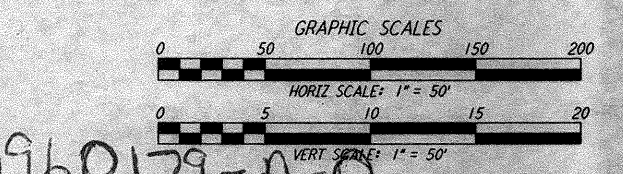
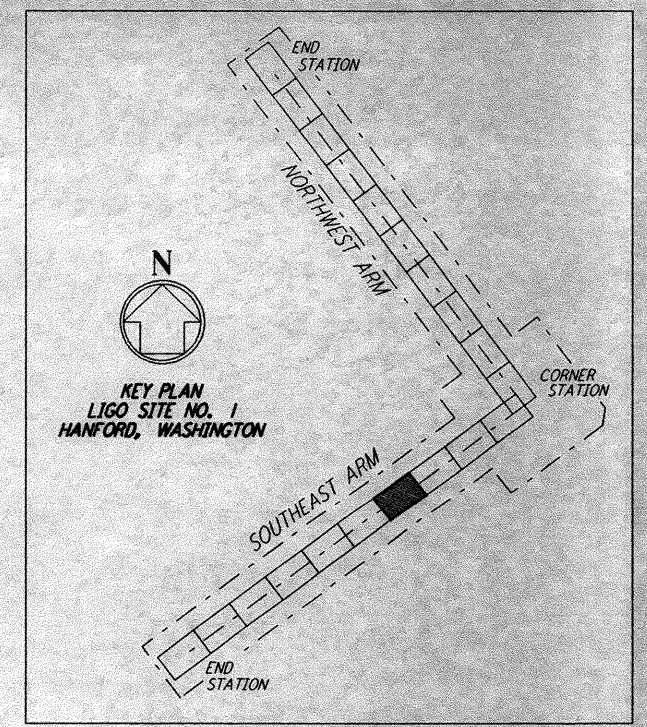
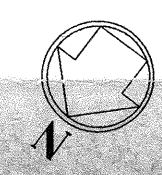

0960179-A-0

REVISION		ISSUE		DATE			
9		9		8-10-95			
8		8			WRB		
7		7					
6		6					
5		5					
4		4					
3		3					
2		2					
1		1		8-14-95	PRELIMINARY DESIGN REPORT		
NO.	DATE	APRD BY	DESCRIPTION OF REVISION	NO.	DATE	APRD BY	ISSUED FOR

PARSONS
 100 WEST WALNUT STREET
 PASADENA, CALIFORNIA

LIGO
 CALIFORNIA INSTITUTE OF TECHNOLOGY
 MASSACHUSETTS INSTITUTE OF TECHNOLOGY

**LASER INTERFEROMETER
 GRAVITATIONAL-WAVE OBSERVATORY
 BEAM TUBE ENCLOSURE - HANFORD, WA**

TITLE: SOUTHWEST ARM PLAN AND PROFILE
 SHEET NUMBER: STA 42+00 TO STA 56+00

SCALE: CONTRACT NUMBER: PPI50969
 PROJECT NUMBER: 8094

AS NOTED: **BT-C-034**

This document and the design it covers are the property of PARSONS. They are loaned only with the borrower's expressed written agreement that they will not be reproduced, copied, loaned, exhibited, or used in any other way, except by written consent from PARSONS to the borrower.

I:\ligo\site\lco\bt-c034.dgz
 K:\PLT\PLT\FILES\W18R2\CE034.PRF
 s3-v18b2
 17:29:33 1995
 LIGOBTF3.BDR