

NOTES:
 1. SEE SHEET WA-C-002 FOR GENERAL NOTES, LEGEND AND ABBREVIATIONS.

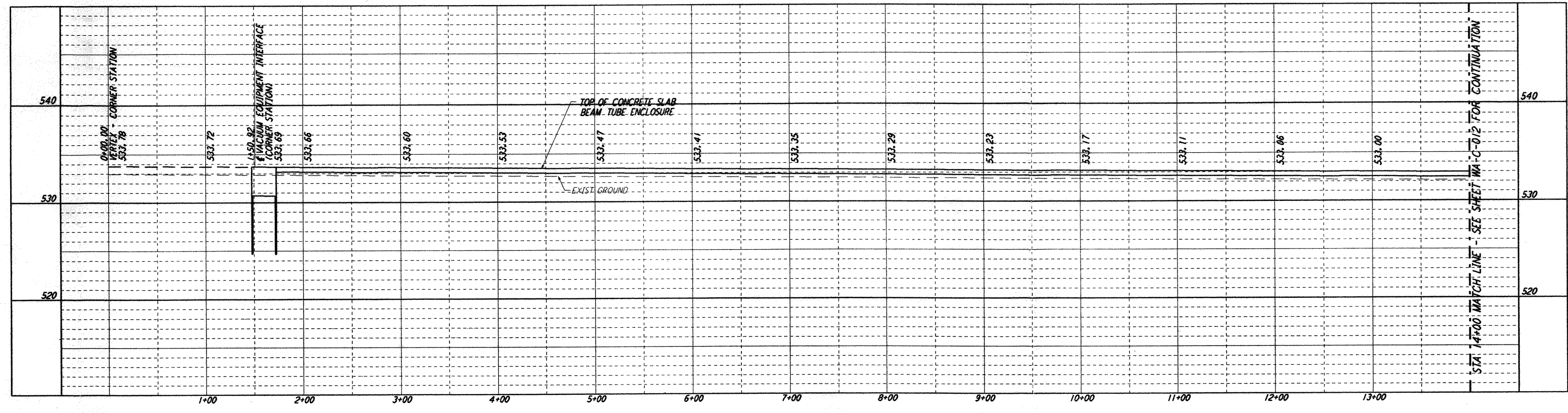

PROFILE
 SCALE: HORIZ: 1" = 50'
 VERT: 1" = 5'

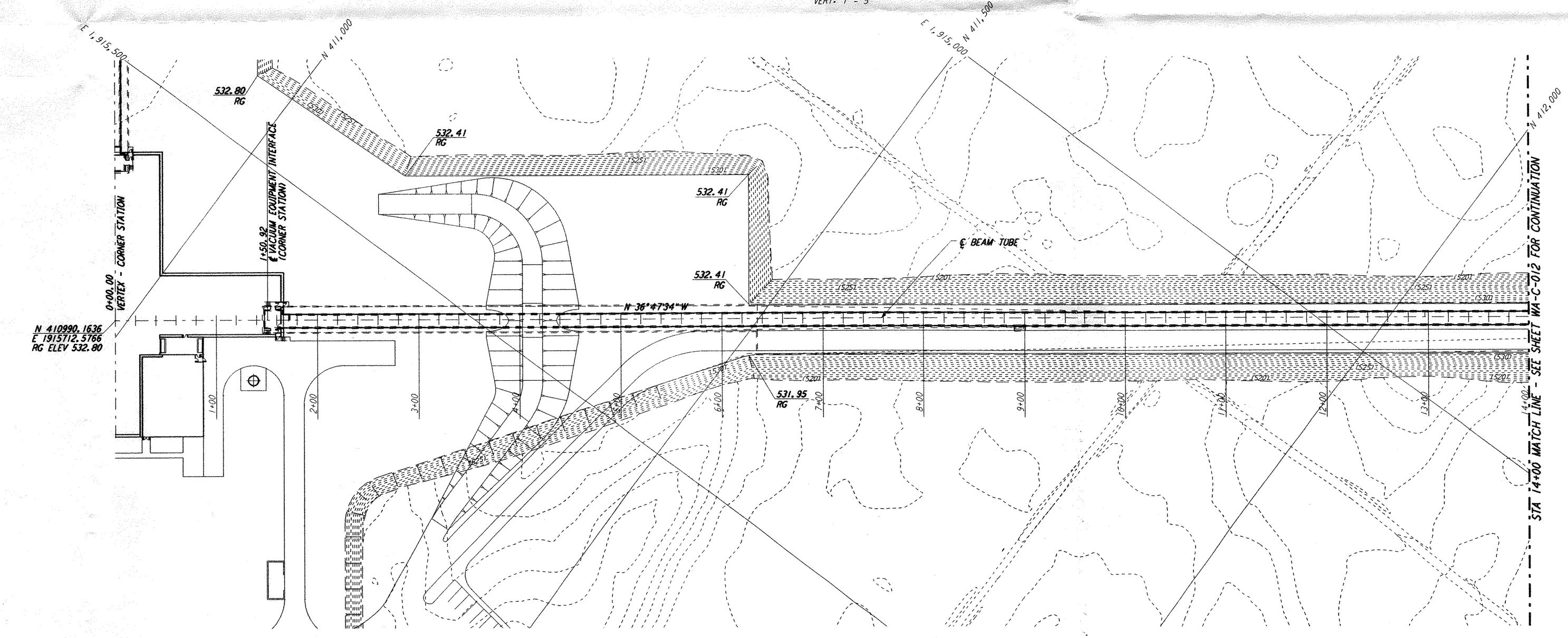

PLAN
 SCALE: 1" = 50'

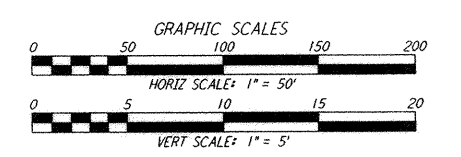
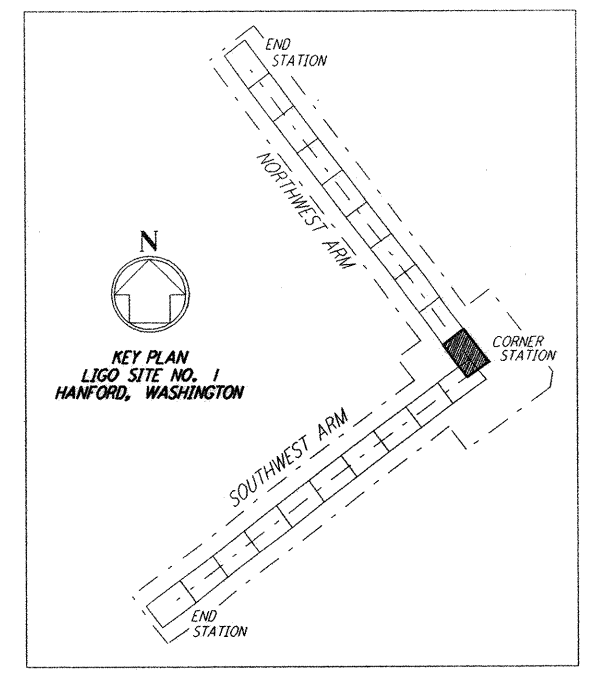
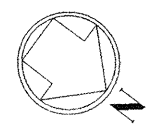

This document and the design it covers are the property of PARSONS. They are loaned only with the borrower's expressed written agreement that they will not be reproduced, copied, loaned, exhibited, or used in any other way, except by written consent from PARSONS to the borrower.

NO.	DATE	APPR BY	DESCRIPTION OF REVISION

DATE	
DRAWN	WRB
CHECKED	
ENGINEER	
PROJ MGR	
CLIENT	

ISSUE	NO.	DATE	APPR BY	DESCRIPTION
1	10/31/95	TDM		PRELIMINARY DESIGN REVIEW
2				ISSUED FOR

PARSONS
 100 WEST WALNUT STREET
 PASADENA, CALIFORNIA

LIGO
 CALIFORNIA INSTITUTE OF TECHNOLOGY
 MASSACHUSETTS INSTITUTE OF TECHNOLOGY

LASER INTERFEROMETER
 GRAVITATIONAL-WAVE OBSERVATORY
 SITE NO. 1 - HANFORD, WASHINGTON

**NORTHWEST ARM
 PLAN AND PROFILE
 STA 0+00 TO STA 14+00**

AS NOTED PP150969 8094
WA-C-011

Tue Oct 31 06:55:15 1995 s3-v18b2 J:\PLOTS\QUEUE\18B2\CE011.PRF