

NOTES:
 1. SEE SHEET WA-C-002 FOR GENERAL NOTES, LEGEND AND ABBREVIATIONS.

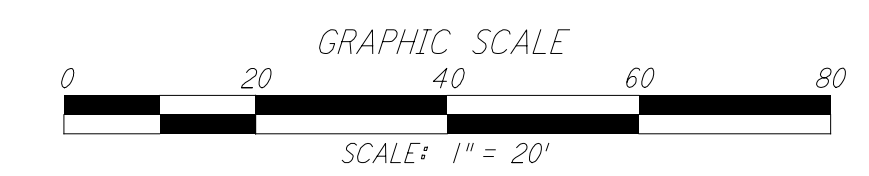
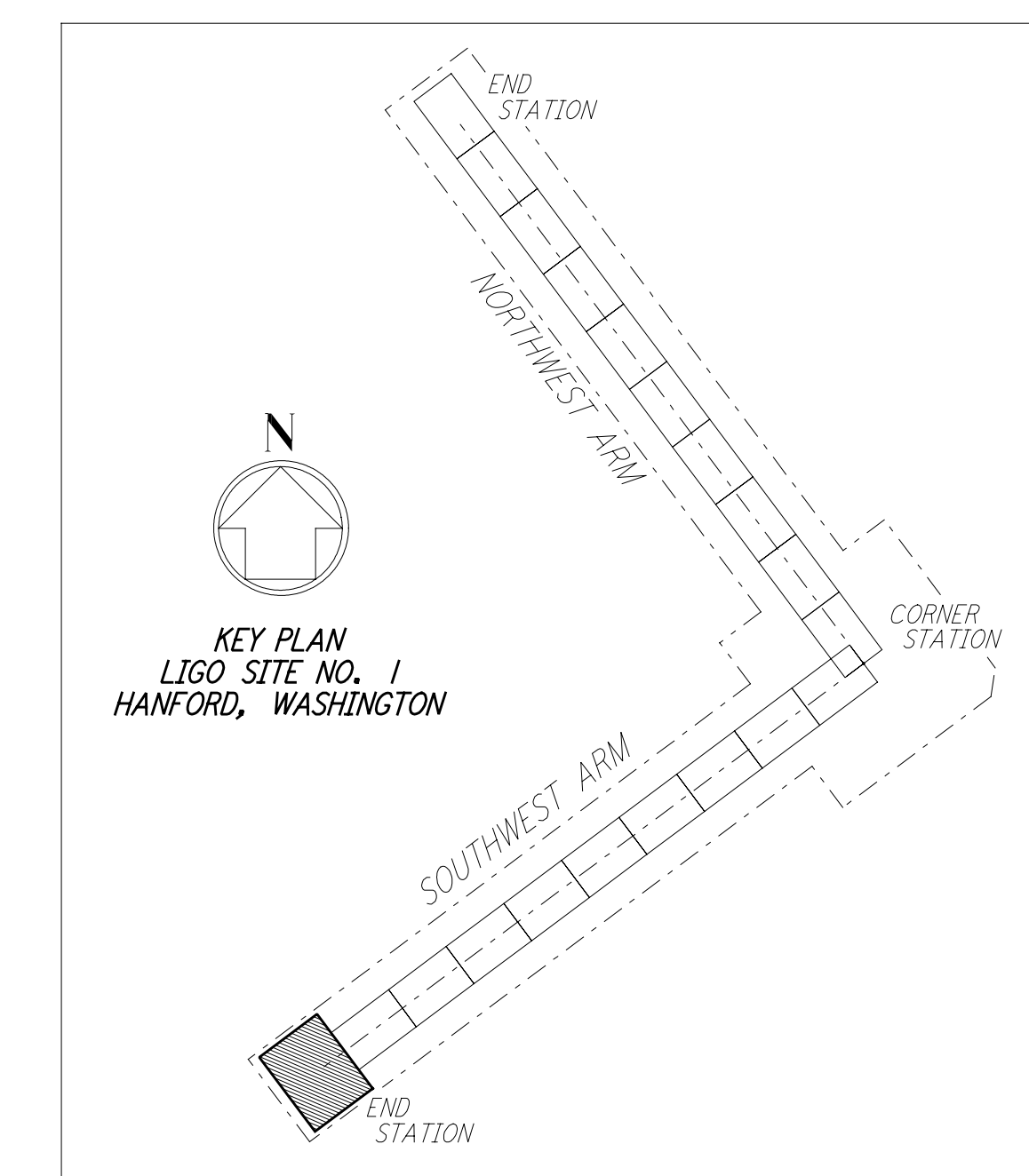
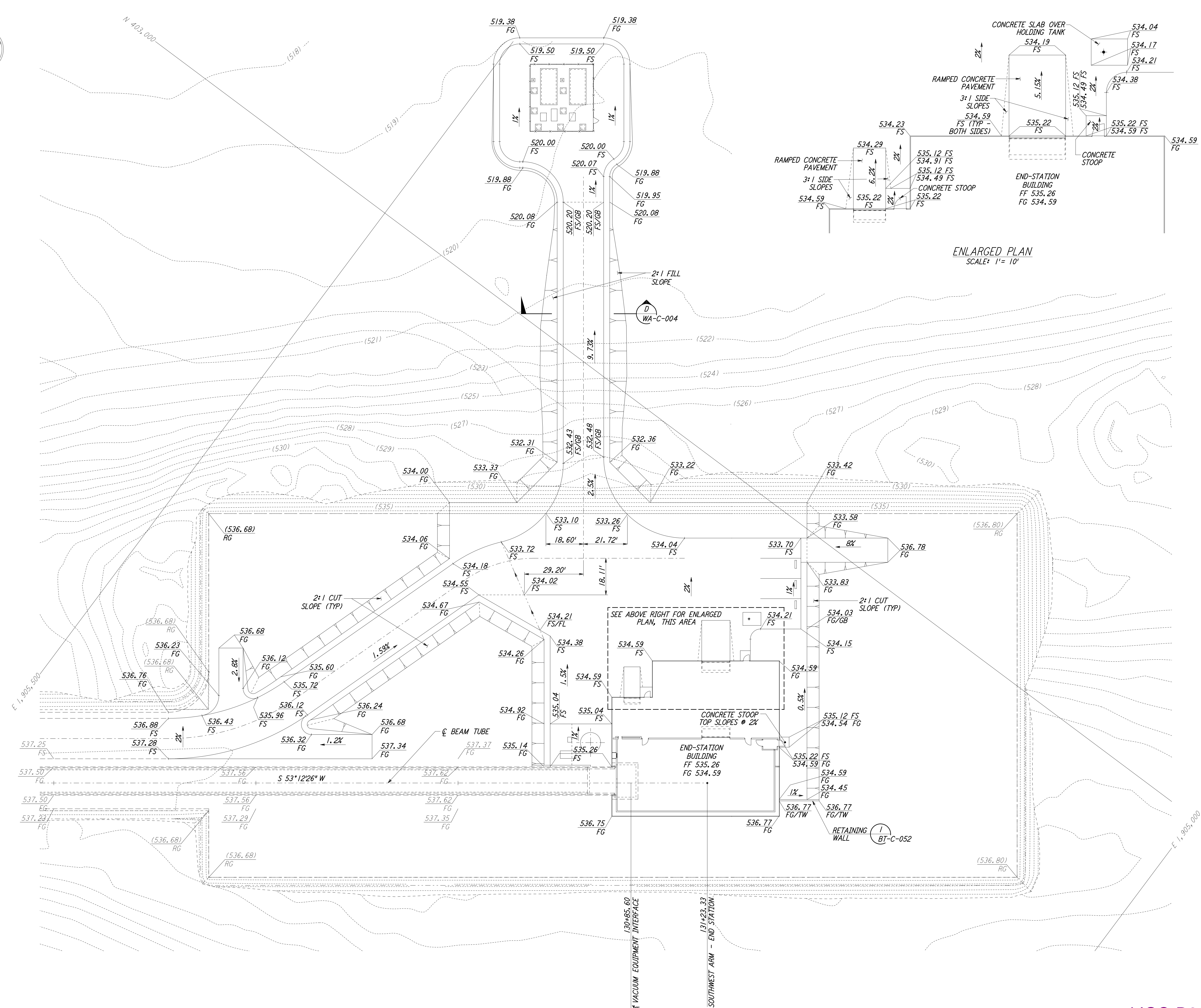
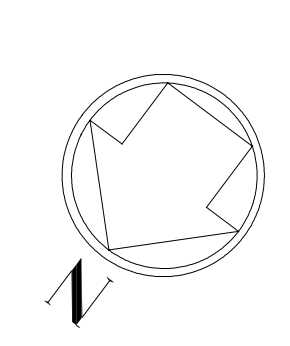

LIGO-D960232-01-O

This document and the design it covers are the property of PARSONS. They are loaned only with the borrower's expressed written agreement that they will not be reproduced, copied, loaned, exhibited, or used in any other way, except by written consent from PARSONS to the borrower.

This document and the design it covers are the property of PARSONS. They are loaned only with the borrower's expressed written agreement that they will not be reproduced, copied, loaned, exhibited, or used in any other way, except by written consent from PARSONS to the borrower.

NO.	DATE	BY	CHKD	ENGR	PROJ	DESCRIPTION
1	5/15/98	WRB				ISSUED FOR AS-BUILT

DRAWING NO.	DESCRIPTION

FOR CONSTRUCTION		
DRAWN	WRB	9/28/95
CHECKED	ML	7/9/96
ENGINEER	JB	7/9/96
PROJ	MDW	7/9/96

AS-BUILT DRAWINGS	



LASER INTERFEROMETER GRAVITATIONAL-WAVE OBSERVATORY SITE NO. I - HANFORD, WASHINGTON			
TITLE	CIVIL SOUTHWEST ARM END-STATION GRADING PLAN	SCALE	1" = 20'
SHEET NUMBER	WA-C-046	OBJECT NUMBER	PP150969
PROJECT NUMBER	8094	REVISIONS	